

G WESTERN AUSTRALIAN GOVERNMENT Gazette



PERTH, TUESDAY, 14 JUNE 1994 No. 80

PUBLISHED BY AUTHORITY G. L. DUFFIELD, GOVERNMENT PRINTER AT 3.30 PM

Publishing Details

The Western Australian *Government Gazette* is published by State Print for the State of Western Australia on Tuesday and Friday of each week unless disrupted by Public Holidays or unforeseen circumstances (changes to this arrangement will be advertised beforehand on the inside cover).

Special *Government Gazettes* and Extraordinary *Government Gazettes* are published periodically, only the special gazettes are included in the subscription price.

The following guidelines should be followed to ensure publication in the *Government Gazette*.

- Material submitted to the Executive Council and which requires gazettal will require a copy of the signed Executive Council Minute Paper and in some cases the Parliamentary Counsel's Certificate.
- Copy should be received by the Manager, Law Publisher no later than 3.00 p.m. on Wednesday (Friday edition) or 3.00 p.m. on Friday (Tuesday edition).
- Lengthy or complicated notices should be forwarded several days before advertised closing date for copy. This is to ensure inclusion in current edition. Failure to observe this request could result in the notice being held over until the following edition.
- Proofs will be supplied only when requested.
- No additions or amendments to material for publication will be accepted by telephone.

Send copy to:

The Manager,
Law Publisher
State Print
Station Street, Wembley, 6014
Telephone: 383 8851 Fax: 383 8888

Advertisers should note:

- All Notices should be written in 'plain English'.
- Signatures (in particular) and proper names must be legible.
- All copy should be typed and double spaced.
- If it is necessary through isolation or urgency to communicate by facsimile, confirmation is not required by post. If original copy is forwarded later and published, the cost will be borne by the advertiser.
- Documents not clearly prepared and in the required format for gazettal, will be returned to the sender unpublished.
- Late copy received at Law Publisher will be placed in the following issue irrespective of any date/s mentioned in the copy.

IMPORTANT COPYRIGHT NOTICE

© State of Western Australia

This work is copyright. Apart from any use as permitted under the *Copyright Act 1968*, no part may be reproduced by any process without written permission from the Government Printer, State Print. Inquiries should be directed to the Manager, Law Publisher, P.O. Box 38, Wembley, W.A. 6014.

Advertising Rates and Payments

Effective from 20 September 1993.

Deceased Estate notices, (per estate)—\$15.20

Real Estate and Business Agents and Finance Brokers Licences, (per notice)—\$35.10

Other Public Notices Section articles \$35.10 (except items of an exceptionally large nature, then arrangements will be made for invoicing).

All other Notices

Per Column Centimetre—\$6.95

Bulk Notices—\$128.40 per page

Clients will be invoiced for advertising charges

COUNTER SALES 1993-94

(As from 1 October 1993)

	\$
Government Gazette—(General)	1.90
Government Gazette—(Special)	
Up to 2 pages	1.90
Over 2 pages	3.80
Hansard	11.40
Industrial Gazette	10.20
Bound Volumes of Statutes	190.00

IMPORTANT NOTICE

Periodically notices are published indicating a variation in normal publishing arrangements:

- Easter or Christmas editions etc—these notices appear approximately 4 weeks prior to any change.
- Extraordinary gazettes not circulated to all subscribers—these notices appear in the following general edition of the gazette.

In all cases notices are published on page 2 and readers are urged to check accordingly prior to contacting State Print.

G. L. DUFFIELD, Director.

PROCLAMATIONS

AA101

**LAND ACT 1933
CLASSIFICATION OF RESERVED LANDS
PROCLAMATION**

WESTERN AUSTRALIA P. M. Jeffery, Governor. [L.S.]	}	By His Excellency Major General Philip Michael Jeffery, Officer of the Order of Australia, Military Cross, Governor of the State of Western Australia.
--	---	---

DOLA File: 1654/1993.

Under Section 31 of the Land Act 1933, I, the Governor acting with the advice and consent of the Executive Council, hereby classify as of Class "A" Reserve No. 43059 comprising Stirling Estate Lot 280 with an area of 2646417 hectares for the designated purpose of "National Park".

Local Authority—Shire of Capel.

Given under my hand and the Seal of the State on 7 June 1994.

By His Excellency's Command,

GEORGE CASH, Minister for Lands.

GOD SAVE THE QUEEN !

AA102

**LAND ACT 1933
CLASSIFICATION OF RESERVED LANDS
PROCLAMATION**

WESTERN AUSTRALIA P. M. Jeffery, Governor. [L.S.]	}	By His Excellency Major General Philip Michael Jeffery, Officer of the Order of Australia, Military Cross, Governor of the State of Western Australia.
--	---	---

DOLA File: 2552/993.

Under Section 31 (1) (a) of the Land Act 1933, I, the Governor acting with the advice and consent of the Executive Council, hereby classify as of Class "A" Reserve No. 43056 comprising Nelson Location 13429 with an area of 86397 hectares for the designated purpose of "Conservation of Flora and Fauna".

Local Authority—Shire of Manjimup.

Given under my hand and the Seal of the State on 7 June 1994.

By His Excellency's Command,

GEORGE CASH, Minister for Lands.

GOD SAVE THE QUEEN !

AA103

**TRANSFER OF LAND ACT 1893
TRANSFER OF LAND (REVESTMENT)
PROCLAMATION**

WESTERN AUSTRALIA P. M. Jeffery, Governor. [L.S.]	}	By His Excellency Major General Philip Michael Jeffery, Officer of the Order of Australia, Military Cross, Governor of the State of Western Australia.
--	---	---

DOLA File: 1127/992.

Under Section 243 of the Transfer of Land Act 1893, I, the Governor acting with the advice and consent of the Executive Council, do hereby revest in Her Majesty as of her former estate, the land described as portion of Canning Location 16 being the land coloured brown and marked Pedestrian Accessway on Plan 12596 and being part of the land comprised in Certificate of Title Volume 1514 Folio 401.

Given under my hand and the Seal of the State on 7 June 1994.

By His Excellency's Command,

GEORGE CASH, Minister for Lands.

GOD SAVE THE QUEEN !

AA104

TRANSFER OF LAND ACT 1893
TRANSFER OF LAND (REVESTMENT)

PROCLAMATION

WESTERN AUSTRALIA P. M. Jeffery, Governor. [L.S.]	}	By His Excellency Major General Phillip Michael Jeffery, Officer of the Order of Australia, Military Cross, Governor of the State of Western Australia.
--	---	--

DOLA File: 5735/950V13.

Under Section 243 of the Transfer of Land Act 1893, I, the Governor acting with the advice and consent of the Executive Council, do hereby revest in Her Majesty as of her former estate, the land described in the Schedules to this Proclamation.

Given under my hand and the Seal of the State on 7 June 1994.

By His Excellency's Command,

GEORGE CASH, Minister for Lands.

GOD SAVE THE QUEEN !

Schedule I

DOLA File	Description of Land	Certificate of Title	Volume	Folio
7680/896V2	Malcolm Town Lot 29. (now Lot 279)		1967	879
573/994	Lot 380 on Plan 19181. (now Location 4094)		1970	633
2294/988	Lot 939 on Plan 17748. (now portion Lot 649)		1890	844
2294/988	Lot 897 on Plan 17748. (now portion Lot 649)		1890	802
574/994	Lot 310 on Plan 19180. (now Location 4095)		1970	618
923/976	Lot 202 on Diagram 83612. (now Location 3872)		1959	631
414/994	Lot 1240 on Plan 18634. (now Lot 656)		1966	136
414/994	Lot 1251 on Plan 19340. (now portion Lot 657)		1978	265
414/994	Lot 1241 on Plan 19338. (now portion Lot 657)		1978	207
644/994	Lot 54 on Diagram 84955. (now Location 29108)		1976	870
626/994	Lot 504 on Plan 19045. (now Location 7758)		1957	149
610/994	Lot 100 on Plan 19138. (now Location 3875)		1968	145
2134/974	Lot 501 on Diagram 84116. (now Location 3879)		1971	435
647/994	Lot 66 on Plan 19308. (now Location 3882)		1980	949
1384/991	Lot 63 on Diagram 80915. (now portion Location 3873)		1955	28
1384/991	Lot 64 on Diagram 79691. (now portion Location 3873)		1963	264
646/994	Lot 4 on Diagram 84821. (now Location 3881)		1976	38
423/994	Lot 26 on Plan 15391. (now Location 11984)		1868	802
3257/990	Lot 592 on Plan 19306. (now Location 3874)		1970	542
3257/990	Lot 753 on Diagram 84796. (now Location 3892)		1970	584
10222/902	Kathleen Lot 42. (now Lot 76)		1992	41
429/994	Portion of Canning Location 31 and being the land coloured brown and marked Pedestrian Accessway on Plan 8890(1). (now Location 3887)		127	47A

Schedule II

DOLA File	Description of Land
2106/993	Portion of Swan Location I coloured brown and marked Pedestrian Accessway abutting Lots 666 and 695 on Plan 15155 and being part of the land comprised in Certificate of Title Volume 1708 Folio 846.
2304/993	Portion of Kwinana Lot E7 being the land coloured brown and marked Pedestrian Accessway containing an area of 265 square metres on Plan 10743 and being part of the land comprised in Certificate of Title Volume 1399 Folio 587. (now Lot 342).
2447/993	Portion of Perthshire Location Au being the land coloured brown and marked Pedestrian Accessway containing an area of 329 square metres abutting Lots 144 and 159 on Plan 11294 and being part of the land comprised in Certificate of Title Volume 1418 Folio 596.

CONSERVATION AND LAND MANAGEMENT

CM301

CONSERVATION AND LAND MANAGEMENT ACT 1984**ORDER TO REVOKE STATE FOREST No. 1**

CALM File: 010632F2710.

DOLA File: 1654/993.

Made by His Excellency the Governor under section 9 (2).

Whereas both Houses of Parliament passed a resolution that a proposal from His Excellency the Governor dated the twenty second day of May 1990, for the revocation in whole or in part of State forest Nos. 1, 4, 15, 30, 41 and 45, should be carried out. Now, His Excellency the Governor, with the advice and consent of the Executive Council, declares that the dedication of Crown land as State forest No. 1 described in the schedule is totally revoked.

Schedule

State forest No. 1 being the whole of the land shown on Department of Conservation and Land Management registered plan No. 120 Sheet 2.

Area: about 264.5 hectares.

Public Plans: Bunbury 1:10 000 8.4 and Geographe 1:10 000 8.3.

D. G. BLIGHT, Clerk of the Council.

FISHERIES

FI301

FISHERIES ADJUSTMENT SCHEMES ACT 1987**FISHERIES ADJUSTMENT SCHEMES AMENDMENT REGULATIONS
(NO. 2) 1994**

Made by His Excellency the Governor in Executive Council.

Citation

1. These regulations may be cited as the *Fisheries Adjustment Schemes Amendment Regulations (No. 2) 1994*.

Commencement

2. These regulations come into operation on 1 July 1994.

Regulation 4 amended

3. Regulation 4 of the *Fisheries Adjustment Schemes Regulations 1988** is amended in subregulation (1) by deleting "\$100" and substituting the following —

" \$115 "

[* *Published in Gazette of 17 June 1988 at p. 1593.*
For amendments to 5 April 1994 see 1992 Index to Legislation of Western Australia, Table 4, p. 86.]

By His Excellency's Command,

D. G. BLIGHT, Clerk of the Council.

JUSTICE

JM301

JUSTICES ACT 1902

JUSTICES (INREP) AMENDMENT REGULATIONS (NO. 2) 1994

Made by His Excellency the Governor in Executive Council.

Citation

1. These regulations may be cited as the *Justices (INREP) Amendment Regulations (No. 2) 1994*.

Schedule 1 amended

2. Schedule 1 to the *Justices Act 1902** is amended —

(a) in item 2 by inserting after paragraph (o) in columns 2, 3, 4 and 5 respectively, the following paragraphs —

“

(p)	Rangers' Supervisor City of Bunbury	City Manager/ Town Clerk City of Bunbury	Rangers' Supervisor City of Bunbury	Rangers' Supervisor City of Bunbury
-----	--	---	--	--

”;

(b) in item 4 by inserting after paragraph (i) in columns 2, 3, 4 and 5 respectively, the following paragraphs —

“

(j)	Rangers' Supervisor City of Bunbury	City Manager/ Town Clerk City of Bunbury	Rangers' Supervisor City of Bunbury	Rangers' Supervisor City of Bunbury
-----	--	---	--	--

”;

(c) in item 5 by inserting after paragraph (g) in columns 2, 3, 4 and 5 respectively, the following paragraphs —

“

(h)	Rangers' Supervisor City of Bunbury	City Manager/ Town Clerk City of Bunbury	Rangers' Supervisor City of Bunbury	Rangers' Supervisor City of Bunbury
-----	--	---	--	--

”;

(d) in item 6 by inserting after paragraph (m) in columns 2, 3, 4 and 5 respectively, the following paragraphs —

“

(n)	Rangers' Supervisor City of Bunbury	City Manager/ Town Clerk City of Bunbury	Rangers' Supervisor City of Bunbury	Rangers' Supervisor City of Bunbury
-----	--	---	--	--

”;

and

- (e) in item 7 by inserting after paragraph (k) in columns 2, 3, 4 and 5 respectively, the following paragraphs —

“

(l)	Rangers' Supervisor City of Bunbury	City Manager/ Town Clerk City of Bunbury	Rangers' Supervisor City of Bunbury	Rangers' Supervisor City of Bunbury
-----	--	---	--	--

”

[* *Published in Gazette of 15 December 1989 at pp. 4521-24.
For amendments to 23 May 1994 see 1993 Index to Legislation of Western
Australia, Table 4, pp. 148-9, and Gazette of 15 April 1994.*]

By His Excellency's Command,

D. G. BLIGHT, Clerk of the Council.

LAND ADMINISTRATION

LA101

CORRIGENDUM

DOLA File: 12146/911.

In the notice at page 2081 of the *Government Gazette* dated 17 May 1994 in respect to Reserve No. 13267 the reference to 12.4581 hectares is amended to read 11.1326 hectares.

A. A. SKINNER, Chief Executive.

LA201

LAND ACT 1933 ORDERS IN COUNCIL (Vesting of Reserves)

By the direction of His Excellency the Governor under section 33 (2), the following reserves have been vested.

DOLA File: 2699/982.

Reserve No. 37980 (Newman Lots 990 and 2303) vested in The St. John Ambulance Association in Western Australia Incorporated for the designated purpose of "Ambulance Depot".

Local Authority—Shire of East Pilbara.

DOLA File: 844/994.

Reserve No. 43038 (Cockburn Sound Location 4086) vested in the Australian and Overseas Telecommunications Corporation Limited for the designated purpose of "Exchange Site".

Local Authority—City of Mandurah.

DOLA File: 1955/894.

Reserve No. 594 (Fremantle Lot 2078) vested in the Minister for Works for the designated purpose of "Historic Buildings and Park".

Local Authority—City of Fremantle.

DOLA File: 2843/985.

Reserve No. 40361 (Swan Location 10977) vested in the Water Authority of Western Australia for the designated purpose of "Drainage".

Local Authority—City of Stirling.

DOLA File: 2044/992.

Reserve No. 42573 (Canning Location 3803) vested in the Shire of Kalamunda for the designated purpose of "Public Recreation".

DOLA File: 2331/993.

Reserve No. 43063 (Victoria Location 11977) vested in the Shire of Mingenew for the designated purpose of "Recreation" with power, subject to the approval in writing of the Minister for Lands to each and every lease or assignment of lease being first obtained, to lease the whole or any portion thereof for any term not exceeding twenty one (21) years from the date of the lease.

DOLA File: 624/991.

Reserve No. 43039 (Williams Location 15792) vested in the Australian and Overseas Telecommunications Corporation Limited for the designated purpose of "Radio Mast Site".

Local Authority—Shire of Wickiepin.

DOLA File: 2083/993.

Reserve No. 43024 (Kambalda Lots 334 and 360) vested in the Shire of Coolgardie for the designated purpose of "Pedestrian Accessway".

DOLA File: 2769/987.

Reserve No. 41169 (Lyons Locations 5, 6, 7 and 46) vested in The State Energy Commission of Western Australia for "Natural Gas Pipeline Purposes".

Local Authority—Shire of Upper Gascoyne.

DOLA File: 2787/906.

Reserve No. 10192 (Williams Lot 101) vested in the Commissioner of Main Roads for the designated purpose of "Depot Site".

Local Authority—Shire of Williams.

DOLA File: 2928/989.

Reserve No. 28459 (Kalgoorlie Lot 3923) vested in the Kalgoorlie Bowling Club Incorporated for the designated purpose of "Recreation".

Local Authority—City of Kalgoorlie-Boulder.

DOLA File: 2252/991.

Reserve No. 43043 (Busselton Lot 430) vested in the Honourable Roger Keith Nicholls JP, M.L.A., Minister for Community Development for the time being and his successors in office, for the designated purpose of "Family and Health Centre" with power, to lease the whole or any portion thereof for any term.

Local Authority—Shire of Busselton.

DOLA File: 4328/948.

Reserve No. 43053 (Wyalkatchem Lot 238) vested in the Shire of Wyalkatchem for the designated purpose of "Horse Paddocks" with power, subject to the approval in writing of the Minister for Lands to each and every lease or assignment of lease being first obtained, to lease the whole or any portion thereof for any term not exceeding five (5) years from the date of the lease.

DOLA File: 2399/966.

Reserve No. 31685 (Canning Location 3769) vested in the Minister for Mines for the designated purpose of "Mining Development—Laboratories" with power, to lease the whole or any portion thereof for any term.

Local Authority—City of Perth.

DOLA File: 2961/986.

Reserve No. 39644 (Canning Location 3848) vested in The State Energy Commission of Western Australia for the designated purpose of "Sub Station Site".

Local Authority—Shire of Mundaring.

DOLA File: 1566/993.

Reserve No. 42874 (Canning Location 3844) vested in the Water Authority of Western Australia for the designated purpose of "Drainage".

Local Authority—City of Canning.

DOLA File: 3224/964.

Reserve No. 31100 (Victoria Location 11077) vested in the Shire of Northampton for the designated purpose of "Aerial Landing Ground" with power, subject to the approval in writing of the Minister for Lands to each and every lease or assignment of lease being first obtained, to lease the whole or any portion thereof for any term not exceeding twenty one (21) years from the date of the lease.

DOLA File: 995/894.

Reserve No. 2494 (Avon Location 29094) vested in the Shire of Bruce Rock for the designated purpose of "Water".

DOLA File: 12767/900.

Reserve No. 7716 (Ravensthorpe Lots 157, 382 to 428 inclusive, 728 and 747 to 749 inclusive) vested in the Minister for Education for the designated purpose of "School Site" with power, to lease the whole or any portion thereof for any term.

Local Authority—Shire of Ravensthorpe.

DOLA File: 1291/993.

Reserve No. 42865 (Canning Location 3837) vested in the City of Gosnells for the designated purpose of "Public Recreation".

DOLA File: 12125/909.

Reserve No. 12477 (Fremantle Lot 2091) vested in the City of Fremantle for the designated purpose of "Recreation" with power, subject to the approval in writing of the Minister for Lands to each and every lease or assignment of lease being first obtained, to lease the whole or any portion thereof for any term not exceeding twenty one (21) years from the date of the lease.

DOLA File: 2568/989.

Reserve No. 41124 (Swan Location 11262) vested in the City of Wanneroo for the designated purpose of "Helicopter Landing Site, Car Park and Drainage" with power, subject to the approval in writing of the Minister for Lands to each and every lease or assignment of lease being first obtained, to lease the whole or any portion thereof for any term not exceeding twenty one (21) years from the date of the lease.

DOLA File: 2098/993.

Reserve No. 43067 (Peel Estate Lot 1385) vested in the Water Authority of Western Australia for the designated purpose of "Drainage".

Local Authority—Shire of Serpentine-Jarrahdale.

DOLA File: 874/993.

Reserve No. 43065 (Swan Location 11928) vested jointly in the Shire of Swan and the Water Authority of Western Australia for the designated purpose of "Park and Public Utilities Services".

DOLA File: 874/977.

Reserve No. 34953 (Fitzroy Location 96) vested in The Agriculture Protection Board of Western Australia for the designated purpose of "Depot Site".

Local Authority—Shire of Derby/West Kimberley.

DOLA File: 2904/950.

Reserve No. 23163 (Derby Lot 429) vested in the Aboriginal Lands Trust for the designated purpose of "Use and Benefit of Aboriginal Inhabitants (Resource Centre)" with power, to lease the whole or any portion thereof for any term.

Local Authority—Shire of Derby/West Kimberley.

DOLA File: 2027/993.

Reserve No. 43055 (Swan Location 11947) vested in The State Energy Commission of Western Australia for the designated purpose of "Padmount Site".

Local Authority—City of Wanneroo.

DOLA File: 623/994.

Reserve No. 43078 (Victoria Location 11982) vested in the Shire of Irwin (subject to the conditions set out in Part I of the Schedule over) for the designated purpose of "Parkland, Recreation and the letting of cottages existing thereon on 14 February 1994" with power, subject to the approval in writing of the Minister for Lands to each and every lease being first obtained, and to the conditions set out in Part II of the Schedule over, to lease the whole or any portion thereof for a term or terms expiring on or before 30 June 2000.

Schedule

PART I

- (i) The Shire is to ensure early removal of structures for which a lease is not accorded by 31 December 1994 and in any case is to ensure clearing of all structures and rehabilitation of affected area by 31 December 2000.
- (ii) No new cottages will be allowed to be constructed within the reserve from the date of making this Order.
- (iii) The Shire will manage the reserve in accordance with a Management Plan prepared in consultation with Conservation and Land Management (CALM) and approved by the Minister for Lands.
- (v) that the Shire, CALM and the NPNCA will establish a Memorandum of Understanding to cover the management of the area.

PART II

- (i) Leasing is to be restricted to persons occupying cottages as at 14 February 1994.
- (ii) No transfer or assignment of leases will be permitted.

DOLA File: 550/975.

Reserve No. 33114 (Kununurra Lot 1196) vested in the Shire of Wyndham-East Kimberley for the designated purpose of "Public Utility Services" subject to access being available to the Service Authorities at all times.

DOLA File: 507/991.

Reserve No. 43061 (Yurabi Location 86) vested in the Aboriginal Lands Trust for the designated purpose of "Use and Benefit of Aboriginal Inhabitants" with power, to lease the whole or any portion thereof for any term.

Local Authority—Shire of Halls Creek.

DOLA File: 2696/906.

Reserve No. 10347 (Tambellup Lots 104 and 379) vested in the Minister for Western Australian Government Railways for the designated purpose of "Railway".

Local Authority—Shire of Tambellup.

DOLA File: 573/994.

Reserve No. 43029 (Cockburn Sound Location 4094) vested in the City of Mandurah for the designated purpose of "Drainage"

DOLA File: 2294/988.

Reserve No. 41193 (Jandakot Agricultural Area Lot 649) vested in the City of Cockburn for the designated purpose of "Public Recreation".

DOLA File: 574/994.

Reserve No. 43030 (Cockburn Sound Location 4095) vested in the City of Mandurah for the designated purpose of "Drainage".

DOLA File: 923/976.

Reserve No. 36340 (Canning Locations 3150 and 3872) vested in the City of Gosnells for the designated purpose of "Drain".

DOLA File: 414/994.

Reserve No. 43023 (Jandakot Agricultural Area Lots 656 and 657) vested in the City of Cockburn for the designated purpose of "Public Recreation and Drainage".

DOLA File: 644/994.

Reserve No. 43042 (Avon Location 29108) vested in the Shire of Toodyay for the designated purpose of "Public Recreation".

DOLA File: 626/994.

Reserve No. 43041 (Plantagenet Location 7758) vested in the Town of Albany for the designated purpose of "Public Recreation".

DOLA File: 610/994.

Reserve No. 43052 (Canning Location 3875) vested in the City of Gosnells for the designated purpose of "Public Recreation".

DOLA File: 2134/974.

Reserve No. 34179 (Canning Locations 2815 and 3879) vested in the City of Gosnells for the designated purpose of "Public Recreation".

DOLA File: 647/994.

Reserve No. 43051 (Canning Location 3882) vested in the City of Gosnells for the designated purpose of "Public Recreation".

DOLA File: 1384/991.

Reserve No. 43050 (Canning Location 3873) vested in the City of Gosnells for the designated purpose of "Public Recreation".

DOLA File: 646/994.

Reserve No. 43049 (Canning Location 3881) vested in the City of Gosnells for the designated purpose of "Public Recreation".

DOLA File: 3257/990.

Reserve No. 41566 (Canning Locations 3707, 3874 and 3892) vested in the City of Gosnells for the designated purpose of "Public Recreation".

DOLA File: 429/994.

Reserve No. 43020 (Canning Location 3887) vested in the City of Armadale for the designated purpose of "Public Utilities Services" subject to access being available to the Service Authorities at all times.

DOLA File: 2304/993.

Reserve No. 43037 (Kwinana Lot 342) vested in the Town of Kwinana for the designated purpose of "Public Utilities Services" subject to access being available to the Service Authorities at all times.

DOLA File: 1308/991.

Reserve No. 43076 (Thadoona Location 14) vested in the Australian and Overseas Telecommunications Corporation Limited for the designated purpose of "Regenerator Site".

Local Authority—Shire of Meekatharra.

DOLA File: 603/990.

Reserve No. 41332 (Bunbury Lot 711) vested in the Minister for Education for "Educational Purposes" with power, to lease the whole or any portion thereof for any term.

Local Authority—City of Bunbury.

M. C. WAUCHOPE, Clerk of the Council.

LA202

LAND ACT 1933
ORDERS IN COUNCIL
(Revocation of Vestings)

By the direction of His Excellency the Governor under section 34B (1), the following Orders in Council and associated Vestings Orders are revoked.

DOLA File: 2699/982.

Order in Council gazetted on 2 June 1992 vesting Reserve No. 37980 (Newman Lot 990) in St. John Ambulance Australia WA Ambulance Service Inc for the designated purpose of "Ambulance Depot".

Local Authority—Shire of East Pilbara.

DOLA File: 1955/894.

Order in Council gazetted on 16 December 1988 vesting Reserve No. 594 (Fremantle Lots 313, 314, 315, 316, 341, 343, 344, 345, 1937, 1954 and 1955) in the Minister for Works for the designated purpose of "Historic Buildings and Park".

Local Authority—City of Fremantle.

DOLA File: 2769/987.

Order in Council gazetted on 5 January 1990 vesting Reserve No. 41169 (Lyons Locations 5, 6 and 7) in The State Energy Commission of Western Australia for "Natural Gas Pipeline Purposes".

Local Authority—Shire of Upper Gascoyne.

DOLA File: 2928/989.

Order in Council gazetted on 10 March 1967 vesting Reserve No. 28459 in the Town of Kalgoorlie for the designated purpose of "Recreation".

DOLA File: 2399/966.

Order in Council gazetted on 10 August 1993 vesting Reserve No. 31685 (Canning Location 3769) in the Minister for Mines for the designated purpose of "Mining Development—Laboratories".

Local Authority—City of Perth.

DOLA File: 2961/986.

Order in Council gazetted on 24 December 1986 vesting Reserve No. 39644 (Canning Location 3500) in The State Energy Commission of Western Australia for the designated purpose of "Sub Station Site".

Local Authority—Shire of Mundaring.

DOLA File: 2113/971.

Order in Council gazetted on 2 March 1973 vesting Reserve No. 31852 in the Shire of Boulder for the designated purpose of "Special Education Centre".

DOLA File: 1224/979.

Order in Council gazetted on 10 August 1990 vesting Reserve No. 36479 (Swan Location 10050) in the City of Wanneroo for the designated purpose of "Drain".

DOLA File: 3224/964.

Order in Council gazetted on 26 November 1971 vesting Reserve No. 31100 in the Shire of Northampton for the designated purpose of "Aerial Landing Ground".

DOLA File: 12125/909.

Order in Council gazetted on 26 October 1923 vesting Reserve No. 12477 in the Fremantle Municipal Council for the designated purpose of "Recreation".

DOLA File: 2904/950.

Portion of the Order in Council gazetted on 30 June 1972 vesting Reserve No. 23163 in the Minister for Community Welfare for "Community Welfare Purposes".

Local Authority—Shire of Derby/West Kimberley.

DOLA File: 874/977.

Order in Council gazetted on 14 October 1977 vesting Reserve No. 34953 in the Honourable Richard Charles Old M.L.A. the Minister for Agriculture for the time being and his successors in office for the designated purpose of "Depot Site".

Local Authority—Shire of Derby/West Kimberley.

DOLA File: 3158/913.

Order in Council gazetted on 23 January 1914 vesting Reserve No. 15178 in the Honourable the Minister for Water Supply, Sewerage and Drainage for the designated purpose of "Water".

Local Authority—City of Bayswater.

DOLA File: 2696/906.

Order in Council gazetted on 24 August 1906 vesting Reserve No. 10347 (Tambellup Lot 104) in the Minister for Railways for the designated purpose of "Railway".

Local Authority—Shire of Tambellup.

DOLA File: 923/976.

Order in Council gazetted on 29 September 1989 vesting Reserve No. 36340 (Canning Location 3150) in the City of Gosnells for the designated purpose of "Drain".

DOLA File: 2134/974.

Order in Council gazetted on 23 May 1980 vesting Reserve No. 34179 in the City of Gosnells for the designated purpose of "Public Recreation".

DOLA File: 3257/990.

Order in Council gazetted on 26 April 1991 vesting Reserve No. 41566 (Canning Location 3707) in the City of Gosnells for the designated purpose of "Public Recreation".

M. C. WAUCHOPE, Clerk of the Council.

LA401

Commonwealth of Australia
TERRITORY OF CHRISTMAS ISLAND LAND ACT 1933 (WA)(CI)
VESTING OF RESERVES

By the direction of The Minister for Lands under Section 33(2), the following reserves have been vested.

DOLA File: 1144/993.

Reserve No. 43028 (Christmas Location 135) vested in the Shire of Christmas Island for the designated purpose of "Recreation".

DOLA File: 1142/993.

Reserve No. 43027 (Christmas Location 85) vested in the Shire of Christmas Island for the designated purpose of "Recreation—Childrens Playground".

A. A. SKINNER, Chief Executive.

LA402

LAND ACT 1933
AMENDMENT OF BOUNDARIES
FREMANTLE TOWNSITE

DOLA File: 7220/896V2.

His Excellency the Governor in Executive Council has been pleased to approve, under Section 10 of the Land Act 1933 of the amendment of the boundaries of Townsite to include the area described in the Schedules hereunder.

Schedule

The land now included in Land Administration Reserve Plan 411.

Public Plan: BG34 (2) 07.11.

WEST TOODYAY TOWNSITE

DOLA File: 2210/977.

His Excellency the Governor in Executive Council has been pleased to approve, under Section 10 of the Land Act 1933 of the amendment of the boundaries of West Toodyay Townsite to include the area described in the Schedule hereunder.

Schedule

All that portion of land comprising Coondle Suburban Area Lot 77 as surveyed and shown on Land Administration Plan Avon 441.

Public Plans: BH35 (2) 07.32 and 07.33.

NARNGULU TOWNSITE

DOLA File: 3133/900V4.

His Excellency the Governor in Executive Council has been pleased to approve, under Section 10 of the Land Act 1933 of the amendment of the boundaries of Narngulu Townsite to include Narngulu Lot 101 on Land Administration Diagram 91415.

Public Plans: BE43 (2) 20.10 and 20.11.

A. A. SKINNER, Chief Executive.

LA403

LAND ACT 1933

DECLARATION THAT PART 1A DOES NOT APPLY

I declare under Section 27H of the Land Act 1933 that Part 1A of the Act does not apply to the following proposals affecting the land specified.

Proposal	Land	DOLA File
Sale—Section 118A(2)	Portion of Clackline Toodyay Road shown in the first schedule at page 100 for inclusion into Certificate of Title Volume 942 Folio 162	1946/1990
Sale—Section 118A(2)	Portion of Clackline Toodyay Road shown in the first schedule at page 102 for inclusion into Certificate of Title Volume 1690 Folio 761	1946/1990
Sale—Section 118A(3)	Portion of Ravenswood Road shown coloured green at folio 186 for inclusion into Certificate of Title Volume 1792 Folio 515	2662/1980
Sale—Section 118A(3)	Portion of Ravenswood Road shown coloured green at folio 189 for inclusion into Certificate of Title Volume 1839 Folio 344	2662/1980
Reservation— (i) Reserve No. 34894 (“Recreation—Golf Course” with vesting) (ii) Reserve No. 42653 (“Public Recreation”)	All those portions of Chapman and James Streets now comprised in Dunsborough Lots 273 and 274 as shown on Crown Survey Plan 18518	2778/9770
Declaration of Public Street—Section 288 of the Local Government Act	Albany Highway (Road No. 122). All that portion of land comprised in the Certificate of Title Volume 1503 Folio 182	1432/994
Reservation as “Asbestos Disposal Site” with vesting.	Victoria Location 11973	1703/992
Reservation for “Public Recreation and Drainage” with vesting.	Victoria Location 10996 (Reserve 29272)	1119/967
Amendment of purpose to “Recreation and Foreshore Management” with vesting.	Guildford Lot 186 (Reserve 1091)	2101/976
Amend classification to “C” Class	and	
Sale—Section 118CA	Guildford Lot 234 (Reserve 261) Whole of the Pedestrian Accessway as delineated and shown on Office of Titles Diagram 46114	1715/992
Reservation for “Drainage” and sale (Section 45B)	Closed Road and Vacant Crown Land	1057/975
Reservation—“Caravan Park”—Vested	Yalgoo Lot 200	1367/971
Widening of Woodenbillup Road in the Shire of Kojonup.	Portion of vacant Crown land containing 9900m ² on Diagram 90727.	1575/1990

Proposal	Land	DOLA File
Lease Under the Land Act	Land detailed at folios 2 & 3 of DOLA File.	1264/994
Sale	Coolgardie Lot 2254	1670/993
Sale	Coolgardie Lot 1114	1107/994
Sale—118CA	Experance Lot 858	947/971
Lease	Doodlakine Sub Lot 213 (formerly Sub Lot 79)	2234/993
Freehold (Section 38)	Jurien Lot 1051	2809/989
Freehold (Section 38)	Cervantes Lot 770	436/991
Freehold (Section 38)	Cervantes Lot 776	433/991
Freehold (Section 38)	Cervantes Lot 745	463/991
Freehold (Section 38)	Cervantes Lot 773	430/991
Freehold (Section 38)	Bremer Bay Lot 674	3639/990
Freehold (Section 117AA)	Boulder Lot 3957	3551/986
Freehold (War Service Land Settlement Scheme Act)	Hay Location 2086	3731/958
Freehold (Section 29(2))	Yealering Lot 85	1329/913
Freehold (Section 29(2))	Dumbleyung Lot 185	1293/913
Freehold (Section 29(2))	Dudinin Lot 66	9701/913
Freehold (Section 29(2))	Toolibin Lot 67	1505/914
Freehold (Section 29(2))	Yoting Lot 34	9121/919
Freehold (Section 29(2))	Bullaring Lot 65	1709/919
Freehold (Section 29(2))	Harrismith Lot 36	1710/919
Lease (Section 117) for "Agriculture"	Wongan Hills Lot 241	3441/964v2
Lease (Section 117) for "Residence & Storage of Mining Equipment"	Boulder Lot 4565	1710/982
Lease (Section 116) for "Telecommunication Purposes"	Canning Location 3798	1377/993
Lease (Section 117) for "Emu Farm"	Wyndham Lots 1281, 1282 and 1283.	2031/1993
Lease (Section 117) for "Telecom Exchange"	Broome Lot 3066	798/1989
Sale Under Section 45B of the Land Act	Karratha Lot 1497	707/977
Excise a portion and sellit to the adjoining owner Kalamunda under Land Act Section 118CA	Portion Reserve 40367 at Kalamunda	2323/987
East Perth Redevelopment Scheme	All the Crown land within the area described in Schedule 1 of the East Perth Redevelopment Act 1991 as shown on Plan No. 1 held at the office of the East Perth Redevelopment Authority.	1226/985

GEORGE CASH, Minister for Lands.

LA404

LAND ACT 1933 NAMING OF ROADS

It is hereby notified for general information that His Excellency the Governor has been pleased to approve under Section 10 of the Land Act 1933, of the naming of the following:—

Shire of Beverley

DOLA File: 3437/981.

RICHARDS ROAD as coloured pink on page 53.

Shire of Mundaring

DOLA File: 1196/971.

MAGEE PLACE as coloured pink at page 180.

TREE GLEN as coloured yellow at page 176.

A. A. SKINNER, Chief Executive,
Department of Land Administration.

LA405

LOCAL GOVERNMENT ACT 1960
DECLARATION OF CLOSURE OF STREETS

Made by the Minister for Lands Under Section 288A

At the request of the local government nominated, the street described in the Schedule is declared to be closed.

Schedule
City of Mandurah

DOLA File: 94/911 V2; Closure No. M1357.

All that portion of Arnold Street as shown bordered blue on Crown Survey Diagram 91652.

Public Plan: BG32(2) 6.40 and 7.40.

A. A. SKINNER, Chief Executive,
Department of Land Administration.

LA701

LAND ACT 1933
RESERVATION NOTICES

Made by His Excellency the Governor under Section 29

The Crown Lands described below have been set apart as public reserves.

DOLA File: 844/994.

Reserve No. 43038 comprising Cockburn Sound Location 4086 with an area of 200 square metres on Land Administration Diagram 91566 for the designated purpose of "Exchange Site".

Public Plan: BG32 92) 07.38. Broun Road.

Local Authority—City of Mandurah.

DOLA File: 2331/993.

Reserve No. 43063 comprising Victoria Location 11977 with an area of 24.9236 hectares on Land Administration Plan 18480 for the designated purpose of "Recreation".

Public Plans: Mingenew T/S and Mingenew SE (25). Mingenew-Morawa Road.

Local Authority—Shire of Mingenew.

DOLA File: 2543/993.

Reserve No. 43045 comprising Camballin Lot 46 with an area of 961 square metres on Land Administration Plan 9097 for the designated purpose of "Use and Requirements of the Government Employees Housing Authority".

Public Plan: Camballin Townsite. Coleman Street.

Local Authority—Shire of Derby/West Kimberley.

DOLA File: 1201/950.

Reserve No. 43040 comprising Melbourne Location 4133 with an area of 910 square metres on Land Administration Diagram 90295 for the designated purpose of "Use and Requirements of the Water Authority of Western Australia".

Public Plan: Bindi Bindi NW (25). Near Great Northern Highway.

Local Authority—Shire of Moora.

DOLA File: 624/991.

Reserve No. 43039 comprising Williams Location 15792 with an area of 2968 square metres on Land Administration Diagram 89955 for the designated purpose of "Radio Mast Site".

Public Plan: Woyerling SE (25). Kerruish Road.

Local Authority—Shire of Wickepin.

DOLA File: 2083/993.

Reserve No. 43024 comprising Kambalda Lots 334 and 360 with an area of 1477 square metres on Land Administration Plan 11628 for the designated purpose of "Pedestrian Accessway".

Public Plan: CG36 (2) 1.27. New Compton Street and Gordon Adams Road.

Local Authority—Shire of Coolgardie.

DOLA File: 2252/991.

Reserve No. 43043 comprising Busselton Lot 430 with an area of 2635 square metres on Land Administration Diagram 91401 for the designated purpose of "Family and Health Centre".

Public Plan: BF29 (2) 24.36. Kent Street.

Local Authority—Shire of Busselton.

DOLA File: 2666/961.

Reserve No. 42963 comprising Kununurra Lots 116, 123, 143 and 161 with an area of 3791 square metres on Land Administration Plans 8699 and 9168 for the designated purpose of "Use and Requirements of the Commissioner of Main Roads".

Public Plan: DH79 (2) 23.17 Nutwood Crescent, Rosewood Avenue and Leichhardt Street.

Local Authority—Shire of Wyndham-East Kimberley.

DOLA File: 4328/948.

Reserve No. 43053 comprising Wyalkatchem Lot 238 with an area of 2.4888 hectares on Land Administration Diagram 50264 for the designated purpose of "Horse Paddocks".

Public Plan: BJ36 (2) 23.32. Lehmann Street.

Local Authority—Shire of Wyalkatchem.

DOLA File: 565/991.

Reserve No. 43004 comprising Fitzroy Crossing Lots 302 and 303 with an area of 1615 square metres on Land Administration Plan 17694 for the designated purpose of "Use and Requirements of the Government Employees Housing Authority".

Public Plan: CN72 (2) 10.27. Sadler Place.

Local Authority—Shire of Derby/West Kimberley.

DOLA File: 1654/1993

Reserve No. 43059 comprising Stirling Estate Lot 280 with an area of 264.6417 hectares on Land Administration Plan 18442 for the designated purpose of "National Park".

Public Plan: BF30 (10) 8.3 & 8.4.

Local Authority—Shire of Capel.

Reserve 43059 is automatically vested in the National Parks and Nature Conservation Authority pursuant to Section 7 of CALM Act 1984.

DOLA File: 2552/993.

Reserve No. 43056 comprising Nelson Location 13429 with an area of 8.6397 hectares on Land Administration Plan 18206 for the designated purpose of "Conservation of Flora and Fauna".

Public Plan: BG27 (2) 29.34. Eastbrook Road.

Local Authority—Shire of Manjimup.

Reserve 43056 is automatically vested in the National Parks and Nature Conservation Authority pursuant to Section 7 of CALM Act 1984.

DOLA File: 2098/993.

Reserve No. 43067 comprising Peel Estate Lot 1385 with an area of 2.5891 hectares on Land Administration Diagram 91510 for the designated purpose of "Drainage".

Public Plans: BG33 (10) 3.6 and 4.6. King Road.

Local Authority—Shire of Serpentine-Jarrahdale.

DOLA File: 874/993.

Reserve No. 43065 comprising Swan Location 11928 with an area of 1.0075 hectares on Land Administration Diagram 91264 for the designated purpose of "Park and Public Utilities Services".

Public Plans: BG34 (2) 21.29 and 21.30. Bushmead Road.

Local Authority—Shire of Swan.

DOLA File: 2547/993.

Reserve No. 43062 comprising Bencubbin Lot 277 with an area of 916 square metres on Land Administration Diagram 91313 for the designated purpose of "Use and Requirements of the Government Employees Housing Authority".

Public Plans: BK37 (2) 12.31 and 12.32. Hopwood Street.

Local Authority—Shire of Mount Marshall.

DOLA File: 2027/993.

Reserve No. 43055 comprising Swan Location 11947 with an area of 18 square metres on Land Administration Diagram 91505 for the designated purpose of "Padmount Site".

Public Plan: BG34 (2) 08.40. Walter Padbury Boulevard.

Local Authority—City of Wanneroo.

DOLA File: 507/991.

Reserve No. 43061 comprising Yurabi Location 86 with an area of 611.6942 hectares on Land Administration Diagram 90425 for the designated purpose of "Use and Benefit of Aboriginal Inhabitants".

Public Plan: Mt Ramsay (250).

Local Authority—Shire of Halls Creek.

DOLA File: 2306/993.

Reserve No. 43081 comprising Narrogin Lot 1343 with an area of 893 square metres on Land Administration Plan 5878 for the designated purpose of "Use and Requirements of the Minister for Works".

Public Plan: BJ31 (2) 11.37. Fox Street.

Local Authority—Town of Narrogin.

DOLA File: 623/994.

Reserve No. 43078 comprising Victoria Location 11982 with an area of about 268 hectares on Land Administration Miscellaneous Plan 1854 for the designated purpose of "Parkland, Recreation and the letting of cottages existing thereon on 14 February 1994.

Public Plans: Beharra and Mount Lefroy (50).

Local Authority—Shire of Irwin.

DOLA File: 2123/991.

Reserve No. 43079 comprising Narngulu Lot 101 with an area of 4167 square metres on Land Administration Diagram 91415 for the designated purpose of "Use and Requirements of the Minister for Works".

Public Plans: BE43 (2) 20.10 and 20.11. Geraldton-Walkaway Road.

Local Authority—Shire of Greenough.

DOLA File: 573/994.

Reserve No. 43029 comprising Cockburn Sound Location 4094 (formerly portion of Cockburn Sound Location 16 and being Lot 380 on Plan 19181) with an area of 2801 square metres for the designated purpose of "Drainage"

Public Plan: BG32 (2) 07.39. Steerforth Drive.

Local Authority—City of Mandurah.

DOLA File: 574/994.

Reserve No. 43030 comprising Cockburn Sound Location 4095 (formerly portion of Cockburn Sound Location 16 and being Lot 310 on Plan 19180) with an area of 722 square metres for the designated purpose of "Drainage"

Public Plan: BG32 (2) 07.39. Casula Avenue.

Local Authority—City of Mandurah.

DOLA File: 414/994.

Reserve No. 43023 comprising Jandakot Agricultural Area Lots 656 and 657 (formerly portions of Jandakot Agricultural Area Lot 221 and being Lots 1240, 1241 and 1251 on Plans 18634, 19338 and 19340 respectively) with an area of 4.3970 hectares for the designated purpose of "Public Recreation and Drainage".

Section 20A.

Public Plan: BG34 (10) 3.1. Tapper Road.

Local Authority—City of Cockburn.

DOLA File: 644/994.

Reserve No. 43042 comprising Avon Location 29108 (formerly portion of Avon Location U3 and being Lot 54 on Diagram 84955) with an area of 17 square metres for the designated purpose of "Public Recreation".

Section 20A.

Public Plan: BH35 (2) 08.31. Toodyay West Road.

Local Authority—Shire of Toodyay.

DOLA File: 626/994.

Reserve No. 43041 comprising Plantagenet Location 7758 (formerly portion of Plantagenet Location 43 and being Lot 504 on Plan 19045) with an area of 763 square metres for the designated purpose of "Public Recreation".

Public Plan: BK26 (2) 12.07. Hewett Rise.

Local Authority—Town of Albany.

DOLA File: 610/994.

Reserve No. 43052 comprising Canning Location 3875 (formerly portion of Canning Location 13 and being Lot 100 on Plan 19138) with an area of 6388 square metres for the designated purpose of "Public Recreation".

Section 20A.

Public Plan: BG34 (2) 21.15. Lakewook Cove.

Local Authority—City of Gosnells.

DOLA File: 647/994.

Reserve No. 43051 comprising Canning Location 3882 (formerly portion of Canning Location 16 and being Lot 66 on Plan 19308) with an area of 190 square metres for the designated purpose of "Public Recreation".

Section 20A.

Public Plan: BG34 (2) 19.10. Leatherwood Way.

Local Authority—City of Gosnells.

DOLA File: 1384/991.

Reserve No. 43050 comprising Canning Location 3873 (formerly portions of Canning Location 13 and being Lots 63 and 64 on Diagrams 80915 and 79691 respectively) with an area of 8974 square metres for the designated purpose of "Public Recreation".

Section 20A.

Public Plans: BG34 (2) 21.15 and 22.15. Near Jade Street.

Local Authority—City of Gosnells.

DOLA File: 646/994.

Reserve No. 43049 comprising Canning Location 3881 (formerly portion of Canning Location 16 and being Lot 4 on Diagram 84821) with an area of 437 square metres for the designated purpose of "Public Recreation".

Public Plan: BG34 (2) 22.12. Near Astley Street.

Local Authority—City of Gosnells.

DOLA File: 423/994.

Reserve No. 43010 comprising Swan Location 11984 (formerly portions of each of Swan Locations 91 and 1359 and being Lot 26 on Plan 15391) with an area of 22.2362 hectares for the designated purpose of "Public Recreation".

Section 20A.

Public Plans: BG35 (10) 5.4 and 5.5.

Local Authority—Shire of Swan.

DOLA File: 429/994.

Reserve No. 43020 comprising Canning Location 3887 (formerly portion of Canning Location 31 and being the land coloured brown and marked Pedestrian Access Way on Plan 8890) with an area of 248 square metres for the designated purpose of "Public Utilities Services".

Public Plan: BG34 (2) 22.05. Waltham and Winchester Roads.

Local Authority—City of Armadale.

DOLA File: 2304/993.

Reserve No. 43037 comprising Kwinana Lot 342 (formerly portion of Kwinana Lot E7 being the land coloured brown and marked Pedestrian Accessway containing an area of 265 square metres on Plan 10743) with an area of 265 square metres for the designated purpose of "Public Utilities Services".

Public Plan: BG33 (2) 11.32. Gamblin Way.

Local Authority—Town of Kwinana.

DOLA File: 1308/991.

Reserve No. 43076 comprising Thadoona Location 14 with an area of 344 square metres on Land Administration Diagram 91551 for the designated purpose of "Regenerator Site".

Public Plan: Collier (250). Great Northern Highway.

Local Authority—Shire of Meekatharra.

DOLA File: 561/1981.

Reserve No. 43060 comprising Oldfield Location 1403 with an area of 300.0902 hectares on Land Administration Original Plan 15821 for the designated purpose of "Conservation of Flora and Fauna".

Public Plan: Bandalup (50).

Local Authority—Shire of Ravensthorpe.

Reserve 43060 is automatically vested in the National Parks and Nature Conservation Authority pursuant to Section 7 of CALM Act 1984.

A. A. SKINNER, Chief Executive.

LA801**LAND ACT 1933
AMENDMENT OF RESERVES**

Made by His Excellency the Governor under Section 37

The following reserves have been amended.

DOLA File: 1599/898.

Reserve No. 5342 (Swan and Canning Districts) "Camping Ground in connection with Helena Reservoir Works" to exclude those portions now containing an area of 1046 square metres now comprised in Location 3848 as surveyed and shown bordered red on Land Administration Diagram 91445 and of its area being reduced to 133.0017 hectares accordingly.

Public Plan: BG34 (10) 7.5. Mundaring Weir Road.

Local Authority—Shire of Mundaring.

DOLA File: 94/911V2.

Reserve No. 19312 (Cockburn Sound Locations 798, 1972, 2166 and 2277) "Recreation" to exclude that portion of Location 2166 containing 3026 square metres as shown coloured mid brown on Land Administration Diagram 91652 and of its area being reduced to 5.8093 hectares accordingly.

Public Plans: BG32 (2) 6.40 and 7.40. Clarice Street.

Local Authority—City of Mandurah.

DOLA File: 3117/959.

Reserve No. 26059 (Sussex District) "Schoolsite" to comprise Busselton Lot 433 as surveyed and shown bordered pink on Land Administration Diagram 91401 in lieu of Location 4325 and of its area being reduced to 4860 square metres accordingly.

Public Plan: BF29 (2) 24.36. Kent Street.

Local Authority—Shire of Busselton.

DOLA File: 2666/961.

Reserve No. 26851 (Kununurra Lots 116, 123, 133, 161 and 162) "Housing (Main Roads Department)" to exclude Lots 116, 123 and 161 and of its area being reduced to 1907 square metres accordingly.

Public Plan: DH79 (2) 23.17. Rosewood Avenue, Leichhardt Street and Nutwood Crescent.

Local Authority—Shire of Wyndham-East Kimberley.

DOLA File: 879/988.

Reserve No. 28851 (Kununurra Lots 16, 50 and 143) "Housing (Main Roads Department)" to exclude Lot 143 and of its area being reduced to 1975 square metres accordingly.

Public Plan: DH79 (2) 23.17.

Local Authority—Shire of Wyndham-East Kimberley.

DOLA File: 2769/987.

Reserve No. 41169 (Lyons Locations 5, 6 and 7) "Natural Gas Pipeline Purposes" to include Location 46 as surveyed and shown bordered pink on Land Administration Diagram 90725 and of its area being increased to 33.9821 hectares accordingly.

Public Plan: Kennedy Range (250).

Local Authority—Shire of Upper Gascoyne.

DOLA File: 2797/969.

Reserve No. 30465 (Cockburn Sound Location 2164) "Tank Site" to exclude that portion now comprised in Location 4086 as surveyed and shown bordered pink on Land Administration Diagram 91566 and of its area being reduced to 3442 square metres accordingly.

Public Plan: BG32 (2) 07.38. Broun Road.

Local Authority—City of Mandurah.

DOLA File: 995/894.

Reserve No. 2494 (Avon District) "Water" to comprise Location 29094 as shown delineated and bordered red on Land Administration Reserve Diagram 1198 and of its area being reduced (recalculated) to 34.4213 hectares accordingly.

Public Plan: Babakin SW (25). Bruce Rock-Corrigin Road.

Local Authority—Shire of Bruce Rock.

DOLA File: 1329/987.

Reserve No. 40231 (Newman Lots 2303 and 2304) "Park" to exclude Lot 2303 and of its area being reduced to 3033 square metres accordingly.

Public Plan: BN58 (2) 15.15. Newman Drive.

Local Authority—Shire of East Pilbara.

DOLA File: 2961/986.

Reserve No. 39644 (Canning District) "Sub Station Site" to comprise Location 3848 as surveyed and shown bordered red on Land Administration Diagram 91445 in lieu of Location 3500 and of its area being increased to 2 719 square metres accordingly.

Public Plan: BG34 (10) 7.5. Mundaring Weir Road.

Local Authority—Shire of Mundaring.

DOLA File: 2699/982.

Reserve No. 37980 (Newman Lot 990) "Ambulance Depot" to include Lot 2303 as surveyed and shown bordered red on Land Administration Diagram 87982 and of its area being increased to 1406 square metres accordingly.

Public Plan: BN58 (2) 15.15. Newman Drive and Nyabalee Road.

Local Authority—Shire of East Pilbara.

DOLA File: 11764/904.

Reserve No. 9700 (Pardu, De Grey, Teano, Thaduna and Erivilla Districts) "De Grey—Peak Hill Stock Route" to exclude that portion now comprised in Thadoona Location 14 as surveyed and shown bordered red on Land Administration Diagram 91551 and of its area being reduced by 344 square metres accordingly.

Public Plans: Collier and Peak Hill (250). Great Northern Highway.

Local Authority—Shire of Meekatharra.

DOLA File: 6022/901V3.

Reserve No. 10513 (Kaluwiri Location 84) "Common" to exclude that portion now comprised in Location 94 as surveyed and shown bordered green on Land Administration Diagram 91580 and of its area being reduced to 20,069.6215 hectares accordingly.

Public Plan: Sir Samuel (250).

Local Authority—Shire of Leonora.

DOLA File: 3257/990.

Reserve No. 41566 (Canning Location 3707) "Public Recreation" to include Locations 3874 and 3892 (formerly portions of Canning Location 16 and being Lots 592 and 753 on Plan 19306 and Diagram 84796 respectively) and of its area being increased to 7328 square metres accordingly.

Public Plans: BG34 (2) 22.14 and 22.15. Peace Court and Kirin Way.

Local Authority—City of Gosnells.

DOLA File: 2134/974.

Reserve No. 34179 (Canning Location 2815) "Public Recreation" to include Location 3879 (formerly portion of Canning Location 19 and being Lot 501 on Diagram 84116) and of its area being increased to 7744 square metres accordingly.

Public Plan: BG34 (2) 19.15. Latimer Way.

Local Authority—City of Gosnells.

DOLA File: 923/976.

Reserve No. 36340 (Canning Location 3150) "Drain" to include Location 3872 (formerly portion of Canning Location 15 and being Lot 202 on Diagram 83612) and of its area being increased to 6162 hectares accordingly.

Public Plan: BG34 (2) 22.13. Station Street.

Local Authority—City of Gosnells.

DOLA File: 2294/988.

Reserve No. 41193 (Jandakot Agricultural Area) "Public Recreation" to comprise Lot 649 as surveyed and shown bordered red on Land Administration Diagram 91507 (portion formerly Lots 939 and 897 on Plan 17748) in lieu of Lot 610 and of its area being increased to 3.2072 hectares accordingly.

Public Plan: BG34 (2) 13.10. Casserley Drive.

Local Authority—City of Cockburn.

DOLA File: 2696/906.

Reserve No. 10347 (Tambellup Lot 104) "Railway" to include Lot 379 as surveyed and shown bordered pink on Land Administration Diagram 90279 and of its area being increased to 7018 square metres accordingly.

Public Plan: BJ28 (2) 37.34. Norrish Street.

Local Authority—Shire of Tambellup.

DOLA File: 711/975.

Reserve No. 34313 (Canning Locations 2849 and 2887) "Public Recreation" to exclude Location 2849 and that portion of Location 2887 as surveyed and shown bordered green on Land Administration Diagram 91409 and of its area being reduced to 859 square metres accordingly.

Public Plan: BG34 (2) 27.22. Near Aldersyde Road.

Local Authority—Shire of Kalamunda.

DOLA File: 5153/948V8.

Reserve No. 24496 (Victoria Locations 3940, 9947, 10200, 11295 and 11928) "Protection of Flora" to exclude that portion containing about 134 hectares as shown on Land Administration Miscellaneous Plan 1854 and of its area being reduced to about 69024.0215 hectares accordingly.

Public Plans: BE40(2) 37.33, (10) 8.1 and 8.2, Beagle Island, Logue and Mount Lefroy (50) and Dongara NE & SE (25).

Local Authority—Shires of Carnamah, Dandaragan, Irwin and Coorow.

DOLA File: 3007/916V2.

Reserve No. 16670 (Kyarra District) "Use and Benefit of Aborigines" to comprise Location 194 as shown delineated and bordered red on Land Administration Reserve Diagram 1252 and of its area being reduced (recalculated) to 4246.9858 hectares accordingly.

Public Plan: Belele (250). Wilgie Mia Road.

Local Authority—Shire of Cue.

DOLA File: 5743/951

Reserve No. 23938 (Narrogin Lots 1343, 1397, 1428 and 1446) "Railway Purposes (Housing)" to exclude Lot 1343 and of its area being reduced to 2777 square metres accordingly.

Public Plan: BJ31 (2) 11.37. Fox and Northwood Streets.

Local Authority—Town of Narrogin.

DOLA File: 3567/976V2.

Reserve No. 34503 (Wellington Locations 5224 and 5276) "Public Recreation" to exclude Location 5276 and of its area being reduced to 1725 square metres accordingly.

Public Plans: BG30 (2) 5.34 and 6.34. Mayne Way.

Local Authority—Shire of Harvey.

DOLA File: 2277/959V3.

Reserve No. 25412 (at Dongara) "Caravan Park" to comprise Lot 94 as surveyed and shown bordered pink on Land Administration Diagram 91394 in lieu of Lot 59 and of its area being reduced to 1.9466 hectares accordingly.

Public Plans: BE42 (2) 34.02 and 34.03. Church Street.

Local Authority—Shire of Irwin.

DOLA File: 3406/980.

Reserve No. 38046 (Dongara Lots 66 and 78) "Protection of Foreshore" to:—

- (i) exclude that portion containing 2591 square metres now comprised in Lot 94 as shown bordered pink on Land Administration Diagram 91394 and
- (ii) include Lot 93 as surveyed and shown bordered pink on Land Administration Diagram 91394 and of its area being increased to about 4.6243 hectares accordingly.

Public Plan: BE43 (2) 34.02 and 34.03. Church Street.

Local Authority—Shire of Irwin.

DOLA File: 3041/923.

Reserve No. 18746 (Bencubbin Lot 129) "Police" to exclude that portion now comprised in Lot 277 as surveyed and shown bordered green on Land Administration Diagram 91313 and of its area being reduced to 5296 square metres accordingly.

Public Plans: BK37 (2) 12.31 and 12.32. Hammond Street.

Local Authority—Shire of Mount Marshall.

DOLA File: 12125/909.

Reserve No. 12477 (Fremantle Townsite and Cockburn Sound District) "Recreation" to comprise Fremantle Lot 2091 as shown delineated and bordered red on Land Administration Reserve Plan 411 in lieu of Location 2473 and Lots 1586 and 1958 and of its area being increased to about 6.2700 hectares accordingly.

Public Plan: BG34 (2) 07.11. Marine Terrace.

Local Authority—City of Fremantle.

DOLA File: 1955/894.

Reserve No. 594 (at Fremantle) "Historic Buildings and Park" to comprise Lot 2078 as surveyed and shown bordered pink on Land Administration Diagram 90591 in lieu of Lots 313 to 316 inclusive, 341, 343 to 345 inclusive 1937, 1954 and 1955 and of its area being increased (recalculated) to 1.1158 hectares accordingly.

Public Plan: BG34 (2) 07.14. Adelaide Street.

Local Authority—City of Fremantle.

A. A. SKINNER, Chief Executive.

LA901**LAND ACT 1933****CHANGE OF PURPOSE OF RESERVES**

Made by His Excellency the Governor under Section 37

The purpose of the following reserves have been changed.

DOLA File: 2787/906.

Reserve No. 10192 (Williams Lot 101) being changed from "Gravel" to "Depot Site".

Public Plan: BH31 (2) Pt 7.5, 7.6, 8.5 and 8.6. William Street.

Local Authority—Shire of Williams.

DOLA File: 2113/971.

Reserve No. 31852 (Kalgoorlie Lot 2263) being changed from "Special Education Centre" to "Use and Requirements of the Minister for Works".

Public Plan: CF37 (2) 29.37. Wilson Street.

Local Authority—City of Kalgoorlie-Boulder.

DOLA File: 2568/989.

Reserve No. 41124 (Swan Location 11262) being changed from "Public Recreation" to "Helicopter Landing Site, Car Park and Drainage".

Public Plan: BG35 (2) 07.07. Elcar Lane.

Local Authority—City of Wanneroo.

DOLA File: 2904/950.

Reserve No. 23163 (Derby Lot 429) being changed from "Community Welfare Purposes" to "Use and Benefit of Aboriginal Inhabitants (Resource Centre)".

Public Plan: CK75 (2) 03.07. Panton Street.

Local Authority—Shire of Derby/West Kimberley.

DOLA File: 603/990.

Reserve No. 41332 (Bunbury Lot 711) being changed from "Pre Primary Centre" to "Educational Purposes".

Public Plan: BG30 (2) 2.32. Forrest Street.

Local Authority—City of Bunbury.

A. A. SKINNER, Chief Executive.

LB201**LAND ACT 1933****CANCELLATION OF RESERVES**

Made by His Excellency the Governor under Section 37

The following reserves have been cancelled.

DOLA File: 13138/911.

Reserve No. 19677 (Williams Location 14415) "Schoolsite".

Public Plan: Datatine NW (25). Peterson Road.

Local Authority—Shire of Dumbleyung.

DOLA File: 5528/897.

Reserve No. 4964 (Woodarra Town Lot 99) "Schoolsite".

Public Plan: Woodarra Townsite. Shamrock Street.

Local Authority—Shire of Leonora.

DOLA File: 1955/894.

Reserve No. 2587 (Fremantle Lots 367 and 368) "Municipal Purposes".

Public Plan: BG34 (2) 07.15. Queen Victoria Street.

Local Authority—City of Fremantle.

DOLA File: 1004/975.

Reserve No. 33316 (Leonora Lot 54) "Use and Requirements of the Minister for Works".

Public Plan: Leonora Townsite. Gwalia Street.

Local Authority—Shire of Leonora.

DOLA File: 4119/920.
Reserve No. 17607 (Avon Location 22448) "Schoolsite".
Public Plan: Kurrenkutten NE (25). Nambadilling Road.
Local Authority—Shire of Corrigin.
DOLA File: 5888/923.
Reserve No. 19018 (Lake Bidy Lots 14 and 19) "Public Utility".
Public Plan: Lake Bidy Townsite. Amery and Churchill Streets.
Local Authority—Shire of Lake Grace.
DOLA File: 20/927.
Reserve No. 19689 (Avon Location 23987) "Schoolsite".
Public Plan: Lomos SE (25). Bullaring-Pingelly Road.
Local Authority—Shire of Corrigin.
DOLA File: 9866/912.
Reserve No. 14652 (Kwobrup Lot 62) "Schoolsite".
Public Plan: Kwobrup Townsite. Wegg Street.
Local Authority—Shire of Kent.
DOLA File: 1114/938.
Reserve No. 22046 (Avon Location 25937) "School Site".
Public Plan: Brookton NE (25). Walters Road.
Local Authority—Shire of Brookton.
DOLA File: 501/945.
Reserve No. 22817 (Edjudina Location 2) "Schoolsite".
Public Plan: Edjudina (250).
Local Authority—Shire of Leonora.
DOLA File: 2558/934.
Reserve No. 21565 (Avon Location 26739) "Schoolsite".
Public Plan: Bulagin SE (25). Tammin-Wyalkatchem Road.
Local Authority—Shire of Tammin.
DOLA File: 6244/914.
Reserve No. 1854 (Bullaring Lot 64) "Schoolsite".
Public Plan: BK33 (2) Pts 03.05, 04.04, 04.05. Anderson Street.
Local Authority—Shire of Corrigin.
DOLA File: 340/938.
Reserve No. 21832 (Agnew Lot 148) "School Site".
Public Plan: Agnew Townsite.
Local Authority—Shire of Leonora.
DOLA File: 518/916.
Reserve No. 16385 (Weld District) "Schoolsite".
Public Plan: Laverton (250). Merolia Road.
Local Authority—Shire of Laverton.
DOLA File: 775/990.
Reserve No. 2437 (Victoria District) "Travelling Stock Route".
Public Plan: Tardun (50) (not charted).
Local Authority—Shire of Irwin.
DOLA File: 1224/979.
Reserve No. 36479 (Swan Location 10050) "Drain".
Public Plan: BG34 (2) 07.04.
Local Authority—City of Wanneroo.
DOLA File: 1874/990.
Reserve No. 3889 (Avon District) "Public Utility".
Public Plan: BK35 (2) 3.20 (not charted).
Local Authority—Shire of Kellerberrin.
DOLA File: 6229/900.
Reserve No. 7332 (Lawlers Town Lot 273) "Schoolsite".
Public Plan: Lawlers Townsite. Woronga Street.
Local Authority—Shire of Leonora.

- DOLA File: 4486/946.
Reserve No. 22593 (Pantapin Lot 35) "Schoolsite".
Public Plan: BJ34 (2) 39.25. Kokerbin Street.
Local Authority—Shire of Quairading.
DOLA File: 458/929.
Reserve No. 20045 (Kulja Lot 71) "Schoolsite".
Public Plan: Kulja Townsite.
Local Authority—Shire of Koorda.
DOLA File: 5435/951.
Reserve No. 23392 (Quairading Lot 250) "Railway Purposes".
Public Plan: Quairading Townsite. Avon Street.
Local Authority—Shire of Quairading.
DOLA File: 1101/990.
Reserve No. 29283 (Carnarvon Lot 1143) "Use and Requirements of the Commissioner of Main Roads".
Public Plan: AN54 (2) 8.06. Richards Street.
Local Authority—Shire of Carnarvon.
DOLA File: 7025/921.
Reserve No. 18141 (Avon Location 22741) "School Site".
Public Plan: Balkuling SE (25). Dulbelling North Road.
Local Authority—Shire of Quairading.
DOLA File: 204/935.
Reserve No. 21641 (Jilbadji Location 294) "School Site".
Public Plan: Moorine Rock (50). Irving Road.
Local Authority—Shire of Yilgarn.
DOLA File: 247/900.
Reserve No. 7301 (Kookynie Town Lot 193) "Schoolsite".
Public Plan: CF41 (2) 29.34. Champion Street.
Local Authority—Shire of Menzies.
DOLA File: 2564/927.
Reserve No. 19626 (Avon District) "Schoolsite".
Public Plan: Pikaring SE (25). Glenmore Road.
Local Authority—Shire of Corrigin.
DOLA File: 1156/929.
Reserve No. 20178 (Fitzgerald Location 1440) "Schoolsite".
Public Plan: Hanley (50). Fagan Road.
Local Authority—Shire of Esperance.
DOLA File: 3560/922.
Reserve No. 18187 (Williams Location 12784) "School Site".
Public Plan: Lake Dorothy (50).
Local Authority—Shire of Kent.
DOLA File: 1073/952.
Reserve No. 23589 (Bilbarin Lot 13) "School Quarters".
Public Plan: BK33(2) PT 16.36, 16.37, 17.36 and 17.37. Mann Street.
Local Authority—Shire of Corrigin.
DOLA File: 6192/925.
Reserve No. 19140 (Lake Biddy Lot 33) "Schoolsite".
Public Plan: BL31 (2) PT 33.27. Biddy-Camm Road.
Local Authority—Shire of Lake Grace.
DOLA File: 4575/950.
Reserve No. 23266 (Ularring Location 3) "Schoolsite".
Public Plan: Menzies (250). Mount Ida Road.
Local Authority—Shire of Menzies.
DOLA File: 2528/978.
Reserve No. 35596 (Swan Location 9863) "Use and Requirements of the Minister for Works".
Public Plan: BG34 (2) 14.27. Vale Street.
Local Authority—City of Stirling.

DOLA File: 401/973.

Reserve No. 22999 (Moora Lot 407) "Use and Requirements of the Water Authority of Western Australia".

Public Plan: BG38 (2) 21.10. Charles and Roberts Streets.

Local Authority—Shire of Moora.

DOLA File: 1885/965.

Reserve No. 25122 (Sandstone Lot 527) "Use and Requirements of the Shire of Sandstone".

Public Plan: Sandstone Townsite. Hack Street.

DOLA File: 3629/969.

Reserve No. 42971 (Southern Cross Lot 778) "Use and Requirements of the Shire of Yilgarn".

Public Plan: BM36 (2) 19.24. Antares Street.

DOLA File: 2248/992.

Reserve No. 42433 (Swan Location 11804) "Use and Requirements of the Minister for Works".

Public Plans: BG34 (2) 6.7, 6.8, 7.7 and 7.8 Stoneville Road.

Local Authority—Shire of Mundaring.

DOLA File: 9145/905.

Reserve No. 9934 (Victoria Location 4185) "Water Supply (Rabbit Department)".

Public Plan: Windinie (50).

Local Authority—Shire of Perenjori.

A. A. SKINNER, Chief Executive.

LB401

LOCAL GOVERNMENT ACT 1960 DECLARATION OF PUBLIC STREETS

Orders of the Minister for Lands Made under Section 288

At the request of the local government nominated, the portion of land specified in the Schedule is now declared to be absolutely dedicated as a public street.

Schedule

City of Mandurah

DOLA File: 94/911 V2.

Road No. 18672 (Clarice Street)(Extension). All that portion of Clarice Street as shown coloured mid brown on Crown Survey Diagram 91652.

Public Plan: BG32(2) 6.40 and 7.40.

A. A. SKINNER, Chief Executive,
Department of Land Administration.

LB701

File No. MRWA 41-25-70VC
Ex Co No. 0383

PUBLIC WORKS ACT 1902 LAND RESUMPTION

Road Widening—Albany Highway (9.22 SLK)

Notice is hereby given, and it is hereby declared, that the said piece or parcel of land described in the Schedule hereto, being all in the Canning District has, in pursuance of the written approval and consent of His Excellency the Governor, acting by and with the advice of the Executive Council, dated the 28th day of March 1994, been set apart, taken, or resumed for the purposes of the following public work, namely—Road Widening—Albany Highway—City of Canning.

And further notice is hereby given that the said piece or parcel of land so set apart, taken, or resumed are marked off and more particularly described on the Plan specified in the Schedule, which may be inspected at Main Roads Western Australia, Waterloo Crescent, East Perth. The additional information contained in the Schedule after the land descriptions is to define locality only and in no way derogates from the Transfer of Land Act description.

And it is hereby directed that the said lands shall vest in Her Majesty for an estate in fee simple in possession for the public work herein expressed, freed and discharged from all trusts, mortgages, charges, obligations, estates, interests, rights-of-way, or other easements whatsoever.

Schedule

Plan MR No.	Owner or Reputed Owner	Occupier or Reputed Occupier	Description	Area
93-58	Canning Agricultural Horticultural and Recreational Society (Inc)	Western Australian Greyhound Racing Association Lessee <i>vide</i> Lease C190543	Portion of Canning Location 5 the subject of Diagram 24185 now contained in Diagram 84345 and being part of the land comprised in Certificate of Title Volume 1793 Folio 660	90m ²

Certified correct this 23rd day of March 1994.

E. J. CHARLTON, Minister for Transport.

Dated this 28th day of March 1994.

MICHAEL JEFFERY, Governor in Executive Council.

Road Dedication

It is hereby notified that the Minister for Lands has approved, pursuant to section 288 of the Local Government Act, the dedication as public street the roads in the various Municipalities as described in the abovementioned resumption notices.

By Order of the Minister for Lands.

Dated this 14th day of June 1994.

A. A. SKINNER, Chief Executive.

LOCAL GOVERNMENT

LG401

TOWN PLANNING AND DEVELOPMENT ACT 1928

ADVERTISEMENT OF RESOLUTION DECIDING TO PREPARE A TOWN PLANNING SCHEME

Shire of Kellerberrin

Town Planning Scheme No. 2

Notice is hereby given that the Shire Council of Kellerberrin on 21 September 1993 passed the following resolution—

Resolved that the Council, in pursuance of section 7 of the Town Planning and Development Act 1928, prepare the above Town Planning Scheme with reference to an area situate wholly within the Shire of Kellerberrin and enclosed within the inner edge of a broken black border on a plan now produced to the Council and marked and certified by the Shire Clerk under his hand dated 21 September 1993 as "Scheme Area Map".

Dated this 21st day of September 1993.

N. L. MASON, Shire Clerk.

LG402

LOCAL GOVERNMENT ACT 1960

HEALTH ACT 1911

City of Subiaco

Memorandum of Imposing Rates

To Whom It May Concern.

At a special meeting of the City of Subiaco held on the 16th day of July 1993, it was resolved that the rates specified hereunder should be imposed on all rateable properties within the district of the City of Subiaco, in accordance with the Local Government Act 1960-1993 and the Health Act 1911-1993 for the year ending 30th June 1994.

Schedule of Rates

1. The General Rate be 6.69 cents in the dollar on Gross Rental Valuation.
2. In accordance with Section 550 (2) of the Local Government Act 1960-1993, a discount of 10.0% will be allowed on current rates paid in full and receipted at Council or any branch of the Commonwealth Bank on or before 4pm, Tuesday, 24 August 1993.

3. A 10.0% penalty will be levied against rates outstanding as at 31st day of January 1994. (Pensioners rates being excluded).
4. A minimum rate of \$235.00 per assessment.
5. A separate annual rubbish service charge of \$95.00 per service will be imposed against all properties utilising the Council's refuse collection service. Eligible pensioners registered with the Council will be entitled to a 50% reduction on their rubbish service charge.

Dated 19 July 1993.

H. E. PASSMORE, Mayor.
PATRICK WALKER, Chief Executive/Town Clerk.

LG403

LOCAL GOVERNMENT ACT 1960

City of Armadale

1994/95—FACILITY HIRE CHARGES

Pursuant to section 191A of the Local Government Act, notice is hereby given that Council, at its Meetings of 2 May 1994 and 7 June 1994, adopted the following facility hire charges.

A. COMMUNITY CENTRES, HALLS, PAVILIONS AND OTHER FACILITIES EFFECTIVE FROM 1 JULY 1994

1. A set rate of—

Main Hall with stage	\$5.50 per hour
Main Hall	\$4.25 per hour
Lesser Hall	\$3.75 per hour
Kitchen	\$2.00 per hour
Bar/Canteen	\$1.00 per hour
Meeting Room	\$2.00 per hour
Changerooms	\$3.00 per hour
Toilets	\$2.00 per hour
Store Room	\$2.00 per week
Office	\$2.00 per week

shall apply to all community centres, halls, pavilions and other facilities, excluding the Minnowarra Park School and Church buildings, available for hire from Council.

N.B. Hirings of main and lesser halls, kitchen, bar/canteen and meeting room facilities shall also include the separate toilets hourly hire rate.

2. A discount structure of 35% to the set rates referred to in (1) above shall apply to the Bedfordale, Karragullen and Forrestdale Halls, and Creyk Park Pavilion.

N.B. This discount does not apply in conjunction with any other discount.

3. Playgroups, Scouts, Brownies and Guides shall be charged at 50% of the set rates referred to in (1) above.

4. Commercial or non-community association users shall be charged at a surcharge of 100% of the set rates referred to in (1) above.

5. The following policy for the Control of Keys shall apply—

- (a) for casual users of facilities without caretakers, a deposit of \$100 per hire per set of keys;
- (b) for regular users a desposit of \$100 per set of keys;
- (c) for seasonal bookings all keys are to be returned at the end of each period booked.

6. A Bond of \$100.00 shall be charged for regular hall hirers with a 100% surcharge on occasional hire and hire of change rooms.

B. GRASS SURFACE RESERVES SEASONAL HIRE RATES EFFECTIVE FROM 1 OCTOBER 1994

Sport	Senior Team	Junior Team
Football	\$655.00	\$112.00
Rugby Union	\$546.00	\$94.00
Rugby League	\$473.00	\$81.00
Touch Football	\$255.00	\$44.00
Soccer	\$400.00	\$69.00
Cricket	\$572.00	\$92.00
Hockey	\$343.00	\$69.00
Softball	\$281.00	\$56.00

B. Grass Surface Reserves—*continued*

Sport	Senior Team	Junior Team
Baseball	\$281.00	\$56.00
T-Ball	N/A	\$28.00
Minkey Hockey	N/A	\$6.00
Kanga Cricket	N/A	\$2.00 per head
Little Athletics	N/A	\$6.00 per head
Netball/Basketball (Hardcourt)	\$35.00	\$7.00

R. C. STUBBS, Mayor.
J. W. FLATOW, City Manager/Town Clerk.

PLANNING AND URBAN DEVELOPMENT

PD401

TOWN PLANNING AND DEVELOPMENT ACT 1928
APPROVED TOWN PLANNING SCHEME AMENDMENT
City of Bayswater

Town Planning Scheme No. 21—Amendment No. 47

Ref: 853/2/14/25 Pt 47.

It is hereby notified for public information, in accordance with Section 7 of the Town Planning and Development Act, 1928 (as amended) that the Hon Minister for Planning approved the City of Bayswater Town Planning Scheme Amendment on June 5, 1994 for the purpose of rezoning Lot 38 No. 312 Walter Road, Morley from "Residential R17.5" to "Office" in accordance with the Scheme (Amendment) Map.

J. B. D'ORAZIO, Mayor.
M. J. CAROSELLA, Town Clerk.

PD402

TOWN PLANNING AND DEVELOPMENT ACT 1928
APPROVED TOWN PLANNING SCHEME AMENDMENT
City of Belmont

Town Planning Scheme No. 11—Amendment No. 53

Ref: 853/2/15/10 Pt 53.

It is hereby notified for public information, in accordance with Section 7 of the Town Planning and Development Act, 1928 (as amended) that the Hon Minister for Planning approved the City of Belmont Town Planning Scheme Amendment on June 5, 1994 for the purpose of amending the Scheme Map by excluding from the "Parks and Recreation" Reserve and including in the "Residential A" zone R20/R40, the following lots—

1. Lot 1 Elizabeth Street
2. Reserve 33702 Belmont Avenue
3. Reserve 31134 (excluding former Lot 36 Diagram 43728, 1217m² fronting the unmade portion of Robinson Avenue).

P. PASSERI, Mayor.
B. R. GENONI, Town Clerk.

PD403

TOWN PLANNING AND DEVELOPMENT ACT 1928
APPROVED TOWN PLANNING SCHEME AMENDMENT
City of Bunbury

Town Planning Scheme No. 6—Amendment No. 157

Ref: 853/6/2/9, Pt. 157.

It is hereby notified for public information, in accordance with section 7 of the Town Planning and Development Act 1928 that the Hon Minister for Planning approved the City of Bunbury Town Planning Scheme Amendment on 5 June 1994 for the purpose of rezoning the portion of land, being 4 510 m², in the vicinity of the Back Beach Kiosk and Surf Club in Ocean Drive, Bunbury as follows—

- (i) Part of Reserve "A" 9997 and "C" 18574 adjoining the Back Beach Kiosk and Surf Club from Park, Recreation and Drainage (unrestricted) to Special Use "Public Entertainment."

- (ii) Part of the Ocean Drive Road Reserve in the vicinity of the Bunbury Back Beach Kiosk and Surf Club buildings from Road Reserve to Special Use "Public Entertainment".
- (iii) Amending the Scheme Text by inserting into "Appendix IV—First Schedule; Special Uses" the following—

Description of Land	Permitted Uses	Development Conditions
Part of "A" Reserve 9997 and "C" 18574 Ocean Drive	Public Entertainment Tourist Facilities Recreation Facilities Convention Facilities Public Assembly Kiosk/Restaurant Surf Club Public Ablutions Related beach facilities to the above activities	Refer Scheme Provisions and subject to Council's discretion dependent on type of development

E. C. MANEA, Mayor.
G. P. BRENNAN, Town Clerk.

PD404

TOWN PLANNING AND DEVELOPMENT ACT 1928
APPROVED TOWN PLANNING SCHEME AMENDMENT

City of Bunbury

Town Planning Scheme No. 6—Amendment No. 153

Ref: 853/6/2/9 Pt 153.

It is hereby notified for public information, in accordance with Section 7 of the Town Planning and Development Act 1928 (as amended) that the Hon Minister for Planning approved the City of Bunbury Town Planning Scheme Amendment on June 5, 1994 for the purpose of rezoning portion of Lot 9 Elizabeth Crescent, Bunbury from 'Parks, Recreation and Drainage' to 'Residential R15'.

E. C. MANEA, Mayor.
G. P. BRENNAN, Town Clerk.

PD405

TOWN PLANNING AND DEVELOPMENT ACT 1928
SCHEME AMENDMENT AVAILABLE FOR INSPECTION

City of Canning

Town Planning Scheme No. 40—Amendment No. 9

Ref: 853/2/16/44 Pt 9.

Notice is hereby given that the City of Canning has prepared the abovementioned scheme amendment for the purpose of introducing a new Use Class of "Convenience Store".

Plans and documents setting out and explaining the scheme amendment have been deposited at Council Offices, 1317 Albany Highway, Cannington and at the State Planning Commission/ Department of Planning and Urban Development, Albert Facey House, 469-489 Wellington Street, Perth, and will be available for inspection during office hours up to and including July 26, 1994.

Submissions on the scheme amendment should be made in writing on Form No. 4 and lodged with the undersigned on or before July 26, 1994.

This amendment is available for inspection in order to provide an opportunity for public comment and it should not be construed that final approval will be granted.

I. F. KINNER, Town Clerk.

PD406

TOWN PLANNING AND DEVELOPMENT ACT 1928
APPROVED TOWN PLANNING SCHEME AMENDMENT

City of Cockburn

Town Planning Scheme No. 2—Amendment No. 84

Ref: 853/2/23/19 Pt 84.

It is hereby notified for public information, in accordance with Section 7 of the Town Planning and Development Act 1928 (as amended) that the Hon Minister for Planning approved the City of Cockburn Town Planning Scheme Amendment on June 5, 1994 for the purpose of—

1. Rezone portion of Lot 6, Lots 7 to 10 (Pt Cockburn Sound Loc 451) Watson Road, Yangebup, Lots 21 to 24 and Pt Lot 5 (Pt Cockburn Sound Loc 451) East Churchill Avenue, Yangebup, portion of Pt Lot 28 and Lot 29 (Pt Cockburn Sound Loc 451) Birchley Road, Yangebup, together with a portion of the Birchley Road reserve from Rural zone to Residential zone as depicted on the Scheme (Amendment) Map.
2. Rezone portion of Pt Lot 4 (Pt Cockburn Sound Loc 451) Yangebup Road, Yangebup from Council Use zone to Residential zone as depicted on the Scheme (Amendment) Map.
3. Rezone portion of Lot 6 (Pt Cockburn Sound Loc 451) Watson Road, Yangebup from Important Regional Road reserve to Residential zone as depicted on the Scheme (Amendment) Map.
4. Rezone portion of Pt Lot 4 (Pt Cockburn Sound Loc 451) Yangebup Road, Yangebup from Important Regional Road reserve to Residential zone as depicted on the Scheme (Amendment) Map.
5. Rezone portion of Pt Lot 4 (Pt Cockburn Sound Loc 451) Yangebup Road, Yangebup from Council Use zone to Important Regional Road reserve as depicted on the Scheme (Amendment) Map.

R. A. LEES, Mayor.
R. W. BROWN, Town Clerk.

PD407

TOWN PLANNING AND DEVELOPMENT ACT 1928
APPROVED TOWN PLANNING SCHEME AMENDMENT

City of Gosnells

Town Planning Scheme No. 1—Amendment No. 415

Ref: 853/2/25/1, Pt. 415.

It is hereby notified for public information, in accordance with section 7 of the Town Planning and Development Act 1928 that the Hon Minister for Planning approved the City of Gosnells Town Planning Scheme Amendment on 5 June 1994 for the purpose of rezoning Lot 196 Wheatley Street, Gosnells from "Residential A" to "Residential A—Additional Use: Office".

O. SEARLE, Mayor.
G. N. WHITELEY, Town Clerk.

PD408

TOWN PLANNING AND DEVELOPMENT ACT 1928
TOWN PLANNING SCHEME AVAILABLE FOR INSPECTION

City of Mandurah

Town Planning Scheme No. 4—Port Bouvard Waterway Management Scheme

Ref: 853/6/13/13.

Notice is hereby given that the City of Mandurah has prepared the abovementioned town planning scheme for the purpose of providing for the management of the Waterways contained within the Port Bouvard Estate.

Plans and documents setting out and explaining the town planning scheme have been deposited at Council Offices, Mandurah Terrace, Mandurah and at the State Planning Commission/Department of Planning and Urban Development, Albert Facey House, 469-489 Wellington Street, Perth, and will be available for inspection during office hours up to and including 9 August 1994.

Submissions on the town planning scheme should be made in writing on Form No. 4 and lodged with the undersigned on or before 9 August 1994.

S. K. GOODE, Town Clerk.

PD409

TOWN PLANNING AND DEVELOPMENT ACT 1928
TOWN PLANNING SCHEME AVAILABLE FOR INSPECTION

City of Mandurah

Town Planning Scheme No. 6—Mandurah Marina Waterway Management Scheme

Ref: 853/6/13/4.

Notice is hereby given that the City of Mandurah has prepared the abovementioned town planning scheme for the purpose of providing for the management of the Waterway contained within the Mandurah Marina Estate.

Plans and documents setting out and explaining the town planning scheme have been deposited at Council Offices, Mandurah Terrace, Mandurah, and at the State Planning Commission/Department of Planning and Urban Development, Albert Facey House, 469-489 Wellington Street, Perth, and will be available for inspection during office hours up to and including August 9, 1994.

Submissions on the scheme amendment should be made in writing on Form No. 4 and lodged with the undersigned on or before August 9, 1994.

M. R. NEWMAN, Town Clerk.

PD410

TOWN PLANNING AND DEVELOPMENT ACT 1928
SCHEME AMENDMENT AVAILABLE FOR INSPECTION

City of Melville

Town Planning Scheme No. 3—Amendment No. 109

Ref: 853/2/17/10, Pt. 109.

Notice is hereby given that the City of Melville has prepared the abovementioned scheme amendment for the purpose of—

- (a) deleting Clause 5.9.1 (1b) relating to the parking of commercial vehicles on a lot containing a single house only;
- (b) deleting Clause 1.9.63 (i), which relates to only allowing four (4) persons as clients/customers for swimming lessons as a home occupation with a private domestic pool; and
- (c) deleting the words "Shall be limited to office use only and the following requirements shall be satisfied" contained within Clause 4.9.4—Policy 4 and replace with the words " Shall be limited to office use and coffee shop only and the following requirements shall be satisfied ".

Plans and documents setting out and explaining the scheme amendment have been deposited at Council Offices, Almondbury Road, Ardross, and at the State Planning Commission/Department of Planning and Urban Development, Albert Facey House, 469-489 Wellington Street, Perth, and will be available for inspection during office hours up to and including July 26, 1994.

Submissions on the scheme amendment should be made in writing on Form No. 4 and lodged with the undersigned on or before July 26, 1994.

This amendment is available for inspection in order to provide an opportunity for public comment and it should not be construed that final approval will be granted.

G. G. HUNT, Town Clerk.

PD411

TOWN PLANNING AND DEVELOPMENT ACT 1928
APPROVED TOWN PLANNING SCHEME AMENDMENT

City of Perth

City Planning Scheme—Amendment No. 41

Ref: 853/2/10/9, Pt. 41.

It is hereby notified for public information, in accordance with section 7 of the Town Planning and Development Act 1928 that the Hon Minister for Planning approved the City of Perth Town Planning Scheme Amendment on June 5, 1994 for the purpose of rezoning the Holdfast Barracks site bounded by Canning Highway, Armagh and Washington Streets, Victoria Park from Special Use—Military Purposes—to Residential R60.

C. LAWRENCE, Chairman of Commissioners.
R. F. DAWSON, Chief Executive/Town Clerk.

PD412

TOWN PLANNING AND DEVELOPMENT ACT 1928
APPROVED TOWN PLANNING SCHEME AMENDMENT
City of Perth

City Planning Scheme—Amendment No. 46

Ref: 853/2/10/9, Pt. 46.

It is hereby notified for public information, in accordance with Section 7 of the Town Planning and Development Act, 1928 that the Hon Minister for Planning approved the City of Perth Town Planning Scheme Amendment on June 5, 1994 for the purpose of:

- (i) the Scheme map be amended by:—
- (a) rezoning the lots fronting Albany Highway between Dane and Oats Streets and Balmoral Street and Baillie Avenue, from Residential R40 to Residential R80;
 - (b) delineating the lots fronting Albany Highway between Dane and Oats Streets and Balmoral Street and Baillie Avenue by a dashed line to form a Special Precinct to be entitled as "Albany Highway Residential/Commercial Precinct";
- (ii) the Scheme text be amended by:—
- (a) amending Clause 59:—
 - (1) by deleting the word "and" and where it appears after the words Windarra Drive Precinct" and substituting therefore a comma;
 - (2) by adding the following words after the words "Herdsman Parade Precinct", "and Albany Highway Residential/Commercial Precinct";
 - (b) inserting after Clause 69B a new Clause 69C as follows:—

"ALBANY HIGHWAY RESIDENTIAL/COMMERCIAL PRECINCT

69C(1) In considering an application for town planning approval in the Albany Highway Residential/Commercial Precinct, the Council, in addition to any other aim or objective of the scheme and to any other matter it is required or permitted to consider, shall have regard to the following objectives:—

 - (a) the encouragement of mixed residential and non-residential development;
 - (b) the protection of the amenity of existing and future residential uses;
 - (c) the encouragement of development consistent with the style and character of existing commercial activities in adjacent areas along Albany Highway and complementary to adjacent residential development;

(2) In this precinct land shall only be used for non-residential purposes if:—

 - (a) combined with a residential use;
 - (b) the plot ratio of any building or part thereof, used for non-residential purposes, does not exceed 33% of the maximum allowable plot ratio of 1.0 or the constructed floorspace, whichever is the lesser;"

(3) Where two symbols are indicated alongside a "Use Class" referred to in Table No. 1 in the column relating to the Residential R60, R80 and R160 zones and the symbols are followed by the footnote reference "8" then for the purpose of applying Clause 24:—

 - (a) the right hand symbol shall apply to land within the Precinct; and
 - (b) the left hand symbol shall apply to all other land in those zones;

(iii) Table No. 1 be amended by:—

- (a) deleting the symbols in the column headed "RESIDENTIAL PLANNING CODES R60, R80 and R160" and substituting therefore the following new symbols:—

Single house, caretaker's residence	P
Aged or dependent persons dwellings	P
Attached house, grouped dwelling	P
Multiple dwelling	P/X ⁸
Home Occupations	AA/P ⁸
Lodging house, hotel, motel, club, tavern, private hotel, serviced apartment	SA/AA ⁸
Hospital, institutional building	SA/AA ⁸
Consulting rooms	SA/P ⁸
Local shop	SA/P ⁸
Shop	X/AA ⁸
Fish shop, pet meat shop, pet shop	X/AA ⁸
Eating house	SA/AA ⁸
Day nursery	SA/AA ⁸
Recreational facilities	AA
Educational establishment	AA
Public worship—place of	AA
Civic building	AA

Theatre, cinema, commercial hall	X/AA ⁸
Office building	X/P ⁸
Light industry	X/SA ⁸
General industry	X
Hazardous or noxious industry	X
Warehouse, showrooms	X/AA ⁸
Public utilities	AA
Car Park	X/AA ⁸
Amusement centre, camping ground, caravan park, cemetery, crematorium, drive-in theatre, drive-in fast food outlet, funeral parlour, fuel depot, open air storage yard, service station, transport depot, vehicle sales premises, veterinary clinic, veterinary hospital	X/AA ⁸

(b) inserting the following new footnote after Footnote 8:—
 "8. Refer to Clause 69C(2) and (3). (Albany Highway Residential/Commercial Precinct)".

PD413

TOWN PLANNING AND DEVELOPMENT ACT 1928
APPROVED TOWN PLANNING SCHEME AMENDMENT
City of Stirling

District Planning Scheme No. 2—Amendment No. 187A

Ref: 853/2/20/34, Pt. 187A.

It is hereby notified for public information, in accordance with section 7 of the Town Planning and Development Act 1928, that the Hon Minister for Planning approved the City of Stirling Town Planning Scheme Amendment on June 6, 1994, for the purpose of:

1. Rezoning Lot 5, H.N. 49 Walter Road West, Dianella from "Service Station" to "Special Use Zone—Offices".
2. Altering Schedule II of the Scheme by the addition thereto of the following—

Walter Road West corner Cleveland Street	Portion of Swan Loc. N and being Lot 5 on Plan 181	Restaurant and Offices
---	---	------------------------

A. A. SPAGNOLO, Mayor.
G. S. BRAY, Town Clerk.

PD414

TOWN PLANNING AND DEVELOPMENT ACT 1928
APPROVED TOWN PLANNING SCHEME AMENDMENT
City of Wanneroo

Town Planning Scheme No. 1—Amendment No. 667

Ref: 853/2/30/1 Pt 667

It is hereby notified for public information, in accordance with Section 7 of the Town Planning and Development Act 1928 that the Hon Minister for Planning approved the City of Wanneroo Town Planning Scheme Amendment on June 5, 1994 for the purpose of—

1. rezoning portion Lot 7 Badgerup Road, Gngangara from Rural to Rural Special Zone (Additional Use) Rural Store not exceeding 100m².
2. specifying a maximum gross leasable area of 100m² in Schedule 5 of the Scheme text.

G. A. MAJOR, Mayor.
A. ROBSON, A/Town Clerk.

PD415

TOWN PLANNING AND DEVELOPMENT ACT 1928
APPROVED TOWN PLANNING SCHEME AMENDMENT

Shire of Augusta-Margaret River

Town Planning Scheme No. 11—Amendment No. 73

Ref: 853/6/3/8, Pt. 73.

It is hereby notified for public information, in accordance with section 7 of the Town Planning and Development Act 1928 that the Hon. Minister for Planning approved the Shire of Augusta-Margaret River Town Planning Scheme Amendment on June 5, 1994 for the purpose of:

1. Rezoning Pt. Lot 2 of Sussex Location 2705 from "Rural" Zone to "Special Use" Zone.
2. Amending the Scheme Map accordingly.
3. Amending the Scheme Text by inserting in Schedule 3: Special Use Sites; under the respective headings, the following:

Lot and Location	Permitted Uses (See Clause 4.8)
Pt. Lot 2 of Sussex Location 2705, Sebbes Road Margaret River	<p>The following uses may be permitted by Council:</p> <ol style="list-style-type: none"> 1. A tourist reception building and cafe area. 2. A farm centre building. 3. A free flight walk through aviary. 4. Eight 2 bedroom chalets. 5. A residential dwelling (in addition to existing dwelling) <p>Development shall be of a high standard and in keeping with the rural character and amenity of area.</p> <p>In considering applications for development, Council shall have regard to the following matters:</p> <ol style="list-style-type: none"> (a) Aesthetics. (b) Effluent Disposal. (c) Drainage. (d) Water course protection. (e) Visual impact. (f) Protection of existing vegetation. (g) Non-Development zones/Landscape buffers. (h) Soil and landform protection. (i) Dieback control. (j) Fire control. (k) Contributions to road upgrading. (l) Water supply—including a monitoring and contingency programme.

L. SHEPHERDSON, President.
A. BROWN, Acting Shire Clerk.

PD501

TOWN PLANNING AND DEVELOPMENT ACT 1928
APPROVED TOWN PLANNING SCHEME AMENDMENT

Shire of Busselton

Town Planning Scheme No. 5—Amendment No. 270

Ref: 853/6/6/6, Pt. 270.

It is hereby notified for public information, in accordance with section 7 of the Town Planning and Development Act 1928 that the Hon. Minister for Planning approved the Shire of Busselton Town Planning Scheme Amendment on June 5, 1994 for the purpose of:

1. Rezoning Lots 265, 273 and 274 Salmon Close from "Single Residential" to "Restricted Use";
and

2. Amending the Scheme Text by adding to "Appendix V—Restricted Use Zones", the following:

Street	Particulars	Only Use Permitted
Salmon Close	Lots 265, 273 & 274	1. Residential Development (R30) as may be permitted by the R30 Code in the Residential Planning Codes. For the purpose of the Scheme Residential Planning Codes means the Residential Planning Codes of Western Australia dated December 1991, together with any amendments thereto.

R. TOGNELA, President.
I. STUBBS, Shire Clerk.

PD502

TOWN PLANNING AND DEVELOPMENT ACT 1928
APPROVED TOWN PLANNING SCHEME AMENDMENT

Shire of Busselton

Town Planning Scheme No. 5—Amendment No. 281

Ref: 853/6/6/6, Pt. 281.

It is hereby notified for public information, in accordance with section 7 of the Town Planning and Development Act 1928 that the Hon. Minister for Planning approved the Shire of Busselton Town Planning Scheme Amendment on June 5, 1994 for the purpose of:

1. Rezoning Lot 3 being portion of Sussex Location 1 from 'Single Residential' to 'Restricted Use'.
2. Amending the Scheme Text by adding the following to Appendix V—Restricted use Zones.

Street	Particulars	Only Use Permitted
Marine Tce.	Lot 3 being portion of Location 1	Residential Development as may be permitted by the Residential R30 Code of the Residential Planning Codes as set out in Appendix 2 to the Statement of Planning Policy No. 1 (as amended 1991), together with any amendments thereto, issued by the Department of Planning and Urban Development.

R. TOGNELA, President.
I. STUBBS, Shire Clerk.

PD503

TOWN PLANNING AND DEVELOPMENT ACT 1928
APPROVED TOWN PLANNING SCHEME AMENDMENT

Shire of Busselton

Town Planning Scheme No. 5—Amendment No. 246

Ref: 853/6/6/6 Pt 246

It is hereby notified for public information, in accordance with Section 7 of the Town Planning and Development Act 1928 that the Hon Minister for Planning approved the Shire of Busselton Town Planning Scheme Amendment on June 5, 1994 for the purpose of—

1. amending the Scheme Maps to include Lot 2 Bussell Highway, West Busselton from "Single Residential" to "Additional Use".
2. amending the Scheme Text by adding to Appendix IV "Additional Use" Zones, the following—

Bussell Highway

Lot 2 of Portion of Sussex Consulting Rooms
Location 5.

R. TOGNELA, President.
I. STUBBS, Shire Clerk.

PD510

TOWN PLANNING AND DEVELOPMENT ACT 1928
APPROVED TOWN PLANNING SCHEME AMENDMENT
Shire of Serpentine-Jarrahdale

Town Planning Scheme No. 2—Amendment No. 31

Ref: 853/2/29/3, Pt. 31.

It is hereby notified for public information, in accordance with section 7 of the Town Planning and Development Act 1928, that the Hon Minister for Planning approved the Shire of Serpentine-Jarrahdale Town Planning Scheme Amendment on June 6, 1994 for the purpose of—

1. Replacing the Subdivisional Guide Plan referred to in Clause 5.9.5 for "Soldiers Road" Serpentine AA Lot 31, 32 and 33 with the Subdivision Guide Plan appended to this document.
2. Amending Appendix 4—Special Rural Zone to include special provisions relating to Lot 32 Karbro Drive, Cardup, described hereunder.

8.3 Special provisions relating to the subdivision of Lot 32 Karbro Drive—

Notwithstanding the following conditions the subdivision and development of Lot 32 Karbo Drive, Cardup shall comply with the Planning Guidelines for Nutrient Management, Serpentine-Jarrahdale January 1993.

Purchasers of the new lots shall be supplied with a copy of these Guidelines and special provisions which are to be attached to the relevant R.E.I.W.A. Contracts of Sale (Offer and Acceptance)

- 8.3.1 On-site effluent disposal systems servicing development on the lots shall be to the specifications and satisfaction of both the Local Authority and the Environmental Protection Authority. The use of non-standard effluent disposal systems shall be required to service development on all new lots.
- 8.3.2 Within this Special Rural estate landuses other than a single residence, that are permitted or may be permitted by the Council pursuant to the Scheme shall only be permitted when the Council is satisfied following consultation with the Environmental Protection Authority that the land use does not involve excessive nutrient application or the clearing of the land.
- 8.3.3 Notwithstanding Clause 5.9.6 (b) of the Scheme any residence and all other outbuildings shall only be constructed within the Building Envelope shown on the Subdivisional Guide Plan. (Figure I)
- 8.3.4 At the time of the building application for each lot a plan of the site shall be submitted by the applicant to the satisfaction and specifications of the Council which shall show site contours, existing trees and stands of vegetation, those trees and vegetation to be removed and retained and proposals for tree Planting and maintenance.
- 8.3.5 The landowner shall be responsible for the establishment and maintenance of firebreaks to the specifications and satisfaction of the Council and any other fire prevention measures that may be required by the Council for the estate will be at the land owners cost in proportion of the land holdings to the whole of the estate.
- 8.3.6 The land for, and the provision of, an on-site static water facility of 50 000 litres capacity, fed by a bore and windmill or suitable alternative for fire fighting purposes shall be provided by the developer of the estate free of cost to Council. The location of the facility shall be to the satisfaction of both the Council and Bush Fires Board and the facility shall be constructed to the specifications of the Bush Fires Board.
- 8.3.7 Signs, hoardings or advertisements shall not be erected without the prior written approval of the Council.
- 8.3.8 The land is situated within the Serpentine Groundwater Area and a well licence for a bore must be obtained from the Water Authority of Western Australia. The siting of bores shall be to the requirements of the Authority having regard to the location of any effluent disposal systems, water bodies, drains and neighbouring bores. The licence will contain a number of conditions including the quantity of water that can be pumped each year. Under current management guidelines 1500 kilolitres per year is allocated. The allocation of 1500 kilolitres if efficiently used is sufficient for domestic use and the irrigation of up to 0.1 hectares.
- 8.3.9 No lot within the subdivision area to be less than 2 hectares.
- 8.3.10 All buildings shall be set back a minimum of 20 metres from front and rear boundaries, and 10 metres from side boundaries.

D. J. HADDOW, President.

R. A. GIBB, Chief Executive Officer/Shire Clerk.

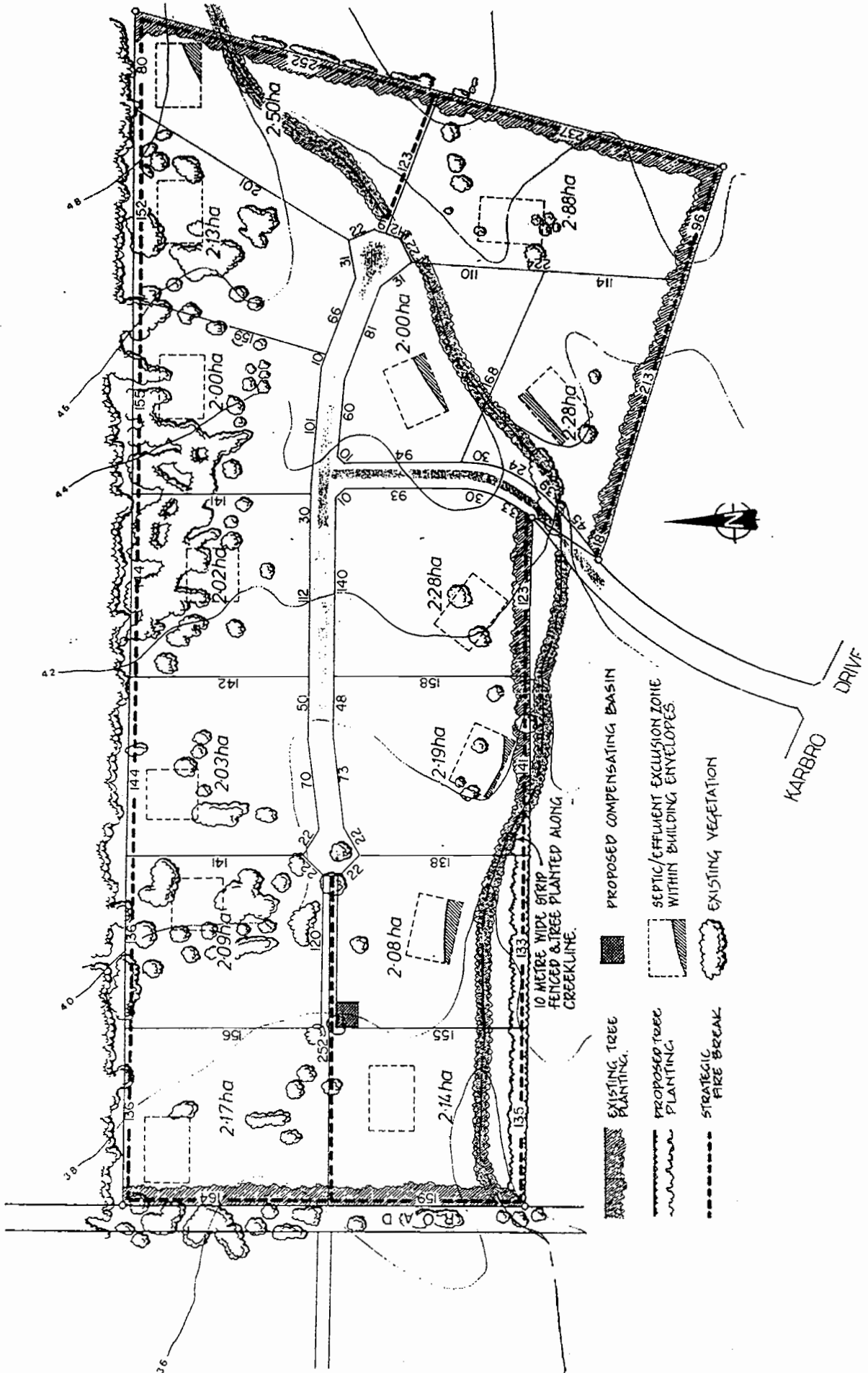

PD504

TOWN PLANNING AND DEVELOPMENT ACT 1928
APPROVED TOWN PLANNING SCHEME AMENDMENT

Shire of Collie

Town Planning Scheme No. 1—Amendment No. 93

Ref: 853/6/8/1 Pt 93

It is hereby notified for public information, in accordance with Section 7 of the Town Planning and Development Act 1928 that the Hon Minister for Planning approved the Shire of Collie Town Planning Scheme Amendment on June 5, 1994 for the purpose of—

1. amending the Scheme Map by rezoning portion of Pt Lot 2773, Wellington Boulevard, Collie from "Residential" to "Commercial A".
2. amending the Zoning Table (Table 1 of the Scheme Text) by inserting the symbol "AA" where the use "Consulting Rooms" cross-references with the zone "Commercial A".
3. amending the Scheme Map by recoding portion of Pt Lot 2773 Residential "R30".

R. PIMM, President.
I. MIFFLING, Shire Clerk.

PD505

TOWN PLANNING AND DEVELOPMENT ACT 1928
APPROVED TOWN PLANNING SCHEME AMENDMENT

Shire of Collie

Town Planning Scheme No. 1—Amendment No. 92

Ref: 853/6/8/1, Pt. 92.

It is hereby notified for public information, in accordance with section 7 of the Town Planning and Development Act 1928 that the Hon. Minister for Planning approved the Shire of Collie Town Planning Scheme Amendment on June 5, 1994 for the purpose of:

1. Amending the Scheme Map by rezoning portion of Lot 60, cnr. Coalfields Highway and Wellington Boulevard, Collie from "Special Use—Roadhouse" to "Motel".
2. Amending the Scheme Map by rezoning portion of Lot 60, cnr. Coalfields Highway and Wellington Boulevard, Collie from "Special Use—Roadhouse" to "Special Use—Tourist Development".
3. Amending the Scheme Map by rezoning portion of Lot 56, cnr. Coalfields Highway and Wellington Boulevard, Collie from "Motel" to "Special Use—Tourist Development".
4. Amending the Scheme Text by inserting after Item 7 of Table 2 of the Scheme Text the following:

8	Wellington Boulevard	Portion of Lots 56 and 60	Tourist Development, being either: (i) Tourist shops & showrooms (ii) Tourist markets & entertainment (iii) Museum (iv) Motel expansion.
---	----------------------	---------------------------	--

R. PIMM, President.
I. MIFFLING, Shire Clerk.

PD506

TOWN PLANNING AND DEVELOPMENT ACT 1928
SCHEME AMENDMENT AVAILABLE FOR INSPECTION

Shire of Denmark

Town Planning Scheme No. 3—Amendment No. 2

Ref: 853/5/7/3 Pt 2

Notice is hereby given that the Shire of Denmark has prepared the abovementioned scheme amendment for the purpose of—

- (a) rezoning Lot 2 Mount Shadforth Road, Denmark, from 'Rural' zone to 'Tourist' zone.
- (b) amending the face of the Scheme Map accordingly.
- (c) introducing Appendix 13—Schedule of Tourist Zones into the Scheme Text referring to the particulars of the land and conditions of use.

Plans and documents setting out and explaining the scheme amendment have been deposited at Council Offices, Strickland Street, Denmark and at the State Planning Commission/Department of Planning and Urban Development, Albert Facey House, 469-489 Wellington Street, Perth, and will be available for inspection during office hours up to and including July 26, 1994.

Submissions on the scheme amendment should be made in writing on Form No. 4 and lodged with the undersigned on or before July 26, 1994.

This amendment is available for inspection in order to provide an opportunity for public comment and it should not be construed that final approval will be granted.

P. DURTANOVICH, Shire Clerk.

PD507

**TOWN PLANNING AND DEVELOPMENT ACT 1928
APPROVED TOWN PLANNING SCHEME AMENDMENTS**

Shire of Esperance

Town Planning Scheme No. 22—Amendment Nos. 7 and 9

Ref: 853/11/6/21, Pts. 7 and 9.

It is hereby notified for public information, in accordance with section 7 of the Town Planning and Development Act 1928 that the Hon Minister for Planning approved the Shire of Esperance Town Planning Scheme Amendments on 5 June 1994 for the purpose of—

Amendment No. 7

- (i) rezoning lot 423 Pink Lake Road, Esperance from Additional Use—Fast Food Outlet and Butchers Shop to Shops and Offices.
- (ii) rezoning lots 420-422 Pink Lake Road, Esperance from Residential to Shop and Offices.

Amendment No. 9

- (i) rezoning that portion of land being CT Vol. 1890 Fol. 189, area 202 m² immediately behind Pt. Lot 186 Foy Street, Esperance from Parks and Recreation Reserve to Residential R12.5-R17.5.

D. A. PATERSON, President.
R. T. SCOBLE, Shire Clerk.

PD508

**TOWN PLANNING AND DEVELOPMENT ACT 1928
SCHEME AMENDMENT AVAILABLE FOR INSPECTION**

Shire of Gnowangerup

Town Planning Scheme No. 1—Amendment No. 5

Ref: 853/5/9/7, Pt. 5.

Notice is hereby given that the Shire of Gnowangerup has prepared the abovementioned scheme amendment for the purpose of:

- (a) Rezoning Lots 54, 84, 56, 57, 58, 59 Moir Street from the Residential Zone to Industrial Zone.
- (b) An "AA" Classification for "Residential—Single House" in Table 1—Zoning Table of the Scheme Text at the cross reference between the Industrial Zone and Residential—Single House.
- (c) Rezoning Lots 1, 2, 3, 4, 5 and 7 Moir Street Borden from the Residential Zone to the Commercial Zone.
- (d) Rezoning Lot 6 Moir Street Borden from Public Purposes Reserve to Commercial Zone.
- (e) Rezoning Lot 30 (17871) Wray Street Borden from Recreation Reserve to Industrial Zone.
- (f) Rezoning portion of Wray Street Borden (17055) from a Road Reserve to Industrial Zone.
- (g) Rezoning portion of Lot 81 (revested) bounded by Wray Street Borden, Moir Street Borden and the Borden Town Boundary from the Rural Zone to Industrial Zone.
- (h) Rezoning portion of Moir Street Borden (approx. 2 400m²) from a Road Reserve to the Industrial Zone.
- (i) Rezoning portion of Lot 53 (23568) approx. 7 650m², bounded by John Street Borden and Windmar Street Borden from the Recreation Reserve to the Residential Zone.
- (j) Surveying and gazetting the unofficial road now transversing Lot 46, linking John Street Borden to Chester Pass Road Borden.
- (k) Rezoning portions of Lots 46, 47, Trappitt Street Borden and part of the land bounded by John Street, Farrent Street, Chester Pass Road and Trappitt Street Borden to create an Industrial Zone of approx. 4.2 ha adjacent to the newly gazetted road and bordered by John Street Borden and Chester Pass Road Borden.

Plans and documents setting out and explaining the scheme amendment have been deposited at Council Offices, 28 Yougenup Road, Gnowangerup and at the State Planning Commission/Department of Planning and Urban Development, Albert Facey House, 469-489 Wellington Street, Perth, and will be available for inspection during office hours up to and including July 26, 1994.

Submissions on the scheme amendment should be made in writing on Form No. 4 and lodged with the undersigned on or before July 26, 1994.

This amendment is available for inspection in order to provide an opportunity for public comment and it should not be construed that final approval will be granted.

M. L. CHESTER, Shire Clerk.

PD509

TOWN PLANNING AND DEVELOPMENT ACT 1928
APPROVED TOWN PLANNING SCHEME AMENDMENT

Shire of Greenough

Town Planning Scheme No. 4—Amendment No. 53

Ref: 853/3/7/6, Pt. 53.

It is hereby notified for public information, in accordance with section 7 of the Town Planning and Development Act 1928, that the Hon. Minister for Planning approved the Shire of Greenough Town Planning Scheme Amendment on June 6, 1994 for the purpose of rezoning Lot 160 Hibertia Street, Strathalbyn from Low Density Residential R5 to Shop.

J. P. EDWARDS, President.
W. T. PERRY, Shire Clerk.

PD511

TOWN PLANNING AND DEVELOPMENT ACT 1928
APPROVED TOWN PLANNING SCHEME AMENDMENT

Shire of Swan

Town Planning Scheme No. 9—Amendment No. 212

Ref: 853/2/21/10, Pt. 212.

It is hereby notified for public information, in accordance with section 7 of the Town Planning and Development Act 1928, that the Hon. Minister for Planning approved the Shire of Swan Town Planning Scheme Amendment on June 5, 1994 for the purpose of substituting the Subdivisional Guide Plan dated March 1991 with the revised Subdivisional Guide Plan dated September 1993, which provides for the subdivision of Lots 112, 131 to 135 & 140 into lots of not less than 1 hectare.

M. C. KIDSON, President.
E. W. LUMSDEN, Shire Clerk.

PD512

TOWN PLANNING AND DEVELOPMENT ACT 1928
APPROVED TOWN PLANNING SCHEME AMENDMENT

Town of Albany

Town Planning Scheme No. 1A—Amendment No. 76

Ref: 853/5/2/15, Pt. 76.

It is hereby notified for public information, in accordance with section 7 of the Town Planning and Development Act 1928, that the Hon. Minister for Planning approved the Town of Albany Town Planning Scheme Amendment on June 5, 1994 for the purpose of the reservation of Part Lot 8 Anson Road from Future Urban Zone, Lots 9 and 10 Albany Highway from Other Commercial and Future Urban Zones, and Reserve 36701 corner Anson Road and Albany Highway from Clubs and Institutions Zone to a reserve for Public Use, Department of Agriculture.

A. G. KNIGHT, Mayor.
M. A. JORGENSEN, General Manager/Town Clerk.

PD513

TOWN PLANNING AND DEVELOPMENT ACT 1928
APPROVED TOWN PLANNING SCHEME AMENDMENT

Town of Claremont

Town Planning Scheme No. 3—Amendment No. 43

Ref: 853/2/2/3, Pt. 43.

It is hereby notified for public information, in accordance with section 7 of the Town Planning and Development Act 1928, that the Hon. Minister for Planning approved the Town of Claremont Town Planning Scheme Amendment on June 5, 1994 for the purpose of amending Clause 52 by—

- (a) Substituting the heading "Building and Objects—Replacement" for "Grouped and Multiple Dwelling Replacement".
- (b) Inserting the figure "(1)" immediately before the first line.

(c) Inserting the following new subclause—

“(2) If any part of a building (other than a single dwelling) that is entered in the Schedule referred to in Clause 78 is damaged or destroyed, otherwise than by or on behalf of the owner thereof, the Council may permit that development to be restored (in the event of damage) or replaced (in the event of destruction) without the provision of additional carparking as required by subclause 30 (a) of this Scheme if—

- (a) the building is a true copy with no significant or substantial variation from the original building,
- (b) the gross floor area is no greater than the original building,
- (c) the use of the building remains unchanged.

P. H. WEYGERS, Mayor.
J. LAW, Acting Town Clerk.

POLICE

PE403

POLICE AUCTION

The following property will be offered by public auction on behalf of the Commissioner of Police on Saturday, 25th June, 1994 at the Broome Auction Centre, Clementson Street, Broome commencing at 9.00 am—

- 10 assorted bicycles
- 1 gold chain and earrings (plate)
- 1 Olympus 35 MM camera
- 1 hiking tent
- 1 sleeping bag
- 1 Lorus watch
- 2 pr stereo headphones
- 1 Casio calculator
- 1 microphone and lead
- 1 Sony Walkman
- 1 spanner set
- 1 pool cue
- sundry other tools

Inspection of the above items can be made at the Broome Auction Centre, Lot 2096 Clementson Street, Broome from Monday, 20th June, 1994. Phone (091) 93 5309.

TRANSPORT

TR301

JETTIES ACT 1926

JETTIES AMENDMENT REGULATIONS 1994

Made by His Excellency the Governor in Executive Council.

Citation

1. These regulations may be cited as the *Jetties Amendment Regulations 1994*.

Commencement

2. These regulations come into operation on 1 July 1994.

Principal regulations

3. In these regulations the *Jetties Act Regulations 1940** are referred to as the principal regulations.

[* Reprinted in the Gazette of 13 December 1990 at pp. 6069-116.
For amendments to 23 May 1994 see 1993 Index to Legislation of
Western Australia, Table 4, p. 146.]

Regulation 10B amended

4. Regulation 10B (1) (c) of the principal regulations is amended by deleting "20 cents" and substituting the following —

" 21 cents ".

Regulation 11 amended

5. Regulation 11 (1) of the principal regulations is amended by deleting "11 cents" and substituting the following —

" 12 cents ".

Regulation 25 amended

6. Regulation 25 (1) of the principal regulations is amended —

(a) in paragraph (a) by deleting "30 cents" in the 2 places it occurs and substituting in both cases the following —

" 31 cents "; and

(b) in paragraph (b) by deleting "30 cents" in the 2 places it occurs and substituting in both cases the following —

" 31 cents ".

Appendix I repealed and an appendix substituted

7. Appendix I to the principal regulations is repealed and the following Appendix substituted —

"

APPENDIX I

[Regs. 6 and 10A]

1. WHARFAGE, HANDLING AND HAULAGE CHARGES

		WHARFAGE ALL PORTS
		\$
Empty returns	per tonne or m ³	1.09
Explosives	per tonne or m ³	2.08
Fertiliser	per tonne or m ³	1.66
Bullocks, cows, etc.	each	1.09
Figs, sheep, goats and dogs	each	0.26
Meat chilled or frozen	per tonne or m ³	1.98
Oil, etc. by pipeline — Bulk	per kilolitre	5.65

		WHARFAGE ALL PORTS
ORE —		
Bulk	per tonne	1.60
In containers	per tonne	1.60
Products of the soil of the State except otherwise stated (exported)	per tonne or m ³	0.98
TIMBER —		
Direct from overseas — in bundles	per tonne or m ³	2.08
Direct from overseas — loose	per tonne or m ³	2.08
Ex WA Ports — in bundles	per tonne or m ³	0.98
Ex WA Ports — loose	per tonne or m ³	0.98
VEHICLES		
Commercial vehicles on own wheels	per tonne or m ³	1.98
Motor cars and utilities on own wheels	per tonne or m ³	1.87
OTHER GOODS		
General cargo	per tonne or m ³	3.38
Recreational vessels	per metre	8.00

HAULAGE AND HANDLING

Charges for haulage and handling shall be in accordance with the IPLF charge-out rates.

BERTHAGE DUES

For vessels over 300 gross registered tonnes shall be 47 cents per tonne or per cubic metre or per kilolitre at the option of the officer in charge, on all cargo landed or shipped with a minimum \$75.00 per day or part thereof.

Vessels under 300 gross registered tonnes shall be 47 cents per tonne or per cubic metre or per kilolitre, at the option of the officer in charge on all cargo landed or shipped with a minimum \$50.00 per day or part thereof.

Pearling store ships, mission vessels and luggers shall pay 47 cents per tonne on all cargo landed or shipped with a minimum \$20.00 per day.

FRESH WATER

Supplied to ships at \$1.46 per kilolitre.

LIGHTING OF JETTY

BROOME — \$5.70 per hour or part thereof.

WYNDHAM — for full lighting of jetty shed and yard \$17.00 per hour, for use of jetty lighting \$5.40 per hour. For reduced lighting \$1.80 per hour.

MOP SHELL — BROOME

Shall be treated as cargo for trans-shipment and pay wharfage one way. Department is not responsible for safe custody or loss of or damage to such shell.

STORAGE

(a) \$0.36 per tonne or part thereof for transit cargo not removed from the goods shed or yard within 3 days of the cargo being received.

(b) \$0.36 per tonne or part thereof or per cubic metre or part thereof for transshipment cargo per week for a maximum period of 2 weeks, thereafter rates set out in paragraph (a) apply.

HIRE OF MOBILE CRANE — WYNDHAM

\$52.00 per hour or part thereof (cost of operator's wage not included).

2. SLIPWAY CHARGES — (FEES PER DAY OR PART THEREOF)

[Reg. 96]

NOTE: Outside of normal hours, the slipway charges set out below are subject to additional charges as prescribed by regulations 37 and 38 of these regulations.

WATER & ELECTRIC POWER CHARGES — ALL PORTS

	\$
Use of water —	2.40
Use of power —	4.15

ALBANY SLIPWAY

Slippage Fees —	
Vessels not exceeding 25 Gross Registered Tons	27.00
Vessels over 25 but not exceeding 50 Gross Registered Tons	48.00
Vessels over 50 but not exceeding 100 Gross Registered Tons	108.00
Vessels over 100 but not exceeding 200 Gross Registered Tons	430.00
Vessels over 200 Gross Registered Tons	850.00
Operator's Time —	
At cost with a minimum for each service	130.00

CARNARVON SLIPWAY

Slippage Fees —	
Vessels not exceeding 10 metres	75.00
Vessels over 10 metres but not exceeding 15 metres	110.00
Vessels over 15 metres but not exceeding 20 metres	175.00
Vessels over 20 metres	287.00
Haulage charge — All vessels	141.00

SHARK BAY SLIPWAY

Slippage Fees —	
Vessels not exceeding 5 metres	34.00
Vessels exceeding 5 metres but not exceeding 12 metres	53.00
Vessels exceeding 12 metres per day or part thereof	60.00
Haulage charge — All vessels	40.00

JOHNS CREEK (POINT SAMSON) SLIPWAY / WYNDHAM SLIPWAY

Slippage Fee — Vessels not exceeding 15 metres	75.00
— Vessels over 15 metres	110.00
Haulage charge — All vessels	92.00

Appendix IA amended**8. Appendix IA to the principal regulations is amended —**

- (a) in item 1 by deleting "A x B x 1.19" and substituting the following —

" A x B x 1.27 ";

- (b) by deleting item 4 and substituting the following item —

“

4. PEN FEES — PORT OF PERTH

**LOCATION — HILLARYS BOAT
HARBOUR [Reg. 73]**

Annual Fee: Length of Vessel
x \$220 per metre.

Advance Payment

* Payment in advance for —

2 years \$210 metre/year

3 years \$200 metre/year

4 years \$190 metre/year

5 years \$180 metre/year

* Fee for 3 year pen lease —

Year 1 \$300 metre/year

Year 2 \$200 metre/year

Year 3 \$100 metre/year

Six Monthly Fee: 60 % of the
annual fee.

Three Monthly fee: 40 % of the
annual fee.

Monthly Fee: 15 % of the
annual fee.

Daily Fee: \$20 per day (flat
rate for all
vessels).

- Note:** 1. A 2½% discount will apply to annual
pen fees paid in advance.
2. Fishing vessels that have paid the
annual fees at Fremantle Fishing
Boat Harbour will be charged 66% of
the annual fee.
3. Payment of pen fees entitles the
hirer to free use of the service jetty
located within the harbour for the
purpose of loading and unloading the
vessel.

”;

- (c) in item 5 by deleting “\$185” and substituting the following —

“ \$190 ”; and

- (d) in item 6 by deleting

“**Annual Fee:** Length of Vessel x \$88
per metre.”

and substituting the following —

“

Annual Fee: Length of Vessel x \$88
per metre.

Annual Fee paid monthly: 10% of the annual fee
per month

”.

**Appendix III repealed and an
Appendix substituted**

9. Appendix III to the principal regulations is repealed and the following Appendix substituted —

“

APPENDIX III

Part 1

[Reg. 94A]

**PEN & BERTHAGE FEES
Other than the Port of Perth**

LOCATIONS: Emu Point & Princess Royal
Boat Harbour, Albany.
Carnarvon Boat Harbour.
Denham.
Bandy Creek Boat Harbour.
Fremantle Fishing Boat Harbour.
Jurien Boat Harbour.
Mandurah Service Jetty.
Johns Creek Boat Harbour.
Batavia Coast Boat Harbour.
Casuarina Boat Harbour.

**1. EMU POINT AND PRINCESS ROYAL
BOAT HARBOUR, ALBANY/
MANDURAH SERVICE JETTY**

Annual Fee: Length of Vessel x \$70 per metre.
Annual Fee paid monthly: 10% of the annual fee per month.
Monthly Fee: 12% of the annual fee.
Daily Casual Fee: Length of Vessel x \$2 per metre.

**2. JURIEN / BATAVIA COAST /
CASUARINA BOAT HARBOUR**

Annual Fee: Length of Vessel x \$128
per metre.
Annual Fee paid monthly: 10% of the annual fee per month.
Monthly Fee: 12% of the annual fee.
Daily Casual Fee: Length of Vessel x \$2 per metre.

**3. BANDY CREEK /
JOHNS CREEK BOAT HARBOUR**

Annual Fee:
(Serviced Pens) Length of Vessel x \$90 per metre.
Annual Fee:
(Unserviced Pens) Length of Vessel x \$60 per metre.
Annual Fee paid monthly: 10% of the annual fee per month.
Monthly Fee: 12% of the annual fee.
Daily Casual Fee: Length of Vessel x \$2 per metre.

4. CARNARVON BOAT HARBOUR

Annual Fee: Length of Vessel x \$124 per metre.
Annual Fee paid monthly: 10% of the annual fee per month.
Monthly Fee: 20% of the annual fee.
Daily Casual Fee: Length of Vessel x \$2.50 per metre.

5. FREMANTLE FISHING BOAT HARBOUR

Annual Fee: Length of Vessel x \$90 per metre for vessels up to, but not including 20 metres.

Length of Vessel x \$120 per metre for vessels 20 metres and over.

Annual Fee paid monthly: 10% of the annual fee per month.

Monthly Fee: 13% of the annual fee.

Daily Casual Fee: Length of Vessel x \$2 per metre.

6. DENHAM

Annual Fee: Length of Vessel x \$155 per metre.

Annual Fee paid monthly: 10% of the annual fee per month.

Monthly Fee: 12% of the annual fee.

Daily Casual Fee: Length of Vessel x \$2 per metre.

NOTE: Payment of pen fees entitles the hirer to free use of any service jetty located within the harbour in which that pen is located subject to the availability of berth space and the direction of authorized officers.

Part 2

[Reg. 94B]

PILE MOORING FEES — STATEWIDE

Annual Fee: Length of Vessel x \$80 per metre.

Annual Fee paid monthly: 10% of annual fee per month

Monthly Fee: 12% of the annual fee.

Daily Casual Fee: 1% of the annual fee.

NOTE: Payment of pile mooring fees entitles the hirer to free use of any service jetty located within the harbour in which that mooring is located subject to the availability of berth space and the direction of authorized officers.

Part 3

[Reg. 94C]

CASUAL BERTHING FEES — OTHER THAN PORT OF PERTH

This fee applies to any Departmental Jetty, other than one located within the Port of Perth, for which no other fee has been prescribed in regulation.

Daily Casual Fee: Length of Vessel x \$2 per metre.

Part 4

[Reg. 11B]

SERVICE JETTIES — FUEL WHARFAGE RATES

LOCATIONS: Exmouth

A rate of \$0.003 per litre of fuel oil.

Lancelin
Greenhead
Leeman

A rate of \$0.005 per litre of fuel oil.

Carnarvon

A rate of \$0.007 per litre of fuel oil.

Augusta
Kalbarri
Mandurah
Onslow
Port Gregory

A rate of \$0.01 per litre of fuel oil.

”

By His Excellency's Command,

D. G. BLIGHT, Clerk of the Council.

TR302

SHIPPING AND PILOTAGE ACT 1967
JETTIES ACT 1926
WESTERN AUSTRALIAN MARINE ACT 1982
NAVIGABLE WATERS AMENDMENT REGULATIONS 1994

Made by His Excellency the Governor in Executive Council.

Citation

1. These regulations may be cited as the *Navigable Waters Amendment Regulations 1994*.

Commencement

2. These regulations shall come into operation on 1 July 1994.

Various fees amended

3. The *Navigable Waters Regulations** are amended by deleting in the provisions referred to in column 1 of the Table to this regulation the fees respectively set out in column 2 of the Table and substituting in each case the corresponding fee set out in column 3 of the Table.

TABLE		
Column 1	Column 2	Column 3
Provisions	Deleted Fee	Substituted Fee
Regulation 45B (3)		
TABLE — item (i)	28	29
— item (ii)	56	58
— item (iii)	104	108
— item (iv)	142	147
Regulation 45B (4)	14.00	15.00
Regulation 45BAA (4) paragraph (g)	14.00	15.00
Regulation 45BA (2)		
paragraph (a)	195.00	200.00
paragraph (b)	195.00	200.00

Column 1	Column 2	Column 3
Provisions	Deleted Fee	Substituted Fee
Regulation 45BA (3)	145.00	150.00
Regulation 45BA (6)	53.00	55.00

[* Reprinted as at 17 October 1989.
For amendments to 23 May 1994 see 1993 Index to Legislation of
Western Australia, Table 4, pp. 248-9.]

By His Excellency's Command,

D. G. BLIGHT, Clerk of the Council.

TR303

SHIPPING AND PILOTAGE ACT 1967

PORTS AND HARBOURS AMENDMENT REGULATIONS 1994

Made by His Excellency the Governor in Executive Council.

Citation

1. These regulations may be cited as the *Ports and Harbours Amendment Regulations 1994*.

Commencement

2. These regulations come into operation on 1 July 1994.

Principal regulations

3. In these regulations the *Ports and Harbours Regulations** are referred to as the principal regulations.

[* Published in the Gazette of 3 February 1966 at pp.277-92.
For amendments to 23 May 1994 see 1993 Index to Legislation of
Western Australia, Table 4, pp.245-8.]

Regulations 14 amended

4. Regulation 14 (3) of the principal regulations is amended by deleting "\$2 938" and substituting the following —

" \$3 030 ".

Regulation 15 amended

5. Regulation 15 (3) of the principal regulations is amended by deleting "\$484" and substituting the following —

" \$499 ".

Regulation 15A amended

6. Regulation 15A of the principal regulations is amended —

(a) in subregulation (1) by deleting "\$471" and substituting the following —

" \$497 "; and

- (b) in subregulation (2) —
- (i) by deleting “\$471” and substituting the following —
 “ \$497 ”; and
- (ii) by deleting “\$571” and substituting the following —
 “ \$589 ”.

Regulation 15B amended

7. Regulation 15B of the principal regulations is amended —
- (a) by deleting “\$229” and substituting the following —
 “ \$236 ”; and
- (b) by deleting “\$328” and substituting the following —
 “ \$338 ”.

Regulation 15C amended

8. Regulation 15C of the principal regulations is amended —
- (a) by deleting “\$72” and substituting the following —
 “ \$74 ”;
- (b) by deleting “\$484” and substituting the following —
 “ \$499 ”; and
- (c) by deleting “\$1 256” and substituting the following —
 “ \$1 295 ”.

Regulation 16 amended

9. Regulation 16 of the principal regulations is amended in paragraph (d) by deleting “\$530” and substituting the following —
 “ \$547 ”.

Third Schedule amended

10. The Third Schedule to the principal regulations is amended in Part I —

- (a) by deleting item 1 and substituting the following item —

“ [Reg. 15]

1. The charges for pilotage of vessels into and out of ports in the State at which pilotage is provided are —

PORTS	GROSS REGISTERED TONNAGE OF VESSEL	CHARGES FOR BOTH INWARD AND OUTWARD PILOTAGE \$
BROOME	Up to 1 499	1 516
	1 500 — 3 000	2 030
	3 001 — 5 000	2 443
	5 001 — 10 000	2 942
	10 001 — 20 000	3 636
	20 001 — 30 000	4 253
	Exceeding 30 000	4 666

PORTS	GROSS REGISTERED TONNAGE OF VESSEL	CHARGES FOR BOTH INWARD AND OUTWARD PILOTAGE
		\$
CARNARVON		
(Cape Cuvier)	Up to 9 999	3 016
	10 000 — 20 000	3 640
	20 001 — 30 000	4 356
	30 001 — 40 000	5 046
	Exceeding 40 000	5 947
 PORT WALCOTT		
	Up to 1 499	1 516
	1 500 — 3 000	2 030
	3 001 — 5 000	2 752
	5 001 — 10 000	3 561
	10 001 — 20 000	4 062
	20 001 — 30 000	4 812
	30 001 — 40 000	5 789
	40 001 — 50 000	6 077
	50 001 — 60 000	6 578
	60 001 — 70 000	7 077
	70 001 — 80 000	7 498
	80 001 — 90 000	7 857
	90 001 — 100 000	8 373
	100 001 — 115 000	8 755
	115 001 — 130 000	9 137
	Exceeding 130 000	9 639
 WYNDHAM		
(In respect of pilotage between Nicholls Point and berth)	Up to 1 499	1 720
	1 500 — 3 000	2 235
	3 001 — 5 000	2 824
	5 001 — 10 000	3 561
	10 001 — 20 000	4 470
	20 001 — 30 000	5 043
	Exceeding 30 000	5 573

and

(b) in item 2 —

- (i) by deleting "\$400" and substituting the following —
" \$413 ";
- (ii) by deleting "\$229" and substituting the following —
" \$236 "; and
- (iii) by deleting "\$328" and substituting the following —
" \$338 ".

By His Excellency's Command,

D. G. BLIGHT, Clerk of the Council.

TR304

W. A. MARINE ACT 1982

W. A. MARINE AMENDMENT REGULATIONS 1994

Made by His Excellency the Governor in Executive Council.

PART 1 — PRELIMINARY

Citation

1. These regulations may be cited as the *W. A. Marine Amendment Regulations 1994*.

Commencement

2. These regulations shall come into operation on 1 July 1994.

**PART 2 — W.A. MARINE (ADJUSTMENT OF COMPASSES)
REGULATIONS 1983**

Regulation 4 amended

3. The Scale of Fees to regulation 4 of the *W.A. Marine (Adjustment of Compasses) Regulations 1983** is amended by deleting —

“
 \$95
 \$152
 \$185
 \$252
 \$419
 \$503
 \$682
 ”

and substituting the following —

“
 \$98
 \$157
 \$191
 \$260
 \$432
 \$519
 \$704
 ”

[* *Published in the Gazette of 1 July 1983 at pp. 2191-2.*
 For amendments to 23 May 1994 see 1993 Index to Legislation of
 Western Australia, Table 4, p.318.]

**PART 3 — W.A. MARINE (CERTIFICATES OF COMPETENCY AND
SAFETY MANNING) REGULATIONS 1983**

Schedule 3 amended

4. Schedule 3 to the *W.A. Marine (Certificates of Competency and Safety Manning) Regulations 1983** is repealed and the following schedule substituted —

“

SCHEDULE 3

[Regs. 14, 17 and 27A]

FEEES

Fees applicable	\$
Registration fee, to be paid for certificate of competency, or part thereof	52
Examination fee, for each examination	26
Eyesight test	15
Issue of certificate	20
Copy of certificate	20

”

[* *Published in the Gazette of 1 July 1983 at pp. 2209-40.*
For amendments to 23 May 1994 see 1993 Index to Legislation of Western Australia, Table 4, pp. 318-9.]

PART 4 — W.A. MARINE (HIRE AND DRIVE) REGULATIONS 1983

Regulation 4 amended

5. Regulation 4 of the *W.A. Marine (Hire and Drive) Regulations 1983** is amended in subregulation (2) (e) —

- (a) in clause 3.1.2 (1) (b) by deleting “\$206” and substituting the following —
“ \$213 ”;
- (b) in clause 3.1.2 (3) (b) by deleting “\$103” and substituting the following —
“ \$106 ”; and
- (c) in clause 3.1.3 (m) by deleting “\$40” and substituting the following —
“ \$41 ”.

[* *Published in the Gazette of 1 July 1983 at pp. 2185-8.*
For amendments to 23 May 1994 see 1993 Index to Legislation of Western Australia, Table 4, p. 320.]

PART 5 — W.A. MARINE (LOAD LINES) REGULATIONS 1983**Regulation 6 amended**

6. Regulation 6 (1) of the *W.A. Marine (Load Lines) Regulations 1983** is amended by deleting "\$25" and substituting the following —

" \$26 ".

[* *Published in the Gazette of 1 July 1983 at p. 2193.*
For amendments to 23 May 1994 see 1993 Index to Legislation of Western Australia, Table 4, p. 320.]

PART 6 — W.A. MARINE (MERCANTILE MARINE) REGULATIONS 1983**Regulation 7 amended**

7. Regulation 7 of the *W.A. Marine (Mercantile Marine) Regulations 1983** is amended —

(a) in subregulation (1) by deleting "\$22" and substituting the following —

" \$23 "; and

(a) in subregulation (2) by deleting "\$22" and substituting the following —

" \$23 ".

[* *Published in the Gazette of 1 July 1983 at p. 2193.*
For amendments to 23 May 1994 see 1993 Index to Legislation of Western Australia, Table 4, p. 320.]

PART 7 — W.A. MARINE (RADIOTELEPHONY) REGULATIONS 1981**Regulation 16 amended**

8. Regulation 16 of the *W.A. Marine (Radiotelephony) Regulations 1981** is amended —

(a) in subregulation (2a) by deleting "\$153" and substituting the following —

" \$158 "; and

(b) in subregulation (2b) by deleting "\$78" and substituting the following —

" \$80 ".

[* *Published in the Gazette of 27 November 1981 at pp. 4839-46.*
For amendments to 23 May 1994 see 1993 Index to Legislation of Western Australia, Table 4, pp. 320-21.]

**PART 8 — W.A. MARINE (SURVEYS AND CERTIFICATES
OF SURVEY) REGULATIONS 1983**

Schedule 1 amended

9. Schedule 1 to the *W.A. Marine (Surveys and Certificates of Survey) Regulations 1983** is repealed and the following Schedule is substituted —

Schedule 1

Fees

1. SURVEY FEES

- (a) The fees for examination of plans of a vessel, surveys carried out during construction, and annual or subsequent surveys are as follows —

<i>Length of Vessel (Metres)</i>	Column 1 <i>Examination of plans</i> (\$)	Column 2 <i>Surveys during Construction</i> (\$)	Column 3 <i>Annual or Subsequent Surveys</i> (\$)
Over 0 but not exceeding 5	95	192	104
Over 5 but not exceeding 7	95	204	104
Over 7 but not exceeding 8	122	271	112
Over 8 but not exceeding 9	150	353	119
Over 9 but not exceeding 10	176	434	126
Over 10 but not exceeding 11	217	522	139
Over 11 but not exceeding 12	258	611	152
Over 12 but not exceeding 13	298	699	167
Over 13 but not exceeding 14	340	787	180
Over 14 but not exceeding 15	381	875	193
Over 15 but not exceeding 16	420	964	206
Over 16 but not exceeding 17	461	1 052	220
Over 17 but not exceeding 18	503	1140	234
Over 18 but not exceeding 19	542	1228	248
Over 19 but not exceeding 20	583	1317	261

<i>Length of Vessel (Metres)</i>	<i>Column 1 Examination of plans (\$)</i>	<i>Column 2 Surveys during Construction (\$)</i>	<i>Column 3 Annual or Subsequent Surveys (\$)</i>
Over 20 but not exceeding 21	630	1412	281
Over 21 but not exceeding 22	678	1506	302
Over 22 but not exceeding 23	725	1601	323
Over 23 but not exceeding 24	773	1697	343
Over 24 but not exceeding 25	820	1791	362
Over 25 but not exceeding 26	869	1885	383
Over 26 but not exceeding 27	915	1980	402
Over 27 but not exceeding 28	964	2076	424
Over 28 but not exceeding 29	1010	2171	445
Over 29 but not exceeding 30	1058	2265	464
Over 30 but not exceeding 31	1112	2367	491
Over 31 but not exceeding 32	1167	2470	519
Over 32 but not exceeding 33	1220	2571	546
Over 33 but not exceeding 34	1275	2673	574
Over 34 but not exceeding 35	1329	2775	601
Over 35 but not exceeding 36	1384	2876	628
Over 36 but not exceeding 37	1439	2978	655
Over 37 but not exceeding 38	1492	3081	681
Over 38 but not exceeding 39	1547	3182	708
Over 39 but not exceeding 40	1601	3284	735
Over 40 but not exceeding 41	1662	3391	771
Over 41 but not exceeding 42	1723	3501	805

<i>Length of Vessel (Metres)</i>	Column 1 <i>Examination of plans</i> (\$)	Column 2 <i>Surveys during Construction</i> (\$)	Column 3 <i>Annual or Subsequent Surveys</i> (\$)
Over 42 but not exceeding 43	1784	3610	838
Over 43 but not exceeding 44	1845	3717	872
Over 44 but not exceeding 45	1906	3827	906
Over 45 but not exceeding 46	1967	3934	939
Over 46 but not exceeding 47	2028	4042	973
Over 47 but not exceeding 48	2089	4152	1006
Over 48 but not exceeding 49	2151	4260	1040
Over 49 but not exceeding 50	2211	4368	1075
Over 50 metres	2272	4477	1108

The fee shown in column 3 for annual and subsequent survey shall be reduced by \$62.00 if the vessel does not have a radio installation.

The fee shown in column 3 for annual and subsequent survey provides for the survey and one further inspection to clear a deficiency notice. When further inspections are necessary to complete the survey, an additional fee of \$72.00 per visit will be charged.

When the vessel is to be issued with a Classification Certificate in respect of its hull and machinery by a recognized Classification Society, the fee payable shall be 50% of the fee prescribed in column 1 and column 2 and 100% of the fee prescribed in column 3.

- (b) Where a vessel is to be surveyed for more than one class of vessel, the fee payable under Column 1 (examination of plans) shall be increased by the amount of one-half of the fee for each additional class;
- (c) Where a vessel is to be surveyed for more than one class of vessel, the fee payable under Column 3 (annual or subsequent survey) shall be increased by the amount of one-half the fee for each additional class;
- (d) Issue of a certificate of survey where the Department accepts a certificate of survey by another marine authority \$40.00;
- (e) For the extension of a certificate of survey \$40.00;
- (f) Issue of a replacement certificate of survey, or a copy of a certificate of survey, or a Permit to Operate, or a Towage Permit \$40.00;
- (g) For a survey specially required subsequent to repairs following damage or accident, the fee is \$40.00 per hour or part thereof, plus associated travel costs;

- (h) The fee for consideration of an application to change the class of the vessel is one-half of the appropriate fee for examination of plans for each class;
- (i) The fee for a survey carried out to change the class of the vessel is one-half of the appropriate fee, for annual or subsequent survey, for each class;
- (j) Where examination of plans is required due to significant alterations to a vessel, the fee is one-half of the appropriate fee payable under Column 1 (Examination of Plans);
- (k) Where an additional survey is carried out due to significant alterations to a vessel, the fee is one-half of the appropriate fee for a survey carried out during construction.

2. Fee for —

- (a) Examination of the plans of a pressure vessel \$ 40.00
per hour
or part
thereof
- (b) Initial survey and test of a pressure vessel \$ 40.00
per hour
or part
thereof
- (c) Examination of the plans of a crane installation on a
vessel \$ 40.00
per hour
or part
thereof
- (d) Survey of a crane installation on a vessel \$ 40.00
per hour
or part
thereof
- (e) Inspection of towage arrangement before the issue of a
towage permit \$ 40.00
per hour
or part
thereof
- (f) Check of stability data of vessel, where detailed check
of loading required \$492.00
- (g) Check of stability data of vessel, where detailed check
of loading not required \$122.00
- (h) Attendance at inclining experiment, roll period test or
authorized practical stability test \$122.00

3. The survey fee payable for vessels licensed under the WA *Marine (Hire and Drive Vessels) Regulations 1983* shall be in accordance with the following scale —

Type of Vessel	Fee (\$)
(a) Power boats not exceeding 5 metres in length	35
(b) Sailing boats other than sailboards	36
(c) Boats propelled exclusively by oars or paddles and sailboards	21
(d) All other boats exceeding 5 metres in length (including houseboats) —	

fees in accordance with the scale set out in item 1
(a) of this Schedule.

- | | | |
|----|--|------|
| 4. | Annual exemption fee (regs. 10 and 10A) — | \$ |
| | (a) For recording or transfer of vessel | 15; |
| | (b) For registration or renewal where the length of the vessel — | |
| | (i) does not exceed 5 metres | 29; |
| | (ii) exceeds 5 metres but does not exceed 10 metres . . | 58; |
| | (iii) exceeds 10 metres but does not exceed 20 metres . | 108; |
| | (iv) exceeds 20 metres | 147. |
| 5. | The fee for any other survey or service requested by the owner or owners agent is \$102 per hour or part thereof. | |
| 6. | In addition to the fees set out in this Schedule, a fee of \$64 per hour or part thereof shall be payable for any survey or service performed during overtime hours, Sundays or public holidays. | |
| 7. | Fee for mileage at rate of 50c/km, or other associated travel costs. | |

[* *Published in the Gazette of 1 July 1983 at pp. 2195-208. For amendments to 23 May 1994 see 1993 Index to Legislation of Western Australia, Table 4, p. 321.*]

By His Excellency's Command,

D. G. BLIGHT, Clerk of the Council.

TR401

BUNBURY PORT AUTHORITY ACT 1909

PROPOSED EXCISION FROM THE BUNBURY PORT AUTHORITY

I, Major General Philip Michael Jeffery, Officer of the Order of Australia, Military Cross, Governor of the State of Western Australia, do hereby in pursuance of the powers enabling me in that behalf, and under and by virtue of the provisions of section 20 of the Bunbury Port Authority Act 1909; direct that all that portion of land and harbour bed shown delineated in black and bordered red on Department of Land Administration Miscellaneous Plan Number 1838 shall be excised from the Bunbury Port Authority and be revested in and held by the Crown.

Given under my hand, at Perth this 7th day of June 1994.

MICHAEL JEFFERY, Governor.

TR402

BUNBURY PORT AUTHORITY ACT 1909

PROPOSED EXCISION FROM THE BUNBURY PORT AUTHORITY

I, Major General Philip Michael Jeffery, Officer of the Order of Australia, Military Cross, Governor of the State of Western Australia, do hereby in pursuance of the powers enabling me in that behalf, and under and by virtue of the provisions of section 20 of the Bunbury Port Authority Act 1909; direct that all that portion of land and harbour bed shown delineated in black and bordered red on Department of Land Administration Miscellaneous Plan Number 1829 shall be excised from the Bunbury Port Authority and be revested in and held by the Minister for Transport.

Given under my hand, at Perth this 7th day of June 1994.

MICHAEL JEFFERY, Governor.

PUBLIC NOTICES**ZZ101****THE PUBLIC TRUSTEE ACT 1941**

Notice is hereby given that pursuant to section 14 of the Public Trustee Act 1941 and amendments the Public Trustee has elected to administer the estates of the undermentioned deceased persons.

Name of Deceased; Address; Date of Death; Date Election Filed.

Dominguez Gonzalez, Manuel (also known as Manuel Dominguez); Collie; 20 December 1993; 3 June 1994.

Dated at Perth the 7th day of June 1994.

K. E. BRADLEY, Public Trustee,
565 Hay Street, Perth 6000.

ZZ201**TRUSTEES ACT 1962**

Re: Estate Frank Victor Downing, late of Unit 14 Kyamalia, 19 Broome Street, Cottesloe 6011.

Creditors with claims on the above deceased estate should lodge such claims with the executor R. C. Downing, Unit 114 Parklands, 52 Liege St, Woodlands 6018, not later than 15th July 1994.

R. C. DOWNING, Executor.

ZZ301**INQUIRY AGENTS LICENSING ACT 1954****APPLICATION FOR LICENCE IN THE FIRST INSTANCE**

To the Court of Petty Sessions at Midland.

I, Alan James Greenhalgh of 33 Statham Street, Glen Forrest WA, security adviser having attained the age of twenty-one years, hereby apply on my own behalf for a licence under the abovementioned Act. The principal place of business will be at 33 Statham Street, Glen Forrest.

Dated the 8th day of June 1994.

A. J. GREENHALGH, Signature of Applicant.

Appointment of Hearing

I hereby appoint the 15th day of July 1994 at 10.00 o'clock in the forenoon as the time for the hearing of the foregoing application at the Court of Petty Sessions at Midland.

Dated the 9th day of June 1994.

KEVIN PARSONS, Clerk of Petty Sessions.

Objection to the granting of the application may be served on the applicant and the Clerk of Petty Sessions at any time prior to seven days before the date appointed for the hearing.

ZZ401

WESTERN AUSTRALIAN TROTTING ASSOCIATION

By-laws of Trotting

Notice of Amendment

Notice is hereby given that at a meeting of the Committee of the Western Australian Trotting Association held at Gloucester Park, East Perth, on the 22nd day of February 1994, it was resolved by an absolute majority of the Committee of the Association that the By-laws of Trotting made under the Western Australian Trotting Association Act 1946 ("the Act") be amended as follows—

Amend By-law 4A

Present Wording

"In addition to the number of members comprising the Committee as outlined in By-law 4, for a period of three years commencing at the close of the 1991 Annual General Meeting and until the close of the Annual General Meeting in 1994 the President of the Fremantle Trotting Club (Incorporated) or subject to the written approval of a simple majority of the Committee, his nominee, shall be a member of the Committee. The provisions of By-laws 4, 5, 6, 7, 8, 9 and 10 shall not apply to the President of the Fremantle Trotting Club (Incorporated) or his nominee as a member of the Committee so far as the same relate to the nomination, candidacy, election and retirement of members of the Committee. Such person must be a financial member of the Association at all times during his term of office as a member of the Committee."

Amended Wording

"In addition to the number of members comprising the Committee as outlined in By-law 4, for a period of five years commencing at the close of the 1991 Annual General Meeting and until the close of the Annual General Meeting in 1996 the President of the Fremantle Trotting Club (Incorporated) or subject to the written approval of a simple majority of the Committee, his nominee, shall be a member of the Committee. The provisions of By-laws 4, 5, 6, 7, 8, 9 and 10 shall not apply to the President of the Fremantle Trotting Club (Incorporated) or his nominee as a member of the Committee so far as the same relate to the nomination, candidacy, election and retirement of members of the Committee. Such person must be a financial member of the Association at all times during his term of office as a member of the Committee."

Dated the 22nd day of February 1994.

JOHN HIGGINS, President.

THE COMPLETE SOLUTION TO DESKTOP PUBLISHING

Contact our Marketing Branch
and discuss your needs with one
of our Client Liaison Officers on
383 8811 or call into:

State Print
22 Station Street
Wembley, W.A. 6014



STATE PRINT
DEPARTMENT OF STATE SERVICES

DESKTOP PUBLISHING

Enhance the look of your document by using our desktop service. We can offer you an IBM or Apple Macintosh Applications.

QUALITY OF OUTPUT; THE CHOICE IS YOURS!

We offer you a range of qualities in final camera-ready output to suit your budget, ready for negative or printing plate preparation.

DOCUMENT CONVERSION

State Print can save you printing and publishing costs by converting your final draft document.

DISK CONVERSION

We offer you fast and accurate data and document conversion between virtually any 8", 5.25", or 3.5" disk formats, or magnetic tape with conversion options.

PERTH OBSERVATORY



THE W.A. SPECIALISTS IN ASTRONOMICAL

Research & Educational Astronomy
PUBLIC TOURS (DAY & NIGHT)
FIELD NIGHTS, LECTURES
Astronomical Information

Astronomical Handbook

Sun rise & set; Moon rise & set

Legal advice

Chronometer calibration

Astronomical souvenirs

SERVING WESTERN AUSTRALIA SINCE 1896

WALNUT ROAD, BICKLEY 6076

TELEPHONE 293 8255 FAX 293 8138

ASTRONOMY IS LOOKING UP

**Do you need
something printed?**

*Tried the
Print lately?*

3 Reasons why you should:

- QUALITY WORK
- COMPETITIVE RATES
- FAST EFFICIENT SERVICE

Telephone our Marketing section for a quote or advice
on how to produce your next publication in the
most efficient and economical way

WE KNOW YOU'LL BE IMPRESSED!



STATE PRINT
DEPARTMENT OF STATE SERVICES

STATION STREET, WEMBLEY 6014, PHONE 383 8811

CONTENTS

REGULATIONS, BY-LAWS, RULES, DETERMINATIONS, ORDERS

	Page
Fisheries Adjustment Schemes Amendment Regulations (No. 2) 1994	2439
Jetties Amendment Regulations 1994	2475-82
Justices (INREP) Amendment Regulations (No. 2) 1994	2440-1
Shipping and Pilotage Act—Ports and Harbours Amendment Regulations 1994	2483-5
Shipping and Pilotage Act, Jetties Act, Western Australian Marine Act—Navigable Waters Amendment Regulations 1994	2482-3
W.A. Marine Amendment Regulations 1994	2486-93

GENERAL CONTENTS

	Page
Conservation and Land Management	2439
Fisheries	2439
Justice	2440-1
Land Administration—	
General Information	2441, 2446-60
Orders in Council	2441-6
Local Government	2460-2
Planning and Urban Development	2462-75
Police	2475
Proclamations	2437-8
Public Notices—	
Deceased Persons Estates	2494
Inquiry Agents	2494
Western Australian Trotting Association By-laws	2495
Transport	2475-93



1 9 9 4 0 0 0 8 0 6 6

GENERAL 14 JUN