



WESTERN AUSTRALIAN GOVERNMENT Gazette



PERTH, FRIDAY, 15 DECEMBER 1995 No. 174

PUBLISHED BY AUTHORITY JOHN A. STRIJK, ACTING GOVERNMENT PRINTER AT 3.30 PM

Publishing Details

The Western Australian *Government Gazette* is published by State Law Publisher for the State of Western Australia on Tuesday and Friday of each week unless disrupted by Public Holidays or unforeseen circumstances (changes to this arrangement will be advertised beforehand on the inside cover).

Special *Government Gazettes* and Extraordinary *Government Gazettes* are published periodically, all gazettes are included in the subscription price.

The following guidelines should be followed to ensure publication in the *Government Gazette*.

- Material submitted to the Executive Council and which requires gazettal will require a copy of the signed Executive Council Minute Paper and in some cases the Parliamentary Counsel's Certificate.
- Copy should be received by the Manager (Sales and Editorial), State Law Publisher no later than 12 noon on Wednesday (Friday edition) or 12 noon on Friday (Tuesday edition).
- Lengthy or complicated notices should be forwarded several days before advertised closing date for copy. This is to ensure inclusion in current edition. Failure to observe this request could result in the notice being held over until the following edition.
- Proofs will be supplied only when requested.
- No additions or amendments to material for publication will be accepted by telephone.

Send copy to:

The Manager (Sales and Editorial),
State Law Publisher
Ground Floor, 10 William Street, Perth, 6000
Telephone: 321 7688 Fax: 321 7536

Advertisers should note:

- All Notices should be written in 'plain English'.
- Signatures (in particular) and proper names must be legible.
- All copy should be typed and double spaced.
- If it is necessary through isolation or urgency to communicate by facsimile, confirmation is not required by post. If original copy is forwarded later and published, the cost will be borne by the advertiser.
- Documents not clearly prepared and in the required format for gazettal, will be returned to the sender unpublished.
- Late copy received at State Law Publisher will be placed in the following issue irrespective of any date/s mentioned in the copy.

IMPORTANT COPYRIGHT NOTICE

© State of Western Australia

This work is copyright. Apart from any use as permitted under the *Copyright Act 1968*, no part may be reproduced by any process without written permission from the Government Printer, State Law Publisher. Inquiries should be directed to the Manager Sales & Editorial, State Law Publisher, 10 William St, Perth 6000.

Advertising Rates and Payments

INCREASE EFFECTIVE FROM 1 JULY 1995.

Deceased Estate notices, (per estate)—\$16.00

Real Estate and Business Agents and Finance Brokers Licences, (per notice)—\$37.30

Other Public Notices Section articles \$37.30 (except items of an exceptionally large nature, then arrangements will be made for invoicing).

All other Notices

Per Column Centimetre—\$7.40

Bulk Notices—\$137.00 per page

COUNTER SALES 1995-96

(As from 1 July 1995)

	\$
Government Gazette—(General)	2.30
Government Gazette—(Special)	
Up to 2 pages	2.30
Over 2 pages	4.60
Hansard	13.00
Industrial Gazette	11.60
Bound Volumes of Statutes	202.00

PUBLISHING DETAILS FOR CHRISTMAS 1995 AND NEW YEAR HOLIDAY PERIOD 1996

For *Government Gazette* published 3.30 pm Friday 29 December 1995, closing time for copy will be 12 noon Wednesday 27 December 1995.

For *Government Gazette* published 3.30 pm Friday 5 January 1996, closing time for copy will be 12 noon Wednesday 3 January 1996.

***Government Gazettes* will not be published on Tuesday 26 December 1995
or Tuesday 2 January 1996.**

PROCLAMATIONS

AA101

MAIN ROADS ACT 1930

DECLARATION OF ROADS THAT SHALL CEASE TO BE SECONDARY ROADS

PROCLAMATION

WESTERN AUSTRALIA
P. M. Jeffery,
Governor.
[L.S.]

} By His Excellency Major General Phillip Michael
Jeffery, Officer of the Order of Australia, Military
Cross, Governor of Western Australia.

MRWA 85-364V3.

Whereas by section 24 of the Main Roads Act 1930, it is provided that the Governor may on the recommendation of the Commissioner, by proclamation declare that any section or part of a road shall cease to be a Secondary Road; and whereas the Commissioner has recommended that the roads delineated on the Plans specified in Schedule 1 hereto shall cease to be a Secondary Road. Therefore, I the Governor, acting with the advice and consent of the Executive Council, in exercise of the powers conferred by section 24 of the Main Roads Act 1930, and pursuant to be said recommendations do hereby declare the roads delineated on the Plans and as generally described in Schedule 1 hereto shall cease to be Secondary Roads with effect on and from February 1 1996.

Given under my hand and the Public Seal of Western Australia, at Perth on 5 December 1995.

By His Excellency's Command,

E. J. CHARLTON, Minister for Transport.

GOD SAVE THE QUEEN !

Schedule 1

ROADS THAT SHALL CEASE TO BE SECONDARY ROADS

Road No.	Road Name	Local Authority	As Delineated on Plan No.
S002	Albany-Nanarup	Albany	9522-123
S003	Albany-Youngs Siding	Albany, Albany Town	9522-123, 124, 128
S007	Bindon-Gingin	Chittering, Gingin	9422-075 9522-213, 214
S016	Burakin-Wialki	Koorda, Mt Marshall Wongan-Ballidu	9422-084, 089, 090 9522-057, 059
S017	Camballin	Derby-West Kimberley	9522-148, 149
S021	Carnamah-Perenjori	Carnamah, Perenjori	9422-102, 103 9522-171, 173
S022	Carnarvon-Mullewa	Carnarvon, Mullewa, Murchison Upper Gascoyne	9522-025, 115, 116 9522-167, 168, 170
S029	Coorow-Latham	Coorow, Perenjori	9422-129, 130 9522-171, 172
S032	Cunderdin-Quairading	Cunderdin, Quairading	9522-181, 182, 202, 203
S033	Cunderdin-Wyalkatchem	Cunderdin, Wyalkatchem	9422-100, 101 9522-202, 203
S035	Dalwallinu-Kalannie	Dalwallinu	9522-205, 207, 208
S041	Dowerin-Kalannie	Dalwallinu, Dowerin Wongan-Ballidu	9522-057, 059, 060 9522-205, 208, 211, 212
S046	Frenchman Bay	Albany, Albany Town	9422-123 9522-128
S048	Geraldton-Yuna	Chapman Valley, Geraldton City Greenough	9522-011, 157, 158, 159 9522-160, 163
S049	Gingin Brook	Gingin	9522-213
S051	Gnowangerup-Tambellup	Gnowangerup, Tambellup	9422-005, 029 9522-144, 145
S059	Kellerberrin-Yoting	Quairading, Kellerberrin	9522-181, 218, 220
S061	Kondinin-Narembeen	Kondinin, Narembeen	9422-111, 135, 136
S062	Koorda-Mollerin	Koorda	9422-084, 085
S063	Kulin-Dumbleyung	Dumbleyung, Kulin	9422-132 9522-084
S068	Laverton-Warburton	Laverton, Ngaanyatjaraku	9522-089, 090, 097, 098
S069	Manjimup-Carlotta	Manjimup, Nannup	9422-047, 052
S070	Meckering-Dowerin	Cunderdin, Dowerin	9522-202, 204, 211, 212
S071	Merredin-Narembeen	Narembeen, Merredin	9422-135, 136 9522-221, 223
S074	Mingenew-Mullewa	Mingenew, Mullewa	9422-117, 118 9522-167

Road No.	Road Name	Local Authority	As Delineated on Plan No.
S084	Nannup-Pemberton	Manjimup, Nannup	9422-047, 051, 052, 057
S085	Narembreen-Mt Walker East	Narembreen	9422-135
S086	Narrogin-Harrismith	Narrogin, Narrogin Town, Wickpin	9522-152, 154, 187, 198
S088	North Bannister-Pingelly	Pingelly, Wandering	9522-155, 156, 185, 186
S089	North Dandalup-Dwellingup	Murray	9422-055-1, 054-1 9522-200
S091	Northam-Toodyay	Northam, Northam Town, Toodyay	9422-096 9522-015, 020
S093	Northampton-Nabawa	Chapman Valley, Northampton	9522-048, 052, 157, 158
S094	Northcliffe-Windy Harbour	Manjimup	9422-047, 058
S095	Old Bunbury	Murray, Waroona	9422-055-1 9522-001
S100	Pemberton-Northcliffe	Manjimup	9422-047, 058
S104	Pinjarra-Williams	Murray, Boddington, Williams	9422-055-1, 053-1, 054-1, 125, 142 9522-055, 056
S106	Quairading-Corrigin	Corrigin, Quairading	9522-079, 181, 182
S108	Southern Cross-Koolyanobbing	Yilgarn	9522-021, 024, 147, 146
S109	Southern Cross-Marvel Loch	Yilgarn	9522-021, 023, 024, 146
S112	Tammin-Wyalkatchem	Tammin, Wyalkatchem	9422-100, 101 9522-224, 225
S116	Walkaway-Nangetty	Greenough, Mullewa	9522-011, 013, 167
S117	Wandering-Narrogin	Cuballing, Narrogin, Narrogin Town Wandering	9522-081, 152, 154, 185
S118	Warralakin	Westonia	9422-120, 122
S120	Westonia	Westonia	9422-120, 121, 123
S122	Wickepin South	Narrogin, Wickpin	9522-152, 187, 188
S125	Wongan Hills-Burakin	Wongan-Ballidu	9522-057, 059
S126	Wongan Hills-Calingiri West	Chittering, Victoria Plains Wongan-Ballidu	9422-075, 098, 099 9522-057, 061
S127	Wongan Hills-Koorda	Koorda, Dowerin, Wongan-Ballidu	9422-084, 085 9522-057, 060, 061, 211
S128	Wongan Hills-Waddington	Victoria Plains, Wongan-Ballidu	9422-098 9522-057, 061
S130	Wubin-Gunyidi	Coorow, Dalwallinu	9422-129 9522-205, 210
S131	Gingin Access	Gingin	9522-213, 214
S132	York-Tammin	Quairading, Cunderdin Tammin, York	9522-181, 202, 224 9522-225, 229, 230
S133	Yuna-Tenindewa	Chapman Valley, Mullewa	9522-157, 160 9522-167
S135	Roebourne-Wittenoom	Ashburton, Roebourne	9522-030, 035, 040
S136	Corrigin-Narembreen	Corrigin, Narembreen	9422-135 9522-079
S137	Kingsbury Drive	Serpentine-Jarrahdale	9522-191, 193
S138	Canning Dam	Armadale City	9422-033

AA102

MAIN ROADS ACT 1930

DECLARATION OF ROADS THAT SHALL CEASE TO BE HIGHWAYS AND MAIN ROADS

PROCLAMATION

WESTERN AUSTRALIA
P. M. Jeffery,
Governor.
[L.S.]

} By His Excellency Major General Philip Michael
Jeffery, Officer of the Order of Australia, Military
Cross, Governor of Western Australia.

MRWA 85-364V3.

Whereas by section 13 of the Main Roads Act 1930, it is provided that the Governor may on the recommendation of the Commissioner, by proclamation declare that any section or part of a road shall cease to be a Highway or shall cease to be a Main Road; and whereas the Commissioner has recommended that the road or section of road delineated on the Plans specified in Schedule 1 hereto shall cease to be Highways and the road or section of road delineated on the Plans specified in Schedule 2 shall cease to be Main Roads. Therefore, I the Governor, acting with the advice and consent of the Executive Council, in exercise of the powers conferred by section 13 of the Main Roads Act 1930, and pursuant to the said recommendations do hereby declare the road or section of road delineated on the

Plans and as generally described in Schedule 1 hereto shall cease to be Highways with effect on and from February 1 1996 and the road or section of road delineated on the Plans and as generally described in Schedule 2 shall cease to be Main Roads with effect on and from February 1 1996.

Given under my hand and the Public Seal of Western Australia, at Perth on 5 December 1995.

By His Excellency's Command,

E. J. CHARLTON, Minister for Transport.

GOD SAVE THE QUEEN !

Schedule 1
ROADS THAT SHALL CEASE TO BE HIGHWAYS

Road No.	Road Name	Local Authority	As Delineated on Plan No.
H002	Highway H2 (Perth-Bunbury)	Bunbury City, Harvey	9422-020, 066, 067
H016	Mitchell Freeway (Ramp #515)	Perth City	9422-038, 116
H019	Great Eastern Highway Bypass	Swan	9422-039, 119

Schedule 2
ROADS THAT SHALL CEASE TO BE MAIN ROADS

Road No.	Road Name	Local Authority	As Delineated on Plan No.
M002	Armada-le-Bunbury	Armada-le City, Bunbury City Dardanup, Harvey, Murray Waroona, Serpentine-Jarrahdale	9422-020, 027, 033, 053-1, 055-1, 066 9422-068, 069, 070, 071, 074, 115 9522-001, 002, 191, 199, 200 9522-192, 194
M003	Armada-le-Ravensthorpe	Armada-le City, Beverley, Brookton Corrigin, Kondinin, Kulin Lake Grace, Ravensthorpe	9422-033, 111, 112, 113, 114 9422-132, 134 9522-075, 077, 078, 079, 080 9522-119, 121, 140
M006	Bruce Rock-Narembeen	Bruce Rock, Narembeen	9422-127, 128, 135, 136
M011	Derby	Derby-West Kimberley	9522-148, 150
M015	Geraldton-Mt. Magnet	Geraldton City, Greenough Mullewa, Yalgoo, Mt Magnet	9522-011, 014, 163, 166 9522-167, 168, 169, 178, 179, 180
M018	Kalgoorlie-Meekatharra	Meekatharra, Kalgoorlie/Boulder City Leonora, Menzies, Wiluna	9522-086, 087, 088, 091, 092, 093 9522-094, 095, 096, 099, 100, 164, 165
M019	Kambalda	Coolgardie, Kalgoorlie/Boulder City	9522-086, 087, 088 9522-101, 102, 104
M020	Karratha-Dampier	Roebourne	9522-040, 041, 042, 065
M025	Manjimup-Pemberton	Manjimup	9422-047, 057
M033	Albany Port	Albany Town	9522-128
M038	Williams-Kulin	Narrogin, Narrogin Town, Williams	9522-152, 154, 055, 056
M040	Wyalkatchen-Southern Cross	Koorda, Mt Marshall, Mukinbudin, Nungarin, Westonia, Wyalkatchem, Yilgarn	9422-084, 085, 089, 091, 092 9422-093, 094, 100, 101, 120, 122 9522-021, 022, 146
M042	Guildford	Bassendean Town, Bayswater Stirling City, Vincent Town, Swan	9422-035, 039, 042, 046, 119 9522-069
M043	Cockburn	Cockburn City, Kwinana Town	9422-036 9522-003
M047	Fremantle Traffic Bridge	Fremantle City	9422-032-1
M049	Limestone-Marble Bar	East Pilbara	9522-036-1, 037
M050	Brearley Ave	Belmont City	9522-070
M052	Tydemans	Fremantle City	9422-032-1

AA103

MAIN ROADS ACT 1930
DECLARATION OF HIGHWAYS AND MAIN ROADS
PROCLAMATION

WESTERN AUSTRALIA
P. M. Jeffery,
Governor.
[L.S.]

} By His Excellency Major General Philip Michael
Jeffery, Officer of the Order of Australia, Military
Cross, Governor of Western Australia.

MRWA 85-364V3.

Whereas by section 13 of the Main Roads Act 1930, it is provided that the Governor may on the recommendation of the Commissioner, by proclamation declare that any section or part of a road shall be a Highway or shall be a Main Road; and whereas the Commissioner has recommended that the road or section of road delineated on the Plans specified in Schedule 1 hereto shall be Highways and the road or section of road delineated on Plans specified in Schedule 2 hereto shall be Main Roads.

Therefore, I the Governor, acting with the advice and consent of the Executive Council, in exercise of the powers conferred by section 13 of the Main Roads Act 1930, and pursuant to the said recommendations do hereby declare the road or section of road delineated on the Plans and as generally described in Schedule 1 hereto shall be Highways with effect on and from February 1 1996 and the road or section of road delineated on the Plans and as generally described in Schedule 2 shall be Main Roads, with effect on and from February 1 1996; but the footpaths, if any of such roads are excluded from this proclamation.

Given under my hand and the Public Seal of Western Australia, at Perth on 5 December 1995.

By His Excellency's Command,

E. J. CHARLTON, Minister for Transport.

GOD SAVE THE QUEEN !

Schedule 1
ROADS THAT SHALL BE PROCLAIMED TO BE HIGHWAYS

Road No.	Road Name	Local Authority	As Delineated on Plan No.
H009	South Western	Armadale City, Bunbury City Dardanup, Harvey, Murray Serpentine-Jarrahdale, Waroona	9422-020, 027, 033, 053-1, 055-1, 066 9422-068, 069, 070, 071, 074, 115 9522-001, 002, 191, 192, 194 9522-199, 200
H024	Brearley Ave	Belmont City	9522-070
H025	Cockburn Road	Cockburn City, Kwinana Town	9422-036 9522-003
H026	Guildford Road	Bassendean Town, Bayswater City Mundaring, Perth City, Stirling City Swan, Vincent Town	9422-035, 038, 039, 042, 046 9422-119, 137, 138 9522-069
H030	Port Beach Road	Fremantle City	9422-032-1
H031	Queen Victoria Street	Fremantle City	9422-032-1
H032	South Street	Canning City, Fremantle City Melville City	9422-032-1, 034, 037
H034	Tydean Road	Fremantle City	9422-032-1
H036	West Coast Highway	Cambridge Town, Nedlands City Stirling City	9422-041, 042, 045
H040	Albany Port Road	Albany Town	9522-128
H041	Anzac Drive	Kalgoorlie/Boulder City	9522-086, 087, 088
H046	Dampier Road	Roebourne	9522-040, 041, 042, 065
H047	Derby Road	Derby-West Kimberley	9522-148, 150
H049	Goldfields Highway	Coolgardie, Kalgoorlie/Boulder City Leonora, Meekatharra, Menzies Wiluna	9522-086, 087, 088, 101, 102, 104 9522-091, 092, 093, 094, 095, 096 9522-099, 100, 164, 165
H050	Mid West Highway	Geraldton City, Greenough, Mt. Magnet Mullewa, Yalgoo	9522-011, 014 9522-163, 166, 167, 168, 169, 178, 179
H052	South Eastern Highway (Brookton Highway)	Armadale City, Beverley, Brookton Corrigin, Kondinin, Kulin Lake Grace, Ravensthorpe	9422-033, 111, 112, 113, 114 9422-132, 134 9522-075, 077, 078, 079, 080 9522-119, 121, 140
H053	Williams-Narrogin Road	Narrogin, Narrogin Town, Williams	9522-055, 056, 152, 154

Schedule 2
ROADS THAT SHALL BE PROCLAIMED TO BE MAIN ROADS

Road No.	Road Name	Local Authority	As Delineated on Plan No.
M002	Bindoon-Moora	Chittering, Moora, Victoria Plains	9422-075, 078, 086, 087, 088, 098
M003	Boddington	Boddington	9422-125, 126, 142
M006	Bridgetown-Boyup Brook	Boyup Brook, Bridgetown-Greenbushes	9422-016-1, 017, 018, 019
M008	Vasse	Busselton, Nannup, Manjimup	9422-021, 047, 051, 052, 057
M009	Burrup Peninsula	Roebourne	9522-040, 065
M011	Denham	Shark Bay	9422-109, 110
M015	Gnowangerup-Stirling Range	Gnowangerup	9422-005
M018	Jurien	Dandaragan	9422-079, 083
M019	Kalbarri	Northampton	9522-048, 049, 051-1
M020	Marvel Loch	Yilgarn	9522-021, 023, 024, 146
M025	Mingenew-Morawa	Mingenew, Morawa	9422-117, 118 9522-046, 047
M031	Northam-Cranbrook	Narrogin Town	9522-154

Road No.	Road Name	Local Authority	As Delineated on Plan No.
M033	Northam-Toodyay	Northam, Northam Town, Toodyay	9422-096 9522-015, 020
M036	Northcliffe	Manjimup	9422-047, 058
M038	Narrogin-Kondinin	Kondinin, Kulin, Narrogin Shire, Narrogin Town Wickepin	9422-111, 114, 132, 133 9522-152, 154, 187, 188
M042	Capel-Donnybrook	Capel, Donnybrook-Balingup	9422-022, 024, 049, 050
M043	Caves	Augusta-Margaret River, Busselton	9422-015, 021, 059
M047	Coral Bay	Carnarvon	9522-025, 027
M049	Onslow	Ashburton	9522-030, 031
M050	Pannawonica	Ashburton	9522-030, 032
M051	Paraburdoo-Tom Price	Ashburton	9522-030, 033, 034
M053	Pinjarra-Williams	Murray, Boddington, Williams	9422-053-1, 054-1, 055-1, 125, 142, 9522-055, 056
M056	Wongan Hills-Calingiri	Chittering, Victoria Plains Wongan-Ballidu	9422-075, 098, 099 9522-057, 061
M057	Monkey Mia	Shark Bay	9422-109, 110

BUSH FIRES BOARD

BU301

BUSH FIRES ACT 1954

The Municipality of the Shire of Broome

By-law Relating to Establishment, Maintenance and Equipment of Bush Fire Brigades

1. ESTABLISHMENT OF BRIGADE

- (a) By resolution, the Council may establish and equip a Bush Fire Brigade under the provisions of the Bush Fires Act 1954 (as amended) and Regulations thereunder, the Brigade shall be formed in accordance with these By-laws, and a name shall be given to the Brigade. Details of the Brigade and its Officers shall be entered in the register of the Bush Fire Brigade held by Council.
- (b) A Bush Fire Brigade may be established for the whole of the Shire of Broome for any specified area thereof.

2. APPOINTMENT OF OFFICERS

- (a) By the authority of Council, the Bush Fire Brigade shall duly elect a Captain, a first Lieutenant and such additional Lieutenants as it deems necessary to act as Officers of the Brigade.
- (b) Members of the Brigade shall elect a person to act as Secretary of the Brigade and shall inform Council accordingly.
- (c) The Council may appoint an equipment officer who shall be responsible for the custody and maintenance in good order and condition of all equipment and appliances acquired by the Council for the purposes of the Brigade.
- (d) The foregoing appointments are subject to the approval of Council.

3. POWERS AND DUTIES OF OFFICERS

The membership of a Bush Fire Brigade may consist of the following—

- (a) Fire fighting members shall be those persons being a member of either sex and being seventeen (17) years of age and over who are willing to render service at any Bush Fire when called upon, and who sign an undertaking form contained in the First Schedule of these By-laws.
- (b) Persons being sixteen (16) years of age are eligible to join a Brigade as a trainee member, but may not be engaged operationally in fire fighting duties until the age of seventeen (17) years of age.
- (c) No fees or subscription shall be payable by fire fighting members and the enrolment of persons as such members shall in every case be subject to the approval of Council.

4. FINANCE

The expenditure incurred by the Council in the purchase of equipment, payment for services and generally for the purpose of this Act, shall be a charge on the ordinary revenue of the Council and a recording of such expenditure shall be maintained in accordance with Municipal Audit requirements.

5. MEETING OF BRIGADE

Meetings will be held as necessary.

FIRST SCHEDULE
FORM OF ENROLMENT—FIRE FIGHTING MEMBER

I,, the undersigned, hereby make application to be enrolled as a Fire Fighting Member of the 12 Mile Bush Fire Brigade.

My private address is:

My business address is:

I can be contacted by telephone number:

I hereby declare that I am over seventeen (17) years of age and in good health.

On enrolment as a Fire Fighting Member, I hereby undertake—

1. To promote the objects of the Brigade as far as shall be in my power,
2. To be governed by the provisions of the Constitution, such By-laws and Regulations as may from time to time be made hereunder,
3. To use my best endeavour to give assistance in fire fighting measures when called upon on such occasions to obey all orders and instructions issued by duly Authorised Officers of the Brigade.

Applicant's Signature:

Name in Full:

Signature of Parent/Guardian:
 (if under 18 years of age)

Name in Full:

 Brigade Secretary to detach this portion.

Please list here all fire fighting equipment owned by you.

.....

Dated this..... day of..... 1995

The Common Seal of the Shire of Broome was hereunder affixed by authority of a resolution of Council in the presence of—

R. JOHNSTON, President.
 G. POWELL Shire Clerk.

Recommended—

R. L. WIESE, Minister for Emergency Services.

Approved by His Excellency the Governor in Executive Council the 5th day of December 1995.

J. PRITCHARD, Clerk of the Council.

EDUCATION

ED401

EDUCATION ACT 1928

Declaration of School Boundaries Pursuant to Paragraph (b) of Subsection (2) of Section 21

The Hon. Minister for Education has declared that from January 1996 children attending Government primary schools listed hereunder and proceeding to a Government secondary school shall attend the secondary school as directed. The only exceptions shall be those stated in this notice or in cases where students have changed their place of residence, or when written approval for attendance elsewhere has been obtained from the undersigned.

GREG BLACK, Director—General of Education.

**SECONDARY SCHOOLS, THEIR CONTRIBUTORY PRIMARY SCHOOLS AND SPECIAL
ENROLMENT CONDITIONS**

Secondary Schools and Contributory Primary Schools	Options, Exceptions, if any
Albany Senior High Albany Flinders Park Mount Manypeaks Spencer Park	<p>Children from Booragoon Primary School have the option of attending either Applecross Senior High School or Melville Senior High School.</p> <p>Children from Brentwood Primary School have the option of attending either Applecross Senior High School or Rossmoyne Senior High School.</p> <p>Children of secondary school age living in the area bounded by Leach Highway, Winthrop Drive, Somerville Boulevard and Murdoch Drive shall have the option of attending either Applecross or Melville Senior High School.</p> <p>Children of secondary school age living in the locality of Murdoch and north of South Street shall have the option of attending either Applecross or Melville Senior High School.</p>
Applecross Senior High Applecross Ardross Booragoon Brentwood Mt Pleasant Winthrop	<p>The following constitutes a boundary between Armadale and Kelmscott Senior High Schools:</p> <p>From the railway line, east along Galliers Avenue to Albany Highway, north along Albany Highway to the locality boundary between Armadale and Kelmscott, east and south east along the locality boundary to the portion of Salter Road with an easterly orientation, east along Salter Road and its easterly extension for one kilometre beyond the intersection of Salter Road and Paterson Road. The boundary parts of Galliers Avenue and Salter Road are excluded from the catchment area for Armadale Senior High School.</p> <p>The following constitutes an optional area between Armadale and Cecil Andrews Senior High Schools:</p> <p>From the intersection of Lake Road and Ranford Road, north east along Lake Road to Bay Court, north west along Bay Court and its extension to the Southern River, north along the Southern River to the north westerly extension of Champion Drive (which corresponds with the locality boundary), north west along the extension of Champion Drive to the local government authority boundary between the Cities of Armadale and Gosnells, south west along the local government boundary to Ranford Road, and south west along Ranford Road to Lake Road. The boundary parts of Lake Road (west side) and Ranford Road (both sides) are included within the optional area, while Bay Court (both sides) is excluded from the optional area.</p>
Armadale Senior High Armadale Byford Forrestdale Gwynne Park Jarrahdale Kingsley Marri Grove Mundijong Oakford Serpentine	<p>The following constitutes a boundary for Australind Senior High School:</p> <p>From the intersection of the westerly extension of Pead Road with the coastline, east along the aforesaid extension of Pead Road, Pead Road and the easterly extension of Pead Road to the electricity transmission line, south along the electricity transmission line to a point due west from the confluence of the Mornington River and Wellesley River, east to the aforesaid confluence, south along the Wellesley River into the Brunswick River, south west along the Brunswick River to the Australind Bypass, south and south west along the Australind Bypass to the railway crossing, west and north west along the railway line to the railway bridge crossing the Preston River.</p> <p>The following constitutes the boundary for an optional area between Australind Senior High School and Harvey Agricultural Senior High School:</p> <p>From the Wellington Dam north west and west along the Colie River to the Australind Bypass, north along the Australind Bypass to the Brunswick River, east and north east along the Brunswick River to the confluence with the Wellesley River, north along the Wellesley River to the confluence with the</p>
Australind Senior High Australind Brunswick Junction Clifton Park Eaton Parkfield Roelands	

Secondary Schools and
Contributory Primary Schools

Options, Exceptions, if any

	Mornington River, east along the Mornington River to the intersection with Campbell Road, east to the intersection of Sandalwood Road with the South Western Highway and east along Sandalwood Road for a distance of three kilometres. The boundary parts of Sandalwood Road (both sides) are excluded from this optional area.
Balcatta Senior High	
Balcatta	
Birralee	Children from Lake Gwelup Primary School have the option of attending either Balcatta Senior High School or Scarborough Senior High School.
Lake Gwelup	Children from Osborne Primary School living in Main Street (both sides) and west thereof shall attend Balcatta Senior High School.
Osborne	Children from Osborne Primary School living in the area east of Main Street have the option of attending either Balcatta Senior High School or Mirrabooka Senior High School.
Takari	
West Balcatta	
Balga Senior High	
Balga	
Boyare	
Dryandra	
North Balga	
Waddington	
Warriapendi	
Ballajura Community College	
Alinjarra	The following constitutes a boundary for Ballajura Community College:
Ballajura	From the intersection of Alexander Drive and Marangaroo Drive, south along Alexander Drive to Marshall Road, east along Marshall Road to the proposed northern extension of the Tonkin Highway, north along the proposed extension of the Tonkin Highway to the boundary between the localities of Ballajura and Cullacabardee, north west, north and west along this locality boundary to the intersection with Marangaroo Drive, north west and west along the proposed Hepburn Avenue to Rangeview Road, south along Rangeview Road and its extension to Derbi Road, south along Derbi Road to Hillcrest Road, south west along Hillcrest Road to Gerosa Place, south along Gerosa Place to Marangaroo Drive and east along Marangaroo Drive to Alexander Drive. The boundary parts of Alexander Drive (east side), Marshall Road (north side), proposed Hepburn Avenue (south side), Rangeview Road (both sides), Hillcrest Road (both sides) and Marangaroo Drive (north side), and the boundary streets of Derbi Road (both sides) and Gerosa Place (both sides) are included within the area for Ballajura Community College.
Illawarra	
South Ballajura	
Belmont Senior High	
Belmay	The following constitutes the boundary for Belmont Senior High School:
Belmont	From the junction of Belmont Avenue and Great Eastern Highway, south-east along Belmont Avenue and its extension through the Belmont shopping centre to Fulham Street, north-east along Fulham Street to Abernethy Road, south-east along Abernethy Road to Keane Street, north-east along Keane Street to Whiteside Street, south-east along Whiteside Street and its extension to the Tonkin Highway, south-east along the Tonkin Highway to Horrie Miller Drive, north along Horrie Miller Drive and its extension to the local government authority boundary (City of Belmont and Shire of Swan), north-west along the local government boundary to Great Eastern Highway, south-west along Great Eastern Highway to Ivy Street, north-west along Ivy Street to the Swan River, south and south-west along the Swan River to the north-westerly extension of Belmont Avenue to the Swan River, and south-east along this extension to the junction of Belmont Avenue and Great Eastern Highway. The boundary parts of Belmont Avenue (north side), Abernethy Road (both sides), Keane Street (both sides), Whiteside Street (both sides) and Ivy Street (both sides) are included within the area for Belmont Senior High School. The boundary parts of Belmont Avenue (south side) and Fulham Street (both sides) are excluded from the area for Belmont Senior High School.
Cloverdale	
Redcliffe	
Tranby	
Whiteside	

Secondary Schools and
Contributory Primary Schools

Options, Exceptions, if any

The following constitutes an optional area between Belmont and Kewdale Senior High Schools:

From the junction of Belmont Avenue and Great Eastern Highway, south-east along Belmont Avenue to Wright Street, south-west along Wright Street to Acton Avenue, north-west along Acton Avenue and its extension to the Swan River, north-east along the Swan River to the extension of Belmont Avenue to the Swan River, and south-east along this extension to the junction of Belmont Avenue and Great Eastern Highway. The boundary part of Belmont Avenue (south side) is included within this optional area. The boundary parts of Wright Street (both sides) and Acton Avenue (both sides) are excluded from this optional area.

Belridge Senior High

Beldon
Connolly
Eddystone
Edgewater
Heathridge
Joondalup
Kinross

Children living in the following area in the localities of Connolly and Currambine shall attend Belridge Senior High School:

From the intersection of Hodges Drive and Country Club Boulevard, north along Country Club Boulevard and continuing north to the golf course underpass at Shenton Avenue, west from the underpass to Connolly Drive, north along Connolly Drive to Moore Drive, east along Moore Drive to the intersection with the proposed extension of the Mitchell Freeway, south along the proposed extension of the Mitchell Freeway to Hodges Drive, and west along Hodges Drive to Country Club Boulevard. The boundary parts of Country Club Boulevard (east side), Shenton Avenue (north side), Connolly Drive (east side), Moore Drive (south side) and Hodges Drive (north side) are included within this area.

Children living in the locality of Joondalup shall attend Belridge Senior High School.

The following constitutes a boundary for an optional area between Belridge Senior High School and Clarkson High School:

From the intersection of Moore Drive and Connolly Drive, north along Connolly Drive to Burns Beach Road, east along Burns Beach Road to the proposed extension of the Mitchell Freeway, south along the proposed extension of the Mitchell Freeway to Moore Drive, and west along Moore Drive to Connolly Drive. The boundary parts of Connolly Drive (east side), Burns Beach Road (south side) and Moore Drive (north side) are included within this optional area.

Bunbury Senior High

Boyanup
Bunbury
Burekup
Carey Park
Cooinda
Dardanup
Picton
South Bunbury

The following constitutes a boundary between Bunbury Senior High School and Newton Moore Senior High School:

From the confluence of the Preston River with the Ferguson River, north west and west along the Preston River to the railway bridge, west and north west along the railway line to the intersection of the railway line and Forrest Avenue, west and north west along Forrest Avenue to Wisbey Street, south west along Wisbey Street to Yorla Road, north west along Yorla Road to Clarke Street East, west along Clarke Street East to Clarke Street, west along Clarke Street to Hoylake Avenue, and north west and west along Hoylake Avenue and its extension to the Indian Ocean.

Children from Carey Park Primary School living in the area north of (but not including) the above boundary have the option of attending either Bunbury Senior High School or Newton Moore Senior High School. Children from Carey Park Primary School living in Hoylake Avenue, Clarke Street and Clarke Street East (both sides in all cases) and the boundary parts of Yorla Road, Wisbey Street and Forrest Avenue (both sides in all cases), and south of the boundary shall attend Newton Moore Senior High School.

Children from South Bunbury Primary School living in the area north of (but not including) the above boundary shall attend Bunbury Senior High School.

Children from South Bunbury Primary School living in Hoylake Avenue, Clarke Street, and Clarke Street East (both sides in all cases) and the boundary parts of Yorla Road, Wisbey Street and Forrest Avenue (both sides in all cases), and south of the boundary shall attend Newton Moore Senior High School.

Secondary Schools and
Contributory Primary Schools

Options, Exceptions, if any

The following constitutes a boundary between Bunbury Senior High School and Harvey Agricultural Senior High School:

From the bridge carrying the Australind Bypass over the Collie River, east and south east along the Collie River to Wellington Dam.

The following constitutes a boundary between Australind and Bunbury Senior High Schools:

From the bridge carrying the Australind Bypass over the Collie River, south and south west along the Australind Bypass to the railway crossing, west and north west along the railway line to the railway bridge crossing the Preston River.

Cannington Senior High

Beckenham
Cannington
Gibbs Street
Queens Park
Wilson

Children from Wilson Primary School living in Leach Highway (south-east side) and south-east thereof shall attend Cannington Senior High School. Children from Wilson Primary School living in Leach Highway (north-west side) and north-west thereof shall attend Como Senior High School.

Carine Senior High

Carine
Davallia
Marmion
North Beach
Poynter

Cecil Andrews Senior High

Challis
Neerigen Brook
Willandra

The following constitutes an optional area between Cecil Andrews and Kelmscott Senior High Schools:

From the intersection of Lake Road and Champion Drive, south west along Lake Road to Bay Court, north west along Bay Court and its extension to the Southern River, north along the Southern River to the north westerly extension of Champion Drive, and south east along the extension of Champion Drive to Lake Road. The boundary parts of Lake Road (west side) and Bay Court (both sides) are included within the optional area.

The following constitutes an optional area between Armadale and Cecil Andrews Senior High Schools:

From the intersection of Lake Road and Ranford Road, north east along Lake Road to Bay Court, north west along Bay Court and its extension to the Southern River, north along the Southern River to the north westerly extension of Champion Drive (which corresponds with the locality boundary), north west along the extension of Champion Drive to the local government authority boundary between the Cities of Armadale and Gosnells, south west along the local government boundary to Ranford Road, and south west along Ranford Road to Lake Road. The boundary parts of Lake Road (west side) and Ranford Road (both sides) are included within the optional area, while Bay Court (both sides) is excluded from the optional area.

Churchlands Senior High

Churchlands
Doubleview
Kapinara
Scarborough
Wembley Downs
Woodlands

Children from Churchlands Primary School have the option of attending either Churchlands Senior High School or City Beach Senior High School.

Children from Kapinara Primary School living in the area to the east of Weaponess Road shall attend Churchlands Senior High School. Children from Kapinara Primary School living in Weaponess Road (both sides) and west thereof shall attend City Beach Senior High School.

Children from Wembley Downs Primary School living in the area north of Hale Road or in the area east of Weaponess Road south of Hale Road shall attend Churchlands Senior High School. Children from Wembley Downs Primary School living in Hale Road (both sides) west of Weaponess Road and south thereof and who live in Weaponess Road (both sides) south of Hale Road and west thereof have the option of attending either Churchlands Senior High School or City Beach Senior High School.

Secondary Schools and
Contributory Primary Schools

Options, Exceptions, if any

City Beach Senior High

Churchlands
City Beach
Floreat Park
Kapinara
Lake Monger
Wembley
Wembley Downs

Children from Churchlands Primary School have the option of attending either City Beach Senior High School or Churchlands Senior High School.

Children from Kapinara Primary School living in Weaponess Road (both sides) and west thereof shall attend City Beach Senior High School. Children from Kapinara Primary School living in the area to the east of Weaponess Road shall attend Churchlands Senior High School.

Children from Wembley Downs Primary School living in Hale Road (both sides) west of Weaponess Road and south thereof and who live in Weaponess Road (both sides) south of Hale Road and west thereof have the option of attending either City Beach Senior High School or Churchlands Senior High School. Children from Wembley Downs Primary School living in the area north of Hale Road or in the area east of Weaponess Road south of Hale Road shall attend Churchlands Senior High School.

Clarkson High

Clarkson
Kinross
Merriwa
Quinns Rocks

The following constitutes a boundary for Clarkson High School:

From the coastline, east along Burns Beach Road to the proposed extension of the Mitchell Freeway, north along the proposed Mitchell Freeway to the boundary between the localities of Alkimos and Eglinton, west along this locality boundary to the coastline, south along the coastline to Burns Beach Road. The boundary part of Burns Beach Road (north side only) is included within the area for Clarkson High School.

The following constitutes a boundary for an optional area between Clarkson High School and Ocean Reef Senior High School:

From the intersection of Burns Beach Road and Marmion Avenue, south along Marmion Avenue to Moore Drive, east along Moore Drive to Connolly Drive, north along Connolly Drive to Burns Beach Road and west along Burns Beach Road to Marmion Avenue. The boundary parts of Marmion Avenue (east side), Moore Drive (north side), Connolly Drive (west side) and Burns Beach Road (south side) are included within this optional area.

The following constitutes a boundary for an optional area between Belridge Senior High School and Clarkson High School:

From the intersection of Moore Drive and Connolly Drive, north along Connolly Drive to Burns Beach Road, east along Burns Beach Road to the proposed extension of the Mitchell Freeway, south along the proposed extension of the Mitchell Freeway to Moore Drive, and west along Moore Drive to Connolly Drive. The boundary parts of Connolly Drive (east side), Burns Beach Road (south side) and Moore Drive (north side) are included within this optional area.

Como Senior High

Collier
Como
Koonawarra
Manning
Wilson

Children from Wilson Primary School living in Leach Highway (north-west side) and north-west thereof shall attend Como Senior High School. Children from Wilson Primary School living in Leach Highway (south-east side) and south-east thereof shall attend Cannington Senior High School.

Coodanup Senior High

Dudley Park
Greenfields
Riverside

The following constitutes the boundary for the core area of Coodanup Senior High School:

From Channel Island in the Peel Inlet, north along the Mandurah Estuary to the 'old' Mandurah Bridge, east along Pinjarra Road to the intersection with Fremantle Road, north along Fremantle Road to Murdoch Drive, east along Murdoch Drive to Bortolo Drive, north east along Bortolo Drive to the intersection with Exchequer Avenue, east along Exchequer Avenue to Lakes Road, north and east along Lakes Road to the Serpentine River, south along the Serpentine River to Goegrup Lake, south across Goegrup lake to the Serpentine River and south from Goegrup Lake along the Serpentine River to the Peel Inlet. The boundary parts of Pinjarra Road (south side), Fremantle Road (east side), Bortolo Drive (east side) and Exchequer Avenue (south side), Lakes Road (east and south sides), Goegrup Lake (west side) and the Serpentine River (west side) are included within the core area for Coodanup Senior High School.

Secondary Schools and
Contributory Primary Schools

Options, Exceptions, if any

The following primary schools contribute in full or in part to Coodanup Senior High School: Dudley Park, Greenfields, Riverside. Children living within the area for the core area for Coodanup Senior High School, as designated above, shall attend Coodanup Senior High School.

The following shall constitute an optional area between Coodanup Senior High School and Mandurah Senior High School:

From the intersection of Fremantle Road and Murdoch Drive, east along Murdoch Drive to Bortolo Drive, north along Bortolo Drive to Exchequer Avenue, east along Exchequer Avenue to Lakes Road, north along Lakes Road to Gordon Road, west along Gordon Road to Fremantle Road and south along Fremantle Road to Murdoch Drive. The boundary parts of Murdoch Drive (north side), Bortolo Drive (west side), Exchequer Avenue (north side), Lakes Road (west side), Gordon Road (south side) and Fremantle Road (east side) are included within this optional area.

Craigie Senior High
Camberwarra
Craigie
Lymburner
Mullaloo Beach
Mullaloo Heights
Springfield

Children from Lymburner Primary School living in the following area shall attend Craigie Senior High School:

From the intersection of Whitfords Avenue and Marmion Avenue, south along Marmion Avenue to Cook Avenue, west along Cook Avenue to Wild Road, south along Wild Road to David Crescent, west along David Crescent to Mawson Crescent, south along Mawson Crescent to Flinders Avenue, west along Flinders Avenue to Whitfords Avenue, and north and east along Whitfords Avenue to Marmion Avenue. The boundary parts of Marmion Avenue (west side), Cook Avenue (both sides), and Whitfords Avenue (east and south sides) are included within this area. The boundary parts of Wild Road (both sides), David Crescent (both sides), Mawson Crescent (both sides) and Flinders Avenue (both sides) are excluded from this area.

The following constitutes a boundary for an optional area between Craigie Senior High School and Ocean Reef Senior High School:

From the Indian Ocean south of the east-west alignment of Merrifield Place, due east to Northshore Drive, north along Northshore Drive to Mullaloo Drive, in a general easterly direction along Mullaloo Drive to Kallaroo Place, east along Kallaroo Place to Marmion Avenue, north along Marmion Avenue to Ocean Reef Road, west along Ocean Reef Road to the junction with Oceanside Promenade, and due west to the Indian Ocean. The boundary part of Merrifield Place (both sides), Northshore Drive (west side), Mullaloo Drive (north side), Marmion Avenue (west side), Ocean Reef Road (south side) and the boundary street of Kallaroo Place (north side), are included within the optional area.

Duncraig Senior High
Duncraig
Glengarry
Sorrento

Eastern Hills Senior High
Chidlow
Darlington
Gidgegannup
Glen Forrest
Mount Helena
Mundaring
Parkerville
Sawyers Valley
Wooroloo

Children from Darlington Primary School have the option of attending either Eastern Hills Senior High School, Kalamunda Senior High School or Swan View Senior High School.

Children from Glen Forrest Primary School have the option of attending either Eastern Hills Senior High School, Kalamunda Senior High School or Swan View Senior High School.

Forrestfield Senior High
Dawson Park
Edney
Forrestfield
High Wycombe
Maida Vale
Wattle Grove
Woodlupine

Children from Wattle Grove Primary School have the option of attending either Forrestfield Senior High School or Lesmurdie Senior High School.

The following constitutes an optional area between Forrestfield and Kalamunda Senior High Schools:

From the intersection of the Great Eastern Highway Bypass and the railway line, east along the Great Eastern Highway Bypass to the Roc Highway, north along the Roc Highway to Bushmead Road, east along Bushmead Road to the boundary

Secondary Schools and
Contributory Primary Schools

Options, Exceptions, if any

between the Shires of Mundaring and Swan, south east along the shire boundary to Ridge Hill Road, south and south west along Ridge Hill Road to Watsonia Road, south, south east and south west along Watsonia Road to Kalamunda Road, south east along Kalamunda Road to Nangana Way, south along the north-south alignment of Nangana Way, south along the north-south alignment of Nangana Way to the walk trail, west along the walk trail to West Terrace, north west and north along West Terrace to Simeon Close, west along Simeon Close and its extension to Maud Road, and continuing west along Maud Road to Hawtin Road, north along Hawtin Road to Kent Road, west along Kent Road to Brewer Road, south along Brewer Road to Bruce Road, west along Bruce Road to Sultana Road East, north west along Sultana Road East to Sultana Road West, continuing north west along Sultana Road West to Milner Road, south west along Milner Road to the boundary between the localities of Forrestfield and High Wycombe, west along this locality boundary to the local government boundary between the City of Belmont and the Shire of Kalamunda, north, north west and north east along the Shire of Kalamunda boundary to the railway line and north along the railway line to the Great Eastern Highway Bypass. The boundary parts of the Great Eastern Highway Bypass (south side), Roe Highway (east side), Bushmead Road (south side), Ridge Hill Road (both sides), Watsonia Road (both sides), Kalamunda Road (south side), Nangana Way (both sides), West Terrace (both sides), Simeon Close (both sides), Maud Road (both sides), Kent Road (both sides), Brewer Road (both sides), Bruce Road (both sides), East Sultana Road (both sides), West Sultana Road (both sides) and Milner Road (both sides) are included in the optional area. The boundary parts of the Great Eastern Highway Bypass (north side), Roe Highway (west side), Bushmead Road (north side) and Kalamunda Road (north side) are excluded from this optional area.

Geraldton Senior High

There is no system of contributory primary schools operating with Geraldton Senior High School and John Willcock Senior High School.

The following constitutes a boundary between Geraldton Senior High School and John Willcock Senior High School:

From the junction of Willcock Drive and Olive Street, north-east and east along Olive Street to Brand Highway, north along Brand Highway to the junction with Durlacher Street, north along Durlacher Street to North West Coastal Highway, east, north-east and north along North West Coastal Highway to the Chapman River, and in a general south-easterly direction along the Chapman River to Ridley Road.

Children living in Olive Street (both sides) and north thereof, in the boundary parts of Brand Highway (west side) and Durlacher Street (west side) and west thereof and in the boundary part of North West Coastal Highway (north and west side only) and west thereof shall attend Geraldton Senior High School.

Children living south of Olive Street, in the boundary parts of Brand Highway (east side) and Durlacher Street (east side) and east thereof in each case, and in the boundary part of North West Coastal Highway (south, south-east and east sides only) and south and east thereof shall attend John Willcock Senior High School.

Secondary students travelling on the Northampton school bus and other school buses which transport students to Rangeway Primary School shall attend John Willcock Senior High School.

Secondary students travelling on all other school buses shall attend Geraldton Senior High School.

Girrawheen Senior High

Blackmore
Girrawheen
Hainsworth
Koondoola
Marangaroo
Montrose

Secondary Schools and
Contributory Primary Schools

Options, Exceptions, if any

Gosnells Senior High

Ashburton Drive
Gosnells
Huntingdale
Seaforth
Wirrabirra

The following constitutes the boundary for an optional area between Gosnells and Kelmscott Senior High Schools:

From the junction of Mills Road East and Tonkin Highway, south west along Tonkin Highway to the bridge over the Canning River, south along the Canning River to the local government boundary between the City of Armadale and the City of Gosnells, east, south and east along the local government boundary to the western boundary of the Cohunu Wildlife Sanctuary site, north along the western boundary of the Sanctuary site and continuing north to a point east of the junction of Mills Road East and Pages Way, west from this point to the junction of Mills Road East and Pages Way and in a generally westerly direction along Mills Road East to the junction with Tonkin Highway. The boundary parts of Tonkin Highway (south east side), Canning River (east side), Pages Way (both sides) and Mills Road East (both sides) are included within this optional area.

Governor Stirling Senior High

Bassendean
Guildford
Herne Hill
Middle Swan
Midland
Midvale
Upper Swan
West Midland

The following constitutes a boundary for Governor Stirling Senior High School:

From the bridge carrying Toodyay Road over Jane Brook, south-west along Toodyay Road to the Roe Highway, south along the Roe Highway to Great Eastern Highway, west along Great Eastern Highway to Lloyd Street, south along Lloyd Street to Clayton Street, south along Clayton Street to Military Road, south along Military Road to Bushmead Road, east along Bushmead Road to the Roe Highway, south along the Roe Highway to the Great Eastern Highway Bypass, west along the Great Eastern Highway Bypass to Great Eastern Highway, south-west along Great Eastern Highway to Ivy Street, north-west along Ivy Street to the Swan River, south and west along the Swan River to the extension of Iveson Place, north along Iveson Place to Reid Street, west along Reid Street to Elder Parade, north along Elder Parade to Chapman Street, west and north-west along Chapman Street to the railway line, north-east along the railway line to the Swan River, and generally north along the Swan River to the confluence with Ellenbrook.

The boundary parts of Toodyay Road (north side), Roe Highway (west side), Great Eastern Highway (north side), Lloyd Street (both sides), Bushmead Road (south side), Roe Highway (west side), Great Eastern Highway Bypass (north side), Elder Parade (east side) and Chapman Street (north side) are included within the area for Governor Stirling Senior High School.

The boundary parts of Toodyay Road (south side), Roe Highway (east side), Great Eastern Highway (south side), Military Road (both sides), Bushmead Road (north side), Roe Highway (east side), Great Eastern Highway Bypass (south side), Ivy Street (both sides), Iveson Place (both sides), Reid Street (both sides), Elder Parade (west side) and Chapman Street (south side) are excluded from the area for Governor Stirling Senior High School.

Children from Middle Swan Primary School living in the area west of the Roe Freeway shall attend Governor Stirling Senior High School.

The following constitutes the boundary for an optional area between Governor Stirling Senior High School and Swan View Senior High School:

From the intersection of Great Eastern Highway and Roe Highway, west along Great Eastern Highway to Bushby Street, north along Bushby Street and its extension northwards along the locality boundary to Eddie Barron Drive, east along the locality boundary between Middle Swan and Midvale to the Roe Highway, south along the Roe Highway to Great Eastern Highway. The boundary parts of Great Eastern Highway (both sides), Bushby Street (both sides) and Roe Highway (west side) are included within this optional area.

Greenwood Senior High

Dalmain
Goollelal
Greenwood
West Greenwood

Secondary Schools and
Contributory Primary Schools

Options, Exceptions, if any

Hamilton Senior High

Coogee
Coolbellup
East Hamilton Hill
Kardinya
Koorilla
Newton
North Lake
Phoenix
Samson
South Coogee
Southwell
Spearwood
Spearwood Alternative
Wattleup
Winterfold

The following constitutes a boundary for Hamilton Senior High School:

From the intersection of the coastline and the westward extension of Island Street, east along Island Street to Hampton Road, south along Hampton Road to Rockingham Road, south east along Rockingham Road to Carrington Street, north along Carrington Street to Winterfold Road, east along Winterfold Road and continuing along Torquil Road to North Lake Road, south along North Lake Road to the proposed Roe Highway, north east along the proposed Roe Highway to Progress Drive, south along Progress Drive to the eastward extension of Phoenix Road, west along the extension of Phoenix Road and Phoenix Road to Sudlow Road, south along Sudlow Road to Spearwood Avenue, north west along Spearwood Avenue to Wellard Street, south along Wellard Street to Barrington Street, west along Barrington Street to the railway line, and south along the railway line to the eastward extension of Fanstone Avenue. The boundary parts of Hampton Road (west side), Rockingham Road (south side), Carrington Street (east side), Winterfold Road (south side), Torquil Road (south side), North Lake Road (west side) and Progress Drive (both sides), are included within the area for Hamilton Senior High School. The boundary parts of Island Street and its extension are excluded from the area for Hamilton Senior High School.

Children from Winterfold Primary School living in Healy Road (both sides) and north thereof shall attend South Fremantle Senior High School. Children from Winterfold Primary School living in the area south of Healy Road have the option of attending either South Fremantle Senior High School or Hamilton Senior High School.

The following constitutes an optional area between Hamilton and South Fremantle Senior High Schools:

From the intersection of Stock Road and Winterfold Road, east along Winterfold Road and continuing into Torquil Road to North Lake Road, north along North Lake Road to South Street, west along South Street to Stock Road and south along Stock Road to Winterfold Road. The boundary parts of Winterfold Road (north side), Torquil Road (north side), North Lake Road (west side), South Street (south side) and Stock Road (east side) are included within this optional area.

The following constitutes an optional area between Hamilton and Melville Senior High Schools:

From the intersection of Farrington Road and North Lake Road, east along Farrington Road to Progress Drive, south along Progress Drive to the proposed Roe Highway, west along the proposed Roe Highway to North Lake Road, and north along North Lake Road to Farrington Road. The boundary parts of Farrington Road (south side), Progress Drive (both sides) and North Lake Road (east side) are included within this optional area.

Hampton Senior High

Anzac Terrace
Eden Hill
Embleton
Hampton Park
Morley
Noranda
Weld Square

Children from Eden Hill Primary School living in Walter Road (south side) and south thereof and in May Road and Iolanthe Street north of Walter Road (west side in each case) and west thereof shall attend Hampton Senior High School. Children from Eden Hill Primary School living in Walter Road (north side), east of Iolanthe Street, and north thereof and in May Road and Iolanthe Street north of Walter Road (east side in each case) and east thereof shall attend Lockridge Senior High School.

Children from Embleton Primary School living in Collier Road (both sides) and east and north thereof shall attend Hampton Senior High School. Children from Embleton Primary School living in the area west and south of Collier Road shall attend John Forrest Senior High School.

Children from Morley Primary School living in Old Collier Road (both sides) and that part of Collier Road (both sides) with a south easterly orientation, and east thereof south of Walter Road, shall attend Hampton Senior High School. Children from Morley Primary School living in the area west of Old

Secondary Schools and
Contributory Primary Schools

Options, Exceptions, if any

	<p>Collier Road and that part of Collier Road with a south easterly orientation, south of Walter Road, shall attend John Forrest Senior High School. Children from Morley Primary School living in Walter Road (both sides) and north and west thereof shall attend Morley Senior High School.</p> <p>Children from Noranda Primary School living in Crimea Street (east side) and east thereof shall attend Hampton Senior High School. Children from Noranda Primary School living in Crimea Street (west side) and west thereof shall attend Morley Senior High School.</p> <p>The following shall constitute an optional area between Hampton Senior High School and Lockridge Senior High School: From the junction of Benara Road and Beechboro Road, east along Benara Road to Milligan Avenue, south along Milligan Avenue to Bottlebrush Drive, south along Bottlebrush Drive to Telstar Drive, west along Telstar Drive to Beechboro Road, and north along Beechboro Road to Benara Road. The boundary parts of Benara Road (south side), Milligan Avenue (both sides), Bottlebrush Drive (west side), Telstar Drive (north side) and Beechboro Road (east side) are included within this optional area.</p>
<p>Harvey Agricultural Senior High Benger Brunswick Junction Harvey Roelands Yarloop</p>	<p>The following constitutes the southern boundary for Harvey Agricultural Senior High School: From the intersection of the westerly extension of Pead Road with the coastline, east along the aforesaid extension of Pead Road, Pead Road and the easterly extension of Pead Road to the electricity transmission line, south along the electricity transmission line to a point due west from the confluence of the Mornington River and Wellesley River, east to the aforesaid confluence, east along the Mornington River to the intersection with Campbell Road, east to the intersection of Sandalwood Road with the South Western Highway and east along Sandalwood Road for a distance of three kilometres. The boundary parts of Sandalwood Road (both sides) are included within the catchment area of Harvey Agricultural Senior High School.</p> <p>The following constitutes the boundary for an optional area between Australind Senior High School and Harvey Agricultural Senior High School: From the Wellington Dam north west and west along the Collier River to the Australind Bypass, north along the Australind Bypass to the Brunswick River, east and north east along the Brunswick River to the confluence with the Wellesley River, north along the Wellesley River to the confluence with the Mornington River, east along the Mornington River to the intersection with Campbell Road, east to the intersection of Sandalwood Road with the South Western Highway and east along Sandalwood Road for a distance of three kilometres. The boundary parts of Sandalwood Road (both sides) are excluded from this optional area.</p>
<p>Hollywood Senior High Claremont Dalkeith East Claremont Hollywood Jolimont Nedlands Rosalie</p>	
<p>John Curtin Senior High Bicton East Fremantle North Fremantle Palmyra Richmond</p>	<p>Children from Palmyra Primary School living in the area east of Stock Road have the option of attending either John Curtin Senior High School or Melville Senior High School. Children from Palmyra Primary School living in Stock Road (both sides) and west thereof shall attend John Curtin Senior High School.</p>
<p>John Forrest Senior High Ashfield Bayswater Dianella East Maylands Embleton Hillcrest Inglewood Morley West Morley</p>	<p>The following constitutes the boundary for John Forrest Senior High School: From the intersection of Morley Drive and Alexander Drive, east along Morley Drive to Light Street, south-east along Light Street to Walter Road West, north-east and east along Walter Road West to Old Collier Road, south east along Old Collier Road and continuing south east into Collier Road, south east along Collier Road to the railway line, south-west along the railway line to Chapman Street, south-east along Chapman</p>

Secondary Schools and
Contributory Primary Schools

Options, Exceptions, if any

	<p>Street to Elder Parade, south along Elder Parade to Reid Street, east along Reid Street to Iveson Place, south along Iveson Place and its extension to the Swan River, south-west and west along the Swan River foreshore to the extension of Fogerthorpe Crescent, north along Fogerthorpe Crescent to Peninsula Road, west along Peninsula Road to Joseph Street, north along Joseph Street to Mephan Street, north-east along Mephan Street to Caledonian Avenue, north-west along Caledonian Avenue to the railway line, north-east along the railway line to Kennedy Street, north-west along Kennedy Street, Eleventh Avenue, Dundas Road and Homer Street to Alexander Drive, and north along Alexander Drive to Morley Drive. The boundary parts of Morley Drive (south side), Chapman Street (south side), Elder Parade (west side), Reid Street (both sides), Iveson Place (both sides), Fogerthorpe Crescent (both sides), Peninsula Road (both sides), Joseph Street (east side), Mephan Street (east side), Caledonian Avenue (north-east side), Homer Street (north-east side) and Alexander Drive (east side) are included within the area for John Forrest Senior High School.</p> <p>The boundary parts of Light Street (both sides), Walter Road West (both sides), Collier Road (both sides), Chapman Street (north side), Elder Parade (east side), Joseph Street (west side), Mephan Street (west side), Caledonian Avenue (south-west side), Homer Street (south-west side) and Alexander Drive (west side) are excluded from the area for John Forrest Senior High School.</p> <p>The following primary schools also contribute to other senior high schools:</p> <p>Dianella, Embleton, Inglewood, Morley and West Morley.</p>
John Willcock Senior High	<p>There is no system of contributory primary schools operating with John Willcock Senior High School and Geraldton Senior High School.</p> <p>The following constitutes a boundary between John Willcock Senior High School and Geraldton Senior High School:</p> <p>From the junction of Willcock Drive and Olive Street, north-east and east along Olive Street to Brand Highway, north along Brand Highway to the junction with Durlacher Street, north along Durlacher Street to North West Coastal Highway, east, north-east and north along North West Coastal Highway to the Chapman River, and in a general south-easterly direction along the Chapman River to Ridley Road.</p> <p>Children living south of Olive Street, in the boundary parts of Brand Highway and Durlacher Street (east side only) and east thereof in each case, and in the boundary part of North West Coastal Highway (south, south-east and east sides only) and south and east thereof shall attend John Willcock Senior High School.</p> <p>Children living in Olive Street (both sides) and north thereof, in the boundary parts of Brand Highway and Durlacher Street (west side only) and west thereof and in the boundary part of North West Coastal Highway (north and west side only) and west thereof shall attend Geraldton Senior High School.</p> <p>Secondary students travelling on the Northampton school bus and other school buses which transport students to Rangeway Primary School shall attend John Willcock Senior High School. Secondary students travelling on all other school buses shall attend Geraldton Senior High School.</p>
Kalamunda Senior High	
Darlington	
Edney	
Falls Road	
Glen Forrest	
Gooseberry Hill	
High Wycombe	
Kalamunda	
Maida Vale	
Walliston	<p>Children from Falls Road Primary School living in the area north of Falls Road and the portion of Lesmurdie Road north of Falls Road shall attend Kalamunda Senior High School. Children from Falls Road Primary School living in the area south of Falls Road and south of the portion of Lesmurdie Road north of Falls Road shall attend Lesmurdie Senior High School. Children living in Falls Road and the boundary part of Lesmurdie Road have the option of attending either Kalamunda Senior High School or Lesmurdie Senior High School.</p> <p>Children from Walliston Primary School living in the area north of Lesmurdie Road, Jackson Road, and a line connecting the</p>

Secondary Schools and
Contributory Primary Schools

Options, Exceptions, if any

junction of Jackson Road and Stanhope Road with the junction of Mundaring Weir Road and Aldersyde Road shall attend Kalamunda Senior High School. Children from Walliston Primary School living in the area south of Lesmurdie Road, Jackson Road, and a line connecting the junction of Jackson Road and Stanhope Road with the junction of Mundaring Weir Road and Aldersyde Road shall attend Lesmurdie Senior High School. Children living in the boundary part of Lesmurdie Road and in Jackson Road have the option of attending either Kalamunda Senior High School or Lesmurdie Senior High School.

The following constitutes an optional area between Forrestfield and Kalamunda Senior High Schools:

From the intersection of the Great Eastern Highway Bypass and the railway line, east along the Great Eastern Highway Bypass to the Roe Highway, north along the Roe Highway to Bushmead Road, east along Bushmead Road to the boundary between the Shires of Mundaring and Swan, south east along the shire boundary to Ridge Hill Road, south and south west along Ridge Hill Road to Watsonia Road, south, south east and south west along Watsonia Road to Kalamunda Road, south east along Kalamunda Road to Nangana Way, south along the north-south alignment of Nangana Way, south along the north-south alignment of Nangana Way to the walk trail, west along the walk trail to West Terrace, north west and north along West Terrace to Simeon Close, west along Simeon Close and its extension to Maud Road, and continuing west along Maud Road to Hawtin Road, north along Hawtin Road to Kent Road, west along Kent Road to Brewer Road, south along Brewer Road to Bruce Road, west along Bruce Road to Sultana Road East, north west along Sultana Road East to Sultana Road West, continuing north west along Sultana Road West to Milner Road, south west along Milner Road to the boundary between the localities of Forrestfield and High Wycombe, west along this locality boundary to the local government boundary between the City of Belmont and the Shire of Kalamunda, north, north west and north east along the Shire of Kalamunda boundary to the railway line and north along the railway line to the Great Eastern Highway Bypass. The boundary parts of the Great Eastern Highway Bypass (south side), Roe Highway (east side), Bushmead Road (south side), Ridge Hill Road (both sides), Watsonia Road (both sides), Kalamunda Road (south side), Nangana Way (both sides), West Terrace (both sides), Simeon Close (both sides), Maud Road (both sides), Kent Road (both sides), Brewer Road (both sides), Bruce Road (both sides), East Sultana Road (both sides), West Sultana Road (both sides) and Milner Road (both sides) are included in the optional area. The boundary parts of the Great Eastern Highway Bypass (north side), Roe Highway (west side), Bushmead Road (north side) and Kalamunda Road (north side) are excluded from this optional area.

Children from Darlington Primary School have the option of attending either Eastern Hills Senior High School, Kalamunda Senior High School or Swan View Senior High School

Children from Glen Forrest Primary School have the option of attending either Eastern Hills Senior High School, Kalamunda Senior High School or Swan View Senior High School.

Kelmscott Senior High
Clifton Hills
Grovelands
Kelmscott
Kingsley
Westfield Park

The boundary between Kelmscott Senior High School and Roleystone District High School is the north-south boundary between the localities of Kelmscott and Roleystone, with children living to the east of this boundary being directed to Roleystone District High School and those living to the west of this boundary being directed to Kelmscott Senior High School, except that children living in the area bounded on the north by Chevin Road, on the west by Canning Mills Road, on the south by a line drawn due east from Canning Mills Road at a point due west of the southern extremity of Coventry Road to the locality boundary between Kelmscott and Roleystone, and on the east by the afore-mentioned locality

Secondary Schools and
Contributory Primary Schools

Options, Exceptions, if any

boundary, have the option of attending either Kelmscott Senior High School or Roleystone District High School, with the boundary parts of Chevin Road and Canning Mills Road (both sides in each case) being included in the optional area.

The following constitutes an optional area between Cecil Andrews and Kelmscott Senior High Schools:

From the intersection of Lake Road and Champion Drive, south west along Lake Road to Bay Court, north west along Bay Court and its extension to the Southern River, north along the Southern River to the north westerly extension of Champion Drive, and south east along the extension of Champion Drive to Lake Road. The boundary parts of Lake Road (west side) and Bay Court (both sides) are included within the optional area.

The following constitutes a boundary between Armadale and Kelmscott Senior High Schools:

From the railway line, east along Galliers Avenue to Albany Highway, north along Albany Highway to the locality boundary between Armadale and Kelmscott, east and south-east along the locality boundary to the portion of Salter Road with an easterly orientation, and east along Salter Road and its easterly extension for one kilometre beyond the intersection of Salter Road and Paterson Road. The boundary parts of Galliers Avenue (both sides) and Salter Road (both sides) are included within the catchment area of Kelmscott Senior High School.

The following constitutes the boundary for an optional area between Gosnells and Kelmscott Senior High Schools:

From the junction of Mills Road East and Tonkin Highway, south west along Tonkin Highway to the bridge over the Canning River, south along the Canning River to the local government boundary between the City of Armadale and the City of Gosnells, east, south and east along the local government boundary to the western boundary of the Cohunu Wildlife Sanctuary site, north along the western boundary of the Sanctuary site and continuing north to a point east of the junction of Mills Road East and Pages Way, west from this point to the junction of Mills Road East and Pages Way and in a generally westerly direction along Mills Road East to the junction with Tonkin Highway. The boundary parts of Tonkin Highway (south east side), Canning River (east side), Pages Way (both sides) and Mills Road East (both sides) are included within this optional area.

Kent Street Senior High
Bentley
East Victoria Park
Kensington
Millen
South Perth
Victoria Park

Kewdale Senior High
Carlisle
Kewdale
Lathlain
Tranby
Whiteside

The following constitutes a northern boundary for Kewdale Senior High School:

From the junction of Acton Avenue and Great Eastern Highway, south-east along Acton Avenue to Wright Street, north-east along Wright Street to Belmont Avenue, south-east along the extension of Belmont Avenue through the Belmont shopping centre to Fulham Street, north-east along Fulham Street to Abernethy Road, south-east along Abernethy Road to Keane Street, north-east along Keane Street to Whiteside Street, and south-east along Whiteside Street and its extension to the Tonkin Highway. The boundary parts of Acton Avenue (both sides), Wright Street (both sides) and Fulham Street (both sides) are included within the area for Kewdale Senior High School. The boundary parts of Abernethy Road (both sides), Keane Street (both sides), and Whiteside Street (both sides) are excluded from the area for Kewdale Senior High School.

The following constitutes an optional area between Belmont and Kewdale Senior High Schools:

From the junction of Belmont Avenue and Great Eastern Highway, south-east along Belmont Avenue to Wright Street, south-

Secondary Schools and
Contributory Primary Schools

Options, Exceptions, if any

west along Wright Street to Acton Avenue, north-west along Acton Avenue and its extension to the Swan River, north-east along the Swan River to the extension of Belmont Avenue to the Swan River, and south-east along this extension to the junction of Belmont Avenue and Great Eastern Highway. The boundary part of Belmont Avenue (south side) is included within this optional area. The boundary parts of Wright Street (both sides) and Acton Avenue (both sides) are excluded from this optional area.

Kwinana Senior High
Baldvis
Calista
Hope Valley
Leda
Medina
North Parmelia
Orelia

Lakeland Senior High
Bibra Lake
Jandakot
South Lake
Yangebup

The following constitutes a boundary for Lakeland Senior High School:

From the intersection of the railway line and the eastward extension of Fanstone Avenue, north along the railway line to Barrington Street, east along Barrington Street to Wellard Street, north along Wellard Street to Spearwood Avenue, south east along Spearwood Avenue to Sudlow Road, north along Sudlow Road to Phoenix Road, east along Phoenix Road and the extension of Phoenix Road to Progress Drive, north along Progress Drive to the proposed Roe Highway, east along the proposed Roe Highway to the western extension of Leeming Road, east to and along Leeming Road to Johnston Road, south along Johnston Road to Acourt Road, south and east along Acourt Road to Warton Road, south west along Warton Road to Forrest Road, west along Forrest Road to a point due north of the western arm of Murdoch Way, due south from this point to Rowley Road. The boundary parts of Phoenix Road (south side), Roe Highway (south side) and Leeming Road (south side) are included within the area for Lakeland Senior High School. The boundary parts of Phoenix Road (north side), Progress Drive (both sides), Johnston Road (both sides), Acourt Road (both sides), Warton Road (both sides), Forrest Road (both sides) and Murdoch Way (both sides) are excluded from the area for Lakeland Senior High School.

Leeming Senior High
Banksia Park
Bateman
Bull Creek
Leeming
Oberthur
West Leeming

Children from Bateman Primary School living in the following area shall attend Leeming Senior High School:

From the junction of Marsengo Road and Murdoch Drive, east along Marsengo Road to the eastern part of Broadhurst Crescent, south along Broadhurst Crescent to Scandrett Way, east along Scandrett Way and its eastward extension to the Kwinana Freeway, south along the Kwinana Freeway to South Street, west along South Street to Murdoch Drive, and north along Murdoch Drive to Marsengo Road. The boundary parts of Murdoch Drive (east side), Marsengo Road (south side), Broadhurst Crescent (west side), Scandrett Way (south side), the Kwinana Freeway (west side) and South Street (north side) are included within this area.

The following constitutes an optional area between Leeming Senior High School and Rossmoyne Senior High School:

From the junction of Marsengo Road and Murdoch Drive, east along Marsengo Road to the eastern part of Broadhurst Crescent, south along Broadhurst Crescent to Scandrett Way, east along Scandrett Way and its eastward extension to the Kwinana Freeway, north along the Kwinana Freeway to Parry Avenue, north-west and west along Parry Avenue to Murdoch Drive, and south along Murdoch Drive to Marsengo Road.

The boundary parts of Murdoch Drive (east side), Marsengo Road (north side), Broadhurst Crescent (east side), Scandrett Way (north side), Kwinana Freeway (west side) and Parry Avenue (south side) are included within this optional area.

Secondary Schools and
Contributory Primary Schools

Options, Exceptions, if any

Children from Bull Creek Primary School living in the following area shall attend Leeming Senior High School:

From the junction of South Street and the Kwinana Freeway, north along the Kwinana Freeway to a point opposite the western extension of Windich Road, in an easterly direction to and along Windich Road and its eastward extension to Benningfield Road, south along Benningfield Road to Henry Bull Drive, east and south-east along Henry Bull Drive to James Street, east along James Street to Hardy Street, south-east along Hardy Street to Darley Circle, south along Darley Circle to More Crescent, northeast along More Crescent to Back Close, east along Back Close and the walkway linking Back Close and Darley Circle, south along Darley Circle to Vagg Street, east along Vagg Street to Wheatley Drive, south along Wheatley Drive to South Street and west along South Street to the Kwinana Freeway. The boundary parts of Windich Road, Benningfield Road, Henry Bull Drive, James Street, Hardy Street, Darley Circle, More Crescent, Back Close and Vagg Street (both sides in all cases), South Street (north side) and the Kwinana Freeway (east side) are included in the above-mentioned area. The boundary parts of Wheatley Drive (both sides) are excluded from the above-mentioned area.

The following constitutes an optional area between Leeming Senior High School and Willetton Senior High School:

From the intersection of Parry Avenue and the Kwinana Freeway, south along the Kwinana Freeway to a point opposite the western extension of Windich Road, in an easterly direction to and along Windich Road and its eastward extension to Benningfield Road, south along Benningfield Road to Henry Bull Drive, east then southeast along Henry Bull Drive to James Street, east along James Street to Hardy Street, south east along Hardy Street to Darley Circle, south east along Darley Circle to More Crescent, north east along More Crescent to Back Close, east along Back Close and the walkway linking Back Close and Darley Circle, south along Darley Circle to Vagg Street, east along Vagg Street to Wheatley Drive, north along Wheatley Drive to Parry Avenue and west along Parry Avenue to the Kwinana Freeway. The boundary parts of Parry Avenue (south side), Wheatley Drive (both sides) and the Kwinana Freeway (east side) are included within this optional area. The boundary parts (both sides) of all other streets are excluded from this optional area.

The following constitutes an optional area between Leeming Senior High School and Willetton Senior High School:

From the junction of South Street and Wheatley Drive, north along Wheatley Drive to the southern arm of Oberthur Crescent, east between Oberthur Crescent and Weeks Way to the walkway linking Weeks Way and Anstie Way, east along this walkway to Anstie Way, north then east along the northern part of Anstie Way to Hetherington Drive, north-east along Hetherington Drive to Owgan Place, south-east along Owgan Place to Karel Avenue, south along Karel Avenue to South Street and west along South Street to Wheatley Drive. The boundary parts of Wheatley Drive, Anstie Way, Owgan Place (both sides in all cases), Karel Avenue (west side) and South Street (north side) are included within this optional area, whilst the boundary parts of Hetherington Drive (both sides) are excluded from this area.

Lesmurdie Senior High
Falls Road
Lesmurdie
Pickering Brook
Walliston
Wattle Grove

Children from Falls Road Primary School living in the area south of Falls Road and south of the portion of Lesmurdie Road north of Falls Road shall attend Lesmurdie Senior High School. Children from Falls Road Primary School living in the area north of Falls Road and the portion of Lesmurdie Road north of Falls Road shall attend Kalamunda Senior High School. Children living in Falls Road and the boundary part of Lesmurdie Road have the option of attending either Lesmurdie Senior High School or Kalamunda Senior High School.

Children from Walliston Primary School living in the area south of Lesmurdie Road, Jackson Road, and a line connecting the

Secondary Schools and
Contributory Primary Schools

Options, Exceptions, if any

junction of Jackson Road and Stanhope Road with the junction of Mundaring Weir Road and Aldersyde Road shall attend Lesmurdie Senior High School. Children from Walliston Primary School living in the area north of Lesmurdie Road, Jackson Road, and a line connecting the junction of Jackson Road and Stanhope Road with the junction of Mundaring Weir Road and Aldersyde Road shall attend Kalamunda Senior High School. Children living in the boundary part of Lesmurdie Road and in Jackson Road have the option of attending either Lesmurdie Senior High School or Kalamunda Senior High School.

Children from Wattle Grove Primary School have the option of attending either Lesmurdie Senior High School or Forrestfield Senior High School.

Lockridge Senior High

Beechboro
Caversham
East Beechboro
Eden Hill
Lockridge
West Beechboro

Children from Eden Hill Primary School living in Walter Road (north side) east of Iolanthe Street and north thereof and in May Road and Iolanthe Street north of Walter Road (east side in each case) and east thereof shall attend Lockridge Senior High School. Children from Eden Hill Primary School living in Walter Road (south side) and south thereof and in May Road and Iolanthe Street north of Walter Road (west side in each case) and west thereof shall attend Hampton Senior High School.

The following shall constitute an optional area between Hampton Senior High School and Lockridge Senior High School:

From the junction of Benara Road and Beechboro Road, east along Benara Road to Milligan Avenue, south along Milligan Avenue to Bottlebrush Drive, south along Bottlebrush Drive to Telstar Drive, west along Telstar Drive to Beechboro Road, and north along Beechboro Road to Benara Road. The boundary parts of Benara Road (south side), Milligan Avenue (both sides), Bottlebrush Drive (west side), Telstar Drive (north side) and Beechboro Road (east side) are included within this optional area.

Lynwood Senior High

Brookman
Ferndale
Kinlock
Langford
Lynwood
Parkwood

Maddington Senior High

Bramfield Park
East Kenwick
East Maddington
Maddington
Orange Grove

Children from East Kenwick Primary School living in Albany Highway (east side) and east thereof shall attend Maddington Senior High School. Children from East Kenwick Primary School living in Albany Highway (west side) and west thereof shall attend Thornlie Senior High School.

Mandurah Senior High

Falcon
Glencoe
Greenfields
Halls Head
Mandurah
North Mandurah
Riverside

The following constitutes a boundary for the core area of Mandurah Senior High School:

From Channel Island in the Peel Inlet, north along the Mandurah Estuary to the 'old' Mandurah Bridge, east along Pinjarra Road to the intersection with Fremantle Road, north along Fremantle Road to Gordon Road, east along Gordon Road to Lakes Road, north and east along Lakes Road to the Serpentine River, north along the Serpentine River to the boundary between the Shires of Murray and Rockingham, west along the Murray-Rockingham and Mandurah-Rockingham Shire boundaries to Mandurah Road, north along Mandurah Road to the locality boundary between Golden Bay and Secret Harbour, west along the Golden Bay-Secret Harbour locality boundary to the coast. The boundary parts of Pinjarra Road (north side), Fremantle Road (west side), Gordon Road (north side), Lakes Road (north side), the Murray-Rockingham and Mandurah-Rockingham Shire boundaries (south side), Mandurah Road (west side) and the Golden Bay-Secret Harbour locality boundary (south side) are included within the core area for Mandurah Senior High School.

Secondary Schools and
Contributory Primary Schools

Options, Exceptions, if any

The following constitutes an optional area between Coodanup Senior High School and Mandurah Senior High School:

From the intersection of Fremantle Road and Murdoch Drive east along Murdoch Drive to Bortolo Drive, north along Bortolo Drive to Exchequer Avenue, east along Exchequer Avenue to Lakes Road, north along Lakes Road to Gordon Road, west along Gordon Road to Fremantle Road and south along Fremantle Road to Murdoch Drive. The boundary parts of Murdoch Drive (north side), Bortolo Drive (west side), Exchequer Avenue (north side), Lakes Road (west side), Gordon Road (south side) and Fremantle Road (east side) are included within this optional area.

The following primary schools contribute in full to Mandurah Senior High School:

Falcon, Glencoe, Mandurah, North Mandurah. Children living within the core area of Mandurah Senior High School, as designated above, are expected to attend Mandurah Senior High School. Children from outside the core or optional areas of Mandurah Senior High School are excluded from attendance at that school.

Children of secondary school age resident within the locality of Secret Harbour have the option of attending either Mandurah Senior High School or Warnbro Community High School.

Melville Senior High

Attadale
Booragoon
Carawatha
Kardinya
Melville
Palmyra
Willagee
Winthrop

The following constitutes a boundary for Melville Senior High School:

From the intersection of Canning Highway and Chesson Street, west along Canning Highway to North Lake Road, south along North Lake Road to Leach Highway, east along Leach Highway to Winthrop Drive, south along Winthrop Drive to Somerville Boulevard, east along Somerville Boulevard to Prescott Drive, south along Prescott Drive to South Street, west along South Street to Windelya Road, south along Windelya Road to Farrington Road, west along Farrington Road to North Lake Road, north along North Lake Road to South Street, west along South Street to Stock Road, north along Stock Road to the Swan River foreshore, and east and south east along the foreshore to a point intersected by the northern extension of Chesson Street.

The boundary parts of Canning Highway (north side), North Lake Road (west side between Canning and Leach Highways), Leach Highway (south side), Winthrop Drive (west side), Somerville Boulevard (south side), South Street (north side), Windelya Road (both sides), Farrington Road (north side), North Lake Road (east side between Farrington Road and South Street), South Street (north side) and Stock Road (east side) are included within the area for Melville Senior High School. Prescott Drive (both sides) is excluded from this area.

Children from Booragoon Primary School have the option of attending either Applecross Senior High School or Melville Senior High School.

Children from Palmyra Primary School living in the area east of Stock Road have the option of attending either Melville Senior High School or John Curtin Senior High School. Children from Palmyra Primary School living in Stock Road (both sides) and west thereof shall attend John Curtin Senior High School.

Children of secondary school age living in the area bounded by Leach Highway, Winthrop Drive, Somerville Boulevard and Murdoch Drive have the option of attending either Applecross or Melville Senior High School.

Children of secondary school age living in the locality of Murdoch and north of South Street have the option of attending either Applecross or Melville Senior High School.

The following constitutes an optional area between Hamilton and Melville Senior High Schools:

From the intersection of Farrington Road and North Lake Road, east along Farrington Road to Progress Drive, south along Progress Drive to the proposed Roe Highway, west along the proposed Roe Highway to North Lake Road, and north along North Lake Road to Farrington Road. The boundary parts of Farrington Road (south side), Progress Drive (both sides) and North Lake Road (east side) are included within this optional area.

Secondary Schools and
Contributory Primary Schools

Options, Exceptions, if any

Mirrabooka Senior High

Mirrabooka
Mount Hawthorn
Nollamara
Osborne
Sutherland
Tuart Hill
Westminster
Yokine

Children from Mount Hawthorn Primary School living in Green Street (both sides) and north thereof have the option of attending either Mirrabooka Senior High School or Perth Modern Senior High School. Children from Mount Hawthorn Primary School living in the area south of Green Street shall attend Perth Modern Senior High School.

Children from Osborne Primary School living in the area east of Main Street have the option of attending either Mirrabooka Senior High School or Balcatta Senior High School. Children from Osborne Primary School living in Main Street (both sides) and west thereof shall attend Balcatta Senior High School.

Children from Tuart Hill Primary School living in Green Street (both sides) and north thereof shall attend Mirrabooka Senior High School.

Children from Yokine Primary School living in Blythe Avenue and Woodrow Avenue (north side in each case) and north thereof shall attend Mirrabooka Senior High School. Children from Yokine Primary School living in Blythe Avenue and Woodrow Avenue (south side in each case) and south thereof shall attend Mount Lawley Senior High School.

Morley Senior High

Camboon
Dianella Heights
Morley
Noranda
North Morley
West Morley

The following constitutes a boundary for Morley Senior High School:

From the intersection of Alexander Drive and Reid Highway, west along Reid Highway to Northwood Drive, south along Northwood Drive to Yirrigan Drive, south east along Yirrigan Drive to Dianella Drive, south along Dianella Drive to Morley Drive, east along Morley Drive to Light Street, south east along Light Street to Walter Road West, north east and east along Walter Road West to Charnwood Street, north along Charnwood Street and its extension to Morley Drive, east along Morley Drive to Crimea Street, north along Crimea Street and its extension to the Reid Highway, east along the Reid Highway to the Tonkin Highway, north along the proposed extension of the Tonkin Highway to Marshall Road, west along Marshall Road to Beach Road, north west along Beach Road to Alexander Drive and south along Alexander Drive to the Reid Highway. The boundary parts of Reid Highway (west section) (south side), Northwood Drive (east side), Yirrigan Drive (north side), Dianella Drive (east side), Morley Drive (north side), Light Street (both sides), Walter Road West (both sides), Charnwood Street (both sides), Morley Drive (both sides), Crimea Street (west side), Reid Highway (east section) (north side), Tonkin Highway (west side), Marshall Road (south side), Beach Road (south side) and Alexander Drive (east side) are included within the catchment area of Morley Senior High School.

Mount Lawley Senior High

The following constitutes the boundary for the Mount Lawley Senior High School:

From the junction of Wanneroo Road and Wiluna Street, north-east along Wiluna Street to Flinders Street, north along Flinders Street to Blythe Avenue, east along Blythe Avenue and Woodrow Avenue to Cresswell Road, south-east along Cresswell Road, Homer Street, Dundas Road, Eleventh Avenue and Kennedy Street to the railway line, south-west along the railway line to Caledonian Avenue, south-east along Caledonian Avenue to Mephan Street, south-west along Mephan Street to Joseph Street, south along Joseph Street to Peninsula Road, east along Peninsula Road to Foggerthorpe Crescent, south along Foggerthorpe Crescent and its extension to the Swan River foreshore, west and south-west along the Swan River foreshore to Summers Street, west along Summers Street to the junction with Lord Street and Bulwer Street, north-west along Bulwer Street to Vincent Street, west along Vincent Street to Charles Street, north and north-west along Charles Street to the junction with Walcott Street and Wanneroo Road, and north-west along Wanneroo Road to Wiluna Street. The boundary parts of Wiluna Street (south-east side), Flinders Street (both sides), Woodrow Avenue (south side), Cresswell Road (south-west side) and Vincent Street

Secondary Schools and
Contributory Primary Schools

Options, Exceptions, if any

(both sides), and the boundary streets of Blythe Avenue (south side), Homer Street (south-west side), Dundas Road (both sides), Eleventh Avenue (both sides), Kennedy Street (both sides), Caledonian Avenue (south-west side), Mephan Street (west side) and Joseph Street (west side) are included within the area for Mount Lawley Senior High School, while the boundary parts of Peninsula Road, Fogerthorpe Crescent, Summers Street and Charles Street (both sides in each case), and the boundary street of Bulwer Street (both sides) are excluded from the area for Mount Lawley Senior High School.

The following primary schools contribute in full or part to Mount Lawley Senior High School: Coolbinia, Dianella, Highgate, Inglewood, Kyilla, Mount Lawley, Maylands, North Perth and Yokine. Children from these schools living within the area for Mount Lawley Senior High School, as designated above, shall attend Mount Lawley Senior High School. Children from outside the area for Mount Lawley Senior High School are excluded from attendance at that school.

Newton Moore Senior High

Adam Road
Capel
Carey Park
South Bunbury
Withers

The following constitutes a boundary between Bunbury Senior High School and Newton Moore Senior High School:

From the confluence of the Preston River with the Ferguson River, north west and west along the Preston River to the railway bridge, west and north west along the railway line to the intersection of the railway line and Forrest Avenue, west and north west along Forrest Avenue to Wisbey Street, south west along Wisbey Street to Yorla Road, north west along Yorla Road to Clarke Street East, west along Clarke Street East to Clarke Street, west along Clarke Street to Hoylake Avenue and north west and west along Hoylake Avenue and its extension to the Indian Ocean.

Children from Carey Park Primary School living in the area north of (but not including) the above boundary have the option of attending either Bunbury Senior High School or Newton Moore Senior High School. Children from Carey Park Primary School living in Hoylake Avenue, Clarke Street and Clarke Street East (both sides in all cases) and the boundary parts of Yorla Road, Wisbey Street and Forrest Avenue (both sides in all cases), and south of the boundary shall attend Newton Moore Senior High School.

Children from South Bunbury Primary School living in the area north of (but not including) the above boundary shall attend Bunbury Senior High School. Children from South Bunbury Primary School living in Hoylake Avenue, Clarke Street and Clarke Street East (both sides in all cases) and the boundary parts of Yorla Road, Wisbey Street and Forrest Avenue (both sides in all cases), and south of the boundary shall attend Newton Moore Senior High School.

North Albany Senior High

Mount Lockyer
Yakamia

Northam Senior High

Avonvale
Bakers Hill
Goomalling
Meckering
Northam
West Northam
Wundowie

Ocean Reef Senior High

Beaumaris
Connolly
Kinross
Mullaloo Beach
Mullaloo Heights
Ocean Reef
Poseidon

Children living in the following area shall attend Ocean Reef Senior High School:

From the intersection of Hodges Drive and Country Club Boulevard, north along Country Club Boulevard and continuing north to the golf course underpass at Shenton Avenue, west from the underpass to Connolly Drive, north along Connolly Drive to Moore Drive, west along Moore Drive to Marmion Avenue, north along Marmion Avenue to Burns Beach Road, west along Burns Beach Road to the coastline, south along the coastline to Hodges Drive and east along Hodges Drive to Country Club Boulevard.

Secondary Schools and
Contributory Primary Schools

Options, Exceptions, if any

The boundary parts of Country Club Boulevard (west side), Shenton Avenue (south side), Connolly Drive (west side), Moore Drive (south side), Marmion Avenue (west side) and Burns Beach Road (south side) are included within this area. The boundary parts of Country Club Boulevard (east side), Shenton Avenue (north side), Connolly Drive (east side), Moore Drive (north side), Marmion Avenue (east side) and Burns Beach Road (south side) are excluded from this area.

The following constitutes a boundary for an optional area between Clarkson High School and Ocean Reef Senior High School:

From the intersection of Burns Beach Road and Marmion Avenue, south along Marmion Avenue to Moore Drive, east along Moore Drive to Connolly Drive, north along Connolly Drive to Burns Beach Road and west along Burns Beach Road to Marmion Avenue. The boundary parts of Marmion Avenue (east side), Moore Drive (north side), Connolly Drive (west side) and Burns Beach Road (south side) are included within this optional area.

The following constitutes a boundary for an optional area between Craigie Senior High School and Ocean Reef Senior High School:

From the Indian Ocean south of the east-west alignment of Merrifield Place, due east to Northshore Drive, north along Northshore Drive to Mullaloo Drive, in a general easterly direction along Mullaloo Drive to Kallaroo Place, east along Kallaroo Place to Marmion Avenue, north along Marmion Avenue to Ocean Reef Road, west along Ocean Reef Road to the junction with Oceanside Promenade, and due west to the Indian Ocean. The boundary part of Merrifield Place (both sides), Northshore Drive (west side), Mullaloo Drive (north side), Marmion Avenue (west side), Ocean Reef Road (south side) and the boundary street of Kallaroo Place (north side), are included within the optional area.

Padbury Senior High
Bambara
Lymburner
Padbury
South Padbury

Children from Lymburner Primary School living in the following area shall attend Padbury Senior High School:

From the intersection of Cook Avenue and Marmion Avenue, west along Cook Avenue to Wild Road, south along Wild Road to David Crescent, west along David Crescent to Mawson Crescent, south along Mawson Crescent to Flinders Avenue, west along Flinders Avenue to Whitfords Avenue, south along Whitfords Avenue to Hepburn Avenue, east along Hepburn Avenue to Marmion Avenue, and north along Marmion Avenue to Cook Avenue. The boundary parts of Wild Road (both sides), David Crescent (both sides), Mawson Crescent (both sides), Flinders Avenue (both sides), Whitfords Avenue (east side), Hepburn Avenue (north side), and Marmion Avenue (west side) are included within this area. The boundary part of Cook Avenue is excluded from this area.

Perth Modern Senior High
Highgate
Kylla
Mount Hawthorn
North Perth
Subiaco
Tuart Hill
West Leederville

Children from Highgate Primary School living in Bulwer and Summers Streets (both sides) and south thereof shall attend Perth Modern Senior High School. Children from Highgate Primary School living in the area north of Bulwer and Summers Streets shall attend Mount Lawley Senior High School.

Children from Kylla Primary School living in Charles Street (both sides) and west thereof shall attend Perth Modern Senior High School. Children from Kylla Primary School living in the area east of Charles Street shall attend Mount Lawley Senior High School.

Children from Mount Hawthorn Primary School living in the area south of Green Street shall attend Perth Modern Senior High School. Children from Mount Hawthorn Primary School living in Green Street (both sides) and north thereof have the option of attending either Perth Modern Senior High School or Mirrabooka Senior High School.

Children from North Perth Primary School living in Charles Street (both sides) and west thereof shall attend Perth Modern Senior High School. Children from North Perth Primary School living in the area east of Charles Street shall attend Mount Lawley Senior High School.

Children from Tuart Hill Primary School living in Green Street (both sides) and north thereof shall attend Mirrabooka Senior High School.

Secondary Schools and
Contributory Primary Schools

Options, Exceptions, if any

Pinjarra Senior High

Carcoola
Dwellingup
North Dandalup
Pinjarra

The following constitutes a boundary between Pinjarra Senior High School and Coodanup Senior High School:

From the Peel Inlet, north along the Serpentine River to Goegrup Lake, north across Goegrup Lake to the intersection of Lakes Road and the Serpentine River. Children living in the area to the east of this boundary shall attend Pinjarra Senior High School. Children living in the area to the west of this boundary shall attend Coodanup Senior High School.

The following constitutes a boundary between Mandurah Senior High School and Pinjarra Senior High School:

From the intersection of Lakes Road and the Serpentine River, and north along the Serpentine River to the boundary between the Shires of Murray and Rockingham. Children living in the area to the east of this boundary shall attend Pinjarra Senior High School. Children living in the area to the west of this boundary shall attend Mandurah Senior High School.

Rockingham Senior High

Bungaree
Charthouse
Cooloongup
East Waikiki
Hillman
Rockingham Beach
Safety Bay

The following constitutes a boundary for Rockingham Senior High School:

From the coastline, east along Boundary Road to the proposed Garden Island Highway, south east and east along the proposed Garden Island Highway to Rae Road, east and north east along Rae Road to Ennis Avenue, south east along Ennis Avenue to the boundary between the localities of Cooloongup and Waikiki, south east along this locality boundary to Mandurah Road, north along Mandurah Road to the intersection with Millar Road and the local government boundary between the Town of Kwinana and the City of Rockingham, north and west along this local government boundary to the coastline. The boundary parts of Rae Road (north side), Ennis Avenue (east side) and Mandurah Road (west side) are included within the catchment area of Rockingham Senior High School.

All students resident within the catchment area of Safety Bay Senior High School have the option of attending either Rockingham Senior High School or Safety Bay Senior High School.

Roleystone District High

Karragullen
Roleystone

The boundary between Roleystone District High School and Kelmscott Senior High School is the north-south boundary between the localities of Kelmscott and Roleystone, with children living to the east of this boundary being directed to Roleystone District High School and those living to the west of this boundary being directed to Kelmscott Senior High School, except that children living in the area bounded on the north by Chevin Road, on the west by Canning Mills Road, on the south by a line drawn due east from Canning Mills Road at a point due west of the southern extremity of Coventry Road to the locality boundary between Kelmscott and Roleystone, and on the east by the afore-mentioned locality boundary, have the option of attending either Roleystone District High School or Kelmscott Senior High School, with the boundary parts of Chevin Road and Canning Mills Road (both sides in each case) being included in the optional area.

Rossmoyne Senior High

Bateman
Brentwood
Bull Creek
Oberthur
Riverton
Rossmoyne
Shelley
Willetton

Children from Bateman Primary School living in the area bounded by Leach Highway, the Kwinana Freeway, Parry Avenue and Murdoch Drive shall attend Rossmoyne Senior High School. The boundary parts of Leach Highway (south side), the Kwinana Freeway (west side), Parry Avenue (north side) and Murdoch Drive (east side) are included within this area.

The following shall constitute an optional area between Rossmoyne Senior High School and Leeming Senior High School:

From the junction of Marsengo Road and Murdoch Drive, east along Marsengo Road to the eastern part of Broadhurst Crescent, south along Broadhurst Crescent to Scandrett Way, east along Scandrett Way and its eastward extension to the Kwinana Freeway, north along the Kwinana Freeway to Parry Avenue, north west and west along Parry Avenue to Murdoch Drive, and south along Murdoch Drive to Marsengo Road.

Secondary Schools and
Contributory Primary Schools

Options, Exceptions, if any

	<p>The boundary parts of Murdoch Drive (east side), Marsengo Road (north side), Broadhurst Crescent (east side), Scandrett Way (north side), Kwinana Freeway (west side) and Parry Avenue (south side) are included within this optional area.</p> <p>Children from Brentwood Primary School have the option of attending either Applecross Senior High School or Rossmoyne Senior High School.</p> <p>Children from Bull Creek Primary School living in Parry Avenue (north side only) and north thereof shall attend Rossmoyne Senior High School.</p> <p>Children from Oberthur Primary School living in Parry Avenue (north side only) and north thereof shall attend Rossmoyne Senior High School.</p> <p>Children from Willetton Primary School living in the following boundary streets or parts of boundary streets (both sides) and west thereof shall attend Rossmoyne Senior High School: From the junction of High Road and Augusta Street, south along Augusta Street to Acanthus Road, west along Acanthus Road to Darvell Road, south along Darvell Road to Rhonda Avenue, west along Rhonda Avenue to Donald Street, south along Donald Street to Apsley Road, west along Apsley Road to Eagles Walk, south along the north-south alignment of Eagles Walk and its extension to Flamingo Way and south along the north-south alignment of Flamingo Way and its extension to Albatross Pass.</p> <p>Children from Riverton Primary School living in the area bounded by High Road, Duff Road, the Canning River and Leach Highway shall attend Rossmoyne Senior High School. The boundary parts of High Road (north side), Duff Road (both sides) and Leach Highway (south side) are included within this area. Children from Riverton Primary School living in High Road (south side) and south thereof, shall attend Willetton Senior High School.</p>
<p>Safety Bay Senior High Charthouse Cooloongup East Waikiki Safety Bay</p>	<p>The following constitutes a boundary for Safety Bay Senior High School:</p> <p>From the coastline, east along Boundary Road to the proposed Garden Island Highway, south east and east along the proposed Garden Island Highway to Rae Road, east and north east along Rae Road to Ennis Avenue, south east along Ennis Avenue to Wilmott Drive, west along Wilmott Drive to Gnangara Drive, south west along Gnangara Drive to Read Street, south along Read Street to Rand Avenue, south west along Rand Avenue to Safety Bay Road, south east along Safety Bay Road to Hilda Road, west along Hilda Road and its extension to the coastline. The boundary parts of Boundary Road (both sides), Rae Road (south side), Ennis Avenue (west side), Wilmott Drive (north side), Gnangara Drive (north side), Read Street (west side), Rand Avenue (north side) and Safety Bay Road (west side) are included within the catchment of Safety Bay Senior High School. The boundary street of Hilda Road (both sides) is excluded from the catchment area of Safety Bay Senior High School. All students resident in the above area have the option of attending either Rockingham Senior High School or Safety Bay Senior High School.</p>
<p>Scarborough Senior High Birralee Deanmore Karrinyup Lake Gwelup Newborough North Innaloo</p>	<p>Children from Birralee Primary School have the option of attending either Scarborough Senior High School or Balcatta Senior High School.</p> <p>Children from Lake Gwelup Primary School have the option of attending either Scarborough Senior High School or Balcatta Senior High School.</p>
<p>South Fremantle Senior High Beaconsfield Hilton Samson South Terrace White Gum Valley Winterfold</p>	<p>Children from Winterfold Primary School living in Healy Road (both sides) and north thereof shall attend South Fremantle Senior High School. Children from Winterfold Primary School living in the area south of Healy Road have the option of attending either South Fremantle Senior High School or Hamilton Senior High School.</p>

Secondary Schools and
Contributory Primary Schools

Options, Exceptions, if any

Swan View Senior High

Bellevue
Darlington
Glen Forrest
Greenmount
Helena Valley
Koongamia
Middle Swan
Midvale
Swan View

The following constitutes an optional area between Hamilton and South Fremantle Senior High Schools:

From the intersection of Stock Road and Winterfold Road, east along Winterfold Road and continuing into Torquil Road to North Lake Road, north along North Lake Road to South Street, west along South Street to Stock Road and south along Stock Road to Winterfold Road. The boundary parts of Winterfold Road (north side), Torquil Road (north side), North Lake Road (west side), South Street (south side) and Stock Road (east side) are included within this optional area.

Children from Darlington Primary School have the option of attending either Swan View Senior High School, Eastern Hills Senior High School or Kalamunda Senior High School.

Children from Glen Forrest Primary School have the option of attending either Swan View Senior High School, Eastern Hills Senior High School or Kalamunda Senior High School.

The following constitutes a northern and western boundary for Swan View Senior High School:

From the bridge carrying Toodyay Road over Jane Brook, south-west along Toodyay Road to the Roe Highway, south along the Roe Highway to Great Eastern Highway, west along Great Eastern Highway to Lloyd Street, south along Lloyd Street to Clayton Street, south along Clayton Street to Military Road and south along Military Road to Bushmead Road. The boundary parts of Toodyay Road (south side), Roe Freeway (east side), Great Eastern Highway (south side) and Military Road (both sides) are included within the area for Swan View Senior High School. The boundary parts of Toodyay Road (north side), Roe Highway (west side), Great Eastern Highway (north side) and Lloyd Avenue (both sides) are excluded from the area for Swan View Senior High School.

Children from Middle Swan and Midvale Primary Schools living in the area east of the above boundary shall attend Swan View Senior High School. Children from Middle Swan Primary School living in the area west of the above boundary shall attend Governor Stirling Senior High School.

The following constitutes the boundary for an optional area between Governor Stirling Senior High School and Swan View Senior High School:

From the intersection of Great Eastern Highway and Roe Highway, west along Great Eastern Highway to Bushby Street, north along Bushby Street and its extension northwards along the locality boundary to Eddie Barron Drive, east along the locality boundary between Middle Swan and Midvale to the Roe Highway, south along the Roe Highway to Great Eastern Highway. The boundary parts of Great Eastern Highway (both sides), Bushby Street (both sides) and Roe Highway (west side) are included within this optional area.

Swanbourne Senior High

Cottesloe
Graylands
Mosman Park
North Cottesloe
Swanbourne

Thornlie Senior High

Canning Vale
East Kenwick
Forest Crescent
South Thornlie
Thornlie
Yale

Children from East Kenwick Primary School living in Albany Highway (west side) and west thereof shall attend Thornlie Senior High School. Children from East Kenwick Primary School living in Albany Highway (east side) and east thereof shall attend Maddington Senior High School.

Wanneroo Senior High

East Wanneroo
Wanneroo
Yanchep

The following constitutes a boundary for Wanneroo Senior High School:

From 476 Old Yanchep Road (as shown on Map 8 in the 1994 Streetsmart street directory), south west to the intersection of the locality boundaries of Alkimos, Carabooda and Eglinton, south along the boundary between the localities of Alkimos and Carabooda to the proposed Mitchell Freeway, south along the proposed Mitchell Freeway to Burns Beach Road, east

Secondary Schools and
Contributory Primary Schools

Options, Exceptions, if any

along Burns Beach Road to the locality boundary between Joondalup and Wanneroo, south along the locality boundary between Joondalup and Wanneroo to Ocean Reef Road, east along Ocean Reef Road to Wanneroo Road, south along Wanneroo Road to Gnangara Road, and east along Gnangara Road to the intersection with Alexander Drive. The boundary parts of Burns Beach Road (north side), Ocean Reef Road (north side), Wanneroo Road (east side) and Gnangara Road (north side) are included within the area for Wanneroo Senior High School.

The following constitutes an optional area between Wanneroo Senior High School and Yanchep District High School:

The localities of Eglinton, Two Rocks and Yanchep, and the area of the locality of Carabooda located to the north of the following boundary: from the intersection of the locality boundaries of Alkimos, Carabooda and Eglinton, north east across Wanneroo Road to 476 Old Yanchep Road (as shown on Map 8 in the 1994 Streetsmart street directory).

Warnbro Community High School
Charthouse
Koorana
Warnbro

The following constitutes a boundary for Warnbro Community High School:

From the coastline, east along Hilda Road to Safety Bay Road, north west along Safety Bay Road to Rand Avenue, north east along Rand Avenue to Read Street, north along Read Street to Gnangara Drive, north east along Gnangara Drive to Willmott Drive, east along Willmott Drive to Ennis Avenue, south along Ennis Avenue to Mandurah Road, south along Mandurah Road to the boundary between the localities of Port Kennedy and Secret Harbour, and west along this locality boundary to the coastline. The boundary parts of Hilda Road (both sides), Safety Bay Road (east side), Rand Avenue (south side), Read Street (east side), Gnangara Drive (south side), Willmott Drive (south side), Ennis Avenue (west side) and Mandurah Road (west side) are included within the catchment area for Warnbro Community High School. The boundary parts of Safety Bay Road (west side), Rand Avenue (north side), Read Street (west side), Gnangara Drive (north side), Willmott Drive (north side), Ennis Avenue (east side) and Mandurah Road (east side) are excluded from the catchment area for Warnbro Community High School.

Children of secondary school age resident within the locality of Secret Harbour have the option of attending either Mandurah Senior High School or Warnbro Community High School.

Warwick Senior High
Allenswood
East Greenwood
East Hamersley
Glendale
Hawker Park
Warwick

Willetton Senior High
Bull Creek
Burrendah
Oberthur
Riverton
Rostrata
Willetton

The following shall constitute an optional area between Willetton Senior High School and Leeming Senior High School:

From the intersection of Parry Avenue and the Kwinana Freeway, south along the Kwinana Freeway to a point opposite the western extension of Windich Road, in an easterly direction to and along Windich Road and its eastward extension to Benningfield Road, south along Benningfield Road to Henry Bull Drive, east then south-east along Henry Bull Drive to James Street, east along James Street to Hardy Street, south-east along Hardy Street to Darley Circle, south-east along Darley Circle to More Crescent, north-east along More Crescent to Back Close, east along Back Close and the walkway linking Back Close and Darley Circle, south along Darley Circle to Vagg Street, east along Vagg Street to Wheatley Drive, north along Wheatley Drive to Parry Avenue and west along Parry Avenue to the Kwinana Freeway. The boundary parts of Parry Avenue (south side), Wheatley Drive (both sides) and the Kwinana Freeway (east side) are included within this optional area. The boundary parts (both sides) of all other streets are excluded from this optional area.

Secondary Schools and
Contributory Primary Schools

Options, Exceptions, if any

Children from Oberthur Primary School living in the following area shall attend Willetton Senior High School:

From the junction of Wheatley Drive and the southern arm of Oberthur Crescent, east between Oberthur Crescent and Weeks Way to the walkway linking Weeks Way and Anstie Way, east along this walkway to Anstie Way, north then east along the northern part of Anstie Way to Hetherington Drive, north-east along Hetherington Drive to Owgan Place, south-east along Owgan Place to Karel Avenue, north along Karel Avenue to Parry Avenue, west along Parry Avenue to Wheatley Drive and south along Wheatley Drive to the southern arm of Oberthur Crescent. The boundary parts of Parry Avenue (south side), Karel Avenue (west side), Hetherington Drive (both sides north of Owgan Place) and Wheatley Drive (both sides, south of Vagg Street) are included within this area, whilst the boundary parts of Owgan Place (both sides), Anstie Way (both sides), and Wheatley Drive (both sides, north of Vagg Street), are excluded from this area.

The following constitutes an optional area between Leeming Senior High School and Willetton Senior High School:

From the junction of South Street and Wheatley Drive, north along Wheatley Drive to the southern arm of Oberthur Crescent, east between Oberthur Crescent and Weeks Way to the walkway linking Weeks Way and Anstie Way, east along this walkway to Anstie Way, north then east along the northern part of Anstie Way to Hetherington Drive, north-east along Hetherington Drive to Owgan Place, south-east along Owgan Place to Karel Avenue, south along Karel Avenue to South Street and west along South Street to Wheatley Drive. The boundary parts of Wheatley Drive, Anstie Way, Owgan Place (both sides in all cases), Karel Avenue (west side) and South Street (north side) are included within this optional area, whilst the boundary parts of Hetherington Drive (both sides) are excluded from this optional area.

Children from Willetton Primary School living in the area east of the following boundary streets or parts of boundary streets shall attend Willetton Senior High School:

From the junction of High Road and Augusta Street, south along Augusta Street to Acanthus Road, west along Acanthus Road to Darvell Road, south along Darvell Road to Rhonda Avenue, west along Rhonda Avenue to Donald Street, south along Donald Street to Apsley Road, west along Apsley Road to Eagles Walk, south along the north-south alignment of Eagles Walk and its extension to Flamingo Way and south along the north-south alignment of Flamingo Way and its extension to Albatross Pass.

Children from Willetton Primary School living in the above-mentioned boundary streets or parts of boundary streets and west thereof shall attend Rossmoyne Senior High School.

Children from Riverton Primary School living in High Road (south side) and south thereof shall attend Willetton Senior High School.

Woodvale Senior High
Creaney
Halidon
North Woodvale
Woodvale

Yanchep District High

The following constitutes an optional area between Wanneroo Senior High School and Yanchep District High School:

The localities of Eglinton, Two Rocks and Yanchep, and the area of the locality of Carabooda located to the north of the following boundary: from the intersection of the locality boundaries of Alkimos, Carabooda and Eglinton, north east across Wanneroo Road to 476 Old Yanchep Road (as shown on Map 8 in the 1994 Streetsmart street directory).

FISHERIES**FI401****PEARLING ACT 1990****PEARLING (ANNUAL FEES) NOTICE (No. 2) 1995.**

FD 1/91

Made by the Minister for Fisheries under section 27 (1) (a).

Citation1. This notice may be cited as the *Pearling (Annual Fees) Notice (No. 2) 1995*.**Interpretation**

2. In this notice, unless the contrary intention appears—

“hatchery options” means the number of juvenile pearl oysters that a person is authorised under a pearling licence to take or obtain for the purpose of grow out to a size suitable for seeding for the culture of pearl oysters; and

“juvenile pearl oyster” means any pearl oyster less than the legal minimum size as declared by the Minister in a notice made under section 21.

Commencement

3. This notice shall commence operation on 1 January 1996.

Annual fees for farm leases, pearling licences, hatchery licences and permits

4. For the purposes of section 27 (1) (a) of the Act, the annual fee declared for the year ending 31 December 1996 in respect of—

- (a) a farm lease is \$155.00 per square nautical mile or part thereof of the area of the relevant pearl oyster farm and, in the case of an initial farm lease, the costs of preparing diagrams for the purposes of that farm lease;
- (b) a pearling licence is \$2.50 per pearl oyster of the quota of pearl oysters that may be taken under the pearling licence;
- (c) a pearling licence, in addition to the fee specified in paragraph (b) of this clause, shall be \$0.60 per pearl oyster of hatchery options;
- (d) a hatchery licence is \$125.00;
- (e) a pearling permit is \$55.00; or
- (f) a hatchery permit is \$55.00.

Dated this 7th day of December 1995.

MONTY HOUSE, Minister for Fisheries.

FAIR TRADING**FT301****RETAIL TRADING HOURS ACT 1987****RETAIL TRADING HOURS (FILLING STATIONS)
EXEMPTION ORDER (NO. 4) 1995**

Made by the Minister for Fair Trading under section 5 (1) of the Act.

Citation1. This order may be cited as the *Retail Trading Hours (Filling Stations) Exemption Order (No. 4) 1995*.**Commencement**

2. This order comes into operation on 1 January 1996.

Interpretation

3. (1) In this order —

“prescribed filling station” has the meaning given in the *Retail Trading Hours (Filling Stations) Exemption Order 1995*.

(2) In this order, a reference to a numbered zone refers to the district corresponding to that numbered zone, as prescribed by the *Retail Trading Hours (Filling Station Zones) Regulations 1988* for the purposes of section 14 of the Act.

Exemption (filling station trading hours) — Zones Nos. 9, 10, 11, 13, 15 and 16

4. A person who operates a filling station in —

- (a) the Northam District (Zone No. 9);
- (b) the Bunbury District (Zone No. 10);
- (c) the Kalgoorlie-Boulder District (Zone No. 11);
- (d) the Geraldton District (Zone No. 13);
- (e) the Esperance District (Zone No. 15); or
- (f) the Albany District (Zone No. 16),

may sell or allow to be sold —

- (e) fuel;
- (f) requisites; or
- (g) goods prescribed under section 14 (5) (b) of the Act,

at that filling station, or keep that filling station open, during such hours as the operator thinks fit and to that extent the *Retail Trading Hours Act 1987* does not apply to filling stations in those zones.

Further exemption (prescribed filling station trading hours) — Zones Nos. 9, 10, 11, 13, 15 and 16

5. In addition to the exemption in clause 4, a person who operates a prescribed filling station in —

- (a) the Northam District (Zone No. 9);
- (b) the Bunbury District (Zone No. 10);
- (c) the Kalgoorlie-Boulder District (Zone No. 11);
- (d) the Geraldton District (Zone No. 13);
- (e) the Esperance District (Zone No. 15); or
- (f) the Albany District (Zone No. 16),

may sell or allow to be sold goods specified in Schedule 1 to the *Retail Trading Hours (Filling Stations) Exemption Order 1995* at that prescribed filling station, or keep that prescribed filling station open, during such hours as the operator thinks fit and to that extent the *Retail Trading Hours Act 1987* does not apply to prescribed filling stations in those zones.

Amendment of previous Order

6. The *Retail Trading Hours Exemption Order (No. 3) 1994** is amended —

- (a) in clause 3 (1) —
 - (i) by deleting “the Northam District (Zone No. 9),”; and
 - (ii) by deleting “or the Albany District (Zone No. 16),”; and

- (b) in clause 3 (2) by deleting "zones" and substituting the following —

" zone ".

[* *Published in the Gazette of 18 February 1994 at p. 566.*]

Revocation of previous Order

7. The *Retail Trading Hours (Filling Station) Exemption Order (No. 3) 1995** is revoked.

[* *Published in the Gazette of 19 May 1995 at pp. 1876-77.*]

PETER FOSS, Minister for Fair Trading.

FT401

BUILDERS' REGISTRATION ACT 1939

DETERMINATION

Made by the Minister under Section 22 (3).

I, Peter Gilbert DA Conceicao Foss, Minister for Fair Trading, determine that the annual fee to be paid to the Builders' Registration Board of Western Australia by not later than 1 February by every registered builder or journeyman builder is—

- (a) for an individual \$191.00
- (b) for a partnership \$261.00
- (c) for a body corporate \$590.00

Dated this 2nd day of December 1995.

HON. PETER FOSS, MLC, Minister for the Environment;
Water Resources; The Arts; Fair Trading.

FT402

ASSOCIATIONS INCORPORATION ACT 1987

Section 35

LIONS CLUB OF MUNDARING DISTRICTS INC

Notice is hereby given that the incorporation of the abovementioned association has been cancelled as from the date of this notice.

Dated this 11th day of December 1995.

R. MINEIF, Assistant Commissioner for Corporate Affairs.

HERITAGE COUNCIL OF W.A.

HR401

HERITAGE OF WESTERN AUSTRALIA ACT 1990

NOTICE OF INTENTION TO ENTER PLACES IN THE REGISTER OF HERITAGE PLACES

The Minister for Heritage, Richard Lewis, JP, MLA, has directed pursuant to Section 47 (1) of the Heritage of Western Australia Act 1990 that the places described in Schedule 1 be entered in the Register of Heritage Places on a permanent basis.

Schedule 1

Name	Location	Land Description
The Terraces	63 Mount Street, Perth	Lot 3 on Strata Plan 24137, being the whole of the land comprised in Certificate of Title Volume 2041 Folio 701.
Applecross Primary School (original buildings)	Kintail Road, Applecross	The whole of the land comprised in Crown Land Record Volume 3048 Folio 269.

Dated this 15th day of December 1995.

IAN BAXTER, Director, Office of the Heritage Council.

JUSTICE**JM401****CHARITABLE COLLECTIONS ACT 1946**

I, Kevin John Minson, being the Minister administering the Charitable Collections Act 1946, acting in the exercise of the powers conferred by subsection (3) of section 12 of that Act, do hereby give notice that I have revoked the licences of the organisations listed below—

- City of Wanneroo Trust Fund
- College of Nursing, Australia (W.A. State Committee)
- Karl Stein Foundation
- Kellerberrin Memorial Hospital Auxiliary
- Kisumu Hospital Project
- Newman Hospital Auxiliary
- Nickol Bay Hospital Auxiliary
- Queen Elizabeth II Silver Jubilee Trust
- Solo Parents W.A.
- Tom Price Health Association
- Variety Club of Australia Tent 56
- West Australian Marching Association (Inc)

Dated this 12th day of December 1995

KEVIN JOHN MINSON, Minister Assisting the Minister for Justice.

JM402**JUSTICES ACT 1902**

It is hereby notified for public information that His Excellency the Governor in Executive Council: Has approved of the following appointment to the Office of Justice of the Peace for the State of Western Australia—

Anne Marie Koeyers of Drysdale River Station, Wyndham.

Graham Lindsay Brockman of 69 Saltbush Road, Kambalda West and Kambalda West Pharmacy, Shop 3 Celebration West Centre, Salmon Gums Road, Kambalda.

Gregory Ronald Carter of Lot 11 Walsh Street, Menzies and Shire of Menzies, Shenton Street, Menzies.

RICHARD FOSTER, Executive Director, Courts Division.

LAND ADMINISTRATION**LA401****LOCAL GOVERNMENT ACT 1960****DECLARATION OF CLOSURE OF STREETS**

Made by the Minister for Lands

Under Section 288A

At the request of the local governments nominated, the streets described in the Schedule are now declared to be closed.

SCHEDULE

1. Shire of Busselton (DOLA File No. 2724/1994; Closure No. B1364).
All that portion of Cowrang Lane (formerly Glover Road) plus widenings now comprised in Sussex Location 5013 as shown bordered red on Crown Survey Plan 19035.
Public Plan: Yallingup (25) NW.
2. City of Melville (DOLA File No. 2284/994; Closure No. M1372).
All that portion of Patfield Street shown bordered blue on Crown Survey Diagram 92518.
Public Plans: BG34(2) 10.14
BG34(2) 10.15
3. Shire of Northam (DOLA File No. 4683/1903 V3; Closure No. N722).
All that portion of Boramin Road (Road No. 1626) as shown bordered blue on Crown Survey Diagram 91973.
Public Plan: Northam S.E (25).

A. A. SKINNER, Chief Executive, Department of Land Administration.

LOCAL GOVERNMENT

LG401

BUSH FIRES ACT 1954

Shire of Ashburton

Pursuant to section 38(2) of the Bush Fires Act set out hereunder are the names of Fire Control Officers for the 1995/96 Fire Control Season.

Chief Bush Fire Control Officer

L. A. Welch: Ph Work (091) 846 001 Fax (091) 846 107
Ph Home (091) 846 010

Deputy Chief Bush Fire Control Officer

L. Barker: Ph Work (091) 846 001 Fax (091) 846 107
Ph Home (091) 846 084

Bush Fire Control Officers

M. O'Donahue	Cane River Station	(091) 845 142
K. R. Parsons	Coolawanyah Station	(091) 898 150
M. Herbert	Hamersley Station	(091) 898 155
L. Edwards	Hooley Station	(091) 898 152
M. Herbert	Juna Downs Station	(091) 898 156
W. Stammers	Kooline Station	(099) 430 582
T. Darcy	Lyndon Station	(099) 430 540
N. Blake	Minderoo Station	(091) 846 044
T. L. Richardson	Mt Florance Station	(099) 898 151
G. Watters	Mt Stuart Station	(099) 430 530
G. Smith	Nyang Station	(099) 430 534
R. Butler	Peedamulla	(091) 845 130
J. Bettini	Rocklea/Ashburton Downs Station	(091) 898 159
B. M. Maguire	Turee Creek Station	(091) 757 015
E. R. Pensini	Wylloo Station	(099) 430 585
T. G. Paterson	Yarraloola Station	(091) 845 140
R. Lee	Pannawonica Mine	(091) 593 100
M. Forrester	Marrilla Station	(099) 430 524
H. J. Harvey	Mininer Station	(091) 895 408
J. Pashley	Paraburdoo Mine	(091) 433 732

L. A. VICARY, Shire Clerk.

LG402

LOCAL GOVERNMENT ACT 1960

Shire of Boddington

ACTING SHIRE CLERK

It is hereby notified for public information that Adam Stuart Plowman has been appointed Acting Shire Clerk of the Shire of Boddington from 27 December 1995 until 26 January 1996, during the Shire Clerk's absence on Annual Leave.

B. E. JONES, Shire Clerk.

LG403

SHIRE OF IRWIN

Authorised Officer

The Shire of Irwin advise that Michael William Blows has been appointed an authorised officer under the provisions of—

The Litter Act 1979.

The Dog Act 1976.

The Local Government Act 1960.

All of the Shire of Irwin's By-laws.

Michael William Blows has also been appointed as—

Pound keeper and Ranger; under section 450 of the Local Government Act 1960. Prosecution Officer; in all proceedings in the Court of Petty Sessions on behalf of the Shire of Irwin.

Infringement Issuing Officer under the Bush Fires Act 1954.

J. PICKERING, Shire Clerk.

LG404**DOG ACT 1976***Shire of Irwin*

Appointment of Authorised Persons and Registration Officers

It is hereby notified for public information that the following persons have been appointed as authorised officers pursuant to the Dog Act 1976—

Authorised Persons—

Jack Pickering
Henry Stanly Adamski
Michael William Blows
Roy Arthur Butterfield
Mark Raymond Luzi

Registration Officers—

Melinda Kathryn Lymon
Jacquelyn Gay Kelsch
Ian Steven Walsh
Jo-anne Marion Lee
Michael William Blows
Henry Stanly Adamski
Leah-Ann Phillips

All previous appointments are hereby cancelled.

J. PICKERING, Shire Clerk.

LG405**CITY OF KALGOORLIE-BOULDER**

Acting Town Clerk

It is hereby notified for public information that Phillip Alexander Rob has been appointed Acting Town Clerk for the period from 6 January 1996 until the appointment of a Town Clerk.

R. S. YURYEVICH, Mayor.

LG406**TOWN PLANNING AND DEVELOPMENT ACT 1928**

Advertisement of Resolution Deciding To Prepare A Town Planning Scheme

Shire of Manjimup

Town Planning Scheme No. 3

Notice is hereby given that the Council of the Shire of Manjimup on the fourteenth day of September 1995 passed the following resolution—

Resolution that the Council in pursuance of Section 7 of the Town Planning and Development Act 1928 prepare the above Town Planning Scheme with reference to an area situated wholly within the Shire of Manjimup and enclosed within the inner edge of the black border on a plan now produced to the Council and marked and certified by the Shire Clerk under his hand dated the 24 August 1994 as the Scheme Area Map.

Dated this 11th day of December 1995.

G. FITZGERALD, Shire Clerk.

LG407**BUSH FIRES ACT 1954***Shire of Mount Magnet*

Bush Control Officer

It is hereby notified for public information that the following person has been appointed as authorised officer pursuant to section 38 of the Bush Fires Act 1954—

Fire Control Officer: John C. Dowden

Duel Bush Fire Control Officers with the Shire of Mount Magnet—

Andries Gertenbach—Shire of Yalgoo

J. M. Ripepi—Shire of Sandstone

A. B. Wright—Shire of Cue

G. J. McDONALD, Shire Clerk.

LG408**SHIRE OF TRAYNING**

Acting Shire Clerk

It is hereby notified for public information, that Denise Roslyn Gobbart has been appointed Acting Shire Clerk for the period 27 December, 1995 to 26 January, 1996 inclusive.

LG409**SHIRE OF YORK**

Authorisation of Officers

It is hereby notified for information that at the meeting of the Council on 20 November 1995 the following authorised officers were appointed—

Local Government Act

Mr Graham Merrick

Mr Michael Scott

Bush Fire Act

Mr Michael Scott

Mr Barry Randall

Dog Act

Mr Michael Scott

Mr Graham Merrick

Town Planning Act

Mr Graham Merrick

Litter Act

Mr Graham Merrick

E. FISHER, Shire Clerk.

LG410**BUSH FIRES ACT 1954***City of Cockburn*

Notice is hereby given that the City of Cockburn in accordance with section 18 (5) of the Bush Fires Act, has extended the restricted burning period to midnight 24 December 1995 for fire brigades fuel reduction burns only.

R. W. BROWN, City Manager/Town Clerk.

MINERALS AND ENERGY**MN301****MINING ACT 1978****MINING AMENDMENT REGULATIONS (No. 4) 1995**

Made by His Excellency the Governor in Executive Council.

Citation

1. These regulations may be cited as the *Mining Amendment Regulations (No. 4) 1995*.

Principal regulations

2. In these regulations the *Mining Regulations 1981** are referred to as the principal regulations.

[* Reprinted as at 11 August 1988.

For amendments to 14 November 1995 see 1994 Index to Legislation of Western Australia, Table 4, pp. 190-93, and Gazette of 19 May, 30 June and 13 October 1995.]

Regulation 86 amended

3. Regulation 86 of the principal regulations is amended in the Table by deleting "Coal (inc. peat and lignite)" and substituting the following —

" Coal (including lignite) ".

Regulation 96A amended

4. Regulation 96A of the principal regulations is amended by deleting the subregulation designation "(4)" and substituting the following subregulation designation —

" (3) ".

By His Excellency's Command,

J. PRITCHARD, Clerk of the Council.

MN401**MINING ACT 1978****Notice of Application for an Order for Forfeiture**

Department of Minerals & Energy,
Mt Magnet 28 November 1995.

In accordance with Regulation 49 (2) (c) of the Mining Act 1978-1983, notice is hereby given that the licences are liable to forfeiture under the provisions of Section 96 (1) (a) for breach of covenant, viz. non-payment of rent.

J. PACKINGTON, Warden.

To be heard in the Warden's Court, Mt Magnet on the 23rd January 1996.

EAST MURCHISON MINERAL FIELD*Black Range District*

P57/792 Holloway: John Nelson

P57/793 Holloway: John Nelson

YALGOO MINERAL FIELD

P59/1323 Bateman: Thomas Graham

Vodanovich: Anthony

MN402**MINING ACT 1978****Notice of Application for an Order for Forfeiture**

In accordance with Regulation 49 (2) (c) of the Mining Act 1978-1983, notice is hereby given that the licences are liable to forfeiture under the provisions of Section 96 (1) (a) for breach of covenant, viz. non-payment of rent.

K. BOOTHMAN, Warden.

To be heard in the Warden's Court, Norseman on the 10th January 1996.

DUNDAS MINERAL FIELD*Prospecting Licences*

P63/826 Doudle: Paul Matthew

P63/912 Giles: Peter Baxter

Giles: Robina Sally

Paynter: Cheraine

Paynter: Noel Arthur

P63/917 Norris: Edward Bernard

Norris: Geraldine Fayne

MN403**MINING ACT 1978**

Department of Minerals & Energy,
East Perth WA 6000.

I hereby declare in accordance with the provisions of Section 96A (1) and 97 (1) of the Mining Act 1978 that the undermentioned mining tenements are forfeited for breach of covenant viz; non-payment of rent.

GEORGE CASH, Minister for Mines.

Number	Holder	Exploration Licences	Mineral Field
04/894	Swanwood Nominees Pty Ltd		West Kimberley
04/900	Swanwood Nominees Pty Ltd		West Kimberley
04/933	Golden Eagle Exploration Pty Ltd		West Kimberley
09/642	Mount King Mining NL		Gascoyne
28/530	Aqua-Silk Pty Ltd		North East Coolgardie
Mining Lease			
04/71	Ellendale Diamond Mines NL Moonstone Diamond Corporation NL Sorensen: Erik Christian		West Kimberley

MN404

Commonwealth of Australia

PETROLEUM (SUBMERGED LANDS) ACT 1967

Notice of Grant of Retention Lease

Retention Lease No. WA-7-R has been granted to Woodside Petroleum Development Pty Ltd of Level 40, 385 Bourke Street, Melbourne, Victoria 3000, Woodside Oil Ltd of Level 40, 385 Bourke Street, Melbourne, Victoria 3000, Mid-Eastern Oil Ltd of Level 40, 385 Bourke Street, Melbourne, Victoria 3000, Shell Development (Australia) Proprietary Limited of Shell House, 1 Spring Street, Melbourne, Victoria 3000, BHP Petroleum (North West Shelf) Pty Ltd of Collins Tower, 35 Collins Street, Melbourne, Victoria 3000, BP Developments Australia Ltd of 360 Elizabeth Street, Melbourne, Victoria 3000, Chevron Asiatic Limited of 24th Floor, St Martin's Tower, 44 St George's Terrace, Perth, Western Australia 6000 and Japan Australia LNG (MIMI) Pty Ltd of Level 33, 385 Bourke Street, Melbourne, Victoria 3000 to have effect for a period of five (5) years from the 6 December 1995.

IAN FRASER, Director Petroleum Operations Division.

Commonwealth of Australia

PETROLEUM (SUBMERGED LANDS) ACT 1967

Notice of Grant of Retention Lease

Retention Lease No. WA-8-R has been granted to Woodside Petroleum Development Pty Ltd of Level 40, 385 Bourke Street, Melbourne, Victoria 3000, Woodside Oil Ltd of Level 40, 385 Bourke Street, Melbourne, Victoria 3000, Mid-Eastern Oil Ltd of Level 40, 385 Bourke Street, Melbourne, Victoria 3000, Shell Development (Australia) Proprietary Limited of Shell House, 1 Spring Street, Melbourne, Victoria 3000, BHP Petroleum (North West Shelf) Pty Ltd of Collins Tower, 35 Collins Street, Melbourne, Victoria 3000, BP Developments Australia Ltd of 360 Elizabeth Street, Melbourne, Victoria 3000, Chevron Asiatic Limited of 24th Floor, St Martin's Tower, 44 St George's Terrace, Perth, Western Australia 6000 and Japan Australia LNG (MIMI) Pty Ltd of Level 33, 385 Bourke Street, Melbourne, Victoria 3000 to have effect for a period of five (5) years from the 6 December 1995.

IAN FRASER, Director Petroleum Operations Division.

Commonwealth of Australia

PETROLEUM (SUBMERGED LANDS) ACT 1967

Notice of Grant of Retention Lease

Retention Lease No. WA-9-R has been granted to Woodside Petroleum Development Pty Ltd of Level 40, 385 Bourke Street, Melbourne, Victoria 3000, Woodside Oil Ltd of Level 40, 385 Bourke Street, Melbourne, Victoria 3000, Mid-Eastern Oil Ltd of Level 40, 385 Bourke Street, Melbourne, Victoria 3000

3000, Shell Development (Australia) Proprietary Limited of Shell House, 1 Spring Street, Melbourne, Victoria 3000, BHP Petroleum (North West Shelf) Pty Ltd of Collins Tower, 35 Collins Street, Melbourne, Victoria 3000, BP Developments Australia Ltd of 360 Elizabeth Street, Melbourne, Victoria 3000, Chevron Asiatic Limited of 24th Floor, St Martin's Tower, 44 St George's Terrace, Perth, Western Australia 6000 and Japan Australia LNG (MIMI) Pty Ltd of Level 33, 385 Bourke Street, Melbourne, Victoria 3000 to have effect for a period of five (5) years from the 6 December 1995.

IAN FRASER, Director Petroleum Operations Division.

Commonwealth of Australia
PETROLEUM (SUBMERGED LANDS) ACT 1967

Notice of Grant of Retention Lease

Retention Lease No. WA-10-R has been granted to Woodside Petroleum Development Pty Ltd of Level 40, 385 Bourke Street, Melbourne, Victoria 3000, Woodside Oil Ltd of Level 40, 385 Bourke Street, Melbourne, Victoria 3000, Mid-Eastern Oil Ltd of Level 40, 385 Bourke Street, Melbourne, Victoria 3000, Shell Development (Australia) Proprietary Limited of Shell House, 1 Spring Street, Melbourne, Victoria 3000, BHP Petroleum (North West Shelf) Pty Ltd of Collins Tower, 35 Collins Street, Melbourne, Victoria 3000, BP Developments Australia Ltd of 360 Elizabeth Street, Melbourne, Victoria 3000, Chevron Asiatic Limited of 24th Floor, St Martin's Tower, 44 St George's Terrace, Perth, Western Australia 6000 and Japan Australia LNG (MIMI) Pty Ltd of Level 33, 385 Bourke Street, Melbourne, Victoria 3000 to have effect for a period of five (5) years from the 6 December 1995.

IAN FRASER, Director Petroleum Operations Division.

PLANNING

PD401

METROPOLITAN REGION SCHEME—SECTION 33 AMENDMENT
OUTCOME OF AMENDMENT
“Stirling Regional Centre”

File: 809-2-20-5

Amendment No.: 971/33

It is hereby notified for public information that the Stirling Regional Centre Amendment to the Metropolitan Region Scheme has been submitted before both Houses of Parliament for twelve sittings, in accordance with the provisions of section 33 of the Metropolitan Region Town Planning Scheme Act. During that time no motion of disallowance was carried by either House.

The amendment as depicted on Western Australian Planning Commission plans numbered 3.0893/1 therefore has effect from and after December 6, 1995.

LYNDSAY PREECE, A/Secretary, for Western Australian Planning Commission.

PD402

METROPOLITAN REGION SCHEME—SECTION 33 AMENDMENT
OUTCOME OF AMENDMENT
“South East Corridor—South of Armadale”

File: 809-2-1-31

Amendment No.: 966/33

It is hereby notified for public information that the South East Corridor—South of Armadale Amendment to the Metropolitan Region Scheme has been submitted before both Houses of Parliament for twelve sittings, in accordance with the provisions of section 33 of the Metropolitan Region Town Planning Scheme Act. During that time no motion of disallowance was carried by either House.

The amendment as depicted on Western Australian Planning Commission plans numbered 1.3329/1, 1.3330/3 and 1.3331/1 therefore has effect from and after December 7, 1995.

LYNDSAY PREECE, A/Secretary, for Western Australian Planning Commission.

PD403

METROPOLITAN REGION SCHEME—SECTION 33 AMENDMENT
OUTCOME OF AMENDMENT
“South East Corridor Omnibus”

File: 809-2-1-29

Amendment No.: 961/33

It is hereby notified for public information that the South East Omnibus Amendment to the Metropolitan Region Scheme has been submitted before both Houses of Parliament for twelve sittings, in accordance with the provisions of section 33 of the Metropolitan Region Town Planning Scheme Act. During that time no motion of disallowance was carried by either House.

The amendment as depicted on Western Australian Planning Commission plans numbered 1.3194/3, 1.3195/4 and 1.3196/2 therefore has effect from and after December 1, 1995.

LYNDSAY PREECE, A/Secretary, for Western Australian Planning Commission.

PD404

TOWN PLANNING AND DEVELOPMENT ACT 1928
SCHEME AMENDMENT AVAILABLE FOR INSPECTION
City of Canning

Town Planning Scheme No. 39—Amendment No. 1

Ref: 853/2/16/45 Pt 1

Notice is hereby given that the City of Canning has prepared the abovementioned scheme amendment for the purpose of amending Clauses 4.3.5 and 5.1.3 by deleting reference to the construction of an intersection at Albany Highway/Richmond Street.

Plans and documents setting out and explaining the scheme amendment have been deposited at Council Offices, 1317 Albany Highway, Cannington and at the Western Australian Planning Commission, Albert Facey House, 469 Wellington Street, Perth, and will be available for inspection during office hours up to and including 29 January 1996.

Submissions on the scheme amendment should be made in writing on Form No. 4 and lodged with the undersigned on or before 29 January 1996.

This amendment is available for inspection in order to provide an opportunity for public comment and it should not be construed that final approval will be granted.

I. F. KINNER, Town Clerk.

PD405

TOWN PLANNING AND DEVELOPMENT ACT 1928
APPROVED TOWN PLANNING SCHEME AMENDMENT
City of Cockburn

District Zoning Scheme No. 2—Amendment No. 130

Ref: 853/2/23/19 Pt 130

It is hereby notified for public information, in accordance with Section 7 of the Town Planning and Development Act 1928 that the Hon Minister for Planning approved the City of Cockburn Town Planning Scheme Amendment on 10 December, 1995 for the purpose of—

1. Rezoning the following lots from Residential R15 to Residential R60—

Lots 1, 52, 53, 152, 153 Phoenix Road, Lots 162-172 (inclusive) Glendower Way, Lots 91-96 (inclusive), 181-183 (inclusive) Shallow Street, Lots 48-50 (inclusive) Gerald Road, Pt Lot 62 and Lot 63 Rockingham Road, Lots 60, 61, 64, 207, 208, 213-215 (inclusive) Spearwood Avenue, Lots 209-212 (inclusive) Buktenica Court and Lots 216 and 217 Coleville Crescent, Spearwood of Cockburn Sound Location 561.

2. Amending the Scheme Map in accordance with the above.

R. A. LEES, Mayor.
R. W. BROWN, City Manager/Town Clerk.

PD406**TOWN PLANNING AND DEVELOPMENT ACT 1928**
SCHEME AMENDMENT AVAILABLE FOR INSPECTION*City of Nedlands*

Town Planning Scheme No. 2—Amendment No. 99

Ref: 853/2/8/4 Pt 99

Notice is hereby given that the City of Nedlands has prepared the abovementioned scheme amendment for the purpose of—

1. rezoning No. 20 (Reserve 43193) St John's Wood Boulevard, Mt Claremont from MRS Reserve "Public Purposes" to "Special Use" with the permitted uses of Historic Precinct, Public Purposes, Community Use and Ancillary and Beneficial Commercial Purposes and by amending Schedule 5 accordingly.
2. deleting the "Special Purposes Site 1" zone and "Note: Special Purpose Site 1—refers to the Mt Claremont Historic Precinct on Heritage Lane" from Table 1.

Plans and documents setting out and explaining the scheme amendment have been deposited at Council Offices, 71 Stirling Highway, Nedlands and at the Western Australian Planning Commission, Albert Facey House, 469 Wellington Street, Perth, and will be available for inspection during office hours up to and including 29 January 1996.

Submissions on the scheme amendment should be made in writing on Form No. 4 and lodged with the undersigned on or before 29 January 1996.

This amendment is available for inspection in order to provide an opportunity for public comment and it should not be construed that final approval will be granted.

J. C. LAW, A/Town Clerk.

PD407**TOWN PLANNING AND DEVELOPMENT ACT 1928**
SCHEME AMENDMENT AVAILABLE FOR INSPECTION*City of Stirling*

District Planning Scheme No. 2—Amendment No. 124

Ref: 853/2/20/34 Pt 124

Notice is hereby given that the City of Stirling has prepared the abovementioned scheme amendment for the purpose of—

1. rezoning Lots 8 & 9 Flynn Street from "General Industrial" to "Business".
2. rezoning portion of Lot 14 Pearson Place from "Medium Density Residential R60" to "Business" as depicted on the amendment plan.

Plans and documents setting out and explaining the scheme amendment have been deposited at Council Offices, Civic Place, Stirling and at the Western Australian Planning Commission, Albert Facey House, 469 Wellington Street, Perth, and will be available for inspection during office hours up to and including 29 January 1996.

Submissions on the scheme amendment should be made in writing on Form No. 4 and lodged with the undersigned on or before 29 January 1996.

This amendment is available for inspection in order to provide an opportunity for public comment and it should not be construed that final approval will be granted.

G. S. BRAY, Town Clerk.

PD408**TOWN PLANNING AND DEVELOPMENT ACT 1928**
SCHEME AMENDMENT AVAILABLE FOR INSPECTION*Shire of Busselton*

Town Planning Scheme No. 5—Amendment No. 364

Ref: 853/6/6/6 Pt 364

Notice is hereby given that the Shire of Busselton has prepared the abovementioned scheme amendment for the purpose of rezoning Lots 29 & 30 Kent Street, Busselton from "Single Residential" to "Restricted Use—Residential R30" and incidental and ancillary uses as per the Group Residential Zone.

Plans and documents setting out and explaining the scheme amendment have been deposited at Council Offices, Southern Drive, Busselton and at the Western Australian Planning Commission, Albert Facey House, 469 Wellington Street, Perth, and will be available for inspection during office hours up to and including 29 January 1996.

Submissions on the scheme amendment should be made in writing on Form No. 4 and lodged with the undersigned on or before 29 January 1996.

This amendment is available for inspection in order to provide an opportunity for public comment and it should not be construed that final approval will be granted.

I. STUBBS, Chief Executive Officer.

PD409

TOWN PLANNING AND DEVELOPMENT ACT 1928
SCHEME AMENDMENT AVAILABLE FOR INSPECTION
Shire of Busselton

Town Planning Scheme No. 5—Amendment No. 369

Ref: 853/6/6/6 Pt 369

Notice is hereby given that the Shire of Busselton has prepared the abovementioned scheme amendment for the purpose of rezoning Lots Pt 6 & 8 Causeway Road, Busselton from "General Farming" to "Short-Stay Residential" and "Recreation".

Plans and documents setting out and explaining the scheme amendment have been deposited at Council Offices, Southern Drive, Busselton and at the Western Australian Planning Commission, Albert Facey House, 469 Wellington Street, Perth, and will be available for inspection during office hours up to and including 29 January 1996.

Submissions on the scheme amendment should be made in writing on Form No. 4 and lodged with the undersigned on or before 29 January 1996.

This amendment is available for inspection in order to provide an opportunity for public comment and it should not be construed that final approval will be granted.

I. STUBBS, Chief Executive Officer.

PD410

TOWN PLANNING AND DEVELOPMENT ACT 1928
APPROVED TOWN PLANNING SCHEME AMENDMENT
Shire of Collie

Town Planning Scheme No. 1—Amendment No. 98

Ref: 853/6/8/1 Pt 98

It is hereby notified for public information, in accordance with Section 7 of the Town Planning and Development Act 1928 that the Hon Minister for Planning approved the Shire of Collie Town Planning Scheme Amendment on 10 December, 1995 for the purpose of rezoning Lot 472 Johnston Street, Collie from "Civic and Community Use" Reserve to "Commercial A" zone.

R. PIMM, President.
I. MIFFLING, Shire Clerk.

PD411

TOWN PLANNING AND DEVELOPMENT ACT 1928
SCHEME AMENDMENT AVAILABLE FOR INSPECTION
Shire of Mundaring

Town Planning Scheme No. 3—Amendment No. 9

Ref: 853/2/27/3 Pt 9

Notice is hereby given that the Shire of Mundaring has prepared the abovementioned scheme amendment for the purpose of—

1. Rezoning portions of Reserve 20990 from "Public Purposes" to "Public Open Space".
2. Rezoning Lot 14 from "Rural Landscape Living 2" to "Public Open Space".
3. Rezoning portions of Reserve 12422 from "Rural Landscape Living 2" to "Public Open Space".
4. Rezoning portion of Reserve 12422 allocated for Waste Water Treatment Plant (1.25ha) from "Rural Landscape Living 2" to "Public Purpose—Waste Water Treatment Plant".
5. Amending the Scheme Legend by adding the designation WWTP—Waste Water Treatment Plant.
6. Modifying the Scheme Map to show the approved subdivision on Lot 2 Jarrah Road.

Plans and documents setting out and explaining the scheme amendment have been deposited at Council Offices, 7000 Great Eastern Highway, Mundaring and at the Western Australian Planning Commission, Albert Facey House, 469 Wellington Street, Perth, and will be available for inspection during office hours up to and including 29 January 1996.

Submissions on the scheme amendment should be made in writing on Form No. 4 and lodged with the undersigned on or before 29 January 1996.

This amendment is available for inspection in order to provide an opportunity for public comment and it should not be construed that final approval will be granted.

M. N. WILLIAMS, Shire Clerk.

PD412

**METROPOLITAN REGION SCHEME—SECTION 33 AMENDMENT
OUTCOME OF AMENDMENT
“Regional Roads (Part 1)”**

File: 809-2-1-32

Amendment No.: 959/33

It is hereby notified for public information that the Regional Roads (Part 1) Amendment to the Metropolitan Region Scheme has been submitted before both Houses of Parliament for twelve sittings, in accordance with the provisions of section 33 of the Metropolitan Region Town Planning Scheme Act. During that time no motion of disallowance was carried by either House.

The amendment as depicted on Western Australian Planning Commission plan number 1.3189/2 is therefore effective in the Metropolitan Region Scheme on December 1, 1995.

LYNDSAY PREECE, A/Secretary, for Western Australian Planning Commission.

PD501

**METROPOLITAN REGION TOWN PLANNING SCHEME ACT 1959
METROPOLITAN REGION SCHEME—S.33 AMENDMENT
Regional Roads (Part 2)**

Call For Public Submissions

File No: 809-2-1-38.

Amendment No: 972/33.

The Metropolitan Region Scheme is proposed to be amended to revise the reservations and land requirements for nine regional roads, namely Vincent Street, Hutton Street, Kent Street, Miller Street, Roberts Road, Welshpool Road, Orrong Road, Manning Road and Ennis Avenue. The reservations are proposed to be adjusted to generally reduce the width of the reserves and to protect future opportunities for road improvements as they may be required with the growth of the region and as traffic demand dictates.

The procedure for amending the Scheme, as set out in section 33 of the Metropolitan Region Town Planning Scheme Act, is to be used to advertise this proposal. Public submissions are invited and the amendment will eventually be put to Parliament for final approval. In accordance with the procedure in section 33, the Hon Minister for Planning has approved the amendment for public display and for the calling of submissions.

Copies of the maps showing the proposed changes to the zones and reservations of the Scheme are available for the public inspection at each of the places listed hereunder.

The amending plans 1.3361/1 and 1.3362 are available for inspection from Monday 4 December 1995 to Friday 8 March 1996 at each of the following places—

- (a) Ministry for Planning
1st Floor, Albert Facey House
469-489 Wellington Street
Perth WA 6000
- (b) Council Offices of the municipalities of—
 - (i) City of Perth
Westralia Square
141 St Georges Terrace
Perth WA 6000
 - (ii) City of Fremantle
Corner Newman and William Streets
Fremantle WA 6160
 - (iii) City of Stirling
“Civic Place”
Stirling WA 6021

- (iv) City of Rockingham
"Civic Boulevard"
Cnr Simpson Avenue
Rockingham WA 6168
- (v) City of Canning
1317 Albany Hwy
Cannington WA 6107
- (vi) Town of Victoria Park
99 Shepperton Road
Victoria Park WA 6100
- (vii) Town of Vincent
Vincent Street
(Cnr Loftus Street)
Leederville WA 6007
- (viii) Town of Claremont
308 Stirling Hwy
Claremont WA 6010
- (c) J S Battye Library
Alexander Library Building
Cultural Centre
Francis Street
Northbridge WA 6003
- (d) Main Roads WA
"Don Aitken Centre"
Waterloo Crescent
East Perth WA 6004

Any person who desires to make a submission either supporting or objecting to any provisions of the proposed amendment may do so on the Form 6A. Submission forms are available on request from the display locations and must be lodged with the—

A/Secretary,
Western Australian Planning Commission
469-489 Wellington Street
Perth WA 6000

on or before 4.30 pm Friday 8 March 1996.

P. MELBIN, A/Secretary,
Western Australian Planning Commission.

POLICE

PE501

POLICE ACT 1892

AUCTION

The following property will be offered by Public Auction on behalf of the Commissioner of Police on 24 January, 1996 at the Broome Auction Centre, Clementson Street, Broome, commencing at 9.00 a.m.

- 1 Divers Watch
- 1 Pair Ray-Ban Sunglasses
- 4 Assorted Bicycles

Inspection of the above items can be made at the Broome Auction Centre, Lot 2096, Clementson Street, Broome from 17 January, 1996. Phone (091) 93 5309.

R. FALCONER, Commissioner of Police.

PE502

POLICE ACT 1892

AUCTION

Under the provisions of the Police Act 1892, unclaimed and stolen property will be sold by Public Auction at the premises of Katanning Police Station, 148 Clive Street, Katanning at 10.00 a.m. on 6 January, 1996.

Auction to be conducted by—

Frank Husband/Harold Sealy of Wesfarmers, Katanning.

R. FALCONER, Commissioner of Police.

PE503**POLICE ACT 1892****AUCTION**

Under the provisions of the Police Act 1892, unclaimed and stolen property will be sold by Public Auction at the premises of Broughton and Broughton, Auctioneers of Munda Way, Wedgefield, on Wednesday 7 February, 1996. The property will consist of numerous push bikes and assorted other property.

R. FALCONER, Commissioner of Police.

PREMIER AND CABINET**PR401****MINISTERIAL ACTING ARRANGEMENTS**

It is hereby notified for public information that His Excellency the Governor has approved the following temporary allocation of portfolio during the absence from office of the Hon. C. J. Barnett, MLA at any time in the period 2 to 12 January 1996 inclusive—

Acting Minister for Resources Development; Energy

Hon. S. G. E. Cash, MLC.

M. C. WAUCHOPE, Chief Executive.

PR402**MINISTERIAL ACTING ARRANGEMENTS**

It is hereby notified for public information that His Excellency the Governor has approved the following temporary allocation of portfolio during the absence from office of the Hon. G. D. Kierath, MLA at any time in the period 27 December 1995 to 28 January 1996 inclusive—

Acting Minister for Health; Labour Relations

Hon. K. J. Minson, MLA.

M. C. WAUCHOPE, Chief Executive.

PUBLIC TRUST**PT401****PUBLIC TRUSTEE ACT 1941**

(Section 40: Subsection 4)

Public Trust Office,
Perth WA 6000.
1 December 1995.

Notice is hereby given that the rate of Interest payable to the respective estates and trusts, the monies of which are held in the Common Fund have, as from 1 December 1995, been fixed as follows, calculated on the daily balance.

Court Trusts, Minor Trusts, Agency Trusts, Deceased and Uncared-for-Property (in the state of trusteeship or where considered necessary by the Public Trustee) otherwise prescribed, Incapable Patients' and Infirm Persons' Estates and Represented Persons' Estates; at the rate of 6.75% per annum.

Deceased and Uncared-for-Property (in course of administration or whilst under investigation); at the rate of 6.5% per annum.

Investment Agencies at the rate of 6.5% per annum.

K. E. BRADLEY, Public Trustee.

Approved:

1 December 1995.

CHERYL EDWARDES (Mrs) MLA, Attorney General.

RACING AND GAMING**RA301****GAMING COMMISSION ACT 1987****GAMING COMMISSION AMENDMENT REGULATIONS 1995**

Made by the deputy of the Governor in Executive Council.

Citation

1. These regulations may be cited as the *Gaming Commission Amendment Regulations 1995*.

Principal regulations

2. In these regulations the *Gaming Commission Regulations 1988** are referred to as the principal regulations.

[* *Published in Gazette of 29 April 1988 at pp. 1295-304.*
For amendments to 1 November 1995 see 1994 Index to Legislation of Western Australia, Table 4, p. 105, and Gazette of 6 January 1995.]

Regulation 18AA inserted

3. After regulation 18A of the principal regulations, the following regulation is inserted —

“

Video lottery terminals

18AA. (1) In these regulations, “**video lottery terminal**” means a device which displays electronically on a video screen a depiction of a card displaying symbols, by reference to which prizes in the game played may be won.

(2) The possession or use of a video lottery terminal is unlawful unless the conditions in subregulations (3), (4), (5), (6), (7), (8) and (9) are met.

(3) A video lottery terminal must not —

- (a) provide a means of direct cash pay out; or
- (b) allow more than four different kinds (“**series**”) of the same type of game to be played at any one time

(4) A video lottery terminal shall not be constructed or adapted so as to be playable by means of the insertion of any cash, other than of the amount determined from time to time by the Commission.

(5) A video lottery terminal shall not dispense to the person playing the device any thing other than, where the card displayed electronically by the device constitutes a winning score, a prize docket evidencing the amount of the win.

(6) A prize docket evidencing a win on a video lottery terminal shall be exchangeable with a person authorized by the permit holder for cash equal to the amount displayed on that docket.

(7) A video lottery terminal shall be located in premises approved by the Commission and specified in a permit issued in respect of that device, and not elsewhere.

(8) The total value of the prize dockets a video lottery terminal is designed to distribute shall comprise 70% of the total cash received by the device.

(9) Of the total amount of cash received by a video lottery terminal 6% shall be paid to the Commission, after allowing for reimbursement of the amounts paid out by way of prize money in exchange for prize docketts.

”.

Regulation 18B amended

4. Regulation 18B (1) of the principal regulations is amended by inserting after “regulation 18A” the following —

“ or 18AA ”.

By Command of the deputy of the Governor,

J. PRITCHARD, Clerk of the Council.

RA401

LIQUOR LICENSING ACT 1988

SUMMARY OF LIQUOR LICENSING APPLICATIONS

The following is a summary of applications received under the Liquor Licensing Act 1988 and required to be advertised. Any person wishing to obtain more details about any application, or about the objection process, should contact the Liquor Licensing Division, 1st Floor, Hyatt Centre, 87 Adelaide Terrace, Perth (Telephone: 425 1888), or consult a solicitor or relevant industry organisation.

App. No.	Applicant	Nature of Application	Last Date for Objections
TRANSFER OF LICENCE			
1203/95	Inclure Pty Ltd	Application for the transfer of a Special Facility Licence in respect of premises situated in Como and known as Pagoda Ballroom, from Pell Investments Pty Ltd.	22/12/95
1204/95	Success Venture Pty Ltd	Application for the transfer of a Special Facility Licence in respect of premises situated in Perth and known as the Sheraton Pacific Hotels Pty Ltd.	21/12/95
1205/95	K9 Pty Ltd	Application for the transfer of a Liquor Store Licence in respect of premises situated in Hillarys and known as Whitford City Cellars, from G & D Edwards Pty Ltd.	22/12/95
1206/95	Glasgow Holdings Pty Ltd	Application for the transfer of a Liquor Store Licence in respect of premises situated in Ongerup and known as Ongerup & Needilup Co-Op Ltd, from Ongerup & Needilup Co-Op Ltd.	22/12/95
1207/95	Belmondo Pty Ltd	Application for the transfer of a Restaurant Licence in respect of premises situated in Claremont and known as San Lorenzo Restaurant, from Whitefox Pty Ltd.	25/12/95
GRANT OF A LICENCE			
737/95	Kingswood College	Application for the grant of a Special Facility Licence in respect of premises situated in Nedlands and known as Kingswood College.	5/1/96
738/95	Greenport Nominees Pty Ltd	Application for the grant of a Restaurant Licence in respect of premises situated in Cottesloe and known as The Pavilion.	5/1/96

This notice is published under section 67 (5) of the Liquor Licensing Act 1988.

G. B. AVES, Director of Liquor Licensing.

STATE TAXATION

SX301

STAMP ACT 1921

STAMP AMENDMENT REGULATIONS 1995

Made by the His Excellency the Governor in Executive Council.

Citation

1. These regulations may be cited as the *Stamp Amendment Regulations 1995*.

Principal regulations

2. In these regulations the *Stamp Regulations 1979** are referred to as the principal regulations.

Regulation 3 amended

3. Regulation 3 of the principal regulations is amended by deleting "officers within the meaning of section 5 of the *Public Service Act, 1978*," and substituting the following —

" persons ".

Regulation 4 amended

4. Regulation 4 of the principal regulations is amended in subparagraph (1) (d) (ii) by deleting "of which the authorised person is an officer" and substituting the following —

"
in which the authorized person holds or is discharging the duties
of an office
".

Regulation 8 amended

5. Regulation 8 of the principal regulations is amended by deleting "An officer" and substituting the following —

" A person ".

Regulation 13A inserted

6. After regulation 13 of the principal regulations the following regulation is inserted —

"
Prescribed form in section 112F

13A. For the purposes of section 112F (2), the prescribed form of the statement required to be prepared and lodged with the Commissioner in respect of the transfer is set out in form 4 of the Third Schedule.
".

Regulation 19 amended

7. Regulation 19 (1) (c), (f), (g) and (h) of the principal regulations are amended by deleting "officer" wherever it occurs and substituting the following —

" person ".

Third Schedule amended

8. The Third Schedule to the principal regulations is amended —

- (a) in the regulation reference under the Schedule heading by deleting “and 12A” and substituting the following —

“ , 12A and 13A ”; and

- (b) by adding at the end the following form —

“

Form 4

STAMP ACT 1921

**STATEMENT OF A SECURITIES LENDING
ARRANGEMENT DISPOSITION REFERRED TO
IN SECTION 112F (2)**

TO THE COMMISSIONER OF STATE TAXATION

1. I/We
.....
of
in the State of
declare that I/we am/are a party to a securities
lending arrangement to which section 112F (2)
applies.
2. A description of the marketable securities or
rights in respect of shares relating to the
securities lending arrangement is as follows:
 - (a) Name of the Company, Corporation or
Trust
 - (b) Class of security
 - (c) Quantity
 - (d) Par value
 - (e) Paid up value
3. The date of expiry of the re-acquisition time
was
4. The unencumbered value of the marketable
securities or rights in respect of shares as at
the date of expiry of the re-acquisition time is
\$
5. The amount of moneys paid as a result of the
securities not being repaid to the lender is
\$
6. Payment of \$ stamp duty is enclosed,
calculated in accordance with Item 4A (1) of the
Second Schedule to the Stamp Act on the
greater of the unencumbered value (Item 4) or
the amount of moneys paid at (Item 5).
7. The name(s) and address(es) of the other
person(s) who entered into the securities
lending arrangement is/are:
.....
.....
.....

I/We certify that all details in this statement are true
and correct.

Signature(s) Date
.....

”.

[* *Published in Gazette of 7 December 1979 at pp. 3780-87.
For amendments to 16 November 1995 see 1994 Index to Legislation of
Western Australia, Table 4, pp. 262-63.*]

By His Excellency's Command,

J. PRITCHARD, Clerk of the Council.

TRANSPORT

TR401

WESTERN AUSTRALIAN MARINE ACT 1982

RESTRICTED SPEED AREAS—ALL VESSELS

Speed Boat Hire and Drive Operation Area

Rockingham/Cockburn Sound

Department of Transport,
Fremantle WA, 15 December 1995.

Acting pursuant to the powers conferred by Section 67 of the Western Australian Marine Act 1982 the Department of Transport, by this Notice—

Revokes paragraph (d) (4) (iv) of the notice published in the *Government Gazette* of 25 October 1991 relating to speed limits in the Rockingham, Cockburn Sound area, provided that this revocation will only apply to Licensed Hire and Drive operations approved by the Department of Transport, between sunrise and sunset, to operate within the following area—

Rockingham-Cockburn Sound

All those waters 400 metres to seaward of an area commencing 100 metres offshore from the prolongation of Hillman Street then 220° direction of a position 100 metres offshore from the prolongation of Wanliss Street and providing that the speed of authorised hire vessels within 100 metres of the foreshore is limited to that of eight (8) knots.

STUART HICKS, Director General of Transport.

TR402

NAVIGABLE WATERS REGULATIONS

Speed Boat Hire and Drive Operation Area

Rockingham/Cockburn Sound

Department of Transport,
Fremantle WA, 15 December 1995.

Acting pursuant to the powers conferred by Regulation 48A of the Navigable Waters Regulations the Department of Transport, by this Notice defines and sets aside the following area of Navigable Waters for the purpose of speed boat hire and drive operations providing that this area is confined to Licensed Hire and Drive operations approved by the Department of Transport to operate within this area between sunrise and sunset—

Rockingham-Cockburn Sound

All those waters 400 metres to seaward of an area commencing 100 metres offshore from the prolongation of Hillman Street then 220° direction of a position 100 metres offshore from the prolongation of Wanliss Street and providing that the speed of authorised hire vessels within 100 metres of the foreshore is limited to that of eight (8) knots.

STUART HICKS, Director General of Transport.

WATER AUTHORITY

WA401

COUNTRY TOWNS SEWERAGE ACT 1948

SEABIRD SEWERAGE AREA ORDER 1995

Made by His Excellency the Governor in Executive Council under section 4 (a).

Citation

1. This order may be cited as the Seabird Sewerage Area Order 1995.

Seabird Sewerage Area

2. The land described in the Schedule to this order is constituted the Seabird Sewerage Area.

Schedule

(Clause 2)

All that portion of land above Low Water Mark contained within a circle having a radius of 4 000 metres, centred on the South West corner of lot 282 Hudson Street, Seabird Townsite, as shown on Water Authority of Western Australia Plan DU59-0-1.

By His Excellency's Command,

J. PRITCHARD, Clerk of the Council.

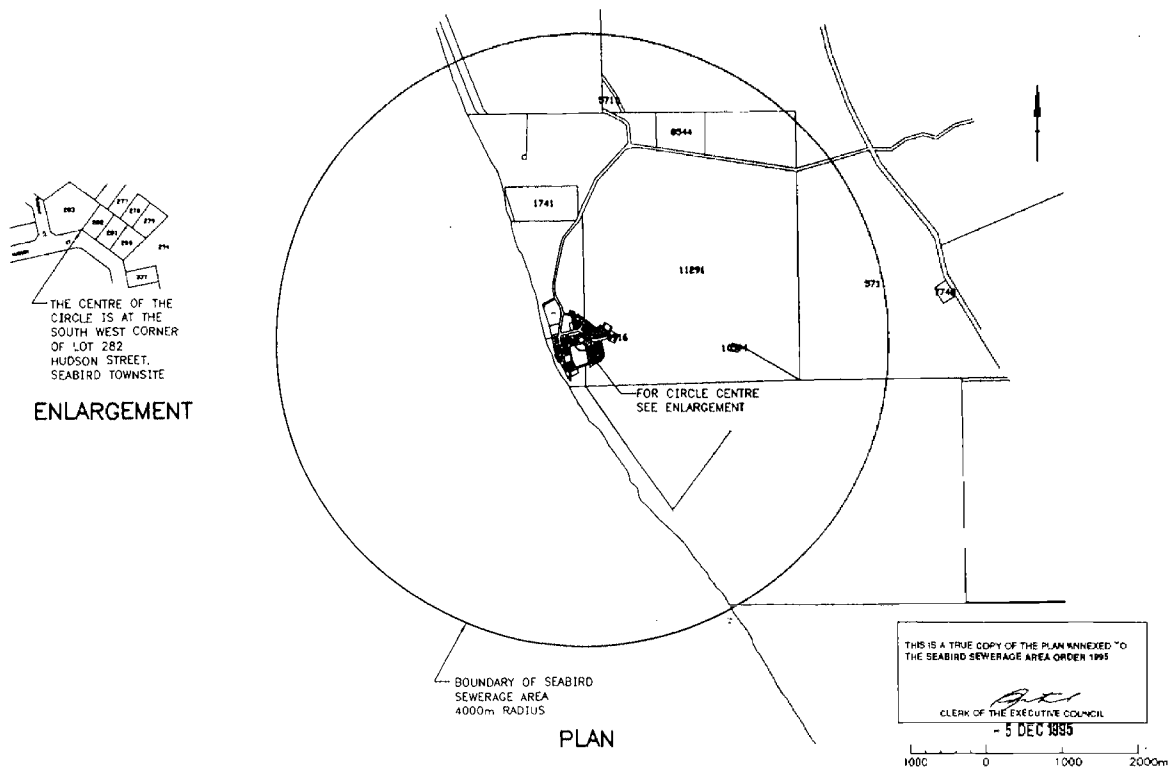

WA402

COUNTRY TOWNS SEWERAGE ACT 1948

LEDGE POINT SEWERAGE AREA ORDER 1995

Made by His Excellency the Governor in Executive Council under section 4 (a).

Citation

1. This order may be cited as the Ledge Point Sewerage Area Order 1995.

Ledge Point Sewerage Area

2. The land described in the Schedule to this order is constituted the Ledge Point Sewerage Area.

Schedule

(Clause 2)

All that portion of land above Low Water Mark contained within a circle having a radius of 4 000 metres, centred on the intersection of the centre line of Ledge Point Drive with the prolongation North-erly of the centre line of Jones Street, Ledge Point Townsite, as shown on Water Authority of Western Australia Plan DU60-0-1.

By His Excellency's Command,

J. PRITCHARD, Clerk of the Council.

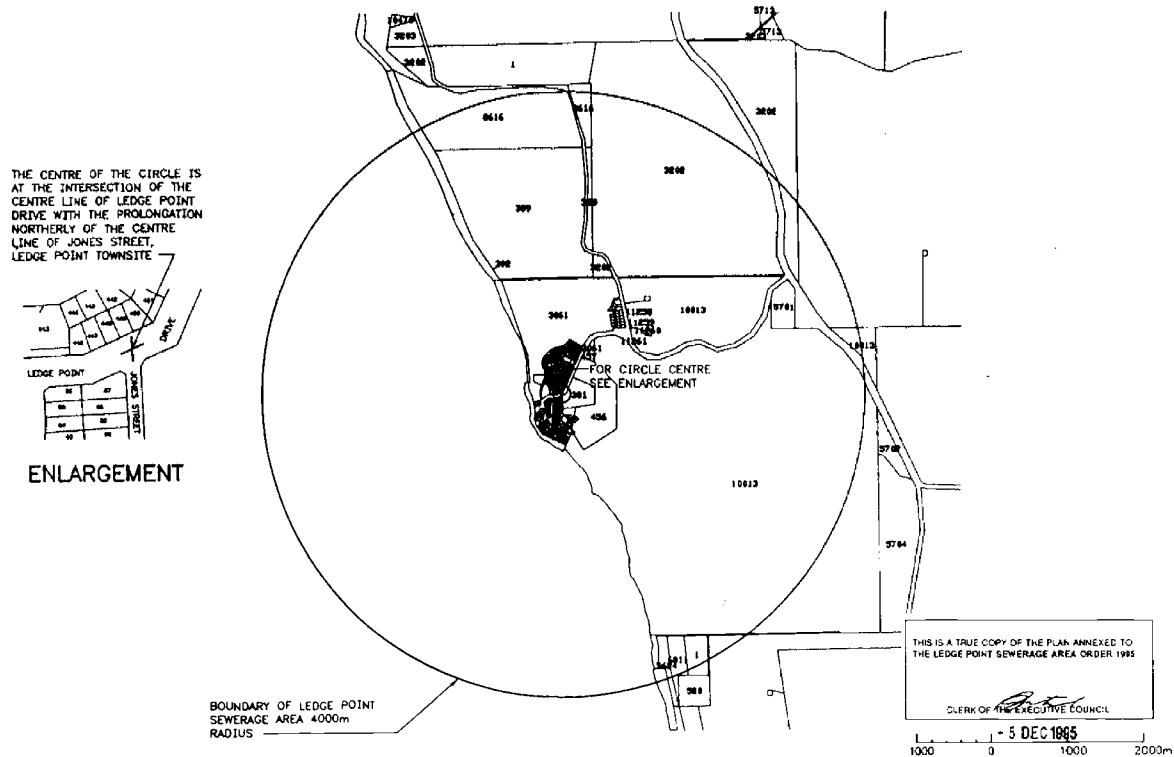

WA403

**COUNTRY TOWNS SEWERAGE ACT 1948
CERVANTES SEWERAGE AREA ORDER 1995**

Made by His Excellency the Governor in Executive Council under section 4 (a).

Citation

1. This order may be cited as the Cervantes Sewerage Area Order 1995.

Cervantes Sewerage Area

2. The land described in the Schedule to this order is constituted the Cervantes Sewerage Area.

Schedule

(Clause 2)

All that portion of land above Low Water Mark contained within a circle having a radius of 5 000 metres, centred on the intersection of the centre line of Seville Street with the prolongation Northerly of the centre line of Valencia Road, Cervantes Townsite, as shown on Water Authority of Western Australia Plan DU61-0-1.

By His Excellency's Command,

J. PRITCHARD, Clerk of the Council.

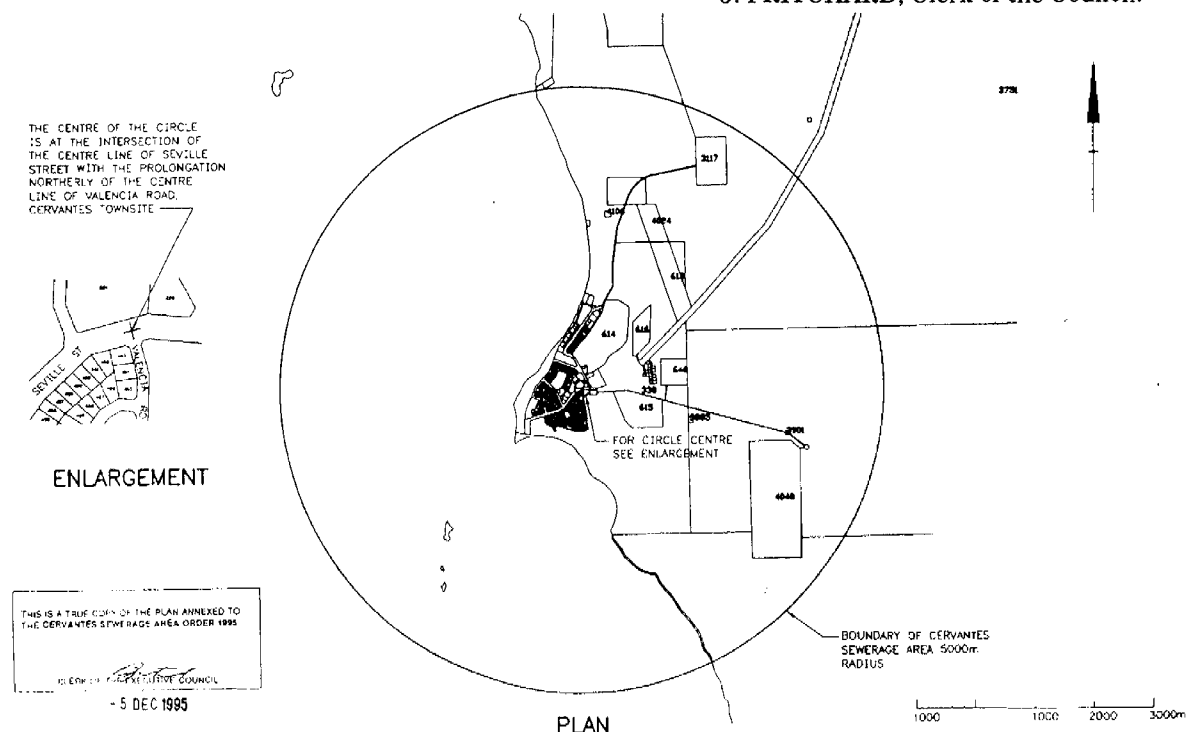

WA404

**COUNTRY TOWNS SEWERAGE ACT 1948
ONSLow SEWERAGE AREA ORDER 1995**

Made by His Excellency the Governor in Executive Council under section 4 (a).

Citation

1. This order may be cited as the Onslow Sewerage Area Order 1995.

Onslow Sewerage Area

2. The land described in the Schedule to this order is constituted the Onslow Sewerage Area.

Schedule

(Clause 2)

All that portion of land above Low Water Mark contained within a circle having a radius of 2 000 metres, centred on the intersection of the centre line of Watson Drive with the prolongation easterly of the centre line of McGrath Avenue, Onslow Townsite, as shown on Water Authority of Western Australia Plan DU81-0-1.

By His Excellency's Command,

J. PRITCHARD, Clerk of the Council.

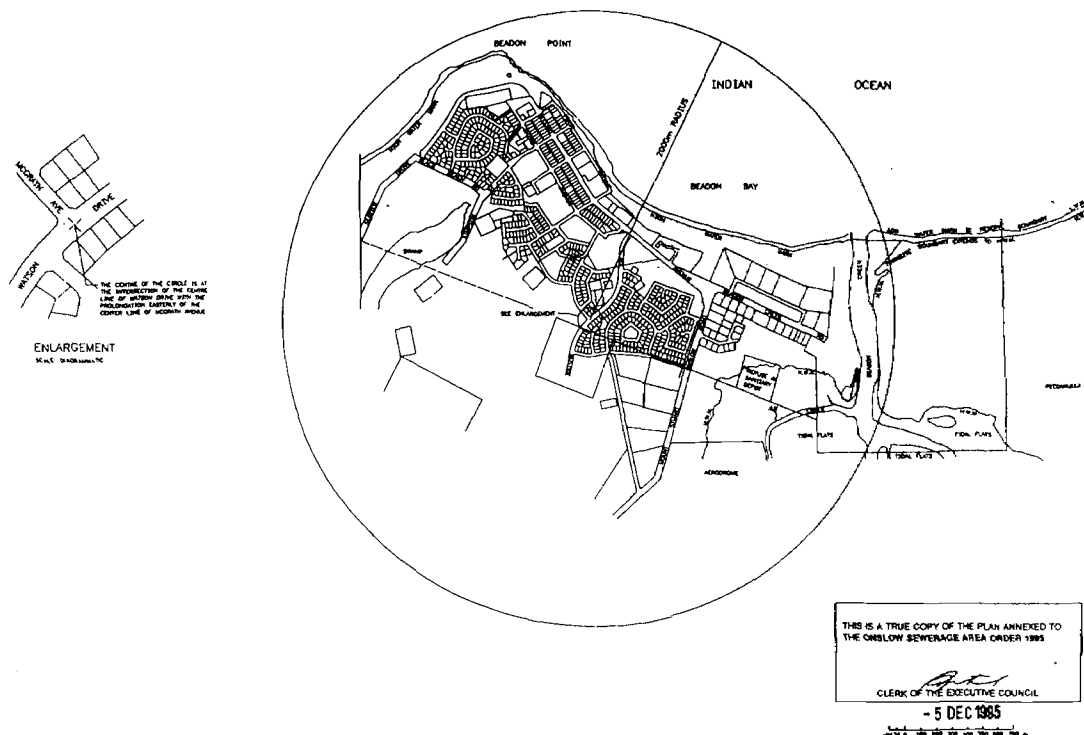
**WA405**

**COUNTRY TOWNS SEWERAGE ACT 1948
CAPEL SEWERAGE AREA ORDER 1995**

Made by His Excellency the Governor in Executive Council under section 4 (a).

Citation

1. This order may be cited as the Capel Sewerage Area Order 1995.

Capel Sewerage Area

2. The land described in the Schedule to this order is constituted the Capel Sewerage Area.

Schedule

(Clause 2)

All that portion of land above Low Water Mark contained within a circle having a radius of 2 500 metres, centred on the south west corner of lot 23 Roe Rd, Capel Townsite, as shown on Water Authority of Western Australia Plan DV21-0-1.

By His Excellency's Command,

J. PRITCHARD, Clerk of the Council.

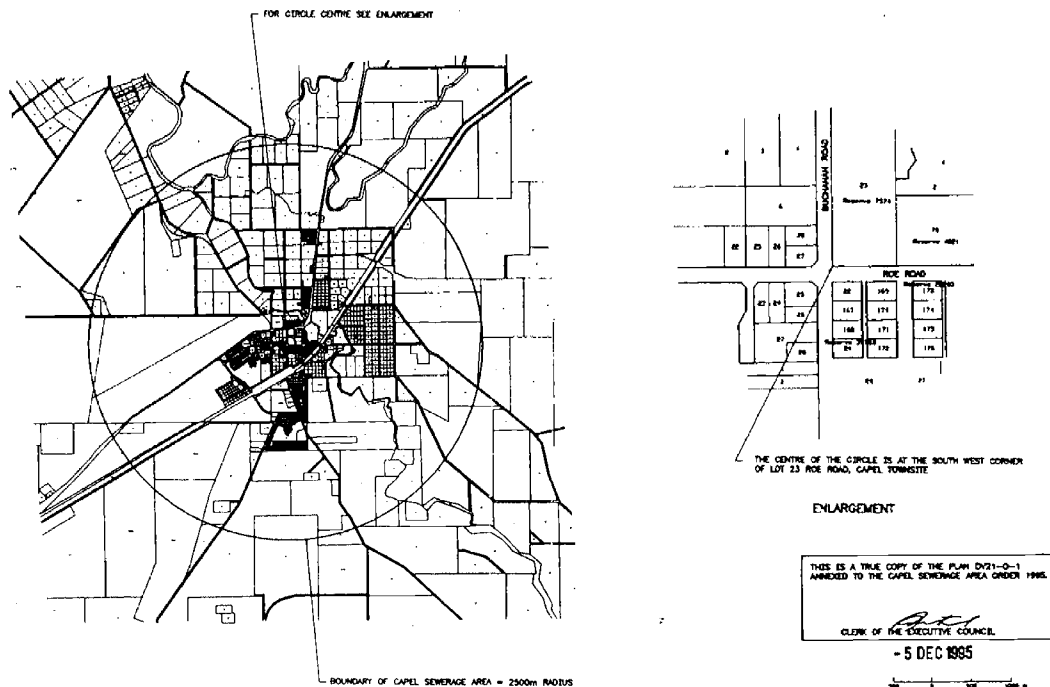

WA406

COUNTRY AREAS WATER SUPPLY ACT 1947**YUNA COUNTRY WATER AREA ORDER 1995**

Made by His Excellency the Governor in Executive Council under section 8 (1)(a).

Citation

1. This order may be cited as the Yuna Country Water Area Order 1995.

Yuna Country Water Area

2. The land described in the Schedule to this order is constituted the Yuna Country Water Area.

Schedule

(Clause 2)

All that area of land shown with symbolized boundary  on Water Authority of Western Australia Plan DU62-0-1 the original of which is held by the Water Authority of Western Australia.

By His Excellency's Command,

J. PRITCHARD, Clerk of the Council.

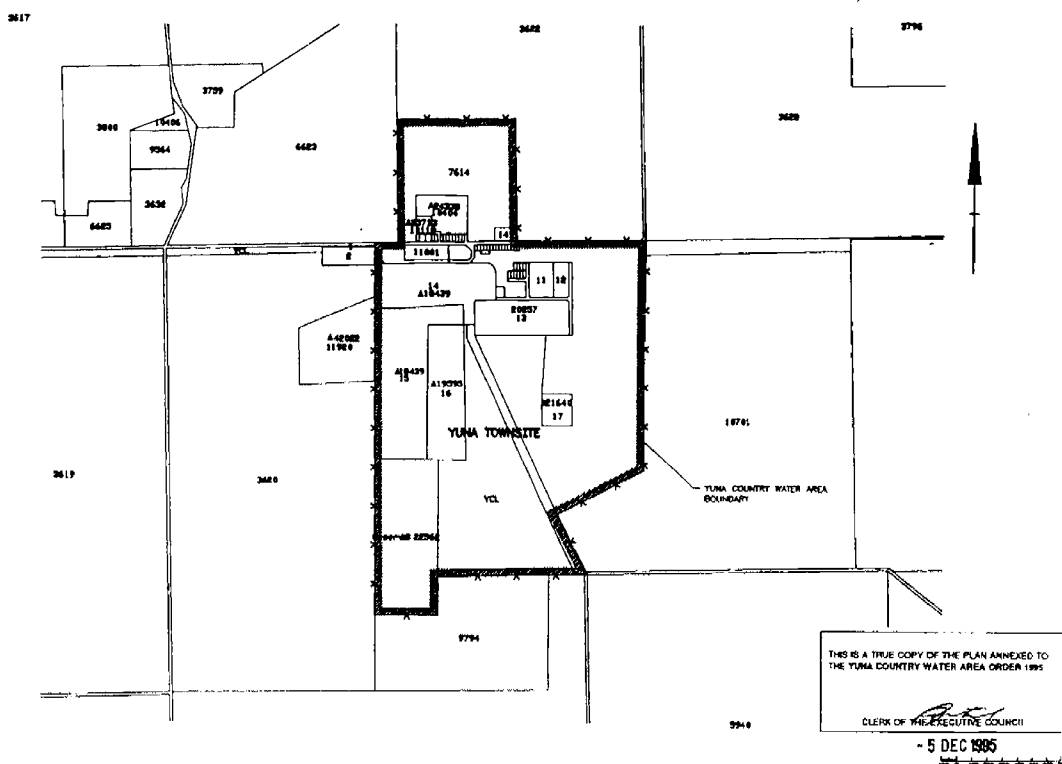

WA407

COUNTRY AREAS WATER SUPPLY ACT 1947
BADGINGARRA COUNTRY WATER AREA ORDER 1995

Made by His Excellency the Governor in Executive Council under section 8 (1)(a).

Citation

1. This order may be cited as the Badgingarra Country Water Area Order 1995.

Badgingarra Country Water Area

2. The land described in the Schedule to this order is constituted the Badgingarra Country Water Area.

Schedule

(Clause 2)

All that area of land shown with symbolized boundary  on Water Authority of Western Australia Plan DU63-0-1 the original of which is held by the Water Authority of Western Australia.

By His Excellency's Command,

J. PRITCHARD, Clerk of the Council.

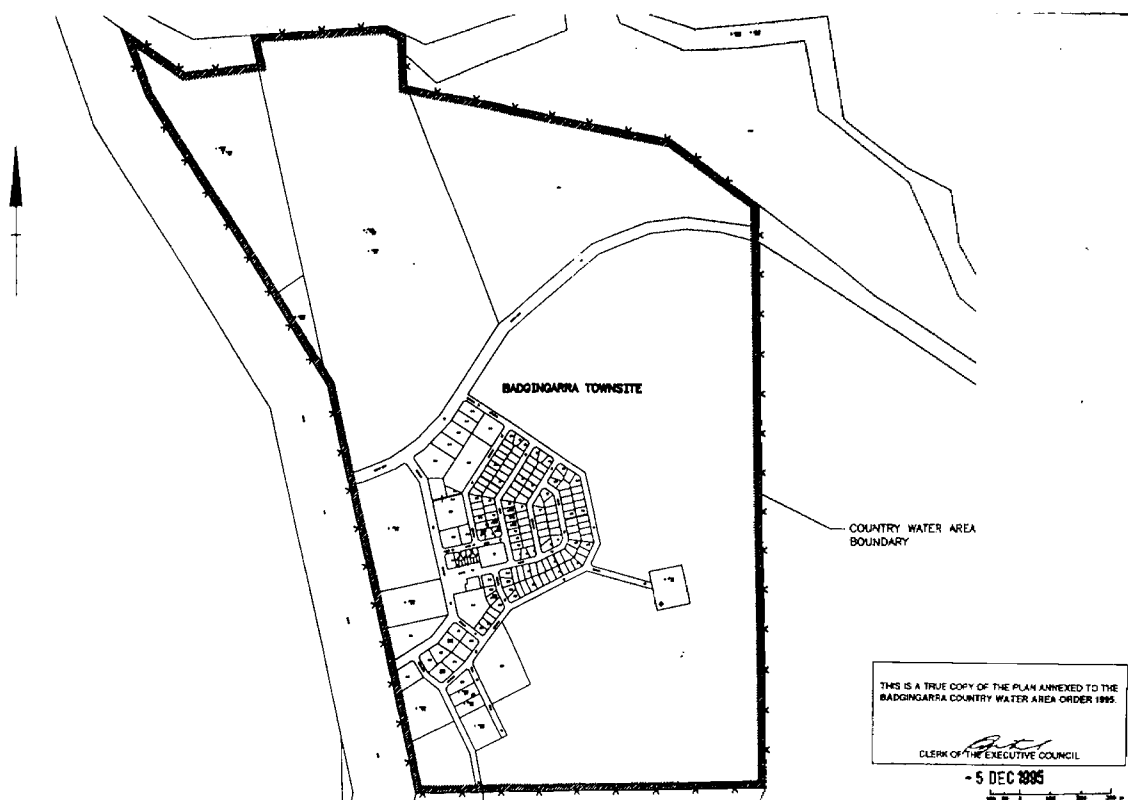

WATERWAYS COMMISSION

WB401

WATERWAYS CONSERVATION ACT 1976

For the purpose of making an appointment to the Avon River Management Authority His Excellency the Governor acting pursuant to the powers conferred by Sections 14 and 16 of the Waterways Conservation Act 1976 as amended and on the recommendation of the Minister for the Environment has been pleased on the 5th day of December 1995 to appoint:

GAVIN MARK BUTCHER as Member

J. PRITCHARD, Clerk of the Council.

WB402

WATERWAYS CONSERVATION ACT 1976

For the purpose of making an appointment to the Peel Inlet Management Authority His Excellency the Governor acting pursuant to the powers conferred by Sections 14 and 16 of the Waterways Conservation Act 1976 as amended and on the recommendation of the Minister for the Environment has been pleased on the 5th day of December 1995 to appoint:

STEPHEN CRAIG RAPER as Deputy Member

J. PRITCHARD, Clerk of the Council.

TENDERS

ZT201

MAIN ROADS
WESTERN AUSTRALIA

Tenders

Tenders are invited for the following projects.

Tender documents are available from the Contracts Officer, Supply Services Branch, Ground Floor, Waterloo Crescent, East Perth.

Tender No.	Description	Closing Date
110/95	Reconstruct Albany Highway through Gleneagle Forest, construct passing lanes on Albany Highway, reconstruct Brookton Highway, Wheatbelt South Region	9 Jan. 1996
403/95	Gravel road sheeting and grading Lake King Cascades Road, Great Southern Region	28 Dec. 1995
398/95	Catering and cleaning services of Main Roads camp at Great Northern Highway 1322.6 SLK, Gascoyne Region	9 Jan. 1996
408/95	Supply and delivery of various Microsoft licences	18 Dec. 1995
400/95	Detail surveys for traffic design	21 Dec. 1995
323/95	Road and bridge construction—Bridge 630, Wheatbelt North Region	11 Jan. 1996

ZT202

Acceptance of Tenders

Contract No.	Description	Successful Tenderer	Amount
			\$
165/95	Supply and delivery of crushed aggregate and bitumen and sealing and resealing, various roads, Wheatbelt North Region.	Pioneer Road Services Pty Ltd	\$1 810 973.94
271/95	Tender assessment and contract management services for the longitudinal road marking in rural regions contract.	Quality and Technical Services Pty Ltd	\$251 100.00
183/95	Limited cadastral survey, Great Northern Highway, Newman-White Springs.	John Bullock and Associates	\$96 200.00
235/95	Supply and delivery of various personal computer upgrade equipment.	Q Technology	\$203 855.00
290/95	Installation of architecture lighting on Narrows Bridge.	Electrical Construction and Maintenance	\$175 885.00
259/95	Provision of design and construction management of various traffic improvement projects in the Metropolitan area.	BSD Consultants Pty Ltd. Fraser Worley Engineers Pty Ltd. Gutteridge Haskins and Davey Pty Ltd.	In accordance with the Contract on a value for money basis.

D. R. WARNER, Director Corporate Services.

ZT301

STATE SUPPLY COMMISSION

Tenders Invited

Tenders forms and full particulars of the Schedule hereunder may be obtained on application at the State Supply Commission, 6th Floor, 441 Murray Street, Perth, 6000.

TELEPHONE No. 365 8491

FACSIMILE No. 321 7918

Date of Advertising	Schedule No.	Description	Date of Closing
1995			1995/96
<i>Supply and Delivery</i>			
December 1	118A1995	Envelopes (Plain) including Over-Printing Requirements to various Government Departments	December 21
November 24	292A1995	Cook-Chill Meals to Carramar and Pindarra Hostels on behalf of the Disability Services Commission	December 21
		Pre-tender briefing to be held at 60 Lord Street, Eden Hill on 8 December 1995 at 10.00 am.	
November 24	577A1995	Supply, Installation and Maintenance of Computing Equipment and associated software for the Ministry of Justice	Extended to December 21
December 1	580A1995	Photocopy and Computer Paper for the Department of Agriculture	December 21
December 8	581A1995	Four (4) 25 000 kg Cab Chassis Trucks, 2 Tipping & 2 Tray Top for the Department of Agriculture	December 21
December 8	582A1995	One (1) only Front Wheel Drive Tractor for Esperance Downs Research Station for the Department of Agriculture	January 4
December 15	588A1995	Records Management Software for the Central Metropolitan College of TAFE	January 4
December 15	592A1995	Automatic Irrigation System for the Burswood Park Public Golf Course Clubhouse & Entry Drive	January 11
December 8	050B1995	Furniture Group 4—Hospital, Hostel and Residential including Bedding, Mattresses and Blinds for various Government Departments (Recall of certain items only)	January 11
November 24	578A1995	Supply and installation of Cinema and additional Audio Equipment for the Centennial Theatre, Goldfields Arts College Centre, Kalgoorlie College	Extended to January 18
<i>Expression of Interest</i>			
December 1	EOI54/95	Provision of WAN/LAN Interconnectivity Equipment for the Western Australian Police Department	December 21
December 15	EOI57/95	Provision of Insurance and Risk Management Services to Homeswest	January 11
<i>Request for Proposal</i>			
December 8	RFP 53/95	Design, Installation and Maintenance of a Parent Management Information System for Family & Children Services	January 18
		Please note an Information Briefing Session will be held on Wednesday, 20 December 1995 at 10.00 am on the Ground Floor, 189 Royal Street, East Perth.	
<i>Provision of Service</i>			
November 24	209A1995	Provision of Accreditation and Registration of Education and Training Services for the WA Police Department. All potential tenderers shall attend a mandatory Pre-tender briefing at the WA Police Academy, Reception, 2 Swanbank Road, Maylands, at 9.00 am, Monday, 11 December 1995	December 21
November 24	302A1995	Charter of Passenger Aircraft—Subsequent to contract 259A1993. RFT 302A1995 relates to Part 3—Panel Arrangements only, which provides for the appointment of a panel of qualified charter operators whose aircraft are suitable and available for Government use. The successful panellists will be required to provide support to the primary contractor appointed under contract 259A1993	December 21

Tenders—*continued*

Date of Advertising	Schedule No.	Description	Date of Closing
1995			1995/96
December 8	332A1995	Supply & Service of Hygiene Disposal Units to all Commission premises for the Disability Services Commission	January 4
December 15	023A1995	Provision of Temporary and Long Term Storage and Retrieval of Records for various Government Departments	January 11
December 15	330A1995	Financial Audit Services for the Ministry of Justice	January 18
December 15	590A1995	Supply, Installation and Maintenance of a Network Management System for the Department of Transport	January 18
December 15	591A1995	Consultancy Services for the Jervoise Bay Infrastructure Plan Study on behalf of the Department of Commerce and Trade	January 18
<i>Purchase & Removal</i>			
December 8	585A1995	Stateships Shipping Containers at Darwin	December 21
December 15	587A1995	(Recall). One (1) only 1988 Nissan Patrol Trayback (7QW 524) for the Aboriginal Affairs Department, Derby	December 21

Tenders addressed to the Chairman, State Supply Commission, 6th Floor, 441 Murray Street, Perth WA 6000, before 10.00 am on the nominated closing date.

Tenders must be properly endorsed on envelopes otherwise they are liable to rejection. No tender necessarily accepted.

CRAIG LAWRENCE, Chairman, State Supply Commission.

ZT302*Accepted Tenders*

Schedule No.	Particulars	Contractor	Rate
<i>Supply and Delivery</i>			
423A1995	Midrange Computing Equipment and Software to service the Financial Management Information System for the Department of Transport.	Focal Systems P/L	Details on Request
562A1995	Automatic Irrigation System for the Burswood Park Board.	Total Eden Watering System	Details on Request
<i>Provision of Service</i>			
267A1995	Air Freight Services for various Government Departments.	Ansett Air Freight	Details on Request
300A1995	Information Technology Services and Support for the Ministry of Premier and Cabinet.	Various	Details on Request
318A1995	Pre-Trade, Trade and Post Trade in Painting and Decorating for the Department of Training.	Various	Details on Request
514A1995	Outsourcing the Planning and Management of the Information Technology Function for the Department of Resources Development.	Advanced Resource Management Consultants	Details on Request
571A1995	Maintenance of Programming Services, for the Support of the Student Management Module of the Western Australian Department of Training's College Management Information Systems (CMIS).	Computer People	\$58.00 p/hour
<i>Request for Proposal</i>			
RFP 38/95	Provision of Track Management and Site Restoration for the Kings Park Board.	Ecospa (Australia) P/L	Details on Request
RFP 43/95	Pre-Qualification of Suppliers for the Engagement of Consultants and Computing Personnel for the Supply of Computing and Information System Services for the Government Employees Superannuation Board.	Various	Details on Request

PUBLIC NOTICES**ZZ101****TRUSTEES ACT 1962**

Notice to Creditors and Claimants

Creditors and other persons having claims (to which section 63 of the Trustees Act relates) in respect of the Estates of the undermentioned deceased persons are required to send particulars of their claims to me on or before the 15th January 1996, after which date I may convey or distribute the assets, having regard only to the claims of which I then have notice.

Bates, Joan Evelyn, late of Kimberley Nursing Home, 76-78 Kimberley Street, Leederville, died 31/10/95. (DEC 288460 DA1)

Bloomfield, Edith Mary, late of 4/260 Cambridge Street, Wembley, died 7/10/95. (DEC 288918 DP3)

Bush, Douglas Robert, late of 4B Caprella Street, Heathridge, died 27/10/95. (DEC 288654 DE3)

Comty, Marie Anne Gilberte, also known as Comty, Anne Marie Gilberte and Comty, Marie Gilberte Anne, late of 11 Illawarra Crescent, Ballajura, died 14/8/95. (DEC 288122 DE2)

Dillon, Stanley Thomas, late of 50 Joondanna Drive, Joondanna, died 12/10/95. (DEC 289162 DG4)

Dixon, Edith May, late of Chrystal Halliday Nursing Home, 61 Jeans Road, Karrinyup, died 9/11/95. (DEC 288711 DS3)

Genevicius, Clara Emily, late of Shoalwater Nursing Home, Fourth Avenue, Shoalwater, died 1/8/95. (DEC 288160 DC4)

Gray, Ellen Maria Edna, late of Jacaranda Lodge, Belgrade Road, Wanneroo, died 26/10/95. (DEC 288475 DC4)

Hall, Olive Evelyn, late of 125/43 McNabb Loop, Como, died 29/9/95. (DEC 287859 DD2)

Hanlon, Paul Frederick, late of 22B Stanford Street, Leederville, died 2/6/95. (DEC 286512 DD3).

King, Mildred Maud, formerly of 12 Margaret Street, Waterman, late of Homes of Peace, Renegade Way, Kingsley, died 17/11/95. (DEC 289197 DS2)

Lamb, Grace Edna, late of 26 Cara Road, Greenmount, died 16/11/95. (DEC 288988 DP4)

Laurisch, Reginald Charles, late of Hakea Villas, 5/5 Randell Street, Esperance, died 20/4/95. (DEC 282953 DD3)

McLaren, Walter James Raymond, late of 1/7 Park Road, Midvale, died 14/10/95. (DEC 288834 DS4)

Peel, William Kenneth, late of 2/151 Sydenham Street, Rivervale, died 12/9/95. (DEC 287856 DA4)

Plowman, Jack Gordon, also known as Plowman, Gordon John, late of 4/48 Abermarle Street, Doubleview, died 19/9/95. (DEC 287981 DA4)

Prince, Norman Alfred, late of The Cottage Hospice, 11 Bedbrook Place, Shenton Park, died 4/9/95. (DEC 287017 DD3)

Robinson, Charles Thomas, late of Embleton Nursing Home, 46 Broun Avenue, Embleton, died 17/11/95. (DEC 288872 DG3)

Wilton, Emily Ida, late of Lady McCusker Home, 27 Beddi Road, Duncraig, died 27/8/95. (DEC 288329 DD3).

Yule, James Henry, late of Agmaroy Nursing Home, 115 Leach Highway, Wilson, died 21/10/95. (DEC 288656 DA4).

K. E. BRADLEY, Public Trustee,
Public Trust Office, 565 Hay Street, Perth WA 6000.
Telephone 222 6777

ZZ201**TRUSTEES ACT 1962**

Creditors and other persons having claim (to which section 63 of the Trustees Act 1962 relates) in respect of the undermentioned deceased persons are required to send particulars of their claims to the Executors of the care of Kott Gunning, Level 11, 15-17 William Street, Perth by the 19th January 1996 after which date the Trustees may convey or distribute the assets, having regard only to the claims of which notice has been given.

Surname; Given Names; Address; Occupation; Date of Death

Gibbon; Michael Robert; Lot 55 Toodyay-Perth Road, Toodyay; Club Manager; 22/9/95.

Goodings; Margo; 58 McCourt Street, Leederville; Taxation Worker; 7/9/95.

ZZ202**TRUSTEES ACT 1962**

Giovina La Canale (also known as Giovina Lacanale) late of 53 Harrison Street, Balcatta, home duties.

Creditors and other persons having claims (to which section 63 of the Trustees Act 1962, relates) in respect of the estate of the deceased who died on the 21st day of June 1995, are required by the Trustee, Clair Anne Nacinovich of c/- Solomon Brothers, Level 40 Exchange Plaza, 2 The Esplanade, Perth in the State of Western Australia to send particulars of their claims to her by the 19th day of January 1996, after which date the Trustee may convey or distribute the assets, having regard only to the claims of which she then has notice.

CONTENTS
REGULATIONS, BY-LAWS, RULES, DETERMINATIONS, ORDERS

	Page
Bush Fires Act—Shire of Broome	6081-2
Gaming Commission Act—Gaming Commission Amendment Regulations 1995	6124-5
Mining Act—Mining Amendment Regulations (No. 4) 1995	6114-5
Pearling Act—Pearling (Annual Fees) Notice (No. 2) 1995	6108
Retail Trading Hours Act—Retail Trading Hours (Filling Stations) Exemption Order (No. 4) 1995	6108-10
Stamp Act—Stamp Amendment Regulations 1995	6126-8

GENERAL CONTENTS

	Page
Bush Fires Act	6081-2
Education	6082-6107
Fisheries	6108
Fair Trading	6108-10
Heritage Council of W.A.	6110
Justice	6111
Land Administration	6111
Local Government	6112-4
Minerals and Energy	6114-7
Planning	6117-22
Police	6122-3
Premier and Cabinet	6123
Proclamations	6077-81
Public Notices—	
Deceased Persons	6137
Public Trust	6123
Racing and Gaming	6124-5
State Taxation	6126-8
Tenders—	
Main Roads	6134
State Supply Commission	6135-6
Transport	6128
Water Authority	6128-33
Waterways Commission	6133

