



# Government Gazette

OF

## WESTERN AUSTRALIA

(Published by Authority at 3.30 p.m.)

(REGISTERED AT THE GENERAL POST OFFICE, PERTH, FOR TRANSMISSION BY POST AS A NEWSPAPER)

No. 9]

PERTH: FRIDAY, 9th FEBRUARY

[1968

AT a meeting of the Executive Council held in the Executive Council Chambers at Perth this 7th day of February, 1968, the following orders in Council were authorised to be issued:—

Local Government Act, 1960.

City of Nedlands.

ORDER IN COUNCIL.

L.G. 35/68.

WHEREAS the Council of the City of Nedlands is desirous, under the By-law making power conferred by section 193 of the Local Government Act, 1960, of making by-laws for regulating public bathing and the costumes of bathers and the conduct of bathers and others in the sea though outside its district for a distance of two hundred (200) yards from low water mark at ordinary spring tides; and whereas it is enacted by subparagraph (iv) of paragraph (a) of that section, that such By-laws may be made only pursuant to an Order made under subsection (8) of section 190 of the Act; and whereas it is enacted by the subsection last mentioned, that where in the opinion of the Governor a by-law making power conferred by the Act on a Council should be extended to areas which are outside the district, the Governor may by Order declare that for the purpose of the exercise of the power the areas are to be regarded as being within the district and that the Council may exercise the power in respect of the areas as if in fact they were within the district; and whereas the Governor is of the opinion that the said By-law making power should be extended to the said areas outside the district of the said Council: now, therefore, His Excellency

the Governor, pursuant to the powers conferred by subsection (8) of section 190 of the Local Government Act, 1960, and acting by and with the advice and consent of the Executive Council, doth hereby declare that for the purpose of the exercise of the said by-law making power areas which are outside the district of the City of Nedlands, namely areas which adjoin that district and extend for a distance of two hundred (200) yards seaward from low water mark at ordinary spring tides are to be regarded as being within the district of the City of Nedlands and that the Council of the City of Nedlands may make By-laws for regulating public bathing and the costumes of bathers and the conduct of bathers and others in respect of those areas as if in fact they were within the municipal district of the City of Nedlands.

W. S. LONNIE,  
Clerk of the Council.

Local Government Act, 1960.

Shire of Ashburton.

ORDER IN COUNCIL.

L.G. 293/52.

WHEREAS by an Order made on the 17th January, 1968, and published in the *Government Gazette* on the 19th January, 1968, the Governor, in exercise of the power conferred by subsection (8) of section 41 of the Local Government Act, 1960, did declare the date of retirement of one member of each of the Town and North West Wards of the Municipality of the Shire of Ashburton; and whereas there was an error in the Order occurring

in the declaration for the Town Ward Member; and whereas it is provided by subsection (2) of section 691 of the abovementioned Act, that an error in an Order made under the provisions of that Act, may be rectified by the Governor by a subsequent Order: now therefore His Excellency the Governor acting with the advice and consent of Executive Council and in exercise of the powers conferred by subsection (2) of section 691 of the Local Government Act, 1960, doth by this Order rectify the said error by amending the Order made on the 17th January, 1968, by substituting for the passage "Town; to be elected in May, 1968; 1970"; the passage "Town; to be elected 20th January, 1968; 1970".

W. S. LONNIE,  
Clerk of the Council.

Local Government Act, 1960.

Shire of Dumbleyung.

ORDER IN COUNCIL.

L.G. 473/61.

WHEREAS it is enacted by section 433A of the Local Government Act, 1960, that the Governor may, *inter alia*, make and publish in the Gazette uniform general by-laws for all or any of the purposes for which by-laws may be made by a Council under Part XV of that Act, and, by order, declare that all or any such uniform general by-laws as are specified in the order shall apply to the whole or any portion of a district so specified; and whereas the Governor has so made and published the uniform general by-laws hereinafter in this Order appearing: now, therefore, His Excellency the Governor acting with the advice and consent of the Executive Council and in exercise of the powers aforesaid, doth hereby declare that the whole of each of the uniform by-laws published in the *Government Gazette* on the 15th October, 1965, and amendments thereto, published in the *Government Gazette* from time to time thereafter shall apply to the townsites of Dumbleyung and Kukerin within the Municipal district of the Shire of Dumbleyung.

W. S. LONNIE,  
Clerk of the Council.

Local Government Act, 1960.

Shire of Gingin.

Retirement of Members.

ORDER IN COUNCIL.

L.G. 523/66.

WHEREAS it is enacted, *inter alia*, by subsection (8) of section 41 of the Local Government Act, 1960, that when in a district the order of retirement of any member will not be in accordance with the provisions of that section, the Governor may, by order, declare the date on which that member shall retire, being a date in accordance with those provisions; and whereas the dates of retirement of one member of the Town Ward of the Municipality of the Shire of Gingin is not in accordance with the provisions of the said section 41; and whereas it is deemed proper to bring this retirement into conformity with the abovementioned section: now therefore, His Excellency the Governor, acting pursuant to the powers conferred by subsection (8) of section 41 of the Local Government Act, 1960, by and with the advice and consent of the Executive Council, doth hereby declare that the date of retirement of one member of the Town Ward of the Municipality of the Shire of Gingin shall be as follows:—

Ward; Councillor; Date of Retirement.  
Town; K. G. Parsons; 1969.

W. S. LONNIE,  
Clerk of the Council.

Premier's Department,  
Perth, 8th February, 1968.

IT is hereby notified for public information that His Excellency the Governor in Executive Council has been pleased to approve of the appointment of William Bennett Eva of Nalya, via Brookton, as a Justice of the Peace for the State of Western Australia; and has accepted the following resignations from the Commission of the Peace for the State of Western Australia:—

William Edward Hassett, of 503 Great Eastern Highway, Greenmount (formerly of Tom Price); Jack Robert Ness, of Albany Highway, Armadale (formerly of Kojonup); and

has removed the name of Alan Fortune, F.R.A.C.S., of Santa Monica, California, United States of America (formerly of Royal Perth Hospital, Perth, and 16 Lillian Street, Cottesloe), from the Commission of the Peace for the State of Western Australia.

EX OFFICIO JUSTICE OF THE PEACE.

IT is hereby notified for public information that Edwin Henry Hobbs of Brookton, President of the Brookton Shire Council, has been appointed under Section 9 of the Justices Act, 1902-1967, to be a Justice of the Peace for the Avon Magisterial District during his term of office as President of the Brookton Shire Council.

W. S. LONNIE,  
Under Secretary, Premier's Department.

LAND AGENTS ACT, 1921.

Application for License in the First Instance.

To the Court of Petty Sessions at Perth:

I, KEVIN JOSEPH MILNE, of 327 Salvado Road, Floreat Park, Estate Agent (Sub), having attained the age of twenty-one years, hereby apply on my behalf for a license to carry on the business of a land agent under the Land Agents Act, 1921 (As Amended) The principal place of business will be at 327 Salvado Road, Floreat Park.

Dated the 10th day of January, 1968.

K. J. MILNE,  
Signature of Applicant.

Appointment of Hearing.

I hereby appoint the 12th day of March, 1968, at 2.15 o'clock in the afternoon as the time for the hearing of the foregoing application at the Court of Petty Sessions at Perth.

Dated the 24th day of January, 1968.

J. GODFREY,  
Clerk of Petty Sessions.

Objection to the granting of the application may be served on the applicant and the Clerk of Petty Sessions at any time prior to seven days before the date appointed for the hearing.

LAND AGENTS ACT, 1921.

Application for Transfer of a License.

To the Court of Petty Sessions at Perth:

I, PHILIP JOHN MARLOW, of 19 Pangbourne Street, Wembley, hereby apply on behalf of a firm Carleton Estate Agency, the partners of which are Philip John Marlow and Samuel Arthur Carleton Moore for the license currently issued to Phillip John Marlow, on his own behalf trading as P. J. Marlow Ltd., to be transferred to me to carry on business as a Land Agent at 47 Lake Street, Perth.

Dated the 15th day of January, 1968.

P. J. MARLOW,  
Signature of Applicant (Transferee).

I, Philip John Marlow, concur in this application.  
P. J. MARLOW,  
Signature of Transferor.

## Appointment of Hearing.

I hereby appoint the 19th day of March, 1968, at 2.15 o'clock in the afternoon as the time for the hearing of the foregoing application at the Court of Petty Sessions at Perth.

Dated the 6th day of February, 1968.

J. GODFREY,  
Clerk of Petty Sessions.

Objection to the granting of the license may be served on the applicant and the Clerk of Petty Sessions at any time prior to seven days before the date appointed for the hearing.

## LAND AGENTS ACT, 1921.

## Application for License in the First Instance.

To the Court of Petty Sessions at Perth:  
I, KEVIN DOUGLAS GREEN, of 17 Elizabeth Street, Cottesloe, Real Estate Manager, having attained the age of 21 years, hereby apply on my behalf (on behalf of Kevin Green & Associates a firm of which I am a member) for a license to carry on the business of a land agent under the Land Agents Act, 1921. The principal place of business will be at Room 2, 40 Parliament Place, Perth.

Dated the 25th day of January, 1968.

K. D. GREEN,  
Signature of Applicant.

## Appointment of Hearing.

I hereby appoint the 12th day of March, 1968, at 2.15 o'clock in the afternoon as the time for the hearing of the foregoing application at the Court of Petty Sessions at Perth.

Dated the 5th day of February, 1968.

J. GODFREY,  
Clerk of Petty Sessions.

Objection to the granting of the application may be served on the applicant and the Clerk of Petty Sessions at any time prior to seven days before the date appointed for the hearing.

## LAND AGENTS ACT, 1921.

## Application for License in the First Instance.

To the Court of Petty Sessions at Perth:  
I, JOHN EDWARD GEORGE ASHBY of 437 Grand Promenade, Dianella, Real Estate Salesman, having attained the age of 21 years, hereby apply on my behalf for a license to carry on the business of a land agent under the Land Agents Act, 1921. The principal place of business will be at 437 Grand Promenade, Dianella.

Dated the 29th day of January, 1968.

J. E. G. ASHBY,  
Signature of Applicant.

## Appointment of Hearing.

I hereby appoint the 19th day of March, 1968, at 2.15 o'clock in the afternoon as the time for the hearing of the foregoing application at the Court of Petty Sessions at Perth.

Dated the 31st day of January, 1968.

J. GODFREY,  
Clerk of Petty Sessions.

Objection to the granting of the application may be served on the applicant and the Clerk of Petty Sessions at any time prior to seven days before the date appointed for the hearing.

## LAND AGENTS ACT, 1921.

## Application for License in the First Instance.

To the Court of Petty Sessions at Perth:  
I, ROBERT WILLIAM LEIGHTON, of 3 Elder Parade, Bassendean, Property Officer, having attained the age of twenty-one years, hereby apply on my behalf for a license to carry on the business of a land agent under the Land Agents Act, 1921. The principal place of business will be at 3 Elder Parade, Bassendean.

Dated the 29th day of January, 1968.

R. W. LEIGHTON,  
Signature of Applicant.

## Appointment of Hearing.

I hereby appoint the 19th day of March, 1968, at 2.15 o'clock in the afternoon as the time for the hearing of the foregoing application at the Court of Petty Sessions at Perth.

Dated the 31st day of January, 1968.

J. GODFREY,  
Clerk of Petty Sessions.

Objection to the granting of the application may be served on the applicant and the Clerk of Petty Sessions at any time prior to seven days before the date appointed for the hearing.

## LAND AGENTS ACT, 1921.

## Application for License in the First Instance.

To the Court of Petty Sessions at Perth:  
I, PHILLIPA ESME BIGGS, of 16 Betty Street, Claremont, accountant, having attained the age of 21 years, hereby apply on my behalf for a license to carry on the business of a land agent under the Land Agents Act, 1921. The principal place of business will be at 42 South Terrace, Fremantle.

Dated the 5th day of February, 1968.

P. E. BIGGS,  
Signature of Applicant.

## Appointment of Hearing.

I hereby appoint the 19th day of March, 1968, at 2.15 o'clock in the afternoon as the time for the hearing of the foregoing application at the Court of Petty Sessions at Perth.

Dated the 5th day of February, 1968.

J. GODFREY,  
Clerk of Petty Sessions.

Objection to the granting of the application may be served on the applicant and the Clerk of Petty Sessions at any time prior to seven days before the date appointed for the hearing.

Crown Law Department,  
Perth, 8th February, 1968.

C.L.D. 481/66.

HIS Excellency the Governor in Executive Council has appointed Keith Stuart Pamplin Graham of 18 Bardsden Street, Cottesloe, as a sworn Valuator under the Transfer of Land Act, 1893-1965.

W. J. ROBINSON,  
Under Secretary for Law.

## VACANCIES IN THE PUBLIC SERVICE

Department	Position	Class	Gross Salary	Date Returnable
Chief Secretary's	Clinical Psychologist, Grade 2, Prisons Department (Item 05/0030) (a) (d)	P-II-9/10	\$5,406-\$5,836	1968 16th February
Mines	Geochemist, Geological Survey Branch (Item 23/4822) (a) (e)	P-I-4	\$7,261	do.
Do.	Geologist, Grade 2, Geological Survey Branch (Item 23/4827) (a) (f)	P-II-2/8	\$3,546-\$5,262	do.
Do.	Geologist, Grade 2, Hydrology and Engineering Geology Division, Geological Survey Branch (Item 23/5225) (a) (g)	P-II-2/8	\$3,546-\$5,262	do.
Do.	Geologist, Grade 2, Mineral Resources Division, Geological Survey Branch (Item 23/5655) (a) (g)	P-II-2/8	\$3,546-\$5,262	do.
Do.	Senior Geologist, Sedimentary Oil Division, Geological Survey Branch (Item 23/5345) (a) (h)	P-I-1/3	\$6,400-\$6,964	do.
Metropolitan Water Supply Board	Clerk, Recovery Section, Accounting Division (Item 22/3150)	C-II-1	\$3,340-\$3,480	do.
Public Works	Clerk Typist, Albany Water Supply, District Offices, Accounting Division (Item 29/2225) (a)	C-V	\$2,030 (21 years)- \$2,350	do.
Education	Clerk, Records Section (Item 14/1560) ....	C-II-1	\$3,340-\$3,480	do.
Town Planning	Planning Assistant, Statutory Planning Section, Metropolitan Planning Branch (Item 33/0337) (i)	P-II-1/6	\$3,190-\$4,596	do.
Agriculture	Liaison Officer, Grade 3, Information Section (Item 01/0385) (a) (c)	P-II-3/8 or P-II-3/8 (F)	\$3,805-\$5,262 \$3,377-\$4,834	23rd February
Public Health	Microbiologist (Medical), Public Health Laboratories (Item 08/3138) (a) (j)	P-I-8	\$8,583	do.
State Housing Commission	Clerk, Land Section, Lands and Securities Branch (Item 32/2564)	C-II-1	\$3,340-\$3,480	do.
Labour	Clerk, Clerical Branch (Item 19/0100) ....	C-II-1	\$3,340-\$3,480	do.
Fisheries and Fauna	Research Officer, Fisheries Research Branch (Item 16/0478) (a) (k)	P-II-2/8	\$3,546-\$5,262	do.
Premier's	Clerk, Records Section, Accounts and Records Branch, Tourist Development Authority (Item 27/0590)	C-II-1	\$3,340-\$3,480	do.
Public Health	Librarian, Library and Technical Information Service (Item 08/0145) (a) (l)	P-II-2/3	\$2,999-\$3,377	do.
Public Works (2 positions)	Engineer, Grade 3, Architectural Division (Item Nos. to be determined) (a) (o)	P-II-3/8	\$3,675-\$5,262	do.
Agriculture	Senior Agricultural Photographer, Information Section (Item 01/0410) (p)	G-II-2/3	\$3,470-\$3,891	do.
Chief Secretary's	Clerk (Public Health Records), Records Branch (Item 03/0390)	C-II-1	\$3,340-\$3,480	do.
State Housing Commission	Supervisor, Grade 1, Supervision Section, Architectural Division (Item 32/6720) (m)	G-II-4	\$4,034-\$4,178	do.
Metropolitan Water Supply Board	Clerk, Seasonal Duties Staff, Accounting Division (Item 22/1185)	C-II-2	\$3,620-\$3,760	do.
Do. do. do.	Clerk-in-Charge, Correspondence Branch (Item 22/0130) (b)	C-II-5	\$4,540-\$4,700	do.
Do. do. do.	Clerk, Applications and Enquiries Section, Accounting Division (Item 22/2265)	C-II-1	\$3,340-\$3,480	do.
Do. do. do.	Clerk, Rating Section, Accounting Division (Item 22/1415)	C-II-1	\$3,340-\$3,480	do.
Do. do. do.	Clerk, Relieving Staff, Accounting Division (Item 22/1020) (n)	C-II-3	\$3,910-\$4,060	do.
Do. do. do.	Clerk, Applications and Enquiries Section, Accounting Division (Item 22/2255)	C-II-1	\$3,340-\$3,480	do.
Do. do. do.	Clerk, Relieving Staff, Accounting Division (Item 22/1010) (n)	C-II-3	\$3,910-\$4,060	do.
Do. do. do.	Clerk, Rating Section, Accounting Division (Item 22/1410)	C-II-1	\$3,340-\$3,480	do.
Public Works	Assistant Cashier (Receiving), Revenue Branch, Accounting Division (Item 29/1595)	C-II-2	\$3,620-\$3,760	do.
Treasury	Clerk, Expenditure Section, Accounts Branch (Item 34/0930)	C-II-1	\$3,340-\$3,480	do.

(a) Applications also called outside the Service under section 24.

(b) The possession of a Diploma in Public Administration, or approved equivalent, will be regarded as an important factor when judging efficiency under section 34 of the Public Service Act.

(c) Degree in Agricultural Science and an interest in journalism.

(d) University degree with major in Psychology, plus Diploma in Clinical Psychology or approved equivalent.

(e) University degree, preferably with Geology and Chemistry majors or a special course in Geochemistry, together with field experience in Geochemical techniques.

(f) University degree, preferably with honours in Micropalaeontology. Some relevant experience an advantage but not essential.

(g) University degree, preferably with honours in Geology. Some experience desirable but not essential.

(h) University degree, preferably with honours in Geology and at least 10 years' experience in Petroleum Geology desirable.

(i) Diploma in Cartography or qualifications equal to the Intermediate level of the Australian Planning Institute.

(j) Medical qualification registrable in Western Australia, wide experience of diagnostic, clinical and public health bacteriology and a higher qualification in medicine or microbiology is required.

VACANCIES IN THE PUBLIC SERVICE—*continued*

(k) Appropriate university degree. Research experience in marine ecology. Working knowledge of fisheries population methods. Knowledge of statistical methods for designing experiments.

(l) Registration Certificate of the Library Association of Australia.

(m) Applicants are required to be registered or entitled to be registered as builders under the Builders' Registration Act.

(n) Progress towards accountancy qualification will be regarded as an important factor when judging efficiency under section 34 of the Public Service Act.

(o) Corporate or graduate membership of the Institute of Engineers (Australia) or equivalent.

(p) Considerable experience in technical and general photography is required, and photographic qualifications and membership of the Institute of Australian Photographers would be an advantage.

Applications are called under section 34 of the Public Service Act, 1904-1967, and are to be addressed to the Public Service Commissioner and should be made on the prescribed form, obtainable from the offices of the various Permanent Heads of Departments.

R. H. DOIG,  
Public Service Commissioner.

9th February, 1968.

Public Service Commissioner's Office,  
Perth, 7th February, 1968.

THE following promotions have been approved:—

G. D. Clough, Architectural Draftsman, P-II-1/6, to be Architect, Grade 3, P-II-3/8, Architectural Division, Public Works Department, as from 22nd December, 1967.

D. D. Clarke, Structural Draftsman, P-II-1/6, to be Senior Engineering Draftsman, P-II-7/8, Architectural Division, Public Works Department, as from 26th January, 1968.

B. V. Johnson, Clerk, C-II-2, Expenditure Section, Accounting Division, Public Works Department, to be Clerk, C-II-2, North West Branch, Premier's Department, as from 12th January, 1968.

The following resignations have been accepted:—

Name; Department; Date.

- I. T. Beard; Public Works; 26/1/68.
- R. E. Hollingsworth; Crown Law; 19/1/68.
- M. P. Macorini; State Housing Commission; 8/3/68.
- I. S. Ferguson; Forests; 16/2/68.
- P. E. Stuart; Public Service Commissioner's Office; 8/3/68.
- D. Murtagh; Premier's; 1/2/68.
- M. A. Lewis; Lands and Surveys; 9/2/68.
- J. E. Karas; Crown Law; 2/2/68.

The following retirements have been approved:—

- D. E. Loukes; Child Welfare; 8/3/68.
- A. B. Ferrier; Metropolitan Water Supply Board; 1/3/68.

The following offices have been created:—

Items 22 0215 and 22 0225, Typist, C-V, Correspondence Branch, Metropolitan Water Supply Board.

Item 22 5605, Inspector, Plumbing Testing, G-II-4, Plumbing Inspection and Testing Section, Sewerage and Drainage Branch, Engineering Division, Metropolitan Water Supply Board.

Items 01 8605 and 01 8315, Laboratory Assistant G-VIII, Seed Certification and Weed Control Branch, Biological Services Division, Department of Agriculture.

Item 14 3535, General Assistant, G-VII-1, Secondary Teachers' College, Teachers' Colleges Branch, Education Department.

Item 10 1658, Inspection Officer, G-II-1/5(F), Field Division, Child Welfare Department.

Item 10 0695, Licensing Clerk, C-II-3, Welfare Branch, Child Welfare Department.

Item 14 3518, Clerk, C-IV, Secondary Teachers' College, Teachers' Colleges Branch, Education Department.

Item 14 3514, Registrar, C-II-3, Secondary Teachers' College, Teachers' Colleges Branch, Education Department.

Item 14 3525, Clerk Typist, C-V, Secondary Teachers' College, Teachers' Colleges Branch, Education Department.

Item 14 3530, Assistant, G-IX, Secondary Teachers' College, Teachers' Colleges Branch, Education Department.

Item 23 5485, Geologist, Grade 1, P-II-9/11, Regional Geology Division, Geological Survey Branch, Department of Mines.

Item 23 5355, Geologist, Grade 1, P-II-9/11, Sedimentary (Oil) Division, Geological Survey Branch, Department of Mines.

Item 23 4822, Technical Information Officer, P-II-9/11, Geological Survey Branch, Department of Mines.

Item 23 5183, Geologist, Grade 1, P-II-9/11, Hydrology and Engineering Geology Division, Geological Survey Branch, Department of Mines.

Item 01 2545, Bacteriologist, Grade 3, P-II-3/8 (F), Animal Health Laboratory, Animal Division, Department of Agriculture.

Item 01 9231, Clerk Typist, C-V, Kimberley Research Station, North West Division, Department of Agriculture.

The following offices have been abolished:—

Items 14 3900, 3925 and 3930, Clerk Typist, C-V, Perth Technical College, Technical Education Division, Education Department, as from 26th January, 1968.

Item 14 3035, Accounting Machinist, C-V, Machinists' Section, Accounts Branch, Education Department, as from 26th January, 1968.

Item 14 3775, Typist, C-V, Clerical Branch, Technical Education Division, Education Department, as from 26th January, 1968.

Item 14 3870, General Assistant, G-VII-1, Perth Technical College, Technical Education Division, Education Department, as from 26th January, 1968.

Item 01 2530, Veterinary Pathologist, Grade 3, P-II-4/9, Animal Health Laboratory, Animal Division, Department of Agriculture, as from 2nd February, 1968.

R. H. DOIG,  
Public Service Commissioner.

## APPOINTMENT.

(35th Victoria, No. 3.)

HIS Honour the Chief Justice has been pleased to appoint Jeremy Noel Knowles, of 152 Broome Street, Cottesloe, in the State of Western Australia, Solicitor, a Commissioner of the Supreme Court of Western Australia, to administer or take within the State of Western Australia, any oath, affidavit, affirmation, declaration, or acknowledgment by a married woman to be used in the Supreme Court of Western Australia. The Commission to remain in force until the said Jeremy Noel Knowles ceases to reside in the State of Western Australia, or until he ceases to be a Solicitor of the Supreme Court of Western Australia, or until he ceases to be entitled to practise as such, or until revoked.

D. H. MORRIS,  
Deputy Registrar Supreme Court.

Supreme Court Office,  
Perth, 6th February, 1968.

## APPOINTMENT.

(35th Victoria, No. 3.)

HIS Honour the Chief Justice has been pleased to appoint Kevin John Edwards, of 20 Overton Gardens, Cottesloe, in the State of Western Australia, Solicitor, a Commissioner of the Supreme Court of Western Australia, to administer or take within the State of Western Australia, any oath, affidavit, affirmation, declaration, or acknowledgment by a married woman to be used in the Supreme Court of Western Australia. The Commission to remain in force until the said Kevin John Edwards ceases to reside in the State of Western Australia, or until he ceases to be a Solicitor of the Supreme Court of Western Australia, or until he ceases to be entitled to practise as such, or until revoked.

D. H. MORRIS,  
Deputy Registrar Supreme Court.

Supreme Court Office,  
Perth, 6th February, 1968.

## APPOINTMENT.

(35th Victoria, No. 3.)

HIS Honour the Chief Justice has been pleased to appoint Donald Michael Watt, of 25 Dunbar Road, Claremont, in the State of Western Australia, Solicitor, a Commissioner of the Supreme Court of Western Australia, to administer or take within the State of Western Australia, any oath, affidavit, affirmation, declaration, or acknowledgment by a married woman to be used in the Supreme Court of Western Australia. The Commission to remain in force until the said Donald Michael Watt ceases to reside in the State of Western Australia, or until he ceases to be a Solicitor of the Supreme Court of Western Australia, or until he ceases to be entitled to practise as such, or until revoked.

D. H. MORRIS,  
Deputy Registrar Supreme Court.

Supreme Court Office,  
Perth, 6th February, 1968.

## HEALTH ACT, 1911-1966.

Department of Public Health,  
Perth, 5th February, 1968.

P.H.D. 1727/67.

THE appointment of Mr Roy Evan Blakemore, as Health Inspector to the Shire of Rockingham, is hereby approved.

W. S. DAVIDSON,  
Commissioner of Public Health.

## NATIVES (CITIZENSHIP RIGHTS) ACT, 1963.

Department of Native Welfare,  
Perth, 19th January, 1968.

THE undermentioned is hereby notified for general information:—

Certificates Issued during the Month of  
December, 1967.

Certificate No.; Name; Place; Date.

2837—Davey Dennis; Derby; 21/11/67.

2842—Fuller Vivienne Madge; (including children:  
Fuller, Fiona Rose; born 25/10/56, Fuller,  
Michele Ann; born 6/2/58, Fuller,  
Adrienne Faye; born 20/5/59, Fuller,  
Alison Gayle; born 28/4/60, Fuller Michael  
Thomson; born 14/9/63, Fuller, Luke  
Geoffrey; born 2/10/65).

2843—Taylor Christopher; Broome; 8/12/67.

249—Lyndon Joan; —; 12/11/46.

259—Fogarty Dawn Margaret; —; 5/11/46.

252—Mippy Janet Caroline; —; 13/12/67.

F. E. GARE,  
Commissioner of Native Welfare.

## FAUNA PROTECTION ACT, 1905-1954.

(Section 7.)

Fisheries and Fauna Department,  
1st February, 1968.

229/52.

IT is hereby notified for general information that the Minister for Fisheries and Fauna has appointed the following persons as Honorary Wardens of Fauna:—

684—McGrath, Michael Joseph Leo, Koordarrie Station, Onslow.

685—Haldane, Andrew Donald, Yanrey Station, Onslow.

686—Paterson, William Murray Pryde, Yarraloola Station, Onslow.

687—Shilling, David Alan Hardie, Camballin, Derby.

688—Summers, Norman Clare, "Green Grove", Dongara.

689—Walmsley, John Celsus, 43 Marine Terrace, Geraldton.

690—McLoughlin, John Raymond, 74 Sanford Street, Geraldton.

691—Burt, Vaughan Graeme Paull, Narracoota Station, Meekatharra.

692—Haythornthwaite, Vincent James, Box 99, Quairading.

693—Watts, Harry Hornby, R.M.B. 223, Kojonup.

694—Berger, Joffre Nicholas, 87 Clive Street, Katanning.

695—Simenson, Jos, 137 Vincent Street, North Perth.

696—Wright, Kenneth David, 354 Marmion Street, Cottesloe.

697—Milroy, Ian Ross, 59 Venn Street, Collie.

698—Spence, Tom, South Perth Zoological Gardens, Labouchere Road, South Perth.

B. K. BOWEN,  
Director.

## GOVERNMENT LAND SALES.

THE undermentioned allotments of land will be offered for sale by public auction on the dates and at the places specified hereunder, under the provisions of the Land Act, 1933-1965, and its regulations.

Lot; Area; Upset Price.

## HALLS CREEK.—

Lot 179; 1r. 7.1p.; \$60 (a).

Lot 180; 1r. 9.5p.; \$60 (a).

Lot 181; 1r. 4p.; \$60 (a).

Lot 182; 1r. 0.3p.; \$60 (a).

Lot 183; 1r.; \$60 (a).

Lot 184; 34.3p.; \$60 (a).

Lot 185; 1r.; \$60 (a).

Lot 186; 1r. 4.2p.; \$60 (a).

Lot 187; 1r.; \$60 (a).

Lot 188; 1r. 3p.; \$60 (a).

Lot 189; 1r. 2.5p.; \$60 (a).

Lot 190; 1r. 0.7p.; \$60 (a).

Lot 191; 38.2p.; \$60 (a).

Wednesday, 13th March, 1968, at the Court House, Halls Creek, at 3.30 p.m.

## WAGERUP.—

Lot 94; 4a. 3r. 17p.; \$150 (b) (c) (d).

Lot 95; 4a. 1r. 22p.; \$150 (b) (c) (d).

Lot 97; 3a. 3r. 7p.; \$150 (b) (c) (d).

Lot 99; 5a. 2r. 36p.; \$150 (b) (c) (d).

Wednesday, 28th February, 1968, at the Court House, Pinjarra, at 11 a.m.

## JARRAHDAL.—

- Lot 50; 1r.; \$100 (a) (c) (d).  
 Lot 68; 36.8p.; \$100 (a) (c) (d).  
 Lot 69; 36.8p.; \$100 (a) (c) (d).  
 Lot 70; 36.4p.; \$110 (a) (c) (d).

Wednesday, 28th February, 1968, at the Court House, Pinjarra, at 11 a.m.

## BODALLIN.—Lot 17; 39.1p.; \$60 (a) (c).

Wednesday, 28th February, 1968, at the Court House, Southern Cross, at 3 p.m.

- (a) Building—Residential only.  
 (b) Suburban conditions.  
 (c) Standard building conditions.  
 (d) Subject to the installation of a septic system.

All improvements on the land offered for sale are the property of the Crown and shall be paid for as the Minister may direct, whose valuation shall be final and binding on the purchaser.

A limit of one lot per person will apply and for the purpose of this condition, husband and wife are deemed to be one.

Plans and further particulars of this sale may be obtained from the Lands Department, Perth.

C. R. GIBSON,  
 Under Secretary for Lands.

## FORFEITURES.

THE following leases have been forfeited under the Land Act, 1933-1967, for reasons stated.

Dated this 9th day of February, 1968.

C. R. GIBSON,  
 Under Secretary for Lands.

- Name; Lease; District; Reason; Corres.; Plan.  
 Dimer, H. K., F. D., S. B. and B.; 393/464; Eucla; non-compliance with conditions; 1435/38; 17/300.  
 Dimer, H. K., F. D., S. B. and B.; 393/437; Eucla; non-compliance with conditions; 1206/07, V.2; 17/300.  
 Errington, G. F. and N. F.; 338/5746; Northcliffe Lot 130; non-compliance with conditions; 243/54; Townsite.  
 Fusco, A.; 347/12067; Avon Location 27872; non-compliance with conditions; 3494/56; 5/80 E.1.

## APPLICATIONS FOR LEASING.

Cervantes Lots 52, 53, 79, 85, 87, 89 and 95  
 "Residential Purposes Only".

Department of Lands and Surveys,  
 Perth, 9th February, 1968.

Corres. 3711/67.

APPLICATIONS are invited, under section 117 of the Land Act, 1933-1967, for the leasing of Cervantes Lots 52, 53, 79, 85, 87, 89 and 95 for "Residential Purposes Only" for a term of twenty-one (21) years at a rental of \$20 per annum each, subject to the following conditions:—

- (a) The lessee shall erect a residence and install a septic system on the demised land within two years from the date of approval of the application to standard acceptable to the Shire of Dandaragan. Failure to comply with this condition will render the lease forfeitable.  
 (b) Neither the Department of Lands and Surveys nor the Shire of Dandaragan accepts any responsibility for construction of roads in the townsite during the currency of the leases.

(c) The lessee shall not without the previous consent in writing of the Minister for Lands assign, transfer, mortgage, sublet or part with the possession of the demised land..

(d) Compensation will not be payable at the expiration or earlier determination of the lease for any improvements effected by the lessee, but the lessee shall have the right to remove any such improvements within three months of the said expiration or earlier determination of the lease.

Applications, accompanied by a deposit of \$12 for each lot must be lodged at the Department of Lands and Surveys, Perth, on or before Wednesday, 6th March, 1968.

Order of preference may be stated if desired.

In the event of more than one application being received for any one lot, the application to be granted will be determined by the Land Board.

(Plan Cervantes Townsite.)

C. R. GIBSON,  
 Under Secretary for Lands.

## APPLICATIONS FOR LEASING.

Light Industrial Sites—Rockingham Lots  
 1173 and 1175.

Department of Lands and Surveys,  
 Perth, 9th February, 1968.

Corres. 3862/65 and 3403/65.

APPLICATIONS are invited, under section 117 of the Land Act, 1933-1967, for the leasing of Rockingham Lots 1173 and 1175 for "Light Industrial Purposes" for a term of fifty (50) years at a rental of \$100 per annum each, subject to the following conditions:—

- (i) The annual rental shall be subject to re-appraisal at intervals of five (5) years.  
 (ii) The demised land shall be utilised for its specified purpose within six (6) months of the date of approval of the application.  
 (iii) All buildings shall be erected within twelve (12) months from the date of approval of the application, to the satisfaction of the Minister for Lands.  
 (iv) The lessee shall have the right within three months from the date of expiration or earlier determination of the lease to remove any improvements effected on the demised land. Compensation will not be payable for any improvements not so removed.  
 (v) At the date of expiration or earlier determination of the lease and following the removal of any improvements, the demised land shall be left in a clean and tidy condition to the satisfaction of the Minister for Lands.  
 (vi) All road frontages shall be developed in a manner satisfactory to the Shire of Rockingham.  
 (vii) The lease shall be forfeited if the lessee ceases to operate for any period in excess of three months.

Applications, accompanied by a deposit of \$52 for each lot, must be lodged at the Department of Lands and Surveys, Perth, on or before Wednesday, 6th March, 1968.

In the event of more than one application being received for any one block, the application to be granted shall be determined by the Land Board.

(Plan R.24-4.)

C. R. GIBSON,  
 Under Secretary for Lands.

**OPEN FOR SALE.**

Port Hedland Lot 947.

Department of Lands and Surveys,  
Perth, 9th February, 1968.

Corres. 64/67.

HIS Excellency the Governor in Executive Council has been pleased to approve under section 45A of the Land Act, 1933-1967, of Port Hedland Lot 947 being made available for sale in fee simple for a "Marine Store Yard" at the purchase price of \$180.

Applications accompanied by a deposit of \$18 must be lodged at the Department of Lands and Surveys, Perth, on or before Wednesday 6th March, 1968.

Balance of purchase money shall be paid within 12 months from the date of approval of the application by four quarterly instalments on the first days of January, April, July and October.

All applications lodged on or before that date will be treated as having been received on the closing date, and if there are more applications than one for the lot the application to be granted will be decided by the land board.

(Plan Port Hedland, Sheet 1.)

C. R. GIBSON,  
Under Secretary for Lands.**OPEN FOR SALE.**

Kalgoorlie Lot 3437.

Department of Lands and Surveys,  
Perth, 9th February, 1968.

Corres. 3866/67.

HIS Excellency the Governor in Executive Council has been pleased to approve under section 45A of the Land Act, 1933-1967, of Kalgoorlie Lot 3437 being made available for sale in fee simple for residential purposes at the purchase price of \$60.

Applications accompanied by a deposit of \$6 must be lodged at the Department of Lands and Surveys, Perth, on or before Wednesday, 6th March, 1968.

Balance of purchase money shall be paid within twelve months from the date of approval of the application by four quarterly instalments on the first days of January, April, July and October.

All applications lodged on or before that date will be treated as having been received on the closing date, and if there are more applications than one for the lot the application to be granted will be decided by the Land Board.

(Plan Kalgoorlie-Boulder, Sheet 1.)

C. R. GIBSON,  
Under Secretary for Lands.**OPEN FOR SALE.**

Carrabin Lot 59.

Department of Lands and Surveys,  
Perth, 9th February, 1968.

Corres. 3162/15.

HIS Excellency the Governor in Executive Council has been pleased to approve under section 45A of the Land Act, 1933-1967, of Carrabin Lot 59 being made available for sale in fee simple for a "Vehicle Parking Area" at the purchase price of \$60.

Applications accompanied by a deposit of \$6 must be lodged at the Department of Lands and Surveys, Perth, on or before Wednesday, 6th March, 1968.

Balance of purchase money shall be paid within twelve months from the date of approval of the application by four quarterly instalments on the first days of January, April, July and October.

All applications lodged on or before that date will be treated as having been received on the closing date, and if there are more applications than one for the lot the application to be granted will be decided by the Land Board.

(Plan Carrabin Townsite.)

C. R. GIBSON,  
Under Secretary for Lands.**OPEN FOR SALE.**

Bullfinch Lot 63.

Department of Lands and Surveys,  
Perth, 9th February, 1968.

Corres. 16371/10.

HIS Excellency the Governor in Executive Council has been pleased to approve under section 45A of the Land Act, 1933-1967, of Bullfinch Lot 63 being made available for sale in fee simple for residential purposes at the purchase price of \$60.

Applications accompanied by a deposit of \$6 must be lodged at the Department of Lands and Surveys, Perth, on or before Wednesday, 6th March, 1968.

Balance of purchase money shall be paid within twelve months from the date of approval of the application by four quarterly instalments on the first days of January, April, July and October.

All applications lodged on or before that date will be treated as having been received on the closing date, and if there are more applications than one for the lot the application to be granted will be decided by the Land Board.

(Plan Bullfinch Townsite.)

C. R. GIBSON,  
Under Secretary for Lands.**LAND OPEN FOR PASTORAL LEASING.**

Under Part VI Land Act, 1933-1967.

**OPEN WEDNESDAY, 13th MARCH, 1968.**

North-West Division—Lyndon District.

Corres. 4747/51.

IT is hereby notified for general information that the area of approximately 112,500 acres (excluding Reserve) as described in the schedule below will be available for leasing as from Wednesday, 13th March, 1968, subject to the condition that a Pastoral Lease of this land may only be granted to a lessee of land in the same locality.

Applications for this land may be lodged at the Department of Lands and Surveys, not later than Wednesday, 13th March, 1968, and must be accompanied by a deposit of \$58.50.

**Schedule.**

All that area of Crown Land bounded on the north by Pastoral Lease 3114/765, on the east by Pastoral Lease 3114/644, on the south by Pastoral Leases 3114/477 and 3114/605 and on the west by Exmouth Gulf. (Plan 95/300.)

C. R. GIBSON,  
Under Secretary for Lands.

Perth, 9th February, 1968.



**LAND OPEN FOR PASTORAL LEASING.**

Under Part VI Land Act, 1933-1967.

**OPEN WEDNESDAY, 13th MARCH, 1968.**

Eastern Division—Hampton and Edjudina Districts.

Corres. 3483/64.

IT is hereby notified for general information that the area of approximately 148,209 acres, as described in the schedule below will be available for leasing as from Wednesday, 13th March, 1968, subject to the condition that a Pastoral Lease of this land may only be granted to a lessee of land in the same locality.

Applications for this land may be lodged at the Department of Lands and Surveys, not later than Wednesday, 13th March, 1968, and must be accompanied by a deposit of \$39.25.

**Schedule.**

All that area of Crown Land (formerly known as "Innaminka Station") bounded on the north by Pastoral Leases 3114/741 and 3114/742, on the west by Pastoral Lease 3114/742, on the south by Pastoral Lease 3114/591 and on the east by Pastoral Lease 3114/409 and Reserve 17454. (Plans 73/80 and 34/300.)

C. R. GIBSON,  
Under Secretary for Lands.

Perth, 9th February, 1968.

**Western Australia.****LICENSED SURVEYORS ACT, 1909-1958.**

Land Surveyors' Licensing Board.

IT is hereby notified for general information that the undermentioned gentlemen have been registered as Licensed Surveyors, under the provisions of the above Act, on the date specified:—

No. 420—Scott, Peter, c/o Mr W. G. Brittain, 73 Palmerston Street, Mosman Park, Western Australia (6012), 24th January, 1968.

No. 421—Wright, Anthony Richard, c/o Messrs Murray & Johnson, 46 Ventnor Avenue, West Perth, Western Australia (6005), 24th January, 1968.

S. J. STOKES,  
Secretary,  
Land Surveyors' Licensing Board.

**TRANSFER OF LAND ACT, 1893 (AS AMENDED).**

Application 90843/66.

TAKE notice that Vincenzo Racco, of Hamel, Farmer, has made application to be registered under the Transfer of Land Act, 1893 as amended as the proprietor of an estate in fee simple in possession in the following parcel of land situate in the Murray District and being:—

Portion of Murray Location 26 containing 32 acres and 31 perches. Bounded on the north west by south eastern boundaries of the land comprised in Plan 4820 measuring 9 chains 23.5 links, 17 chains 71.5 links, 5 chains 74.2 links, 9 chains 52 links, on the east by the western boundary of Lot 3 of Murray Location 26 on Diagram 6638 measuring 15 chains 19 links, and on the south by part of the northern boundary of James Road, the northern boundaries of Lots 4 and 5 of Hamel Agricultural Area Lots 10 and 166 on Diagram 14410 and part of the northern boundary of vacant Crown Land measuring 39 chains 35.5 links.

And further take notice that all persons other than the applicant claiming to have any estate right title or interest in the above parcel of land and desiring to object to the said application are hereby required to lodge in this Office on or before

the 11th day of March next a Caveat forbidding the said land being brought under the operation of the said Act.

H. BLACKMORE,  
Registrar of Titles.

(Office of Titles, Perth, this 9th day of February, 1968. Ball & Co., Solicitors, Harvey, Solicitors for the Applicant.)

**BUSH FIRES ACT, 1954-1965.**  
(Section 38.)

Appointment of Bush Fire Control Officers.

Bush Fires Board,  
West Perth, 9th February, 1968.

IT is hereby notified that the following Shire Councils have appointed the following persons as bush fire control officers for their respective Shires:—

Canning: R. Congdon.  
Cranbrook: F. Neil, G. Ostram and M. Milne.  
Denmark: B. A. Pascoe.  
Dumbleyung: K. F. D. James.

The following appointments have been cancelled:—

Canning: J. N. Lucas.  
Cockburn: V. G. King.  
Cranbrook: R. Denney and T. Marshall.  
Denmark: P. F. Whittaker.  
Dumbleyung: G. Ladyman.  
Lake Grace: W. Colquhoun.

A. SUTHERLAND,  
Secretary, Bush Fires Board.

**PUBLIC WORKS ACT, 1902-1967.**

Sale of Land.

P.W. 762/65; Ex. Co. No. 198.

NOTICE is hereby given that His Excellency the Governor has authorised under section 29 (7) of the Public Works Act, 1902-1967, the sale by Public Auction or Private Contract of the land herein-after described such land being no longer required for the purpose for which it is held.

Land.

Portion of Swan Location 28 and being that portion of Lot 105 on Plan 1792 as is contained in diagram 35550 and being part of the land comprised in Certificate of Title Volume 1308, folio 28.

Dated this 7th day of February, 1968.

J. McCONNELL,  
Under Secretary for Works.

**PUBLIC WORKS DEPARTMENT.**

Tenders, closing at Perth at 2.30 p.m. on the dates mentioned hereunder, are invited for the following works.

Tenders are to be addressed to "The Hon. Minister for Works, c/o Contract Office, Public Works Department, corner King's Park Road and Havelock Street, West Perth," and are to be endorsed "Tender."

The highest, lowest, or any tender will not necessarily be accepted.

Contract No.	Project	Closing Date	Conditions now Available at
16649	Ghooli Pumping Station—Supply and Installation of Pumping Plant	1968 Feb. 27	P.W.D., Perth
16659	Bull Creek Migrants' Hostel—Vinyl Floor Tiles	Feb. 13	P.W.D., Perth
16675	Perth Medical Centre—Long Term Treatment Unit—Central Vacuum Cleaning Service	Feb. 20	P.W.D., Perth

Contract No.	Project	Closing Date	Conditions now Available at	Contract No.	Project	Closing Date	Conditions now Available at
16676	Derby Leprosarium—Remodelling	1968 Feb. 20	P.W.D., Perth P.W.D., Derby	16691	Perth—Treasury Building Sub-Station—New Main Switchboard	1968 Feb. 27	P.W.D., Perth
16677	Mukinbudin—40,000 gallon Tank on 50 ft Stand	Feb. 13	P.W.D., Perth P.W.D., Merredin Police Station, Mukinbudin	16692	Bentley—W.A. Institute of Technology—Department of Architecture—One Passenger Lift	Feb. 27	P.W.D., Perth
16678	Perth Medical Centre—Long Term Treatment Unit—Mechanical Services	Feb. 22 (at Tender Board)	P.W.D., Perth	16693	Meekatharra New School—Erection	Feb. 27	P.W.D., Perth P.W.D., Geraldton Police Station, Meekatharra
16679	Jurien Bay Water Supply—2/50,000 gallon R.C. Circular Roofed Tanks	Feb. 20	P.W.D., Perth	16694	Northam Regional Hospital—Lift Installation	Mar. 5	P.W.D., Perth P.W.D., Northam
16680	Quinns Rocks Water Supply—2/50,000 gallon R.C. Circular Roofed Tanks	Feb. 20	P.W.D., Perth	16695	Beaconsfield School—New Toilet Block and Retaining Wall	Feb. 20	P.W.D., Perth
16681	Cunderdin Hospital—Nurses' Quarters—Repairs and Renovations	Feb. 13	P.W.D., Perth P.W.D., Northam Police Station, Cunderdin	16696	Hollywood Medical Centre—Long Term Treatment Unit Oxygen Service	Feb. 27	P.W.D., Perth
16682	Collie Pumping Station—Erection, 1968	Feb. 20	P.W.D., Perth P.W.D., Bunbury P.W.W.S., Collie	16697	Hollywood Medical Centre—Long Term Treatment Unit Lift Installation	Mar. 5	P.W.D., Perth
16683	Pardelup Prison Farm—New Kitchen and Dining Facilities	Feb. 20	P.W.D., Perth P.W.D., Albany Police Station, Mt Barker	16698	Southern Cross Hospital—Mechanical Services	Feb. 29	P.W.D., Perth P.W.D., A.D., Merredin P.W.D., A.D., Kalgoorlie
16684	Wooroloo School—Repairs and Renovations	Feb. 20	P.W.D., Perth P.W.D., A.D., Northam	16703	Manjimup—Warren District Hospital Servery—New Hood	Mar. 5	P.W.D., Perth P.W.D., Bunbury Police Station, Manjimup
16685	Pardelup Prison Farm—New Kitchen and Dining Facilities—Electrical Installation	Feb. 20	P.W.D., Perth P.W.D., Albany	16704	Southern Cross New Hospital—Supply, Delivery and Installation of Aluminium Windows, Door Frames and Fascias	Mar. 5	P.W.D., Perth P.W.D., Merredin P.W.D., Kalgoorlie
16686	Badgingarra Primary School—Erection	Feb. 20	P.W.D., Perth P.W.D., Geraldton Clerk of Courts, Moora	16705	Kellerberrin Hospital—Repairs and Renovations and Renewal of Water Service	Mar. 5	P.W.D., Perth P.W.D., Merredin Police Station, Kellerberrin
16687	Coolgardie Public Buildings—Repairs and Renovations	Feb. 20	P.W.D., Perth P.W.D., Kalgoorlie Police Station, Coolgardie	16706	Rockingham Police Station and Court House—Additions—Aluminium Door and Windows	Mar. 5	P.W.D., Perth Police Station, Rockingham
16688	Mount Henry Women's Home—New Swill Storage Room	Feb. 20	P.W.D., Perth	16707	Rural & Industries Bank of W.A., Jerramungup Branch—Erection	Mar. 5	P.W.D., Perth P.W.D., Albany
16689	Narrogin High School—Farm Wing—Repairs and Renovations to Quarters	Feb. 20	P.W.D., Perth P.W.D., Narrogin				
16690	Bentley—W.A. Institute of Technology—High Tension Reticulation Electrical	Feb. 27	P.W.D., Perth				

\* Tenders close at W.A. Government Tender Board, 74 Murray Street, Perth.

† Deposit of \$20 is required on documents.

By order of the Hon. Minister for Works,

J. McCONNELL,  
Under Secretary for Works.

### PUBLIC WORKS DEPARTMENT

#### Acceptance of Tenders

Contract No.	Particulars	Contractor	Amount
16641	Perth—R. & I. Bank—Repairs and Renovations	L. E. Lo Manto	\$ 9,400
P.A.	Narrogin High School—Additions, 1967	S. W. Hawkes & Son	50,282
16651	Coolgardie School—Repairs and Renovations	C. Wallace	3,760
16635	New Norcia Police Station and Quarters—Repairs and Renovations	J. H. & C. J. Acreman	2,775
16637	Bullfinch School—Repairs and Renovations	J. Cox	6,860
16636	Bindoon School—Repairs and Renovations	Lakeway Painters & Moretta	3,500
16701	Wyalkatchem School—Composite Science Laboratory—Additions	Cooper & Oxley	23,485
16662	Cue Police Station and Quarters—New Cell Block	S. M. Wojcik	37,560
P.A.	Mt Lawley Technical School—Major Additions, 1967-68—Mechanical Services	J. & E. Ledger Sales Pty Ltd	31,109
16702	Yorkrakine School—Additions	Cooper & Oxley	15,270
16699	Dumbleyung School—Additions, 1967-68	Verhagen & Son	58,306
16700	Toodyay School—Additions, 1967-68	R. E. Turner & Co.	31,890
16665	Kambalda Primary School—Erection	Consolidated Constructions Pty	53,703
16548	Derby Hospital—Mechanical Services (Sub-contract)	L. N. Matthews	26,850
16629	Katanning Court House—Additions for Water Supply Offices	S. Stoicos	16,306
16654	Beverly Court House—New Toilet Block and Repairs and Renovations	R. Treijs	16,654
16606	Royal Perth Hospital—Main Building—External Painting	Perrott & Son Pty Ltd	14,600
16666	Derby Native Reserve Nos. 5982 and 13980—New Water Service	G. W. Spinks	6,860

L.R.O. 863/67; Ex. Co. No. 286

*Local Government Act, 1960-1966; Public Works Act, 1902-1967*

## LAND ACQUISITION

*Shire of Bayswater Town Planning Scheme No. 8—Weld Square*

NOTICE is hereby given, and it is hereby declared, that the several pieces or parcels of land described in the Schedule hereto—being all in the Swan District—have, in pursuance of the written consent under section 13 (b) of the Town Planning and Development Act, 1928-1965, and the approval under section 17 of the Public Works Act, 1902-1967 of His Excellency the Governor, acting by and with the advice of the Executive Council, dated the 7th day of February, 1968, been compulsorily taken and set apart for the purposes of the following work, namely:—Shire of Bayswater Town Planning Scheme No. 8 Weld Square (Stage 1).

And further notice is hereby given that the said pieces or parcels of land so taken and set apart are shown marked off on Plan, P.W.D., W.A. 44548, which may be inspected at the Office of the Minister for Works, Perth.

And it is hereby directed that the said lands shall vest in Shire of Bayswater for an estate in fee simple in possession for the purpose herein expressed, freed and discharged from all trusts, mortgages, charges, obligations, estates, interests, rights-of-way, or other easements whatsoever.

## SCHEDULE

No. on Plan P.W.D., W.A. No. 44548	Owner or Reputed Owner	Description	Area		
			a.	r.	p.
1	Woodfields Pty. Ltd. ....	Portion of Swan Location 1178 and being Lots 70, 71 and 72 on Plan 1656 (Certificate of Title Volume 963, Folio 76)	3	1	7.3
2	Kent Investments Pty. Ltd. ....	Portion of Swan Location 1178 and being Lot 69 on Plan 1656 (Certificate of Title Volume 1216, Folio 990)	1	1	6.9
3	Aloysius Johannes Martinus Elberink, Theissen Theodora Maria Elberink	Portion of Swan Location 1178 and being part Lot 68 on Plan 1656 (Certificate of Title Volume 1221, Folio 116) (as is now contained in Plan 8953)	0	3	4.2
4	The Roman Catholic Bishop of Perth	Portion of Swan Location 1178 and being Lot 67 on Plan 1656 (Certificate of Title Volume 248, Folio 158)	1	0	0.2
5	Stanley Kopinski ....	Portion of Swan Location 1178 and being Lot 58 on Plan 1656 (Certificate of Title Volume 1169, Folio 783)	1	0	0.1
6	Woodfields Pty. Ltd. ....	Portion of Swan Location 1178 and being Lot 57 on Plan 1656 (Certificate of Title Volume 1186, Folio 415)	1	0	0.1
7	Maxwell Leonard Doust ....	Portion of Swan Location 1178 and being Lot 56 on Plan 1656 (Certificate of Title Volume 1143, Folio 150)	1	0	0.1
8	Michael Constantine ....	Portion of Swan Location 1178 and being part Lot 55 on Plan 1656 (Certificate of Title Volume 1205, Folio 747) (as is now contained in Plan 8953)	0	3	2.3
9	James Lindsay Cox ....	Portion of Swan Location 1178 and being Lot 54 on Plan 1656 (Certificate of Title Volume 1152, Folio 855)	1	0	0.2
10	Barbara Jean Van Onselen, Victor Harry Johnsen, Roma May Soutar, Harold Gifford Seymour	Portion of Swan Location 1178 and being Lot 53 on Plan 1656 (Certificate of Title Volume 1230, Folio 272)	1	0	0.1
11	George Rudolf Friedrich Muller, Ethel Elizabeth Muller	Portion of Swan Location 1178 and being part Lot 52 on Plan 1656 (Certificate of Title Volume 1295, Folio 128) (as is now contained in Plan 8953)	0	2	24.8
12	Gifford Holdings Pty. Ltd., Sutherland Holdings Pty. Ltd., Reginald Charles Whitcombe	Portion of Swan Location 1178 and being part Lot 51 on Plan 1656 (Certificate of Title Volume 1295, Folio 476) (as is now contained in Plan 8953)	0	3	24.2
13	Cesare Paine ....	Portion of Swan Location 1178 and being Lot 35 on Diagram 29909 (Certificate of Title Volume 1134, Folio 102)	0	1	23
14	Jacqueline Beverly Greave ....	Portion of Swan Location 1178 and being Lot 29 on Diagram 29909 (Certificate of Title Volume 1281, Folio 728)	0	0	32.4
15	Cesare Paine ....	Portion of Swan Location 1178 and being Lot 30 on Diagram 29909 (Certificate of Title Volume 1134, Folio 102)	0	0	30.6
16	William Edward Morley ....	Portion of Swan Location 1178 and being Lots 31 and 32 on Diagram 29902 (Certificate of Title Volume 1290, Folio 680)	0	1	18.8
17	Elizabeth Maureen Wilson ....	Portion of Swan Location 1178 and being Lots 6 and 7 on Diagram 27913 (Certificate of Title Volume 1301, Folio 544)	0	1	16.9
18	Robert Walker Kerr ....	Portion of Swan Location 1178 and being Lot 8 on Diagram 27913 (Certificate of Title Volume 35, Folio 337A)	0	0	28.8
19	Campton De Barros ....	Portion of Swan Location 1178 and being Lot 9 on Diagram 27913 (Certificate of Title Volume 1286, Folio 755)	0	0	28.8
20	Edith Selina Knowles ....	Portion of Swan Location 1178 and being Lot 10 on Diagram 27913 (Certificate of Title Volume 1286, Folio 756)	0	0	28.1
21	Frank Leon Swider, Eugenie Swider	Portion of Swan Location 1178 and being Lot 41 on Plan 1656 (Certificate of Title Volume 1184, Folio 432)	1	0	0.1
22	Gertrude Josephine Esze, Henry Gabor	Portion of Swan Location 1178 and being part Lot 42 on Plan 1656 (Certificate of Title Volume 1171, Folio 44) (as is now contained in Plan 8953)	0	3	2.8
23	Edna Williams, Daphne Mavis Holten	Portion of Swan Location 1178 and being Lots 43 and 44 on Plan 1656 (Certificate of Title Volume 1120, Folio 905)	2	0	0.2
24	James Lindsay Cox ....	Portion of Swan Location 1178 and being Lot 45 on Plan 1656 (Certificate of Title Volume 1152, Folio 854)	1	0	0.1
25	William Wolfegang ....	Portion of Swan Location 1178 and being Lot 46 on Plan 1656 (Certificate of Title Volume 193, Folio 6)	1	0	0.1
26	Edward Frank Reid ....	Portion of Swan Location 1178 and being Lot 17 on Diagram 30889 (Certificate of Title Volume 1295, Folio 133)	0	0	36
27	Alexander Podmore, Lorraine Eliza- beth Podmore	Portion of Swan Location 1178 and being Lot 18 on Diagram 30889 (Certificate of Title Volume 1295, Folio 135)	0	0	36
28	Michael John Jones ....	Portion of Swan Location 1178 and being Lot 19 on Diagram 30889 (Certificate of Title Volume 1295, Folio 132)	0	0	36
29	Arthur Allan Paul ....	Portion of Swan Location 1178 and being Lot 20 on Diagram 30889 (Certificate of Title Volume 1295, Folio 134)	0	0	36
30	Daisy Irene Manton ....	Portion of Swan Location 1178 and being Lot 25 on Diagram 30889 (Certificate of Title Volume 1295, Folio 129)	0	0	36

## SCHEDULE—continued

No. on Plan P.W.D., W.A. No. 44548	Owner or Reputed Owner	Description	Area
			a. r. p.
31	Ida Winifred Muller, Ruth Millard ....	Portion of Swan Location 1178 and being Lot 26 on Diagram 29920 (Certificate of Title Volume 1283, Folio 919)	0 0 36
32	Ida Winifred Muller, Ruth Millard ....	Portion of Swan Location 1178 and being Lot 27 on Diagram 29920 (Certificate of Title Volume 1283, Folio 920)	0 0 36
33	Victor Harry Johnsen, Alfred Bobs Humphreys, Amy Roma Humphreys, Harold Gifford Seymour, Norman James Edward Soutar, Barbara Kathleen Gooch	Portion of Swan Location 1178 and being the right of way coloured brown on Diagram 28587 (Certificate of Title Volume 1271, Folio 985)	0 0 21.4
34	James Alexander Durward, Moira Elizabeth Durward	Portion of Swan Location 1178 and being Lot 28 on Diagram 29920 (Certificate of Title Volume 1283, Folio 921)	0 0 36
35	Rexso Tiszavolgyi, Etel Tiszavolgyi...	Portion of Swan Location 1178 and being Lot 7 on Plan 1875 (Certificate of Title Volume 1184, Folio 410)	1 0 0.2
36	Bela Meszaros, Maria Meszaros ....	Portion of Swan Location 1178 and being Lot 6 and part Lot 5 on Plan 1875 (Certificate of Title Volume 1183, Folio 410) (as is now contained in Plan 8953)	1 3 5.9
37	Henri Lucien Pognault, Pamela Lorraine Pognault	Portion of Swan Location 1178 and being Lot 103 on Diagram 27468 (Certificate of Title Volume 1306, Folio 516)	0 0 39.1
38	Leon Arie Muhlmann, Berthe Muhlmann	Portion of Swan Location 1178 and being Lot 102 on Diagram 27468 (Certificate of Title Volume 1274, Folio 563)	0 1 0
39	Ronald James Marrs, Mervyn Stanley Marrs	Portion of Swan Location 1178 and being part Lot 101 on Diagram 27468 (Certificate of Title Volume 1271, Folio 171) (as is now contained in Plan 8953)	0 0 8
40	Raymond Domenic Fragomeni ....	Portion of Swan Location 1178 and being part Lot 100 on Diagram 27468 (Certificate of Title Volume 1301, Folio 466) (as is now contained in Plan 8953)	0 0 8
41	Joseph Symonds ....	Portion of Swan Location 1178 and being Lots 1 and 2 on Plan 1875 (Certificate of Title Volume 959, Folio 152)	2 1 0.1
42	Ross Henry Gray, Henry Gray ....	Portion of Swan Location 1178 and being part Lot 10 on Diagram 27399 (Certificate of Title Volume 1257, Folio 112) (as is now contained in Plan 8953)	0 0 0.8
43	Leonardus Rutgrink ....	Portion of Swan Location 1178 and being part Lot 16 on Diagram 30628 (Certificate of Title Volume 1291, Folio 271) (as is now contained in Plan 8953)	0 0 12.5
44	Desmond Patrick Delgado ....	Portion of Swan Location 1178 and being Lot 33 on Plan 1875 (Certificate of Title Volume 1174, Folio 325)	1 1 6.9
45	Kelvin Francis Dillon, Bernice Sylvia Dillon	Portion of Swan Location 1178 and being Lot 34 on Plan 1875 (Certificate of Title Volume 1220, Folio 593)	1 0 0.2
46	John Ross Elsbury, Valerie Francis Elsbury	Portion of Swan Location 1178 and being Lot 2 on Diagram 33653 (Certificate of Title Volume 1152, Folio 859)	0 2 18.1
47	Edward James O'Rourke ....	Portion of Swan Location 1178 and being Lot 37 on Plan 1875 (Certificate of Title Volume 1205, Folio 315)	1 0 0.1
48	Alfred Als, Olga Hildebrands ....	Portion of Swan Location 1178 and being part Lot 38 on Plan 1875 (Certificate of Title Volume 1185, Folio 977) (as is now contained in Plan 8953)	0 3 8.1
49	Stanley Baldwin ....	Portion of Swan Location 1178 and being Lot 39 on Plan 7282 (Certificate of Title Volume 1301, Folio 138)	1 0 0.1
50	Eugene Vadasz ....	Portion of Swan Location 1178 and being Lots 40 and 45 on Plan 1875 (Certificate of Title Volume 1141, Folio 344)	2 0 0.4
51	Vilmos Laczó ....	Portion of Swan Location 1178 and being part Lot 41 on Plan 1875 (Certificate of Title Volume 1176, Folio 902) (as is now contained in Plan 8953)	0 3 4.8
52	Lyll Mansfield Bonser ....	Portion of Swan Location 1178 and being Lot 42 on Plan 1875 (Certificate of Title Volume 1145, Folio 271)	1 0 0.1
53	Hryhor Omeltshenko ....	Portion of Swan Location 1178 and being Lot 44 on Plan 1875 (Certificate of Title Volume 1176, Folio 901)	1 0 0.1
54	James Joseph Devereaux, Winifred Margaret Devereaux	Portion of Swan Location 1178 and being Lot 46 on Plan 1875 (Certificate of Title Volume 1193, Folio 214)	1 0 0.1
55	William Frederick Mumford-Huggins, Betty Valma Mumford-Huggins	Portion of Swan Location 1178 and being part Lot 47 on Plan 1875 (Certificate of Title Volume 1197, Folio 190) (as is now contained in Plan 8953)	0 2 16.1
56	Mavis Norris ....	Portion of Swan Location 1178 and being Lot 48 on Plan 1875 (Certificate of Title Volume 1272, Folio 951)	1 0 0.1
57	Alan John Murray ....	Portion of Swan Location 1178 and being part Lot 49 on Plan 1875 (Certificate of Title Volume 1202, Folio 214) (as is now contained in Plan 8953)	0 3 8.1
58	Francis Burke, Norma Josephine Burke	Portion of Swan Location 1178 and being part Lot 50 on Plan 7282 (Certificate of Title Volume 3, Folio 353A) (as is now contained in Plan 8953)	0 3 8.1
59	Wladimir Chrulew ....	Portion of Swan Location 1178 and being Lot 51 on Plan 1875 (Certificate of Title Volume 1183, Folio 407)	1 0 0.2
60	Bela Meszaros, Maria Meszaros ....	Portion of Swan Location 1178 and being Lot 32 on Plan 1875 (Certificate of Title Volume 1185, Folio 985)	1 1 6.9
61	Roydon Charles Hull, Margaret Elizabeth Hull	Portion of Swan Location 1178 and being Lots 58, 59 and 60 on Plan 1875 (Certificate of Title Volume 1116, Folio 740)	3 0 0.1
62	Marjorie Frances Gunzburg, Leslie Gunzburg, Leonard Joseph O'Hara, Morris Crawcour, Beryl Frances Langsford, Clare Millicent Dall, Mabel Deborah Dall, Ellen Louisa Michelides	Portion of Swan Location 1178 and being portion of the land shown coloured brown on Plan 1656 (Certificates of Title Volume 1054, Folio 657 and Volume 1165, Folio 507) (as is now contained in Plan 8953)	3 0 25.5

Certified correct this 24th day of January, 1968.

ROSS HUTCHINSON,  
Minister for Works.

DOUGLAS KENDREW,  
Governor in Executive Council.

Dated this 7th day of February, 1968.

L.R.O. 776/67; Ex. Co. No. 284

*Local Government Act, 1960-1966; Public Works Act, 1902-1967*

## LAND ACQUISITION

*Shire of Bassendean Town Planning Scheme No. 1—South of Walter Road Scheme*

NOTICE is hereby given, and it is hereby declared, that the several pieces or parcels of land described in the Schedule hereto—being all in the Swan Location—have, in pursuance of the written consent under section 13 (b) of the Town Planning and Development Act, 1928-1965, and the approval under the Public Works Act, 1902-1967, of His Excellency the Governor, acting by and with the advice of the Executive Council, dated the 7th day of February, 1968, been compulsorily taken and set apart for the purposes of the following work, namely :—Shire of Bassendean Town Planning Scheme No. 1—South of Walter Road Scheme.

And further notice is hereby given that the said pieces or parcels of land so taken and set apart are shown marked off on Plan P.W.D., W.A. 44576, which may be inspected at the Office of the Minister for Works, Perth.

And it is hereby directed that the said lands shall vest in Shire of Bassendean for an estate in fee simple in possession for the purpose herein expressed, freed and discharged from all trusts, mortgages, charges, obligations, estates, interests, rights-of-way, or other easements whatsoever.

## SCHEDULE

No. on Plan P.W.D., W.A. No. 44576	Owner or Reputed Owner	Description	Area
			a. r. p.
1	Arthur McGrath, Joan Patricia McGrath	Portion of Swan Location Q1 and being Lot 698 on Plan 2934 (Certificate of Title Volume 1085, Folio 661)	1 0 0
2	Rocco Capitano	Portion of Swan Location 4615 (as is now contained in Plan 8692) (Certificate of Title Volume 1104, Folio 538)	0 3 9.4
3	Peter Gordon Smedley, Dorothy Hilda Smedley	Portion of Swan Location 4760 and being part Lot 11 on Diagram 17519 (as is now contained in Plan 8692) (Certificate of Title Volume 1261, Folio 979)	0 1 8
4	Arthur McGrath, Joan Patricia McGrath	Portion of Swan Location 4760 and being part Lot 12 on Diagram 17519 (as is now contained in Plan 8692) (Certificate of Title Volume 1184, Folio 514)	0 1 0
5	Joseph Iwaniski, Mary Kathleen Iwaniski	Portion of Swan Location 4760 and being part Lot 13 on Diagram 17519 (as is now contained in Plan 8692) (Certificate of Title Volume 1235, Folio 502)	0 1 0
6	Lancelot Norman McLaughlin, Beryl Regina McLaughlin	Portion of Swan Location 4760 and being part Lot 14 on Diagram 17519 (as is now contained in Plan 8692) (Certificate of Title Volume 1190, Folio 923)	0 1 4
7	William Francis Davey, Muriel Ellen Warne	Portion of Swan Location 4760 and being Lot 15 on Diagram 17519 (Certificate of Title Volume 1202, Folio 54)	0 2 0
8	Jack Henry Scudds	Portion of Swan Location 4760 and being part Lot 16 on Diagram 17519 (as is now contained in Plan 8692) (Certificate of Title Volume 1180, Folio 502)	0 1 0
9	Dmytro Bajgerytsch, Anastasia Bajgerytsch	Portion of Swan Location Q1 and being part Lot 21 on Diagram 19297 (as is now contained in Plan 8692) (Certificate of Title Volume 1180, Folio 755)	0 1 0
10	James Lynn	Portion of Swan Location Q1 and being part Lot 22 on Diagram 19297 (as is now contained in Plan 8692) (Certificate of Title Volume 1255, Folio 186)	0 1 4
11 and 12	Alice Hall	Portion of Swan Location Q1 and being Lots 691 and 692 on Plan 2934 (as is now contained in Plan 8692) (Certificate of Title Volume 646, Folio 85)	1 3 0.4
13	Walter James Poulter	Portion of Swan Location Q1 and being part Lot 620 on Plan 2934 (as is now contained in Plan 8692) (Certificate of Title Volume 1103, Folio 557)	0 2 29.8
14	Jean Casson	Portion of Swan Location Q1 and being part Lot 17 on Diagram 17720 (as is now contained in Plan 8692) (Certificate of Title Volume 1174, Folio 125)	0 0 38.2
15	Bernard Ross	Portion of Swan Location Q1 and being Lot 18 on Diagram 17720 (Certificate of Title Volume 1174, Folio 124)	0 1 30.2
16	Bernard Ross	Portion of Swan Location Q1 and being Lot 622 on Plan 2934 (Certificate of Title Volume 1147, Folio 802)	0 3 20.5
17	George Arthur Buck	Portion of Swan Location Q1 and being Lot 683 on Plan 2934 (Certificate of Title Volume 548, Folio 22)	1 0 0
18	David Nicholas Grosser, Carrington Stephen Fleming	Portion of Swan Location Q1 and being Lot 20 on Diagram 18009 (Certificate of Title Volume 1164, Folio 519)	0 1 39.1
19	Chevelley Dick Corbett Deshon, Madge Lila Deshon	Portion of Swan Location Q1 and being part Lot 685 on Plan 2934 (as is now contained in Plan 8692) (Certificate of Title Volume 522, Folio 6)	0 2 15.2
20	Antonio Triscari	Portion of Swan Location Q1 and being part Lot 25 on Diagram 21123 (as is now contained in Plan 8692) (Certificate of Title Volume 1200, Folio 470)	0 1 4
21	Cafarello Giuseppe Trusso	Portion of Swan Location Q1 and being part Lot 26 on Diagram 21123 (as is now contained in Plan 8692) (Certificate of Title Volume 1200, Folio 463)	0 1 4
22	Alfred Ernest Findlay	Portion of Swan Location Q1 and being Lot 687 on Plan 2934 (Certificate of Title Volume 470, Folio 60)	1 0 0
23	Carmelo Debono, Liberata Debono	Portion of Swan Location Q1 and being part Lot 24 on Diagram 20614 (as is now contained in Plan 8692) (Certificate of Title Volume 1192, Folio 169)	0 1 4
24	Saviour Vella, Adeodata Vella	Portion of Swan Location Q1 and being part Lot 23 on Diagram 20614 (as is now contained in Plan 8692) (Certificate of Title Volume 1192, Folio 170)	0 1 4
25	Michael Galea	Portion of Swan Location Q1 and being part of the land contained in Diagram 4314 (as is now contained in Plan 8692) (Certificate of Title Volume 1108, Folio 902)	0 1 4
26	Emily Whitford	Portion of Swan Location Q1 and being part Lot 689 on Plan 2934 (as is now contained in Plan 8692) (Certificate of Title Volume 1087, Folio 115)	0 1 3.9

## SCHEDULE—continued

No. on Plan P.W.D., W.A. No. 44576	Owner or Reputed Owner	Description	Area		
			a.	r.	p.
27	Andrew Sammut, Carmela Sammut ....	Portion of Swan Location Q1 and being part Lot 690 on Plan 2934 (as is now contained in Plan 8692) (Certificate of Title Volume 1068, Folio 682)	0	3	4
28	Cedric Cyril Woods, Geraldine Alice Irene Woods	Portion of Swan Location Q1 and being part Lot 623 on Plan 2934 (as is now contained in Plan 8692) (Certificate of Title Volume 1243, Folio 937)	0	2	20.9
29	Gerald Percy Charles Gamble, Selina Jean Gamble	Portion of Swan Location Q1 and being part Lot 624 on Plan 2934 (as is now contained in Plan 8692) (Certificate of Title Volume 1243, Folio 938)	0	1	21.3
30	Arthur Roy Edwards, Emma Lorraine Edwards	Portion of Swan Location Q1 and being Lot 9 on Diagram 14501 (Certificate of Title Volume 1132, Folio 332)	0	0	35.4
31	Cyril Ernest Peet ....	Portion of Swan Location Q1 and being the right of way coloured brown on Diagram 14501 (Certificate of Title Volume 1108, Folio 871)	0	0	16.7
32	Con Zara ....	Portion of Swan Location 4762 (as is now contained in Plan 8594) (Certificate of Title Volume 1188, Folio 300)	0	2	37.5
33	Clare Joseph Coronel ....	Portion of Swan Location Q1 and being Lot 679 on Plan 2934 (Certificate of Title Volume 482, Folio 103)	1	0	0
34	Josef Kost, Emma Kost ....	Portion of Swan Location 4761 (as is now contained in Plan 8594) (Certificate of Title Volume 1208, Folio 523)	0	2	12.2
35	Francis George Buck, Jessie Buck ....	Portion of Swan Location Q1 and being part Lot 677 on Plan 2934 (as is now contained in Plan 8594) (Certificate of Title Volume 1149, Folio 645)	0	3	0.4
36	Antonio Friscari, Giosepina Friscari ....	Portion of Swan Location Q1 and being Lot 13 on Diagram 16603 (Certificate of Title Volume 1149, Folio 643)	0	1	32
37	William Shier ....	Portion of Swan Location Q1 and being the right of way coloured brown on Diagram 16603 (Certificate of Title Volume 1135, Folio 125)	0	0	16
38	Joseph Wicks Chegwiddden, Mary Dolores Chegwiddden	Portion of Swan Location Q1 and being part Lot 14 on Diagram 16603 (as is now contained in Plan 8594) (Certificate of Title Volume 1149, Folio 644)	0	0	36
39 and 40	James Debono ....	Portion of Swan Location Q1 and being part Lot 18 on Diagram 17020 (as is now contained in Plan 8594) and the right of way coloured brown on Diagram 17020 (Certificate of Title Volume 1157, Folio 62)	0	2	7.9
41 and 42	Robert Archibald Finlay, Shirley Lorraine Finlay	Portion of Swan Location Q1 and being Lot 16 on Diagram 16602 and the right of way coloured brown on Diagram 16602 (Certificate of Title Volume 1314, Folio 425)	0	3	4
43	Joseph Pace, Mary Rose Pace ....	Portion of Swan Location Q1 and being Lot 673 on Plan 2934 (Certificate of Title Volume 1214, Folio 957)	1	0	0
44	Peter Romeo Salvaire ....	Portion of Swan Location Q1 and being part Lot 625 on Plan 2934 (as is now contained in Plan 8594) (Certificate of Title Volume 1273, Folio 11)	0	0	16.7
45 and 46	Salleo Building Co. Pty. Ltd. ....	Portions of Swan Location Q1 and being Lots 626 and 627 on Plan 2934 (Certificate of Title Volume 1262, Folio 268)	1	3	4
47	Armando Martino ....	Portion of Swan Location Q1 and being part Lot 664 on Plan 2934 (as is now contained in Plan 8594) (Certificate of Title Volume 1067, Folio 940)	0	1	0
48	Salleo Building Co. Pty. Ltd. ....	Portion of Swan Location Q1 and being part Lot 665 on Plan 2934 (as is now contained in Plan 8594) (Certificate of Title Volume 30, Folio 135A)	0	1	10
49	Thomas Lynch, Betty Mollie Lynch	Portion of Swan Location Q1 and being part Lot 665 on Plan 2934 (as is now contained in Plan 8594) (Certificate of Title Volume 1256, Folio 462)	0	1	2
49A	Crown ....	Portion of Swan Location Q1 and being that part of the southern moiety of Lot 665 on Plan 8594 marked as Vacant Crown Land	0	0	8
50	Laszlo Szabo ....	Portion of Swan Location Q1 and being Lot 666 on Plan 2934 (Certificate of Title Volume 868, Folio 35)	1	0	0
51	Charlie Chircop ....	Portion of Swan Location Q1 and being part Lot 667 on Plan 2934 (as is now contained in Plan 8594) (Certificate of Title Volume 1097, Folio 28)	0	1	10
52, 53, and 54	William Humphrey Errington ....	Portions of Swan Location Q1 and being Lot 669 and part of each of Lots 667 and 668 on Plan 2934 (as is now contained in Plan 8594) (Certificate of Title Volume 1097, Folio 64)	2	1	0.2
55	John Arthur Butcher, Annie Elizabeth Butcher	Portion of Swan Location Q1 and being part Lot 670 on Plan 2934 (as is now contained in Plan 8594) (Certificate of Title Volume 784, Folio 61)	0	3	4
56	Theodor Cokic, Gisela Cokic ....	Portion of Swan Location Q1 and being the right of way coloured brown on Diagram 21235 (Certificate of Title Volume 784, Folio 62)	0	0	16
57	Jan Wypych, Ingeborg Wigberta Wypych	Portion of Swan Location Q1 and being part Lot 19 on Diagram 21235 (as is now contained in Plan 8594) (Certificate of Title Volume 1194, Folio 327)	0	0	36
58	Theodor Cokic, Gisela Cokic ....	Portion of Swan Location Q1 and being part Lot 20 on Diagram 21235 (as is now contained in Plan 8594) (Certificate of Title Volume 1194, Folio 328)	0	0	36
59	Vincenzo Perrella ....	Portion of Swan Location Q1 and being part Lot 672 on Plan 2934 (as is now contained in Plan 8594) (Certificate of Title Volume 473, Folio 46)	0	3	4
60, 61 and 62	Antonino Magro, Nancy Magro ....	Portion of Swan Location Q1 and being Lots 6 and 8 and part of Lot 7 on Diagram 4304 (as is now contained in Plan 8594) (Certificate of Title Volume 885, Folio 184)	0	3	17.6

## SCHEDULE—continued

No. on Plan P.W.D., W.A. No. 44576	Owner or Reputed Owner	Description	Area		
			a.	r.	p.
63	Stipe Miolin	Portion of Swan Location Q1 and being the right of way coloured brown on Diagram 16523 (Certificate of Title Volume 1150, Folio 389)	0	0	32.7
64	Stipe Miolin	Portion of Swan Location Q1 and being the right of way coloured brown on Diagram 16834 (Certificate of Title Volume 1148, Folio 116)	0	0	32
65	Philip Berkeley Symes	Portion of Swan Location Q1 and being part Lot 12 on Diagram 16834 (as is now contained in Plan 8574) (Certificate of Title Volume 1280, Folio 861)	0	0	32
66	James Jacob Miolin	Portion of Swan Location Q1 and being part Lot 661 on Plan 2934 (as is now contained in Plan 8574) (Certificate of Title Volume 1288, Folio 94)	0	2	14
67	James Jacob Miolin, Jennifer Isobel Miolin	Portion of Swan Location Q1 and being Lot 660 on Plan 2934 (Certificate of Title Volume 1288, Folio 93)	1	0	0
68 and 69	Hilda Ellen Hawks	Portion of Swan Location Q1 and being Lots 658 and 659 on Plan 2934 (Certificate of Title Volume 1228, Folio 79)	2	0	0
70	Carmel Saliba	Portion of Swan Location Q1 and being Lot 657 on Plan 2934 (Certificate of Title Volume 1298, Folio 327)	1	0	0
71	Carmel Sammut	Portion of Swan Location Q1 and being part Lot 656 on Plan 2934 (as is now contained in Plan 8574) (Certificate of Title Volume 1050, Folio 140)	0	1	4
72	Veronica Mary Enderby	Portion of Swan Location Q1 and being part Lot 656 on Plan 2934 (as is now contained in Plan 8574) (Certificate of Title Volume 1050, Folio 139)	0	1	4
73	Allen Andrew Errington	Portion of Swan Location Q1 and being part Lot 655 on Plan 2934 (as is now contained in Plan 8574) (Certificate of Title Volume 1068, Folio 405)	0	1	3.2
74	Dulcie Amelia Gardiner	Portion of Swan Location Q1 and being part of the southern moiety of Lot 655 on Plan 2934 (as is now contained in Plan 8574) (Certificate of Title Volume 636, Folio 157)	0	0	4.7
75	Theodor Cokic, Gisela Cokic, purchasers under Contract of Sale from Dulcie Amelia Gardiner	Portion of Swan Location Q1 and being part of the southern moiety of Lot 655 on Plan 2934 (as is now contained in Plan 8574) (Certificate of Title Volume 636, Folio 157)	0	0	39.2
76	Gaetano Lombardi	Portion of Swan Location Q1 and being Lot 19 on Diagram 19421 (Certificate of Title Volume 1176, Folio 941)	0	1	30.5
77	Charles Henry Thompson	Portion of Swan Location Q1 and being part of Lot 631 on Plan 2934 (as is now contained in Plan 8574) (Certificate of Title Volume 599, Folio 80)	0	0	39.7
78	George Jesse Shaw	Portion of Swan Location Q1 and being part of Lot 631 on Plan 2934 (as is now contained in Plan 8574) (Certificate of Title Volume 622, Folio 114)	0	0	39.7
79	Olive May Bremner	Portion of Swan Location Q1 and being part Lot 632 on Plan 2934 (as is now contained in Plan 8574) (Certificate of Title Volume 1015, Folio 851)	0	0	39.8
80	Kevin Brown, Vera May Brown	Portion of Swan Location Q1 and being part Lot 1 on Diagram 5793 (as is now contained in Plan 8574) (Certificate of Title Volume 1263, Folio 964)	0	0	0.7
81	Renato Camilleri, Julia Josephine Camilleri	Portion of Swan Location Q1 and being part Lot 22 on Diagram 25123 (as is now contained in Plan 8574) (Certificate of Title Volume 12, Folio 23A)	0	0	35.9
82	Joseph Tanti, Maria Tanti	Portion of Swan Location Q1 and being part Lot 23 on Diagram 25123 (as is now contained in Plan 8574) (Certificate of Title Volume 12, Folio 24A)	0	0	29.7
83	Stanley Raymond Hart, Maureen Beverley Hart	Portion of Swan Location Q1 and being part Lot 1 on Diagram 8790 (as is now contained in Plan 8574) (Certificate of Title Volume 1018, Folio 169)	0	1	0.5
84	John Michael Muston	Portion of Swan Location Q1 and being part Lot 2 on Diagram 8790 (as is now contained in Plan 8574) (Certificate of Title Volume 1018, Folio 170)	0	1	1.5
85	C.S.B.P. & Farmers Ltd.	Portion of Swan Location Q1 and being part Lot 3 on Diagram 8790 (as is now contained in Plan 8574) (Certificate of Title Volume 1018, Folio 171)	0	1	2.5
86	Leslie Cassels, Emma Myrtle Cassels	Portion of Swan Location Q1 and being part Lot 4 on Diagram 8790 (as is now contained in Plan 8574) (Certificate of Title Volume 1018, Folio 172)	0	1	3.5
87 and 88	Hilda Ellen Hawks	Portion of Swan Location Q1 and being part Lot 20 on Diagram 21730 (as is now contained in Plan 8574) and the right of way coloured brown on Diagram 21730 (Certificate of Title Volume 1197, Folio 736)	0	1	18.1
89	Ronald James Chatfield, Colleen Frances Chatfield	Portion of Swan Location Q1 and being part Lot 21 on Diagram 21730 (as is now contained in Plan 8574) (Certificate of Title Volume 1197, Folio 735)	0	0	29.9
90	Donald Leonard Hawks	Portion of Swan Location Q1 and being part Lot 651 on Plan 2934 (as is now contained in Plan 8574) (Certificate of Title Volume 1213, Folio 252)	0	2	8
91	Peter Joseph Coyne	Portion of Swan Location Q1 and being part Lot 652 on Plan 2934 (as is now contained in Plan 8574) (Certificate of Title Volume 1094, Folio 423)	0	1	4
92	Sylvia Cochrave	Portion of Swan Location Q1 and being part Lot 652 on Plan 2934 (as is now contained in Plan 8574) (Certificate of Title Volume 1002, Folio 188)	0	1	4
93 and 94	Frank John Harapeet	Portion of Swan Location Q1 and being part Lot 16 on Diagram 18595 (as is now contained in Plan 8574) and the right of way coloured brown on Diagram 18595 (Certificate of Title Volume 1168, Folio 761)	0	1	14.9

## SCHEDULE—continued

No. on Plan P.W.D., W.A. No. 44576	Owner or Reputed Owner	Description	Area		
			a.	r.	p.
95	Ranald James Childewood Garrow ....	Portion of Swan Location Q1 and being part Lot 15 on Diagram 18595 (as is now contained in Plan 8574) (Certificate of Title Volume 1168, Folio 4)	0	0	33.1
96	George Richard May, Olive Frances May	Portion of Swan Location Q1 and being part of the northern moiety of Lot 654 on Plan 2934 (as is now contained in Plan 8574) (Certificate of Title Volume 624, Folio 192)	0	1	4
97	Rose Maud Dorothy May ....	Portion of Swan Location Q1 and being part Lot 654 on Plan 2934 (as is now contained in Plan 8574) (Certificate of Title Volume 566, Folio 156)	0	1	4
98	Estate of Eleanor Jane Pain (deceased)	Portion of Swan Location Q1 and being part Lot 632 on Plan 2934 (as is now contained in Plan 8574) (Certificate of Title Volume 524, Folio 56)	0	0	39.9
99	Sam Caruana ....	Portion of Swan Location Q1 and being part Lot 12 on Diagram 16759 (as is now contained in Plan 8574) (Certificate of Title Volume 1147, Folio 772)	0	0	39.9
100	Minister for Water Supply, Sewerage and Drainage	Portion of Swan Location Q1 and being Lot 26 on Diagram 27964 (Certificate of Title Volume 1264, Folio 496)	0	0	36.5
101 to 105 incl.	Martindale Pty. Ltd., F. D. O'Sullivan Pty. Ltd.	Portion of Swan Location Q1 and being (firstly) Lot 8 on Diagram 31476 and (secondly) Lots 616, 617, 618 and part Lot 619 on Plan 2934 (as is now contained in Plan 8682) (Certificate of Title Volume 1301, Folio 417)	4	3	3.5
106 and 107	Francesco Lombardi, Gisacchino Lombardi, Mario Lombardi	Portions of Swan Location Q1 and being Lot 615 and part Lot 614 on Plan 2934 (as is now contained in Plan 8682) (Certificate of Title Volume 705, Folio 14)	1	2	7.9
108	Mico Giustino Dominic ....	Portion of Swan Location Q1 and being part Lot 613 on Plan 2934 (as is now contained in Plan 8682) (Certificate of Title Volume 588, Folio 22)	0	3	4.6
109	George Orrock Foster ....	Portion of Swan Location Q1 and being part Lot 612 on Plan 2934 (as is now contained in Plan 8682) (Certificate of Title Volume 551, Folio 71)	0	3	1.9
110	Bassendean Road Board ....	Portion of Swan Location Q1 and subject of Plan 4695 (Certificate of Title Volume 845, Folio 67)	0	3	0
111	Doris Calphernia Reed ....	Portion of Swan Location Q1 and being part Lot 701 on Plan 3262 (as is now contained in Plan 8682) (Certificate of Title Volume 1068, Folio 632)	0	0	2.4
112	Estate of Harold Victor Boundy (deceased)	Portion of Swan Location Q1 and being part Lot 702 on Plan 3262 (as is now contained in Plan 8682) (Certificate of Title Volume 1079, Folio 491)	0	0	2.4
113	Annibale Santarini ....	Portion of Swan Location Q1 and being part Lot 703 on Plan 3262 (as is now contained in Plan 8682) (Certificate of Title Volume 1079, Folio 492)	0	0	2.4
114	Leo Nixon-Davis, Maud Elizabeth Nixon-Davis	Portion of Swan Location Q1 and being part Lot 704 on Plan 3262 (as is now contained in Plan 8682) (Certificate of Title Volume 1061, Folio 264)	0	0	2.4
115	Paul Mifsud, Cecilia Mifsud ....	Portion of Swan Location Q1 and being part Lot 705 on Plan 3262 (as is now contained in Plan 8682) (Certificate of Title Volume 623, Folio 131)	0	0	2.4
116	Joseph Aquilina, Maria Dolores Aquilina	Portion of Swan Location Q1 and being part lot 604 on Plan 2934 (as is now contained in Plan 8682) (Certificate of Title Volume 1301, Folio 414)	0	0	17.7
117	Crown ....	Portion of Swan Location 7991 and being Reserve 23063 ....	0	0	32
118	Lino Farrugia, Carry Farrugia	Portion of Swan Location Q1 and being Lot 9 on Diagram 31476 (Certificate of Title Volume 1301, Folio 416)	0	1	8
119	Mary Francis Walker ....	Portion of Swan Location Q1 and being the Northern Moiety of Lot 606 on Plan 2934 (Certificate of Title Volume 1083, Folio 407)	0	2	0
120	Mary Francis Walker ....	Portion of Swan Location Q1 and being part of the Southern Moiety of Lot 606 on Plan 2934 (as is now contained in Plan 8682) (Certificate of Title Volume 969, Folio 123)	0	1	7.9
121	Sussan Benedicta Mills ....	Portion of Swan Location Q1 and being part Lot 4 on Diagram 19605 (as is now contained in Plan 8682) (Certificate of Title Volume 1182, Folio 609)	0	1	15.4
122	Percy Turner Piggin ....	Portion of Swan Location Q1 and being part Lot 3 on Diagram 19605 (as is now contained in Plan 8682) (Certificate of Title Volume 1182, Folio 608)	0	1	0.5
123 and 124	Beniamino Parrella ....	Portion of Swan Location Q1 and being Lot 609 and part Lot 608 on Plan 2934 (as is now contained in Plan 8682) (Certificate of Title Volume 500, Folio 22)	1	3	7.8
125	Normau John Biles, Ursula Mavis Biles	Portion of Swan Location Q1 and being part Lot 610 on Plan 2934 (as is now contained in Plan 8682) (Certificate of Title Volume 1098, Folio 310)	0	2	7.9
126	Lilian Dorothy Foster ....	Portion of Swan Location Q1 and being part Lot 2 on Diagram 14111 (as is now contained in Plan 8682) (Certificate of Title Volume 1115, Folio 910)	0	0	32.3
127	William Ralph Foster, Lilian Dorothy Foster	Portion of Swan Location Q1 and being part Lot 1 on Diagram 14111 (as is now contained in Plan 8682) (Certificate of Title Volume 1111, Folio 500)	0	0	33.5
128	Michael Francis Day, Pamela Day ....	Portion of Swan Location Q1 and being part Lot 706 on Plan 3262 (as is now contained in Plan 8682) (Certificate of Title Volume 532, Folio 72)	0	0	2.4
129	Ian Peter Doig ....	Portion of Swan Location Q1 and being part Lot 707 on Plan 3262 (as is now contained in Plan 8682) (Certificate of Title Volume 1135, Folio 70)	0	0	2.4
130	Joseph Patrick Lambe ....	Portion of Swan Location Q1 and being part Lot 708 on Plan 3262 (as is now contained in Plan 8682) (Certificate of Title Volume 1045, Folio 337)	0	0	2.4



## SCHEDULE—continued

No. on Plan P.W.D., W.A. No. 44576	Owner or Reputed Owner	Description	Area		
			a.	r.	p.
131	Vincenzo Triscari, Rosaria Triscari	Portion of Swan Location Q1 and being part Lot 22 on Diagram 19659 (as is now contained in Plan 8683) (Certificate of Title Volume 1204, Folio 39)	0	0	13.8
132	Anthony Borg	Portion of Swan Location Q1 and being part Lot 23 on Diagram 19659 (as is now contained in Plan 8683) (Certificate of Title Volume 1190, Folio 830)	0	0	7.9
133	Manuel Galea	Portion of Swan Location Q1 and being part Lot 24 on Diagram 19659 (as is now contained in Plan 8683) (Certificate of Title Volume 1205, Folio 890)	0	0	11.6
134 and 135	Kenneth Gordon Ferguson, Herma Ruth Ferguson	Portions of Swan Location Q1 and being the Eastern Moiety of Lot 602 on Plan 2934 and part of the Eastern Moiety of Lot 603 on Plan 2934 (as is now contained in Plan 8683) (Certificate of Title Volume 660, Folio 86)	0	2	16.6
136	Dimitri Krisko	Portion of Swan Location Q1 and being part Lot 601 on Plan 2934 (as is now contained in Plan 8683) (Certificate of Title Volume 548, Folio 124)	0	3	3.9
137	Alojz Colja, Marija Colja	Portion of Swan Location Q1 and being part Lot 10 on Diagram 3725 (as is now contained in Plan 8683) (Certificate of Title Volume 1139, Folio 898)	0	1	4
138	William Jamieson, Gribbon Bell	Portion of Swan Location Q1 and being Lot 9 on Diagram 3725 (as is now contained in Plan 8683) (Certificate of Title Volume 1140, Folio 662)	0	1	4
139	Mern Christine Smith	Portion of Swan Location Q1 and being part Lot 8 on Diagram 3725 (as is now contained in Plan 8683) (Certificate of Title Volume 624, Folio 145)	0	1	3.9
140	Walter John Hart	Portion of Swan Location Q1 and being part Lot 16 on Diagram 14348 (as is now contained in Plan 8683) (Certificate of Title Volume 1145, Folio 611)	3	1	30
141	Guiseppe Trichilo	Portion of Swan Location Q1 and being part Lot 2 on Diagram 3725 (as is now contained in Plan 8683) (Certificate of Title Volume 808, Folio 103)	0	1	4
142	John Joseph McNerney	Portion of Swan Location Q1 and being part Lot 1 on Diagram 3725 (as is now contained in Plan 8683) (Certificate of Title Volume 808, Folio 102)	0	1	10
143	Edmund Charles Watson	Portion of Swan Location Q1 and being the right of way coloured brown on Diagram 16477 (Certificate of Title Volume 623, Folio 137)	0	0	16.7
144	Kelvin Arthur Nielsen	Portion of Swan Location Q1 and being part Lot 21 on Diagram 16477 (as is now contained in Plan 8683) (Certificate of Title Volume 1144, Folio 88)	0	1	0.9
145	Percy William Clements, Mary Clements	Portion of Swan Location Q1 and being part Lot 20 on Diagram 16477 (as is now contained in Plan 8683) (Certificate of Title Volume 1144, Folio 152)	0	0	36
146	Carmelo Vaccaro, Carmela Concetta Vaccaro	Portion of Swan Location Q1 and being part Lot 589 on Plan 2934 (as is now contained in Plan 8683) (Certificate of Title Volume 639, Folio 97)	0	3	0
147	Betty Jean Browne	Portion of Swan Location Q1 and being part Lot 590 on Plan 2934 (as is now contained in Plan 8683) (Certificate of Title Volume 1168, Folio 682)	0	1	9.6
148	Frederick Mott, Ethel Elizabeth May Mott	Portion of Swan Location Q1 and being part Lot 590 on Plan 2934 (as is now contained in Plan 8683) (Certificate of Title Volume 10, Folio 91A)	0	1	10.3
149	David Henry King	Portion of Swan Location Q1 and being the right of way coloured brown on Diagram 15266 (Certificate of Title Volume 1121, Folio 395)	0	0	24
150	David Henry King	Portion of Swan Location Q1 and being Lot 19 on Diagram 15266 (Certificate of Title Volume 1133, Folio 966)	0	1	32
151	David Henry King	Portion of Swan Location Q1 and being Lot 18 on Diagram 15266 (Certificate of Title Volume 1133, Folio 965)	0	1	32
152	Amy Theresa King	Portion of Swan Location Q1 and being part Lot 17 on Diagram 15266 (as is now contained in Plan 8683) (Certificate of Title Volume 1133, Folio 972)	0	0	36
153	Eleanor Meryl Hart	Portion of Swan Location Q1 and being part Lot 16 on Diagram 14348 (as is now contained in Plan 8683) (Certificate of Title Volume 1145, Folio 582)	1	0	0
154	Leonard David Lamb	Portion of Swan Location Q1 and being part of the northern moiety of Lot 586 on Plan 2934 (as is now contained in Plan 8681) (Certificate of Title Volume 571, Folio 196)	0	1	8
155	Luka Antunovic, Maria Antunovic	Portion of Swan Location Q1 and being part of the southern moiety of Lot 586 on Plan 2934 (as is now contained in Plan 8681) (Certificate of Title Volume 571, Folio 195)	0	1	8.7
156 and 157	Johanna Petronella Vanderelst	Portion of Swan Location Q1 and being part Lot 26 on Diagram 20845 (as is now contained in Plan 8681) and the portion coloured brown and marked right of way on Diagram 20845 (Certificate of Title Volume 13, Folio 347A)	0	1	12.7
158	McNess Housing Trust	Portion of Swan Location Q1 and being part of the northern moiety of Lot 584 on Plan 2934 (as is now contained in Plan 8681) (Certificate of Title Volume 549, Folio 129)	0	1	4
159	McNess Housing Trust	Portion of Swan Location Q1 and being part of the southern moiety of Lot 584 on Plan 2934 (as is now contained in Plan 8681) (Certificate of Title Volume 549, Folio 131)	0	1	4
160	McNess Housing Trust	Portion of Swan Location Q1 and being part Lot 583 on Plan 2934 (as is now contained in Plan 8681) (Certificate of Title Volume 549, Folio 130)	0	2	7.9
161	Pietro Ricciardo	Portion of Swan Location Q1 and being Lot 14 on Diagram 11923 (Certificate of Title Volume 1263, Folio 510)	0	0	36

## SCHEDULE—continued

No. on Plan P.W.D., W.A. No. 44576	Owner or Reputed Owner	Description	Area
			a. r. p.
162	Edgar James Quinn	Portion of Swan Location Q1 and being part of the northern moiety of Lot 582 on Plan 2934 (as is now contained in Plan 8681) (Certificate of Title Volume 835, Folio 9)	0 1 4
162A	Guiseppa Pacca, Maria Pacca	Portion of Swan Location Q1 and being part of the southern moiety of Lot 582 on Plan 2934 (as is now contained in Plan 8681) (Certificate of Title Volume 835, Folio 10)	0 1 4
163	Eric Courtney Brinkworth	Portion of Swan Location Q1 and being part Lot 1 on Diagram 3675 (as is now contained in Plan 8681) (Certificate of Title Volume 925, Folio 96)	0 0 38.9
164	Stanley John Willis	Portion of Swan Location Q1 and being Lot 2 on Diagram 3675 (Certificate of Title Volume 1082, Folio 400)	0 1 30.8
165	Stanley John Willis	Portion of Swan Location Q1 and being part Lot 3 on Diagram 3675 (as is now contained in Plan 8681) (Certificate of Title Volume 1053, Folio 530)	0 0 32.6
166	Georg Fischer, Lieselotte Fischer	Portion of Swan Location Q1 and being Lot 4 on Diagram 3675 (Certificate of Title Volume 1234, Folio 729)	0 1 19.3
167	Georg Fischer, Lieselotte Fischer	Portion of Swan Location Q1 and being Lot 5 on Diagram 3675 (Certificate of Title Volume 1230, Folio 730)	0 1 19.3
168	Estate of George Frederick Stinchcombe (deceased)	Portion of Swan Location Q1 and being the portion coloured brown and marked right of way on Diagram 15832 (Certificate of Title Volume 1136, Folio 885)	0 0 8
169	Joseph Calleja	Portion of Swan Location Q1 and being part Lot 21 on Diagram 16316 (as is now contained in Plan 8681) (Certificate of Title Volume 1151, Folio 358)	0 0 25
170	Frank Harold Hooper	Portion of Swan Location Q1 and being part Lot 573 on Plan 2934 (as is now contained in Plan 8681) (Certificate of Title Volume 698, Folio 122)	0 2 0
171	George Leigh Webb, Shirley May Webb	Portion of Swan Location Q1 and being part Lot 23 on Diagram 19060 (as is now contained in Plan 8681) (Certificate of Title Volume 1178, Folio 641)	0 0 36
172	Gwyneath Myrtle Lamb	Portion of Swan Location Q1 and being part Lot 21 on Diagram 15910 (as is now contained in Plan 8681) (Certificate of Title Volume 1142, Folio 389)	0 0 33.8
173 and 174	Leonard Watkins	Portion of Swan Location Q1 and being part Lot 22 on Diagram 15910 (as is now contained in Plan 8681) and the portion coloured brown and marked right of way on Diagram 15910 (Certificate of Title Volume 1142, Folio 414)	0 1 14.1
175 and 176	Terzziglio Grassi	Portion of Swan Location Q1 and being (firstly) Lot 6 on Diagram 3675 and (secondly) Lot 576 on Plan 2934 (Certificate of Title Volume 1304, Folio 74)	1 1 30.8
177	Gladys Olive May Wood	Portion of Swan Location Q1 and being part Lot 7 on Diagram 3675 (as is now contained in Plan 8681) (Certificate of Title Volume 1211, Folio 916)	0 1 0.8
178	Eunice Niriam Price	Portion of Swan Location Q1 and being Lot 8 on Diagram 3675 (Certificate of Title Volume 1082, Folio 401)	0 1 19.3
179	Mary Scudds	Portion of Swan Location Q1 and being part Lot 9 on Diagram 3675 (as is now contained in Plan 8681) (Certificate of Title Volume 702, Folio 65)	0 0 32
180	Kevin Francis Butler	Portion of Swan Location Q1 and being Lot 10 on Diagram 3675 (Certificate of Title Volume 832, Folio 18)	0 1 19.3

Certified correct this 23rd day of January, 1968.

C. W. COURT,  
Acting Minister for Works.

DOUGLAS KENDREW,  
Governor in Executive Council.

Dated this 7th day of February, 1968.

L.R.O. 85/68; Ex. Co. No. 200.

Leslie Solar Salt Industry Agreement Act, 1966; Public Works Act, 1902-1967.

LAND RESUMPTION.  
Ridley River Diversion.

NOTICE is hereby given, and it is hereby declared, that the several pieces or parcels of land described in the schedule hereto—being all in the De Grey and Forrest Districts have, in pursuance of the written approval and consent of His Excellency the Governor, acting by and with the advice of the Executive Council, dated the 7th day of February, 1968, been set apart, taken, or resumed for the purposes of Ridley River Diversion.

And further notice is hereby given that the said pieces or parcels of land so set apart, taken, or resumed are marked off and more particularly described on Plan, P.W.D., W.A. 44615, which may be inspected at the office of the Minister for Works, Perth.

And it is hereby directed that the said lands shall vest in Her Majesty for an estate in fee simple in possession for the purpose herein expressed, freed and discharged from all trusts, mortgages, charges, obligations, estates, interests, rights-of-way or other easements whatsoever.

SCHEDULE.

No. on Plan P.W.D., W.A. No. 44615.

Owner or Reputed Owner	Description	Area
		a. r. p.
The De Grey River Pastoral Company Proprietary Limited	Portion of the land contained in Crown Lease 451/1938 (Pastoral Lease 394/415)	210 0 0

Certified correct this 6th day of February, 1968.

ROSS HUTCHINSON,  
Minister for Works.

Dated this 7th day of February, 1968.

DOUGLAS KENDREW,  
Governor in Executive Council.

L.R.O. 702/67.

Public Works Act, 1902-1967.

## NOTICE OF INTENTION TO RESUME LAND.

THE Minister for Works hereby gives notice, in accordance with the provisions of section 17 (2) of the Public Works Act, 1902-1967, that it is intended to take or resume, under section 17 (1) of that Act, the pieces or parcels of land described in the Schedule hereto, and being all in the Jandakot District, for the purpose of the following public work, namely, Metropolitan Water Supply—Serpentine Trunk Main and Road Widening, and that the said pieces or parcels of land are marked off on Plan P.W.D. W.A. 44581, which may be inspected at the Office of the Minister for Works, Perth.

## SCHEDULE.

No.	Owner or Reputed Owner.	Occupier or Reputed Occupier.	Description.	Area
1	Crown (Purchaser under Contract of Sale); Colin George Gregory (registered proprietor)	Vacant	Portion of Jandakot Agricultural Area Lot 33 and being that part of Lot 1 on Diagram 22020, as is comprised in Plan 7748 and being part of the land in Certificate of Title Volume 1203, folio 14.	a. r. p. (Approx.) 0 2 0.7

Dated this 31st day of January, 1968.

ROSS HUTCHINSON,  
Minister for Works.

M.R.D. 2539/67.

Main Roads Act, 1930-1966; Public Works Act, 1902-1966.

## NOTICE OF INTENTION TO TAKE OR RESUME LAND.

THE Minister for Works hereby gives notice, in accordance with the provisions of section 17 (2) of the Public Works Act, 1902-1966, that it is intended to take or resume under section 17 (1) of that Act the pieces or parcels of land described in the schedule hereto and being all in the Wellington District for the purpose of the following public work, namely, widening Bunbury-Collie-Wagin Road and that the said pieces or parcels of land are marked off on Plan M.R.D. W.A. 1668, which may be inspected at the office of the Commissioner of Main Roads, 32 St George's Terrace, Perth.

## SCHEDULE.

No.	Owner or Reputed Owner	Occupier or Reputed Occupier	Description	Area
1	Tynedale Pty Ltd	Tynedale Pty Ltd	Portion of Wellington Location 1 on Plan 2262 (Certificate of Title, Volume 1275, folio 696)	a. r. p. (approx.) 3 0 13
2	Westralian Plywoods Pty Ltd	Westralian Plywoods Pty Ltd	Portion of Wellington Locations 1 and 5 being part of lot 5 on Plan 7922 (Certificate of Title Volume 1275, folio 695)	9 1 4

F. PARRICK,  
Secretary.

Dated this 7th day of February, 1968.

(This Notice supersedes items 1 and 2 of the Notice that appeared in the *Government Gazette* (No. 108), page 3545, dated the 22nd December, 1967.)

Public Works Act, 1902; Local Government Act, 1960.

## NOTICE OF INTENTION TO TAKE OR RESUME LAND.

THE Minister for Works hereby gives notice, in accordance with the provisions of section 17 (2) of the Public Works Act, 1902, that it is intended to compulsorily acquire on behalf of the Shire of Dumbleyung under section 17 (1) of that Act, the several pieces or parcels of land described in the schedule hereto for Road Purposes, and that the said pieces or parcels of land are marked off on plans as noted copies of which may be inspected at the office of the Minister for Lands, Perth, and at the office of the Shire of Dumbleyung.

## SCHEDULE.

No.	Owner or Reputed Owner	Occupier or Reputed Occupier	Description	Area
a. r. p.				
1880/90, V.2 (R2030), L. and S. Diagrams 71996 and 71997.				
1	Mervyn Harry Dawson	M. H. Dawson	Portion of Williams Location 921 (Certificate of Title Volume 792, folio 26)	0 1 9.6
2	George Barrington Kersley and William Valentine Cronin the Executors of the will of George Kersley (deceased)	V. J. McIntyre	Portion of Williams Location 7659 (Certificate of Title Volume 979, folio 160)	8 0 18
10713/09, V.3 (2108), L. and S. Diagram 71793.				
3	John Gilbert Mott	K. J. H. Cronin	Portion of Williams Location 7994 (Certificate of Title Volume 1250, folio 230)	0 0 27.1
4	John Gilbert Mott	K. J. H. Cronin	Portion of Williams Location 9056 (Certificate of Title Volume 1010, folio 702)	1 0 32.4

C. R. GIBSON,  
Under Secretary for Lands.

Dated this 16th day of February, 1968.

L. &amp; S. 8720/05, V3 (R.1655).

Public Works Act, 1902; Local Government Act, 1960.

## NOTICE OF INTENTION TO TAKE OR RESUME LAND.

THE Minister for Works hereby gives notice, in accordance with the provisions of Section 17 (2) of the Public Works Act, 1902, that it is intended to compulsorily acquire on behalf of the Shire of Dardanup, under Section 17 (1) of that Act, the several pieces or parcels of land described in the schedule hereto for Road Purposes, and that the said pieces or parcels of land are marked off on Original Plans 9455, 9456, 9457, 9458, 10132 and 10133 copies of which may be inspected at the Office of the Minister for Lands, Perth, and at the office of the Shire of Dardanup.

## SCHEDULE.

No.	Owner or Reputed Owner	Occupier or Reputed Occupier	Description	Area
1	John Ephraim Gardiner	J. E. Gardiner	Portion of Wellington Location 375 (Certificate of Title Volume 1050, folio 520)	a. r. p. 0 2 6.2
2	Ernest William Bradbury Marsh and Margaret Mary Marsh	E. B. W. Marsh	Portion of each of Wellington Locations 375 and 605 (Certificate of Title Volume 1102, folio 450)	1 0 21.7
3	Ephraim Gardiner	J. E. Gardiner	Portion of Wellington Location 605 (Certificate of Title Volume 33, folio 196)	0 1 29.1
4	John Ephraim Gardiner	J. E. Gardiner	Portion of Wellington Location 221 (Certificate of Title Volume 1040, folio 864)	0 1 7.8
5	Phyllis Dorothy Mabel Birmingham	J. P. Johnston	Portion of Wellington Location 208 (Certificate of Title Volume 1059, folio 720)	0 2 32.1
6	Phyllis Dorothy Mabel Birmingham	J. P. Johnston	Portion of Wellington Location 581 (Certificate of Title Volume 730, folio 104)	1 0 3.5
7	Geoffrey Michael Harris	G. M. Harris	Portion of each of Wellington Locations 365, 420 and 606 (Certificate of Title Volume 1270, folio 831)	2 2 9
8	Peter James Depiazzi and Owen Bernard Depiazzi	P. J. and O. B. Depiazzi	Portion of each of Wellington Locations 420 and 606 (Certificate of Title Volume 1249, folio 83)	0 1 15.8
9	The Bunbury Diocesan Trustees	The Bunbury Diocesan Trustee	Portion of Wellington Location 451 (Certificate of Title Volume 1059, folio 991)	0 0 9.6
10	Geoffrey Michael Harris	G. M. Harris	Portion of Wellington Location 451 (Certificate of Title Volume 1258, folio 430)	0 1 8.7
11	Janet Mary Tyrrell	J. M. Tyrrell	Portion of Wellington Location 2468 (Certificate of Title Volume 1258, folio 429)	1 0 0.9
12	Arnold Cleve Gibbs and Jennie Gibbs	A. C. Gibbs	Portion of Wellington Location 2468 (Certificate of Title Volume 1258, folio 428)	0 3 4.4
13	John Plesse Johnston	J. P. Johnston	Portion of Wellington Location 338 (Certificate of Title Volume 1048, folio 906)	0 2 2.9
14	Arnold Cleve Gibbs	A. C. Gibbs	Portion of each of Wellington Locations 541 and 578 (Certificate of Title Volume 1121, folio 474)	2 1 22.1
15	Herbert Swinton Kerr	H. S. Kerr	Portion of Wellington Location 470 and being part of the land on Diagram 10728 (Certificate of Title Volume 1083, folio 954)	0 0 18.4
16	Herbert Swinton Kerr	H. S. Kerr	Portion of Wellington Location 850 (Certificate of Title Volume 1121, folio 476)	2 1 21.5
17	Herbert Swinton Kerr	H. S. Kerr	Portion of Wellington Location 850 and being part of the land on Plan 2884 (Certificate of Title Volume 1276, folio 450)	0 0 8.5
18	Herbert Swinton Kerr	H. S. Kerr	Portion of Wellington Location 851 (Certificate of Title Volume 1121, folio 475)	1 1 36.5
19	Robert Stanley Gardiner	R. S. Gardiner	Portion of Wellington Location 398 (Certificate of Title Volume 995, folio 91)	0 3 7.7
20	Robert Stanley Gardiner	R. S. Gardiner	Portion of Wellington Location 398 (Certificate of Title Volume 1011, folio 162)	0 0 20.6
21	Victor Robert Gardiner and Hilda Alice Gardiner	V. R. Gardiner	Portion of Wellington Location 398 (Certificate of Title Volume 1011, folio 163)	0 1 10
22	Harold Ferguson Gibbs	H. F. Gibbs	Portion of Wellington Location 892 (Certificate of Title Volume 121, folio 7)	1 3 30.5
23	Arnold Cleve Gibbs and Howard Basil Gibbs the executors of the Will of Herbert Cleveland Gibbs (deceased)	H. B. Gibbs	Portion of Wellington Location 661 (Certificate of Title Volume 624, folio 68)	0 0 34.5
24	Harold Ferguson Gibbs	H. F. Gibbs	Portion of Wellington Location 3336 (Certificate of Title Volume 1069, folio 730)	1 0 1
25	Ernest Jesse Gardiner	E. J. Gardiner	Portion of Wellington Location 596 (Certificate of Title Volume 1262, folio 35)	0 1 17.7
26	Howard Basil Gibbs	H. B. Gibbs	Portion of each of Wellington Locations 2508 and 2509 (Certificate of Title Volume 841, folio 27)	0 2 29.8
27	Arnold Cleve Gibbs and Howard Basil Gibbs the executors of the Will of Herbert Cleveland Gibbs (deceased)	H. B. Gibbs	Portion of Wellington Location 2508 (Certificate of Title Volume 841, folio 28)	0 2 34.2
28	Arnold Cleve Gibbs and Howard Basil Gibbs the executors of the Will of Herbert Cleveland Gibbs (deceased)	H. B. Gibbs	Portion of Wellington Location 2508 (Certificate of Title Volume 823, folio 104)	0 0 2
29	Dorothy Marguerite Gardiner	B. S. Gardiner	Portion of Wellington Location 368 (Certificate of Title Volume 1058, folio 239)	0 3 10.7
30	Brian Skevington Gardiner	B. S. Gardiner	Portion of each of Wellington Locations 107, 133, 169, 430, 146, 208 and 581 (Certificate of Title Volume 1176, folio 445)	1 3 18.3

Dated this 16th day of February, 1968.

C. R. GIBSON,  
Under Secretary for Lands.

L. &amp; S. 3760/12 (R.2119).

Public Works Act, 1902; Local Government Act, 1960.

## NOTICE OF INTENTION TO TAKE OR RESUME LAND.

THE Minister for Works hereby gives notice, in accordance with the provisions of Section 17 (2) of the Public Works Act, 1902, that it is intended to compulsorily acquire on behalf of the Shire of Canning under Section 17 (1) of that Act, the several pieces or parcels of land described in the schedule hereto for Road Purposes, and that the said pieces or parcels of land are marked off on L. & S. Diagram 71220 copies of which may be inspected at the Office of the Minister for Lands, Perth, and at the office of the Shire of Canning.

## SCHEDULE.

No.	Owner or Reputed Owner	Occupier or Reputed Occupier	Description.	Area.
	Mervyn Edward Schofield	M. E. Schofield	Portion of Canning location 25 and being part of lot 995 on Plan 4386 (Certificate of Title Volume 1297, folio 41)	a. r. p. 0 0 4.5

Dated this 9th day of February, 1968.

G R. GIBSON,  
Under Secretary for Lands.

L. &amp; S. 1308/29 (R.2085).

Public Works Act, 1902; Local Government Act, 1960.

## NOTICE OF INTENTION TO TAKE OR RESUME LAND.

THE Minister for Works hereby gives notice, in accordance with the provisions of Section 17 (2) of the Public Works Act, 1902, that it is intended to compulsorily acquire on behalf of the Shire of Perenjori under Section 17 (1) of that Act, the several pieces or parcels of land described in the schedule hereto for Road Purposes, and that the said pieces or parcels of land are marked off on Original Plan 10572 copies of which may be inspected at the Office of the Minister for Lands, Perth, and at the office of the Shire of Perenjori.

## SCHEDULE.

No.	Owner or Reputed Owner	Occupier or Reputed Occupier	Description.	Area.
	George Wilmot Taylor	D. R. and T. E. Duffell	Portion of Victoria Location 7763 (Certificate of Title Volume 1155, folio 762)	a. r. p. 17 3 25

Dated this 9th day of February, 1968.

G R. GIBSON,  
Under Secretary for Lands.

L. &amp; S. 134/63 (R.1046).

Public Works Act, 1902; Local Government Act, 1960.

## NOTICE OF INTENTION TO TAKE OR RESUME LAND.

THE Minister for Works hereby gives notice, in accordance with the provisions of Section 17 (2) of the Public Works Act, 1902, that it is intended to compulsorily acquire on behalf of the Shire of Plantagenet under Section 17 (1) of that Act, the several pieces or parcels of land described in the schedule hereto for Road Purposes, and that the said pieces or parcels of land are marked off on Original Plan 10071 copies of which may be inspected at the Office of the Minister for Lands, Perth, and at the office of the Shire of Plantagenet.

## SCHEDULE.

No.	Owner or Reputed Owner	Occupier or Reputed Occupier	Description	Area
1	Hilda Elizabeth McGready and Campbell John McGready	H. E. and C. J. McGready	Portion of Porongorup Estate Lot 5 (Crown Lease 2204/1930)	a. r. p. 0 1 14.4
2	Hilda Elizabeth McGready and Campbell John McGready	H. E. and C. J. McGready	Portion of Porongorup Estate Lot 2 (Conditional Purchase Lease 3127/963)	0 1 33.6

Dated this 9th day of February, 1968.

G R. GIBSON,  
Under Secretary for Lands.

L. &amp; S. 874/64 (R.2082).

Public Works Act, 1902; Local Government Act, 1960.

## NOTICE OF INTENTION TO TAKE OR RESUME LAND.

THE Minister for Works hereby gives notice, in accordance with the provisions of Section 17 (2) of the Public Works Act, 1902, that it is intended to compulsorily acquire on behalf of the Shire of Williams under Section 17 (1) of that Act, the several pieces or parcels of land described in the schedule hereto for Road Purposes, and that the said pieces or parcels of land are marked off on L. & S. Diagram 72306 copies of which may be inspected at the Office of the Minister for Lands, Perth, and at the office of the Shire of Williams.

## SCHEDULE.

No.	Owner or Reputed Owner	Occupier or Reputed Occupier	Description.	Area.
1	Alastair George McOran-Campbell	A. G. McOran-Campbell	Portion of Wellington Location 4756 (Crown Lease 700/1964)	a. r. p. 11 0 17
2	Robert Neil Cowcher	R. N. Cowcher	Portion of Wellington Location 4757 (Conditional Purchase Lease 347/14627)	11 2 17

Dated this 9th day of February, 1968.

G R. GIBSON,  
Under Secretary for Lands.

L. &amp; S. 3400/62 (R.1864).

Public Works Act, 1902; Local Government Act, 1960.

## NOTICE OF INTENTION TO TAKE OR RESUME LAND.

THE Minister for Works hereby gives notice, in accordance with the provisions of Section 17 (2) of the Public Works Act, 1902, that it is intended to compulsorily acquire on behalf of the Shire of Carnarvon under Section 17 (1) of that Act, the several pieces or parcels of land described in the Schedule hereto for Road Purposes, and that the said pieces or parcels of land are marked off on Page 32 of L. & S. File 3400/62 copies of which may be inspected at the Office of the Minister for Lands, Perth, and at the office of the Shire of Carnarvon.

## SCHEDULE.

No.	Owner or Reputed Owner	Occupier or Reputed Occupier	Description	Area
1	Arnold Hughan Gibson	A. H. Gibson	Portion of Gascoyne Location 227 (Crown Lease 129/1967)	a. r. p. 21 0 0 (approx.)
2	Thomas James Reynolds	T. J. Reynolds	Portion of Gascoyne Location 228 (Conditional Purchase Lease 3116/2495)	10 0 0 (approx.)
3	Thomas James Reynolds	T. J. Reynolds	Portion of Gascoyne Location 229 (Crown Lease 1350/1961)	16 3 8 (approx.)

Dated this 9th day of February, 1968.

G R. GIBSON,  
Under Secretary for Lands.

L. &amp; S. 4222/65 (R.2037).

Public Works Act, 1902; Local Government Act, 1960.

## NOTICE OF INTENTION TO TAKE OR RESUME LAND.

THE Minister for Works hereby gives notice, in accordance with the provisions of Section 17 (2) of the Public Works Act, 1902, that it is intended to compulsorily acquire on behalf of the Shire of Corrigin under Section 17 (1) of that Act, the several pieces or parcels of land described in the schedule hereto for Road Purposes, and that the said pieces or parcels of land are marked off on L. & S. Diagram 72111, 72112 and 72113 copies of which may be inspected at the Office of the Minister for Lands, Perth, and at the office of the Shire of Corrigin.

## SCHEDULE.

No.	Owner or Reputed Owner	Occupier or Reputed Occupier	Description	Area
1	Doris Amy Rafferty, William George Rafferty and Bessie Ann Rafferty	W. G and B. A. Rafferty	Portion of Avon Location 8417 (Certificate of Title Volume 1013, folio 784)	a. r. p. 0 2 38.8
2	Percival George Tuckfield	E. L. and B. D. Hovell	Portion of Avon Location 27329 (Crown Lease 63/1952)	0 3 19.1
3	Clement Corley Hill	C C. Hill	Portion of Avon Location 11632 (Certificate of Title Volume 1126, folio 717)	1 1 11

Dated this 9th day of February, 1968.

G R. GIBSON,  
Under Secretary for Lands.

L. &amp; S. 8862/04 V.2 (R.2109).

Public Works Act, 1902; Local Government Act, 1960.

## NOTICE OF INTENTION TO TAKE OR RESUME LAND.

THE Minister for Works hereby gives notice, in accordance with the provisions of Section 17 (2) of the Public Works Act, 1902, that it is intended to compulsorily acquire on behalf of the Shire of Cranbrook under Section 17 (1) of that Act, the several pieces or parcels of land described in the schedule hereto for Road Purposes, and that the said pieces or parcels of land are marked off on L. & S. Diagram 72110 copies of which may be inspected at the Office of the Minister for Lands, Perth, and at the office of the Shire of Cranbrook.

## SCHEDULE.

No.	Owner or Reputed Owner	Occupier or Reputed Occupier	Description	Area
1	Earl Conway Parsons	E. C. Parsons	Portion of Plantagenet Location 161 and being part of the land on Diagram 20404 (Certificate of Title Volume 1187, folio 655)	a. r. p. 2 0 21
2	Earl Conway Parsons	E. C. Parsons	Portion of Hay Location 1157 (Certificate of Title Volume 1188, folio 751)	0 0 8

Dated this 9th day of February, 1968.

G R. GIBSON,  
Under Secretary for Lands.

**METROPOLITAN WATER SUPPLY, SEWERAGE AND DRAINAGE BOARD.**

Metropolitan Water Supply.

Notice of Intention.

M.W.B. 819081/68.

NOTICE is hereby given, pursuant to section 20 of the Metropolitan Water Supply, Sewerage and Drainage Act, 1909-1965 of the intention of the Board to undertake the construction and provision of the following works, namely:—

Shire of Rockingham.

Eighteen inch diameter distribution main to Bungaree.

Description of Proposed Works.

The construction of an eighteen inch diameter water main about six thousand seven hundred feet in length complete with valves and all other necessary apparatus.

The Localities in which the Proposed Works will be Constructed or Provided.

Commencing at the intersection of Dixon Road and Kent Street and proceeding thence in a general southerly direction along Dixon Road to Railway Terrace thence continuing in a general southerly direction to and within crown land and parallel to the eastern boundary of the said crown land to Read Street thence continuing in a general southerly direction along Read Street to Cygnus Street in Bungaree Subdivision and terminating thereat.

The above works and localities are shown on plan M.W.B. No. 9915.

The Purposes for which the Proposed Works are to be Constructed or Provided.

To provide for future reticulation of Bungaree.

The Times when and Place at which Plans, Sections, and Specifications may be Inspected.

At the Office of the Board, corner of King's Park Road and Havelock Street, West Perth, for one month on and after the 9th day of February, 1968, between the hours of 9 a.m. and 3.30 p.m.

G. SAMUEL,  
General Manager and Secretary.

**METROPOLITAN WATER SUPPLY, SEWERAGE AND DRAINAGE BOARD.**

Metropolitan Water Supply.

Notice of Intention.

M.W.B. 813682/68.

NOTICE is hereby given, pursuant to Section 20 of the Metropolitan Water Supply, Sewerage and Drainage Act, 1909-1965, of the intention of the Board to undertake the construction and provision of the following works, namely:—

Town of Melville and Shire of Cockburn, 30 inch Hamilton Hill Inlet Main, 2nd Section.

Description of Proposed Works.

The construction of a thirty inch diameter water main about eleven thousand feet in length complete with valves and all other necessary apparatus.

The Localities in which the Proposed Works will be Constructed or Provided.

Commencing at the intersection of North Lake Road and South Street and proceeding thence in a southerly direction along North Lake Road to Torquil Road thence in a westerly direction along Torquil Road to Doherty Road, thence in a southerly direction along Doherty Road to Waverley Road, thence in a general westerly direction along Waverley Road to Coolbellup Avenue, thence in a southerly direction along Coolbellup Avenue to Counsel Road, thence in a general westerly direction along Counsel Road to Lear Place, thence in a general southerly direction along Lear Place to Oswald Street, thence in a general westerly direction along Oswald Street to and across Leece Street and into Hamilton Hill Reservoir Reserve, thence proceeding in a southerly direction within and parallel to the eastern boundary of the said reserve for a distance of approximately six hundred feet,

thence in an easterly direction within the said reserve for a distance of approximately five hundred and fifty feet and terminating thereat as shown in red on plan M.W.B. 9912.

The Purpose for which the Proposed Works are to be Constructed or Provided.

To supply water to the Fremantle and Hamilton Hill area.

Times when and Place at Which Plans, Sections, and Specifications may be Inspected.

At the Office of the Board, corner of Kings Park Road and Havelock Street, West Perth, for one month on and after the 9th of February, 1968, between the hours of 9 a.m. and 3.30 p.m.

G. SAMUEL,  
General Manager and Secretary.

**SHIRE OF NANNUP.**

STATEMENT OF RECEIPTS AND PAYMENTS FOR THE YEAR ENDED 30th JUNE, 1967.

Receipts.		
Rates	.....	\$ 8,531.53
Payment in lieu of Rates	.....	493.64
Licenses	.....	13,330.03
Pound	.....	1.50
Government Grants	.....	10,953.56
Central Road Trust Grants	.....	3,816.50
Income from Property	.....	384.56
Sale of Plant	.....	12.96
Sanitation Charges	.....	1,124.88
Septic Repayments	.....	313.40
Cemetery Receipts	.....	81.00
Vermin Receipts	.....	15.45
Other Fees	.....	128.30
Other Receipts	.....	3,845.52
<b>Total Receipts</b>	.....	<b>\$48,032.83</b>
Payments.		
Administration	.....	\$ 4,662.98
Members	.....	152.76
Debt Service	.....	7,507.22
Public Works and Services	.....	21,879.11
Health Services	.....	2,626.83
Vermin Services	.....	490.60
Cemetery	.....	292.32
Grants and Donations	.....	830.96
Public Works Overhead	.....	662.79
Purchase of Plant	.....	603.05
Plant Operation Costs	.....	411.68
Licensing Plates, etc.	.....	119.56
C.R.T. Fund	.....	4,064.00
Railway Crossing Fund	.....	50.50
Noxious Weeds Recoupable	.....	167.72
Other Public Works	.....	273.19
Materials	.....	159.50
Long Service Reserve	.....	520.00
Traffic Control	.....	1,088.75
<b>Total Payments</b>	.....	<b>\$46,563.52</b>

**SUMMARY.**

Balance at 1/7/66 (Surplus)	.....	\$ 740.50
Receipts as per Statement	.....	48,032.83
		<b>\$48,773.33</b>
Payments as per Statement	.....	46,563.52
Balance at 30/6/67 (Surplus)	.....	2,209.81

**TRUST FUND.**

Receipts.		
Cr. Balance at 1st July, 1966	.....	\$ 1,583.17
Third Party Insurance	.....	10,084.91
Stamp Duty	.....	1,062.00
Nomination Deposits	.....	50.00
Taxation Suspense	.....	1,887.85
State Housing Commission	.....	3,788.00
Tasmanian Bushfire Appeal	.....	113.10
Superannuation	.....	578.00
Interest on Superannuation	.....	5.40
Repayments	.....	4.00
Long Service Reserve	.....	520.00
Interest on Long Service Reserve	.....	61.41
Refunds	.....	3.00
<b>Total Receipts</b>	.....	<b>\$19,740.84</b>
Payments.		
Third Party Insurance	.....	\$ 10,084.91
Stamp Duty	.....	1,062.00
Nomination Deposits	.....	30.00
Taxation Suspense	.....	1,887.85
State Housing Commission	.....	3,788.00
Tasmanian Bushfire Appeal	.....	113.10
Superannuation	.....	578.00
Refunds	.....	3.00
Surplus Balance at 30/6/67	.....	2,193.98
		<b>\$19,740.84</b>

**LOAN CAPITAL.**  
Receipts.

Cr. Balance at 1st July, 1966	\$ 2,116.45
Total	\$2,116.45

Payments.

By Loan No. 13—Library	\$ 468.00
By Loan No. 14—Fire Brigade	1,200.00
By Balance	448.45
Total	\$2,116.45

**BALANCE SHEET AS AT 30th JUNE, 1967.**

Assets.

Bank Account	\$ 2,209.81
Sundry Debtors	3,457.88
Stocks on Hand	798.16
Non-current Assets	4,548.17
Deferred Assets	5,007.77
Fixed Assets	38,517.10
Other: Unspent CRT. Fund	797.74
Total Assets	\$55,336.63

Liabilities.

Sundry Creditors	\$ 587.58
Accrued Interest	377.16
Suspense Account	43.14
Non-current Liabilities	2,193.98
Deferred Liabilities	21,930.59
Municipal Accumulation A/c.	30,204.18
Total	\$55,336.63

We certify that the figures and particulars above are correct.

R. H. BROCKMAN,  
President.

C. GILBERT,  
Shire Clerk.

I have examined the books and accounts of the Shire of Nannup for the year ended 30th June, 1967. I certify that the Annual Statements mentioned above correspond to the books of account, vouchers and documents submitted for audit and are in my opinion correct, subject to my report.

R. R. MARTIN,  
Government Inspector of Municipalities.

**SHIRE OF NYABING-PINGRUP.**

**STATEMENTS OF RECEIPTS AND PAYMENTS FOR THE YEAR ENDED 30th JUNE, 1967.**

Receipts.

Rates	\$ 37,611.73
Payments in lieu of Rates	10.92
Licenses	24,784.87
Government Grants and Recoups, M.R.D.	24,578.75
Government Grants and Recoups, C.R.T.	20,354.25
Income from Property	2,691.48
Sanitation	523.80
Cemeteries	29.05
Vermín Act	34.02
Traffic Act	240.84
Fines and Penalties—Traffic Act	20.00
All Other Receipts	5,484.06
Total Receipts	\$116,363.77

Payments.

Administration	\$ 8,559.40
Membership	637.10
Debt Service	20,185.10
Public Works and Services	52,955.82
Health Services	2,367.52
Vermín Services	1,535.59
Bushfire Control	433.19
Traffic Control	695.23
Cemeteries	15.00
Public Works Overheads, unallocated	371.92
Machinery, Plant and Tools	10,017.00
Plant Operation Costs, unallocated	98.55
Materials Costs, unallocated	398.67
Payments to Central Road Trust Fund	13,930.00
Payments to Railway Crossings Fund	96.00
Donations and Grants	336.87
Transfer to Nyabing Recreation Ground Reserve	2,396.36
Private Works	1,008.28
All Other Expenditure	260.80
Total	\$116,298.40

SUMMARY.

Receipts as per Statement	\$ 116,363.77
Less Overdrawn at 1/7/66	1,916.29
	114,447.48
Add Overdrawn at 30/6/67	1,850.92
Payments as per Statement	\$116,298.40

**BALANCE SHEET AS AT 30/6/67.**

Assets.

Current Assets	\$ 5,368.62
Non-Current Assets	46,833.14
Fixed Assets	126,073.48
Deferred Assets (W.A. Government, re Loan No. 24)	2,813.59
Total Assets	\$181,088.83

Liabilities.

Current Liabilities	\$ 13,011.49
Non-Current Liabilities	1,788.61
Loan Liability	123,091.31
Total	\$137,891.41

SUMMARY.

Total Assets	\$ 181,088.83
Total Liabilities	137,891.41
Balance, Municipal Accumulation Account	\$43,197.42

Contingent Liability.—The amount of interest included in loan debentures payable over the life of the loans, and not shown under the heading of Loan Liability is approximately \$3,250.

We hereby certify that the figures and particulars above are correct.

20th December, 1967.

P. H. WEBSE,  
President.

R. H. SMITH,  
Clerk.

I certify having examined the books and accounts of the Shire of Nyabing-Pingrup for the year ended 30th June, 1967, I certify that the Annual Statements mentioned above correspond with the books of account, vouchers and documents submitted for audit, and are in my opinion correct, subject to my report.

R. MARSHALL,  
Government Inspector of Municipalities.

**LOCAL GOVERNMENT ACT, 1960.**

Shire of Harvey.

Notice of Intention to Borrow.

Proposed Loan (No. 93) of \$30,000.

PURSUANT to section 610 of the Local Government Act, 1960, the Harvey Shire Council hereby gives notice that it proposes to borrow money by the sale of a debenture or debentures on the following terms and for the following purpose: \$30,000 for 15 years, at a rate of interest not exceeding \$6 per cent. per annum, repayable at the Bank of New South Wales Savings Bank Limited, Harvey, by thirty equal half-yearly instalments of principal and interest. Purpose: Road and drainage works.

Plans, specifications, estimates and statements required by section 609, are open for inspection at the office of the Council during office hours for thirty-five days after publication of this notice.

Dated this 31st day of January, 1968.

WILLIAM K. BARNES,  
President.

L. A. VICARY,  
Shire Clerk.

**LOCAL GOVERNMENT ACT, 1960.**

Shire of Harvey.

Notice of Intention to Borrow.

Proposed Loan (No. 94) of \$7,000.

PURSUANT to section 610 of the Local Government Act, 1960, the Harvey Shire Council hereby gives notice that it proposes to borrow money by the sale of a debenture or debentures on the following terms and for the following purpose: \$7,000 for 15 years, at a rate of interest not exceeding \$6 per cent. per annum, repayable at the Bank of New South Wales Savings Bank Limited, Harvey, by thirty equal half-yearly instalments of principal and interest.

Purpose: Brunswick Junction Kindergarten.



Plans, specifications, estimates and statements required by Section 609, are open for inspection at the office of the Council during office hours for thirty-five days after publication of this notice.

The Brunswick and Districts Kindergarten Committee has undertaken to repay 50 per cent. of principal and interest.

Dated this 31st day of January, 1968.

WILLIAM K. BARNES,  
President.

L. A. VICARY,  
Shire Clerk.

#### LOCAL GOVERNMENT ACT, 1960.

Shire of Kojonup.

Notice of Intention to Borrow.

Proposed Loan (No. 54) of \$20,000.

PURSUANT to section 610 of the Local Government Act, 1960, the Kojonup Shire Council hereby gives notice that it proposes to borrow money, by the sale of debentures, on the following terms and for the following purpose: \$20,000 for a period of ten years, at an interest rate not exceeding \$6 per cent., per annum, repayable at the National Bank Savings Bank, Kojonup by half-yearly instalments of principal and interest. Purpose: Extensions to Shire Office building.

Plans, specifications and estimates, as required by section 609 are open for inspection at the office of the Council during office hours, for 35 days after publication of this notice.

Dated this 10th day of January, 1968.

W. H. C. STRETCH,  
President.

R. L. LEGGO,  
Shire Clerk.

#### LOCAL GOVERNMENT ACT.

Shire of Mingenew.

Notice of Intention to Borrow.

Proposed Loan No. 66 of \$10,000.

PURSUANT to section 610 of the Local Government Act, 1960, the Shire of Mingenew hereby gives notice that it proposes to borrow, by debentures, money on the following terms and for the following purpose: \$10,000 for 5 years at a rate of interest not exceeding 5.75 per cent. per annum, repayable at the National Bank Mingenew, by 10 half-yearly instalments of principal and interest. Purpose: To purchase a Loader.

Plans, specifications, estimates and statement required by section 609 are open for inspection of ratepayers at the Office of the Shire of Mingenew between 9 a.m. and 5 p.m. Mondays to Fridays, for 35 days after the publication of this notice.

Dated this 2nd day of February, 1968.

W. C. K. PEARSE,  
President.

G. O. McCracken,  
Shire Clerk.

#### SHIRE OF ROCKINGHAM.

NOTICE is hereby given that Mr Francis Edward McGrath has been appointed Building Surveyor/Health Inspector for the Shire of Rockingham, and the appointment of Mr Roy Evan Blakemore as Building Surveyor has been cancelled.

The appointment of Mr Roy Evan Blackmore is confirmed as Health Inspector/Building Inspector for the Shire of Rockingham.

Dated this 30th day of January, 1968.

D. J. CUTHBERTON,  
Shire Clerk.

#### SHIRE OF MINGENEW.

Dog Catcher and Poundkeeper.

NOTICE is hereby given that Francis Owen Constantine O'Neill has been appointed as Dog Catcher and Poundkeeper for the Shire of Mingenew, and that a pound has been established at the Council's Depot.

G. O. McCracken,  
Shire Clerk.

#### SHIRE OF ALBANY.

IT is hereby notified that Aelian Lorenz van der Straaten and Frank Alan Ginbey have been appointed Traffic Inspectors for the Municipality of the Shire of Albany, as from 19th January, 1968.

B. E. LANGE,  
President.

#### SHIRE OF CAPEL.

Traffic Inspector.

NOTICE is hereby given that Richard Ashley Magennis has been appointed as Traffic Inspector for the Shire of Capel and the appointment of C. R. Impson is hereby cancelled.

W. M. WRIGHT,  
Shire Clerk.

#### SHIRE OF PERENJORI.

Traffic Inspector.

NOTICE is hereby given that Allan Jenkinson has been appointed as Traffic Inspector for the Shire of Perenjori as from 1st February, 1968.

L. H. MILLAR,  
Shire Clerk.

#### SHIRE OF ROEOURNE.

IT is hereby notified for public information that Ernest James Johansen has been appointed Assistant Traffic Inspector to the Shire of Roebourne, as from the 18/1/68.

E. J. JOHANSEN,  
Acting Shire Clerk.

#### MOTOR VEHICLE (THIRD PARTY INSURANCE) ACT, 1943.

Appointment of Premiums Committee.

Department of Local Government,  
Perth, 8th February, 1968.

L.G. 2469/52.

IT is hereby notified for public information, that His Excellency the Governor has appointed, under the provisions of the Motor Vehicle (Third Party Insurance) Act, 1943, John Alexander Carr, as nominee of the Fire and Accident Underwriters' Association of Western Australia Inc., to be a member of the Premiums Committee *vice* Norman Robert Wishart, who has resigned.

R. C. PAUST,  
Secretary for Local Government.

#### LOCAL GOVERNMENT ACT, 1960.

Shire of Canning.

Drainage.

Department of Local Government,  
Perth, 8th February, 1968.

L.G. 850/65.

IT is hereby notified for public information that His Excellency the Governor has approved under the provisions of section 315 (b) of the Local Government Act, 1960, of the Canning Shire Council constructing drains for the purpose of drainage of private lands in those portions of the district as described in the schedule hereto.

R. C. PAUST,  
Secretary for Local Government.

Schedule.

All that portion of land bounded by lines starting from the northeastern corner of Lot 100 of Canning Location 2 as shown on Land Titles Office Plan 2731 and extending 189 degrees 46 minutes 165.8 links along the eastern boundary of that lot; thence 279 degrees 46 minutes 12.4 links; thence 189 degrees 46 minutes 59 links; thence 203 degrees 48 minutes 386.7 links; thence 99 degrees 46 minutes 12.7 links; thence 225 degrees 9 minutes 496.4 links; thence 135 degrees 11 minutes 163 links; thence 196 degrees 49 minutes 288.7 links; thence 225 degrees 9 minutes 60.8 links; thence 135 degrees 9 minutes 32.8 links; thence 196 degrees 49 minutes 283.5 links; thence 203 degrees 21 minutes 33.6 links; thence 225 degrees 9 minutes to the southwestern side of Railway Crescent; thence northwesterly along that side to a point situate in prolongation southwesterly of the northwestern boundary of Lot 127 as shown on Land Titles Office Plan 2731 aforesaid; thence northeasterly to and along that boundary to the southwestern boundary of lot 116; thence 315 degrees 9 minutes 250 links along that boundary; thence 45 degrees 9 minutes 334 links; thence 135 degrees 9 minutes 200 links along the north-eastern boundary of lot 116 aforesaid to the western corner of lot 114; thence northeasterly along the northwestern boundary of that lot to the southern side of Welshpool Road and thence generally easterly along that side to the starting point.

LOCAL GOVERNMENT ACT, 1960.

City of Perth.

Closure of Private Street.

Department of Local Government,  
Perth, 1st February, 1968.

L.G. 92/58.

NOTICE is hereby given in pursuance of the provisions of section 297A of the Local Government Act, 1960, that His Excellency the Governor has approved of the closing of a private street, in accordance with a resolution, passed by the Perth City Council on the 21st August, 1967, "that the private street between Clydesdale and Harper Streets, shown coloured brown on Land Titles Office Plan 2793, abutting Lots 22, 23, 24 and 25 and being portion of Swan Location 36, Certificate of Title Volume 96, folio 90, be closed and amalgamated with the said Lots 22, 23, 24 and 25 in accordance with City of Perth Plan 3563."

R. C. PAUST,  
Secretary for Local Government.

Schedule.

Copy of Diagram 35481.

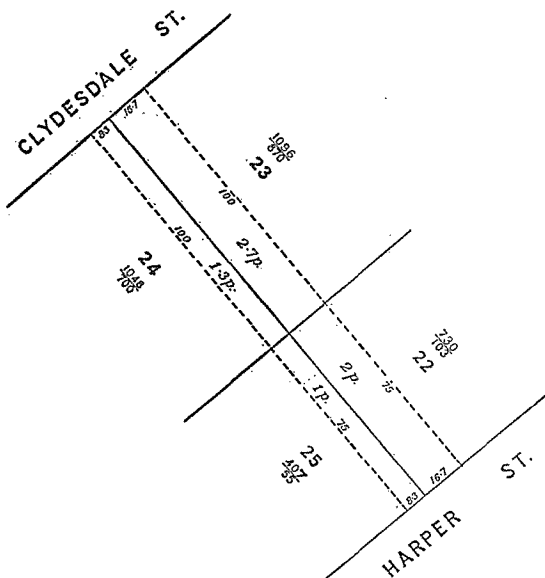

LOCAL GOVERNMENT ACT, 1960.

City of Perth.

Closure of Private Street.

Department of Local Government,  
Perth, 1st February, 1968.

L.G. 92/58.

NOTICE is hereby given in pursuance of the provisions of section 297A of the Local Government Act, 1960, that His Excellency the Governor has approved of the closing of the private street shown on the plan in the schedule hereunder, in accordance with a resolution, passed by the Perth City Council on the 16th day of October, 1967, "that the Right-of-Way being part of Canning Location 2 and being one of the ways shown coloured brown on Land Titles Office, Plan 1740 and being part of the land alone remaining in Certificate of Title Volume 331, Folio 33 and being more particularly the portion of Right-of-Way abutting the rear boundaries of Lots 431, 432 and 433 Rutland Avenue be closed and amalgamated with Lot 430 Wakefield Street."

R. C. PAUST,  
Secretary for Local Government.

Schedule.

Copy of Diagram 35482.

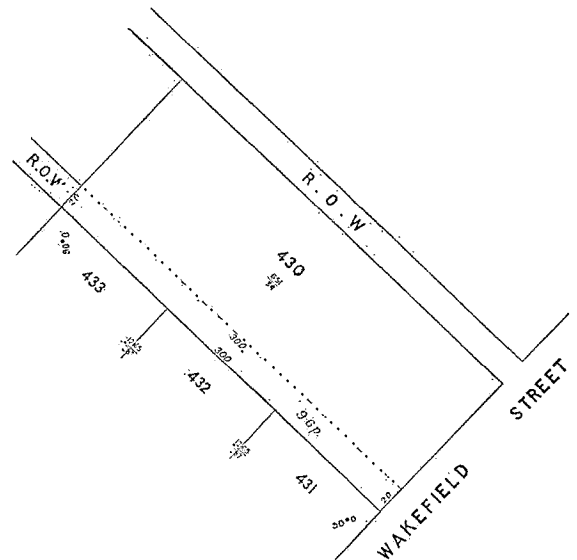

CEMETERIES ACT, 1897.

Nabawa Public Cemetery.

Appointment of Trustees.

Department of Local Government,  
Perth, 8th February, 1968.

L.G. 451/67.

IT is hereby notified for public information that His Excellency the Governor has approved under the provisions of the Cemeteries Act, 1897 the appointment of Lawrence Percival Cooper as a Trustee to Control and Manage the Nabawa Public Cemetery, vice John Cooper, deceased.

R. C. PAUST,  
Secretary for Local Government.

LOCAL GOVERNMENT ACT, 1960.

Town of Bunbury.

Sale of Land.

Department of Local Government,  
Perth, 8th February, 1968.

L.G. 171/64C.

IT is hereby notified for public information that His Excellency the Governor has directed, under the provisions of section 266 of the Local Government Act, 1960, that the Bunbury Town Council

may sell Lots 32, 34 to 40 inclusive, 47 to 54 inclusive, 56, 58 and 65 to 66 inclusive, on Plan 9018, Certificate of Title Volume 1252, folio 940, by public auction.

R. C. PAUST,  
Secretary for Local Government.

LOCAL GOVERNMENT ACT, 1960.

Shire of Armadale-Kelmscott.

Sale of Land.

Department of Local Government,  
Perth, 8th February, 1968.

L.G. 102/67.

IT is hereby notified for public information that His Excellency the Governor has directed, under the provisions of section 266 of the Local Government Act, 1960, that the Armadale-Kelmscott Shire Council may sell Lots 58 to 60 inclusive and 83 on Diagram 35336, and Lots 78 to 81 inclusive on Diagram 35371, without calling public tenders.

R. C. PAUST,  
Secretary for Local Government.

LOCAL GOVERNMENT ACT, 1960.

Shire of Koorda.

Sale of Land.

Department of Local Government,  
Perth, 8th February, 1968.

L.G. 473/59.

IT is hereby notified for public information that His Excellency the Governor has directed, under the provisions of section 266 of the Local Government Act, 1960, that the Koorda Shire Council may sell Koorda Lot 25 Certificate of Title Volume 811 Folio 19 and Koorda Lot 26 Certificate of Title Volume 1110, folio 595.

R. C. PAUST,  
Secretary for Local Government.

LOCAL GOVERNMENT ACT, 1960.

Shire of Port Hedland.

Sale of Land.

Department of Local Government,  
Perth, 8th February, 1968.

L.G. 242/65.

IT is hereby notified for public information that His Excellency the Governor has directed, under the provisions of section 266 of the Local Government Act, 1960, that the Port Hedland Shire Council may sell by public auction Lots 1422, 1427, 1436, 1437, 1438, 1439 and 1441.

R. C. PAUST,  
Secretary for Local Government.

LOCAL GOVERNMENT ACT, 1960.

Shire of Trayning.

Sale of Land.

Department of Local Government,  
Perth, 8th February, 1968.

L.G. 2/68.

IT is hereby notified for public information that His Excellency the Governor has directed, under the provisions of section 266 of the Local Government Act, 1960, that the Trayning Shire Council may sell by public tender, Lot 90 Railway Street, Trayning, Certificate of Title Volume 1264, folio 197.

R. C. PAUST,  
Secretary for Local Government.

LOCAL GOVERNMENT ACT, 1960.

City of Fremantle.

Lease of Land.

Department of Local Government,  
Perth, 8th February, 1968.

L.G. 609/60.

IT is hereby notified for public information that His Excellency the Governor has directed, under the provisions of section 267 of the Local Government Act, 1960, that the City of Fremantle may lease to the Hilton Park Bowling Club Inc. portion of the land described in Certificate of Title Volume 1072, folio 824, being portion of Cockburn Location 839.

R. C. PAUST,  
Secretary for Local Government.

LOCAL GOVERNMENT ACT, 1960.

Shire of Three Springs.

Loans.

Department of Local Government,  
Perth, 8th February, 1968.

L.G. 637/63.

IT is hereby notified for public information that His Excellency the Governor has approved of the maintenance of two doctors' residences, on land comprised in Diagram 9947, Certificate of Title Volume 1043, folio 841, as a work and undertaking for which money may be borrowed under Part XXVI of the Local Government Act, 1960, by the Three Springs Shire Council.

R. C. PAUST,  
Secretary for Local Government.

LOCAL GOVERNMENT ACT, 1960.

Shire of Dundas.

Loans.

Department of Local Government,  
Perth, 8th February, 1968.

L.G. 290/64.

IT is hereby notified for public information that His Excellency the Governor has approved of the extending of the Salmon Gums Stock Sale Yards on portion of Reserve 27786, as a work and undertaking for which money may be borrowed under Part XXVI of the Local Government Act, 1960, by the Dundas Shire Council.

R. C. PAUST,  
Secretary for Local Government.

LOCAL GOVERNMENT ACT, 1960.

Shire of Wanneroo.

Loans.

Department of Local Government,  
Perth, 8th February, 1968.

L.G. 112/61.

IT is hereby notified for public information that His Excellency the Governor has approved of—

- (1) the development of Reserve 11630 for the Burns Beach Holiday Home Scheme;
- (2) the construction of a Motor Racing Circuit on Reserve 10866,

as a work and undertaking for which money may be borrowed under Part XXVI of the Local Government Act, 1960, by the Wanneroo Shire Council.

R. C. PAUST,  
Secretary for Local Government.

LOCAL GOVERNMENT ACT, 1960.

Shire of Exmouth.

Loans.

Department of Local Government,  
Perth, 8th February, 1968.

L.G. 598/66.

IT is hereby notified for public information that His Excellency the Governor has approved of the construction of a Drive-in Theatre on Exmouth Lot 395, the subject of special lease No. 3116-3549 from the Minister for Lands as a work and undertaking for which money may be borrowed under Part XXVI of the Local Government Act, 1960, by the Exmouth Shire Council.

R. C. PAUST,  
Secretary for Local Government.

DOG ACT, 1903.

Department of Local Government,  
Perth, 8th February, 1968.

L.G. 2401/52.

PURSUANT to regulation 4(3) of the regulations made under the Dog Act, 1903, gazetted on the 12th May, 1939, I, Leslie Arthur Logan, Minister for Local Government, do hereby order that the size and shape of the registration label for the year ending 30th June, 1969, shall be as depicted hereunder:—

L. A. LOGAN,  
Minister for Local Government.

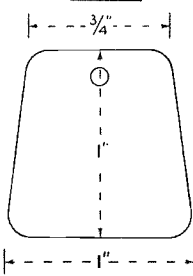

No. 16 or 18 wire-gauge thickness.

PLANT DISEASES ACT, 1914-1966.

Department of Agriculture,  
South Perth, November, 1967.

Agric. File 71/67.

I, THE UNDERSIGNED MINISTER FOR AGRICULTURE, being the Minister charged with the Administration of the Plant Diseases Act, 1914-1966, acting in exercise of the power in this behalf conferred upon me by regulation 5A of the Compulsory Fruit Fly Baiting Regulations made under the provisions of the said Act, do hereby appoint Messrs Roy Havill Creek, of Hampton Road, Bridgetown, and Colin Henry Moore, of Canberra orchard, Bridgetown, as members of the Bridgetown Compulsory Fruit Fly Baiting Scheme to fill the vacancies resulting from the resignation of Messrs W. G. Jones and I. Pierce from the said Committee.

C. D. NALDER,  
Minister for Agriculture.

AGRICULTURAL PRODUCTS ACT, 1926-1966.

Department of Agriculture,  
South Perth, 5th February, 1968.

I, THE UNDERSIGNED MINISTER FOR AGRICULTURE, being the Minister charged with the administration of the Agricultural Products Act, 1926-1966, acting in exercise of the power in this behalf conferred upon me by section 3D of the said Act, and on the recommendation of the Apple Sales Advisory Committee constituted under the Act, do hereby revoke the prohibition concerning the sale of apples and pears as proclaimed by notice in the "West Australian" newspaper of 29th December, 1967 and the Government Gazette of

21st December, 1967, under the provisions of the aforesaid section 3D, and hereby prohibit the sale, except for the purpose of export, of all apples and pears of the grades and varieties as listed in column (1) of the schedule hereto that are below the minimum sizes specified in column (2) of the schedule immediately opposite the name of the variety and grade, for the period 1st February, 1968 to 31st December, 1968.

A person shall not sell, except for the purpose of export from the State, any apples or pears of which the sale is, pursuant to the provisions of this Section prohibited and any person who contravenes the provisions of this Section commits an offence.

Penalty: One hundred dollars.

Grade and Variety. (Column 1.)	Schedule.	Minimum Size. (Column 2.)
Apples.		inches
Extra Fancy Grade Jonathan	....	2 1/4
Fancy Grade Jonathan	....	2 1/4
Orchard Grade Jonathan	....	2 1/4
Plain Grade Jonathan	....	2 3/8
Extra Fancy Grade Delicious	....	2 3/8
Fancy Grade Delicious	....	2 3/8
Orchard Grade Delicious	....	2 3/8
Plain Grade Delicious	....	2 1/2
Extra Fancy Grade Golden Delicious	....	2 3/8
Fancy Grade Golden Delicious	....	2 3/8
Orchard Grade Golden Delicious	....	2 3/8
Plain Grade Golden Delicious	....	2 3/8
Extra Fancy Grade Cleopatra	....	2 3/8
Fancy Grade Cleopatra	....	2 3/8
Orchard Grade Cleopatra	....	2 1/2
Plain Grade Cleopatra	....	2 1/2
Extra Fancy Grade Dunns Seedling	....	2 1/2
Fancy Grade Dunns Seedling	....	2 1/2
Orchard Grade Dunns Seedling	....	2 1/2
Plain Grade Dunns Seedling	....	2 1/2
Extra Fancy Grade Staymans Winesap	....	2 1/2
Fancy Grade Staymans Winesap	....	2 1/2
Orchard Grade Staymans Winesap	....	2 1/2
Plain Grade Staymans Winesap	....	2 1/2
Extra Fancy Grade Gravenstein	....	2 1/4
Fancy Grade Gravenstein	....	2 1/4
Orchard Grade Gravenstein	....	2 1/4
Plain Grade Gravenstein	....	2 1/4
Extra Fancy Grade Willie Sharp	....	2 1/4
Fancy Grade Willie Sharp	....	2 1/4
Orchard Grade Willie Sharp	....	2 1/4
Plain Grade Willie Sharp	....	2 1/4
Extra Fancy Grade Early McIntosh	....	2 1/4
Fancy Grade Early McIntosh	....	2 1/4
Orchard Grade Early McIntosh	....	2 1/4
Plain Grade Early McIntosh	....	2 1/4
Extra Fancy Grade Williams Favourite	....	2 1/4
Fancy Grade Williams Favourite	....	2 1/4
Orchard Grade Williams Favourite	....	2 1/4
Plain Grade Williams Favourite	....	2 1/4
Domestic Grade (all varieties)—All sizes prohibited.	....	
Cooker Grade (all varieties)	....	2 1/2
Pears.		
Extra Fancy Grade Bartlett	....	2 1/8
Fancy Grade Bartlett	....	2 3/8
Orchard Grade Bartlett	....	2 1/8
Plain Grade Bartlett	....	2 1/8
Extra Fancy Grade Packham	....	2 1/4
Fancy Grade Packham	....	2 1/4
Orchard Grade Packham	....	2 1/4
Plain Grade Packham	....	2 1/4
Extra Fancy Grade Comice	....	2 1/4
Fancy Grade Comice	....	2 1/4
Orchard Grade Comice	....	2 1/4
Plain Grade Comice	....	2 1/4
Extra Fancy Grade Josephine	....	2 1/4
Fancy Grade Josephine	....	2 1/4
Orchard Grade Josephine	....	2 1/4
Plain Grade Josephine	....	2 1/4
Extra Fancy Grade Winter Nelis	....	2 1/8
Fancy Grade Winter Nelis	....	2 3/8
Orchard Grade Winter Nelis	....	2 1/8
Plain Grade Winter Nelis	....	2 1/8
Extra Fancy Grade Winter Cole	....	2 3/8

	inches
Fancy Grade Winter Cole	2 $\frac{3}{8}$
Orchard Grade Winter Cole	2 $\frac{3}{8}$
Plain Grade Winter Cole	2 $\frac{3}{8}$
Extra Fancy Grade Keiffer	2 $\frac{1}{4}$
Fancy Grade Keiffer	2 $\frac{1}{4}$
Orchard Grade Keiffer	2 $\frac{1}{4}$
Plain Grade Keiffer	2 $\frac{1}{4}$
Extra Fancy Grade Beurre Bose	2 $\frac{3}{8}$
Fancy Grade Beurre Bose	2 $\frac{3}{8}$
Orchard Grade Beurre Bose	2 $\frac{3}{8}$
Plain Grade Beurre Bose	2 $\frac{3}{8}$
Extra Fancy Grade Glou Morceau	2 $\frac{1}{4}$
Fancy Grade Glou Morceau	2 $\frac{1}{4}$
Orchard Grade Glou Morceau	2 $\frac{1}{4}$
Plain Grade Glou Morceau	2 $\frac{1}{4}$
Extra Fancy Grade Clapps Favourite	2 $\frac{1}{4}$
Fancy Grade Clapps Favourite	2 $\frac{1}{4}$
Orchard Grade Clapps Favourite	2 $\frac{1}{4}$
Plain Grade Clapps Favourite	2 $\frac{1}{4}$
Extra Fancy Grade Howell	2 $\frac{1}{4}$
Fancy Grade Howell	2 $\frac{1}{4}$
Orchard Grade Howell	2 $\frac{1}{4}$
Plain Grade Howell	2 $\frac{1}{4}$
All other pears	2 $\frac{1}{4}$
Domestic Grade (all varieties)—All sizes prohibited.	

C. D. NALDER,  
Minister for Agriculture.

THE UNIVERSITY OF WESTERN AUSTRALIA.  
Annual Election by Convocation of One Member  
of the Senate.

NOMINATIONS for the above election closed on  
Tuesday, 30th January, 1968, and the only nomina-  
tion received was from—

Jean Ethel Rogerson, B.Sc. (W. Aust.),  
A.R.A.C.I.

L. A. W. RICHARDS,  
Clerk of Convocation.

Western Australia.

BUILDING SOCIETIES ACT, 1920,  
(AS AMENDED).

NOTICE is hereby given that a Building Society  
called Steelworkers (A.I.S. Kwinana) No. 1 Build-  
ing Society is duly registered under the provisions  
of the above Act.

Dated the 31st day of January, 1967.

B. BROTHERTON,  
Registrar of Building Societies.

STATE TENDER BOARD OF WESTERN AUSTRALIA.

Accepted Tenders

Schedule No.	Contractor	Particulars	Department Concerned	Rate
1014A/67	Various	Supply and Delivery of Commercial Wet-ting Agent, as specified	Agriculture	\$3.50 per gallon
973A/67	Gerflex Flooring Division	Supply of 36 square yards of Vinyl Tiles, as specified	P.W.D.	For the sum of \$100.80
966A/67	Harland Engineering (Aust.) Pty Ltd	Supply and Delivery of Sewerage Pumping Machinery, as specified—	M.W.B.	
		Item 1		For the sum of \$4,866
		Item 2		For the sum of \$215
		Item 3		For the sum of \$60
977A/67	The Readymix Group (W.A.)	Supply and Delivery of Rockbase as required during the period from the 1st February, 1968, to 31st December, 1968, as specified	M.W.B.	\$2.30 per ton
981A/67	Chamberlain Industries Pty Limited	Supply and Delivery of an Industrial Tractor, as specified	M.W.B.	For the sum of \$6,711
884A/67	Gollin & Co. Ltd	Supply of Steel Boiler Tubes, as specified—	W.A.G.R.	
		Item 3		\$2.70 each
		Item 4		\$2.26 each
859A/67	Various	Supply of Precast Concrete Drainage Pipes, as specified	Various	Details on application
860A/67	Various	Supply of Precast Concrete Box Culverts, as specified	Various	Details on application
5A/68	J. L. Cutbush	Purchase and Removal of an Atlas Copco Paving Breaker (PW 178)	P.W.D.	For the sum of \$7.20
1032A/67	J. L. Cutbush	Purchase and Removal of a White Truck (Registered No. WAG 4081)	M.R.D.	For the sum of \$451.60
1028A/67	J. Krasnostein & Co. Pty Ltd	Purchase and Removal of Scrap Steel, as specified	M.W.B.	\$6.77 per ton
1024A/67	Lange & Amies	Purchase and Removal of a Fordson Major Tractor (Departmental No. MRD 486)	M.R.D.	For the sum of \$302.50
1021A/67	Garvey Motors	Purchase and Removal of a 1964 Toyota Landeruizer Utility (Registered No. WAG 9363)	M.R.D.	For the sum of \$287
1009A/67	L. Ouschan	Purchase and Removal of a HD Holden Utility (Registration No. WAG 2175)	M.R.D.	For the sum of \$652
1006A/67	E. & M. J. Rosher	Purchase and Removal of a Howard Rotsvator Rotary Hoe (Departmental No. MRD 403)	M.R.D.	For the sum of \$77
1005A/67	E. & M. J. Rosher	Purchase and Removal of an Auto Diesel Floodmaster Water Pump (Departmental No. MRD 506)	M.R.D.	For the sum of \$43
988A/67	J. A. & P. B. Weir	Purchase and Removal of an International Dozer (Departmental No. MRD 699)	M.R.D.	For the sum of \$1,900
987A/67	Holmes Motors & Engineering	Purchase and Removal of a 250 amp. Welder powered by an Astin Engine	P.W.D.	For the sum of \$150
<i>All Tenders Declined</i>				
978A/67	All tenders declined	Supply of a Gravity Feed Flood Slicer	P.W.D.	

## STATE TENDER BOARD OF WESTERN AUSTRALIA—continued.

## Tenders for Government Supplies

Date of Advertising	Schedule No.	Supplies Required	Date of Closing
1968			1968
Jan. 16	24A, 1968†	Axleboxes and Bearings	Feb. 15
Jan. 16	25A, 1968†	Railway Wheels and Axles	Feb. 15
Jan. 26	38A, 1968	Copper Tubing—M.W.B.	Feb. 15
Jan. 26	40A, 1968	Coffins	Feb. 15
Jan. 26	44A, 1968	Prime Movers (3 only) and Semi-trailers (7 only)	Feb. 15
Jan. 23	54A, 1968	Liquid Chlorine—M.W.B.	Feb. 15
Jan. 26	55A, 1968	¾ in. Water Meters—M.W.B.	Feb. 15
Jan. 26	56A, 1968	Maintenance Sleepers, 1968-69	Feb. 15
Jan. 26	59A, 1968	Uniforms—W.A.G.R.	Feb. 15
Jan. 26	62A, 1968	Pumping Plant—Albany No. 5 Sewerage Pumping Station	Feb. 15
Jan. 26	64A, 1968	Tinned Fruits and Fruit Juices	Feb. 15
Feb. 2	68A, 1968	Bread—Wooroloo Hospital	Feb. 15
Feb. 2	69A, 1968	Trailer Certificate Registration Holders	Feb. 15
Feb. 2	108	Biscuits, Cake—Government Institutions	Feb. 15
Feb. 2	70A, 1968	Typewriters—Pica Type—15 in. Carriages	Feb. 15
Feb. 2	80A, 1968	12 in. Electric Fans (re-called)	Feb. 15
Feb. 2	81A, 1968	Special Station Sedans	Feb. 15
Jan. 26	53A, 1968	Pumping Machinery—M.W.B.	Feb. 22
Jan. 12	21A, 1968*†	Mainline Diesel Electric Locomotives—3 ft 6 in. Gauge	Feb. 22
Feb. 2	71A, 1968	Calorifiers—Albany Regional Hospital	Feb. 22
Feb. 2	72A, 1968	18 in. C.I. Sluice Valves, 1968	Feb. 22
Feb. 9	89A, 1968	Pantry Equipment—Perth Medical Centre	Feb. 22
Feb. 9	90A, 1968	Sterilizing Equipment—Perth Medical Centre	Feb. 22
Feb. 9	91A, 1968	Refrigerators and Ice-making Machine—Perth Medical Centre	Feb. 22
Jan. 26	42A, 1968†	Dry Freight Containers	Feb. 29
1967			
Dec. 29	1037A, 1967	Distillate Fuel—W.A.G.R.	Feb. 29
1968			
Jan. 26	43A, 1968*†	Diesel Railcars—4 ft 8½ in. Gauge	Mar. 7
Feb. 9	88A, 1968*†	100 only Wheels—ADG, ADH and ADX Railcars	Mar. 7
Jan. 26	57A, 1968*†	Diesel Electric Shunting Locomotives	Mar. 14
Feb. 6	84A, 1968	Suction Road Sweeper	Mar. 21
Jan. 19	37A, 1968†	Six 3300/440 Volt Dry Type Indoor Transformers for Kwinana Generating Station. Documents chargeable at a rate of \$4 first issue and \$1 subsequent issues. S.E.C. Specification 29/K	Mar. 28

\* Documents available from Agent General for W.A., 115 The Strand, London, W.C. 2.

† Documents available for inspection only at W.A. Government Tourist Bureau Offices, Melbourne and Sydney.

## Addresses—Liaison Offices—

W.A. Government Tourist Bureau,  
No. 2 Royal Arcade, Melbourne, Cl.

C/o The Manager,  
W.A. Government Tourist Bureau,  
22 Martin Place, Sydney.

Agent General for W.A.,  
115 The Strand, London, W.C. 2.

## For Sale by Tender

Date of Advertising	Schedule No.	For Sale	Date of Closing
1968			1968
Jan. 26	51A, 1968	Bulldozer Blade	Feb. 15
Jan. 26	52A, 1968	S.E.W. Screening Plant (MRD 403)	Feb. 15
Jan. 26	58A, 1968	Lincoln 400 AMP Welder (PW 97) at Derby	Feb. 15
Jan. 26	61A, 1968	School Building No. 681 at Ludlow	Feb. 15
Jan. 26	67A, 1968	Lighting Plant ex Latham School	Feb. 15
Feb. 2	75A, 1968	Bedford 5 ton Truck (WAG 6869)	Feb. 15
Feb. 2	76A, 1968	EH Holden Panel Van (WAG 7840)	Feb. 15
Feb. 2	82A, 1968	Holden Special Station Sedans	Feb. 15
Feb. 2	73A, 1968	Landrover 109 in. W.B. Utility (WAG 2784) at Derby	Feb. 22
Feb. 2	74A, 1968	Toyota Utility (WAG 7929) at Wyndham	Feb. 22
Feb. 2	77A, 1968	Cockerell Metal Spreader (MRD 445) at Derby	Feb. 22
Feb. 2	78A, 1968	Pneumatic Sump Pump (PW 114) at Wyndham	Feb. 22
Feb. 2	79A, 1968	2 in. Finsbury Pump (PW 256) at Port Hedland	Feb. 22
Feb. 2	83A, 1968	Finsbury 2 in. Self-priming Pump (PW 264) at Port Hedland	Feb. 22
Feb. 9	85A, 1968	Bedford 5 ton Tip Truck (WAG 4073) (ex Department Industrial Development)	Feb. 22
Feb. 9	92A, 1968	Auto Diesel Pumping Plant (MRD 517)	Feb. 22
Feb. 9	93A, 1968	Lightning 3½ cub. ft Concrete Mixer (MRD 408)	Feb. 22
Feb. 9	94A, 1968	Ledger 6/8 Road Roller (MRD 503)	Feb. 22
Feb. 9	95A, 1968	McDonald 3½ ton Road Roller (MRD 446)	Feb. 22
Feb. 9	96A, 1968	Coates Vibrating Roller (MRD 516)	Feb. 22
Feb. 9	97A, 1968	Adams 550 Grader (MRD 561)	Feb. 22
Feb. 9	98A, 1968	Track Marshall Tractor (MRD 826)	Feb. 22
Feb. 9	99A, 1968	Chamberlain F.E. Loader (MRD 613)	Feb. 22
Feb. 9	101A, 1968	Atlas Copeo Air Compressor (MRD 421)	Feb. 22
Feb. 9	86A, 1968	Engines and Pumps, Misting Machines, Knapsack Sprays and Stoves	Feb. 29
Feb. 9	87A, 1968	Toyota Utility (WAG 9689) at Kununurra	Feb. 29

Tenders addressed to the Chairman, State Tender Board, 74 Murray Street, Perth, will be received for the abovementioned supplies until 10 a.m. on the dates of closing.

Tenders must be properly indorsed on envelopes otherwise they are liable to rejection.

Tender forms and full particulars may be obtained on application at the Tender Board Office, 74 Murray Street, Perth.

No Tender necessarily accepted.

A. H. TELFER,  
Chairman, Tender Board.

9th February, 1968.

## MINING ACT, 1904.

Notice of Intention to Forfeit Leases for  
Non-payment of Rent.

Department of Mines,  
Perth, 11th January, 1968.

IN accordance with section 97 of the Mining Act, 1904, notice is hereby given that, unless the rent due on the undermentioned Miner's Homestead Leases be paid on or before the 16th day of February, 1968, it is the intention of the Governor, under the provisions of section 98 of the Mining Act, 1904, to forfeit such leases for breach of covenant, viz., non-payment of rent.

I. R. BERRY,  
Under Secretary for Mines.

Phillips River Goldfield.

197. Bendigo; Foord, Edith Lillian Flowers.  
239. Isabella; McColl, Donald Lewis.

NOTICE OF DISSOLUTION OF PARTNERSHIP  
OF CRONIN AND PECKHAM.

NOTICE is hereby given that the partnership heretofore subsisting between Harold James Cronin, of Ravensthorpe in the State of Western Australia and John Peckham, of Esperance in the said State, carrying on the business as Shearing Contractors at Esperance in the said State under the style or firm name of Cronin and Peckham, was dissolved on the 19th January, 1968.

Dated the 2nd day of February, 1968.

KEALL, STABLES & BRINDSEN,  
Solicitors for the said Harold James Cronin.

## TRUSTEES ACT, 1962.

Notice to Creditors and Claimants.

CREDITORS and other persons having claims (to which section 63 of the Trustees Act relates) in respect of the estate of the undermentioned deceased person are required to send particulars of their claims to the Executors care of the undersigned on or before the respective dates shown hereunder after which dates they may convey or distribute the assets, having regard only to the claims of which they then have notice.

Williams, Percy John Edward, late of 2 Braund Street, Bunbury in the State of Western Australia, retired marine dealer, who died on the 17th August, 1966. Late date for claims 16th March, 1968.

Dated at Perth this 7th day of February, 1968.

MORRIS CRAWCOUR & SOLOMON,  
Solicitors, Atlas Building,  
8 Esplanade, Perth, W.A.

Agents for EASTMAN, JENOUR & CO.,  
Solicitors, 99 Victoria Street,  
Bunbury, W.A.

## TRUSTEES ACT, 1962.

Notice to Creditors and Claimants.

CREDITORS and other persons having claims (to which section 63 of the Trustees Act, 1962, relates) in respect of the Estates of the undermentioned deceased persons are required by The Perpetual Executors Trustees and Agency Company (W.A.) Limited of 89 Saint George's Terrace, Perth to send particulars of their claims to the Company by the undermentioned date after which dates the said Company may convey or distribute the assets having regard only to the claims of which the Company then has notice.

Sutton, William James Basden, late of 38 Mars Street, Carlisle, pensioner. Died 10/7/67. Last day for claims 15/3/68.

Hicks, Freda Irene, formerly of Eden Hospital, Hillview Road, Mt Lawley, late of Home of Peace, Subiaco, widow. Died 6/12/67. Last day for claims 15/3/68.

Webb, Sarah Anne, late of "Glenburn" Jarrahdale, widow. Died 29/6/67. Last day for claims 22/3/68.

Dated at Perth this 7th day of February, 1968.

The Perpetual Executors Trustees and Agency Company (W.A.) Limited,

F. T. RODDA,  
Manager.

## TRUSTEES ACT, 1962.

Notice to Creditors and Claimants.

CREDITORS and other persons having claims (to which section 63 of the Trustees Act relates) in respect of the estates of the undermentioned deceased persons are required to send particulars of their claims to me on or before the respective dates shown hereunder after which dates I may convey or distribute the assets, having regard only to the claims of which I then have notice.

Dated at Perth this 6th day of February, 1968.

J. F. MORRIS,  
Public Trustee,  
555 Hay Street, Perth.

Name; Address; Occupation; Date of Death.

Last Date for Claims, 8th March, 1968.

Washington, Roy William; 91 Lake Street, Perth; retired canvas worker; 27/9/67.

Hitch, Louisa May; 25 Pakenham Street, Mount Lawley; spinster; 15/12/67.

Tadpole, Dominic; Native Reserve, Onslow; pensioner; 30/8/67.

Bowman, Fanny; Native Reserve, Marble Bar; unemployed; 5/12/67.

Last Date for Claims, 15th March, 1968.

Slavin, Vane Yearling; 2 Lever Street, Willagee; waterside worker; 29/8/67.

Stocker, John George; Sunset Home, Nedlands; retired engineer; 20/11/67.

Britton, Percy; 49 Egan Street, Kalgoorlie; retired farmer and contractor; 31/8/67.

Carmichael, Emma; Mount Henry Hospital; widow; 20/11/67.

Morgan, Maria Lee; 47 Raymond Street, Collie; widow; 4/11/67.

Fisher, Royal Augustus; Foster Road, Ewington; fitter; 6/10/67.

Last Date for Claims, 22nd March, 1968.

Prater, Mabel May; 94 Goodwood Parade, Rivervale; married woman; 19/5/59.

Parkinson, Thomas John; 36 Hensman Street, South Perth; retired civil servant; 23/12/67.

Scantlebury, Bertie; 157 Coolgardie Street, Redcliffe; retired caretaker; 27/10/67.

Oliver, Blanche Olive; formerly of 32 Teague Street, Victoria Park, late of Braille Home, Sunbury Road, Victoria Park, widow; 21/1/68.

Elliott, Frank Edmund; 114 Nanson Street, Wembley; Clerk in Holy Orders; 15/12/67.

## GOVERNMENT GAZETTE.

## NOTICE.

Subscriptions are required to commence and terminate with a quarter.

The *Government Gazette* is published on Friday in each week, unless interfered with by public holidays or other unforeseen circumstances.

SUBSCRIPTIONS.—The subscription to the *Government Gazette* is as follows:—Annual subscription, \$12; nine months, \$10; six months, \$7; three months, \$4; single copy (current year), \$0.30; single copy (previous years, up to 10 years), \$0.50; single copy (over 10 years), \$0.80.

## SPECIAL NOTICE.

**ADVERTISEMENTS.**—Notices for insertion must be received by the Government Printer at the Government Printing Office, Station Street, Wembley, or at the Main Hall, Treasury Buildings, St. George's Terrace, Perth, **BEFORE TEN O'CLOCK a.m. on THURSDAY, or the day preceding the day of publication, and are charged at the following rates:—**

For the first eight lines, \$2.

For every additional line, 20c.

and half-price for each subsequent insertion.

To estimate the cost of an advertisement, count eight words to a line; heading, signature and date being reckoned as separate lines.

*All fees are payable in advance.* Remittances should be made by money order, postal note, or cheque.

Where signatures are appended to copy for publication in the *Government Gazette* they must appear in typewritten or block characters below the written signature. Unless this is done, no responsibility will be accepted by this office for any error in the initials or names as printed.

The office at the Treasury Buildings, Perth, will be closed each day between 1 p.m. and 2 p.m.

All communications should be addressed to "The Government Printer, Station Street, Wembley."

## CONTENTS.

	Page.
Agricultural Products Act	266
Agriculture, Department of	266-7
Appointments	240, 241, 243-4, 247, 263
Building Societies Act	267
Bush Fires Act	247
Commissioners of Supreme Court	243-4
Crown Law Department	241
Deceased Persons' Estates	269
Fauna Protection Act	244
Fisheries	244
Health Department	244-7
Justices of the Peace	240
Land Acquisitions	249-56
Land Agents Act	240-1
Land Titles	247
Lands Department	244-7, 259-60
Licensed Surveys Act	247
Local Government Department	239-40, 261-6
Main Roads	257
Metropolitan Water Supply, etc.	261
Mines Department	269
Municipalities	239-40, 261-6
Native Welfare	244
Notice of Intention to Resume Land	257-60
Orders in Council	239-40
Partnership Dissolved	269
Plant Diseases Act	266
Premier's Department	240
Public Service Commissioner	242-3
Public Trustee	269
Public Works Department	247-57
Resumption	256
Sale of Land	247, 264
Sworn Valuers	241
Tenders Accepted	248, 267
Tenders Invited	247-8, 268
Totalisator Board	267-8
Transfer of Land Act	247
Trustees Act	269
University	267