



Western Australia

Midland Redevelopment Act 1999

Midland Redevelopment (Subtracted Area) Regulations 2011

These regulations were repealed by the *Metropolitan Redevelopment Authority Act 2011* s. 134(c) (No. 45 of 2011) as at 31 Dec 2011 (see s. 2(b) and *Gazette* 30 Dec 2011 p. 5573).

Western Australia

Midland Redevelopment (Subtracted Area) Regulations 2011

Contents

1.	Citation	1
2.	Commencement	1
3.	Terms used	1
4.	Schedule 1 of the Act amended	1
5.	Minister may amend planning schemes	2
6.	Other transitional matters	3
7.	Expiry of regulations	3

Notes

	Compilation table	4
--	-------------------	---

Midland Redevelopment (Subtracted Area) Regulations 2011

1. Citation

These regulations are the *Midland Redevelopment (Subtracted Area) Regulations 2011* ¹.

2. Commencement

These regulations come into operation as follows —

- (a) regulations 1 and 2 — on the day on which these regulations are published in the *Gazette*;
- (b) the rest of the regulations — on the day after that day.

3. Terms used

In these regulations —

order means an order made under regulation 5(2);

scheme means either of the following —

- (a) the Metropolitan Region Scheme;
- (b) the *City of Swan Local Planning Scheme No. 17*.

4. Schedule 1 of the Act amended

When an order takes effect, in Schedule 1 of the Act:

- (a) delete “Plan No. 1” (first occurrence) and insert:

Plan No. 2

r. 5

(b) delete “Plan No. 1 —” and insert:

Plan No. 2 —

(c) delete the representation of Plan No. 1 and insert:

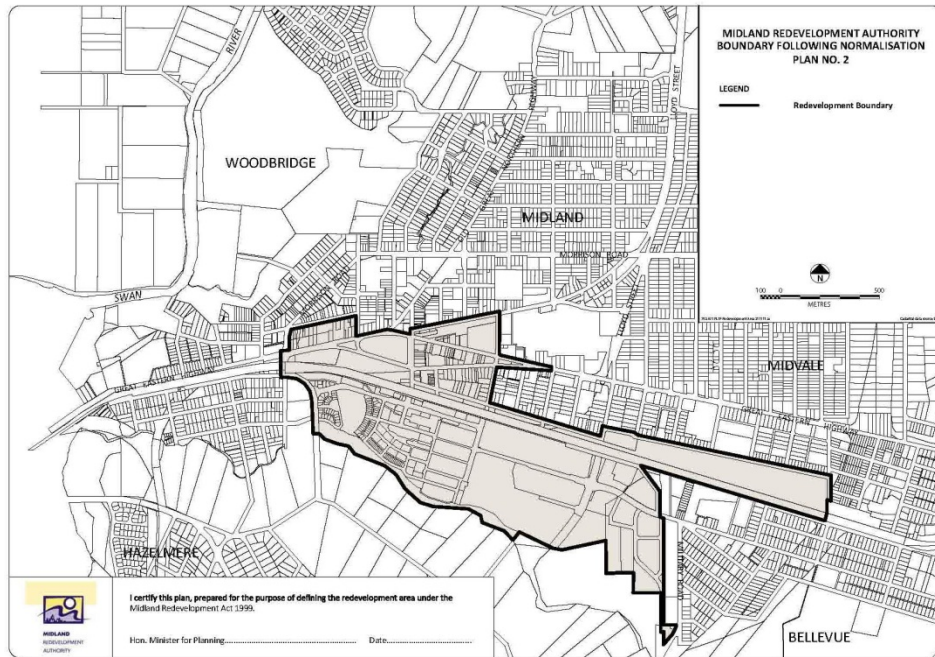

5. Minister may amend planning schemes

(1) In this regulation —

subtracted area means the area that ceases to be in the redevelopment area when Schedule 1 of the Act is amended by regulation 4.

- (2) The Minister may, by order published in the *Gazette*, amend a scheme to provide for any of the following —
 - (a) land in the subtracted area to be included in the area to which the scheme applies;
 - (b) land in the subtracted area to have a reservation or zoning under the scheme the same as, or similar to, that which applied to the land immediately before it ceased to be in the redevelopment area.
- (3) An order takes effect at the beginning of the day after the day on which it is published in the *Gazette*.

6. Other transitional matters

When an order takes effect, the effect of a decision, if any, previously made by the Authority about a development application or an approval continues.

7. Expiry of regulations

- (1) These regulations expire at the end of the 12 month period following the day on which these regulations came into operation.
- (2) The expiry of these regulations does not affect —
 - (a) the amendment of the redevelopment area under regulation 4; or
 - (b) an amendment of a scheme under an order.

Notes

- ¹ This is a compilation of the *Midland Redevelopment (Subtracted Area) Regulations 2011*. The following table contains information about those regulations.

Compilation table

Citation	Gazettal	Commencement
<i>Midland Redevelopment (Subtracted Area) Regulations 2011</i>	13 Dec 2011 p. 5282-4	r. 1 and 2: 13 Dec 2011 (see r. 2(a)); Regulations other than r. 1 and 2: 14 Dec 2011 (see r. 2(b))
These regulations were repealed by the <i>Metropolitan Redevelopment Authority Act 2011</i> s. 134(c) (No. 45 of 2011) as at 31 Dec 2011 (see s. 2(b) and <i>Gazette</i> 30 Dec 2011 p. 5573)		

Defined terms

[This is a list of terms defined and the provisions where they are defined.

The list is not part of the law.]

Defined term	Provision(s)
order.....	3
scheme	3
subtracted area	5(1)